



# VR8/10/12

V-RAKE

Published 02/12

Part NO. 5097C

## OPERATOR'S MANUAL



This Operator's Manual is an integral part of the safe operation of this machine and must be maintained with the unit at all times. READ, UNDERSTAND, and FOLLOW the Safety and Operation Instructions contained in this manual before operating the equipment. C01-Cover



FC-RK-0007

### RHINO

1020 S. Sangamon Ave.  
Gibson City, IL 60936  
800-446-5158



## To the Owner/Operator/Dealer

All implements with moving parts are potentially hazardous. There is no substitute for a cautious, safe-minded operator who recognizes the potential hazards and follows reasonable safety practices. The manufacturer has designed this implement to be used with all its safety equipment properly attached to minimize the chance of accidents.

**BEFORE YOU START!** Read the safety messages on the implement and shown in your manual. Observe the rules of safety and common sense!

# WARNING

### TO AVOID SERIOUS INJURY OR DEATH:

1. READ AND UNDERSTAND OPERATOR'S MANUAL.
2. TRACTOR MUST BE EQUIPPED WITH ROLL-OVER PROTECTION (ROPS) AND SWAY CHAINS.
3. ALWAYS WEAR SAFETY GLASSES, SAFETY SHOES AND SEAT BELT FASTENED TIGHTLY.
4. STOP TRACTOR, LOCK BRAKES, AND BLOCK UP OR SUPPORT IMPLEMENT SECURELY BEFORE WORKING UNDER RAISED COMPONENTS.
5. ALLOW NO RIDERS AT ANY TIME ON TRACTOR OR IMPLEMENT. FALLING OFF CAN KILL.
6. KEEP BYSTANDERS CLEAR OF MOVING PARTS AND WORKING AREA. KEEP CHILDREN AWAY!
7. DO NOT LIFT, LOWER, OR OPERATE UNLESS EVERYONE IS CLEAR OF IMPLEMENT.
8. USE INCREASED CAUTION ON SLOPES & NEAR BANKS AND DITCHES TO PREVENT OVERTURN.
9. LOCK LIFT LEVER UP FOR TRANSPORT. HAVE SMV SIGN VISIBLE. FOLLOW LOCAL LAWS.
10. USE PARKING STAND OR BLOCK UP WHEN UNHITCHING FROM TRACTOR.

999200

For future reference, record your Rhino product model number and serial number.

Dealer		Telephone		Model Number	
Owner		Purchase Date:		Serial Number	



# TABLE OF CONTENTS

## **SAFETY SECTION ..... 1-1**

General Safety Instructions and Practices .....	1-2
Operator Safety Instructions and Practices .....	1-3
Equipment Operation Safety Instructions and Practices .....	1-5
Connecting or Disconnecting Implement Safety Instructions and Practices .....	1-8
Transporting Safety Instructions and Practices .....	1-8
Maintenance and Service Safety Instructions and Practices .....	1-10
Storage and Parking Safety Instructions and Practices .....	1-12
Concluding Safety Instructions and Practices .....	1-12
Decal Location .....	1-13
Decal Description .....	1-15
Federal Laws and Regulations .....	1-20

## **INTRODUCTION SECTION ..... 2-1**

## **ASSEMBLY SECTION..... 3-1**

GENERAL INSTRUCTIONS .....	3-2
ASSEMBLY INSTRUCTIONS .....	3-3
Hydraulic System Assembly .....	3-8
Optional Center Rake Wheel Kit (3690405) .....	3-9
Finger Wheel Wind Covers - Optional .....	3-11

## **OPERATION SECTION ..... 4-1**

Standard Equipment and Specifications .....	4-3
OPERATOR REQUIREMENTS .....	4-4
ROPS and Seat Belt .....	4-5
Tractor Safety Devices .....	4-5
Tractor Horsepower .....	4-5
GETTING ON AND OFF THE TRACTOR .....	4-5
Boarding the Tractor .....	4-6
Dismounting the Tractor .....	4-6
STARTING THE TRACTOR .....	4-7
CONNECTING THE IMPLEMENT TO THE TRACTOR .....	4-7
SETTING THE IMPLEMENT .....	4-8
Attaching the Implement .....	4-8
Setting Working Width .....	4-9
Setting Rake Arm Angle .....	4-9
Optional .....	4-9
Adjusting Rake Ground Pressure .....	4-10
PRE-OPERATION INSPECTION AND SERVICE .....	4-10
Tractor Pre-Operation Inspection/Service .....	4-11
Rake Pre-Operation Inspection/Service .....	4-11
DRIVING THE TRACTOR AND IMPLEMENT .....	4-16
Starting the Tractor .....	4-17
Brake and Differential Lock Setting .....	4-17
Driving the Tractor and Implement .....	4-18
OPERATING THE TRACTOR AND IMPLEMENT .....	4-18
Setting Implement into Work Position .....	4-19

Adjustment in work position .....	4-20
Operating on one side only .....	4-21
Foreign Debris Hazards .....	4-23
PTO RPM and Ground Speed .....	4-23
Shutting Down the Implement .....	4-24
DISCONNECTING THE IMPLEMENT FROM THE TRACTOR.....	4-24
Disconnecting the Implement.....	4-25
RAKE STORAGE.....	4-26
TRANSPORTING THE TRACTOR AND IMPLEMENT .....	4-26
Transporting.....	4-28
Set the machine into transport position.....	4-28
Transporting on Public Roadways .....	4-29
Hauling the Tractor and Implement.....	4-31
TROUBLESHOOTING GUIDE .....	4-32

## **MAINTENANCE SECTION ..... 5-1**

LUBRICATION .....	5-3
Lubrication Fitting Schedule.....	5-3
TIRES .....	5-4
HYDRAULIC CIRCUIT .....	5-4
STORAGE .....	5-4
BOLT TORQUE VALUES .....	5-5

# **SAFETY SECTION**

Safety Section 1-1

# SAFETY

## General Safety Instructions and Practices

A careful operator is the best operator. Safety is of primary importance to the manufacturer and should be to the owner/operator. Most accidents can be avoided by being aware of your equipment, your surroundings, and observing certain precautions. The first section of this manual includes a list of Safety Messages that, if followed, will help protect the operator and bystanders from injury or death. Read and understand these Safety Messages before assembling, operating or servicing this Implement. This equipment should only be operated by those persons who have read the manual, who are responsible and trained, and who know how to do so responsibly.



The Safety Alert Symbol combined with a Signal Word, as seen below, is used throughout this manual and on decals which are attached to the equipment. The Safety Alert Symbol means: "ATTENTION! BECOME ALERT! YOUR SAFETY IS INVOLVED!" The Symbol and Signal Word are intended to warn the owner/operator of impending hazards and the degree of possible injury faced when operating this equipment.

Practice all usual and customary safe working precautions and above all---remember safety is up to YOU. Only YOU can prevent serious injury or death from unsafe practices.



Indicates an imminently hazardous situation that, if not avoided, WILL result in DEATH OR VERY SERIOUS INJURY.



Indicates an imminently hazardous situation that, if not avoided, COULD result in DEATH OR SERIOUS INJURY.



Indicates an imminently hazardous situation that, if not avoided, MAY result in MINOR INJURY.



Identifies special instructions or procedures that, if not strictly observed, could result in damage to, or destruction of the machine, attachments or the environment.

**NOTE:** *Identifies points of particular interest for more efficient and convenient operation or repair.* (SG-1)

READ, UNDERSTAND, and FOLLOW the following Safety Messages. Serious injury or death may occur unless care is taken to follow the warnings and instructions stated in the Safety Messages. Always use good common sense to avoid hazards. (SG-2)



Si no lee ingles, pida ayuda a alguien que si lo lea para que le traduzca las medidas de seguridad. (SG-3)



# SAFETY



Engine Exhaust, some of its constituents, and certain vehicle components contain or emit chemicals known to the state of California to cause cancer and birth defects or other reproductive harm. (SG-30)



Battery posts, terminals and related accessories contain lead and lead compounds, chemicals known to the state of California to cause cancer, birth defects or other reproductive harm. (SG-31)

## Operator Safety Instructions and Practices



Never operate the Tractor or Implement until you have read and completely understand this Manual, the Tractor Operator's Manual, and each of the Safety Messages found in the Manual or on the Tractor and Implement. Learn how to stop the tractor engine suddenly in an emergency. Never allow inexperienced or untrained personnel to operate the Tractor or Implement without supervision. Make sure the operator has fully read and understood the manuals prior to operation. (SG-4)



The operator and all support personnel should wear hard hats, safety shoes, safety glasses, and proper hearing protection at all times for protection from injury including injury from items that may be thrown by the equipment. (SG-16)

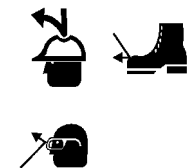

PROLONGED EXPOSURE TO LOUD NOISE MAY CAUSE PERMANENT HEARING LOSS! Tractors with or without an Implement attached can often be noisy enough to cause permanent hearing loss. We recommend that you always wear hearing protection if the noise in the Operator's position exceeds 80db. Noise over 85db over an extended period of time will cause severe hearing loss. Noise over 90db adjacent to the Operator over an extended period of time will cause permanent or total hearing loss. **NOTE:** *Hearing loss from loud noise [from tractors, chain saws, radios, and other such sources close to the ear] is cumulative over a lifetime without hope of natural recovery.* (SG-17)



Always read carefully and comply fully with the manufacturer's instructions when handling oil, solvents, cleansers, and any other chemical agent. (SG-22)



# SAFETY

## SAFETY



KEEP AWAY FROM ROTATING ELEMENTS to prevent entanglement and possible serious injury or death. (SG-24)



Never allow children to play on or around Tractor or Implement. Children can slip or fall off the Equipment and be injured or killed. Inadvertent contact with controls can cause the Implement to shift or fall crushing themselves or others. (SG-25)



DO NOT use drugs or alcohol immediately before or while operating the Tractor and Implement. Drugs and alcohol will affect an operator's alertness and coordination and therefore affect the operator's ability to operate the equipment safely. Before operating the Tractor or Implement, an operator on prescription or over-the-counter medication must consult a medical professional regarding any side effects of the medication that would hinder their ability to operate the Equipment safely. NEVER knowingly allow anyone to operate this equipment when their alertness or coordination is impaired. Serious injury or death to the operator or others could result if the operator is under the influence of drugs or alcohol. (SG-27)



Prolonged operation may cause operator boredom and fatigue affecting safe operation. Take scheduled work breaks to help prevent these potentially impaired operating conditions. Never operate the Implement and Tractor in a fatigued or bored mental state which impairs proper and safe operation. (SG-32)



Use extreme caution when getting onto the Implement to perform repairs, maintenance and when removing accumulated material. Only stand on solid flat surfaces to ensure good footing. Use a ladder or raised stand to access high spots which cannot be reached from ground level. Slipping and falling can cause serious injury or death. (SG-33)



Avoid contact with hot surfaces including hydraulic oil tanks, pumps, motors, valves and hose connections. Relieve hydraulic pressure before performing maintenance or repairs. Use gloves and eye protection when servicing hot components. Contact with a hot surface or fluid can cause serious injury from burns or scalding. (SG-34)



DO NOT operate this Implement on a Tractor that is not properly maintained. Should a mechanical or Tractor control failure occur while operating, immediately shut down the Tractor and perform repairs before resuming operation. Serious injury and possible death could occur from not maintaining this Implement and Tractor in good operating condition. (SG-36)

# SAFETY

## WARNING

Extreme caution should be used by the Tractor operator when operating near passersby. Stop raking if anyone comes within 25 feet of the Implement to prevent possible passerby injury or death from being struck from a thrown object, entanglement with the rakes, or run over. (SRK-01)

## Equipment Operation Safety Instructions and Practices

## CAUTION

Do not back up with this implement. Backing could damage the machine or its components. (S3PT-4)

## WARNING

Use extreme care when lowering or unfolding the implement's wings. Make sure no bystanders are close by or underneath the wings. Allow ample clearance around the implement when folding or unfolding the wings. Use extreme caution around buildings or overhead power lines. (S3PT-05)

## DANGER

There are obvious and hidden potential hazards in the operation of this Implement as in all power-driven or pulled equipment. REMEMBER! This machine is often operated in rough terrain conditions that include tall grass, weeds, gullies, holes, slopes, hidden obstructions and the like. Serious injury or even death may occur unless care is taken to assure the safety of the operator and bystanders in the area. Do not operate this machine with anyone in the immediate area. (S3PT-07)

## DANGER

This Implement may be wider than the Tractor. Be careful when operating or transporting this equipment to prevent the Implement from running into or striking sign posts, guard rails, concrete abutments or other solid objects. Such an impact could cause the Implement and Tractor to pivot violently resulting in loss of steering control, serious injury, or even death. Never allow the Implement to contact obstacles. (S3PT-12)

## WARNING

Operate this Implement only in conditions where you have clear visibility in daylight or with adequate artificial lighting. Never operate in darkness or foggy conditions where you cannot clearly see at least 100 yards in front and to the sides of the tractor and implement. Make sure that you can clearly see and identify passersby, steep slopes, ditches, drop-offs, overhead obstructions, power lines, debris and foreign objects. If you are unable to clearly see this type of items discontinue operating this equipment. (S3PT-21)

## WARNING

Operate this Equipment only with a Tractor equipped with an approved roll-over-protective system (ROPS). Always wear seat belts. Serious injury or even death could result from falling off the tractor--particularly during a turnover when the operator could be pinned under the ROPS. (SG-7)



# SAFETY

## SAFETY



BEFORE leaving the tractor seat lower the implement, set the parking brake and/or set the tractor transmission in parking gear, disengage the PTO, stop the engine, remove the key, and wait for all moving parts to stop. Place the tractor shift lever into a low range or parking gear to prevent the tractor from rolling. Never dismount a Tractor that is moving or while the engine is running. Operate the Tractor controls from the tractor seat only. (SG-9)

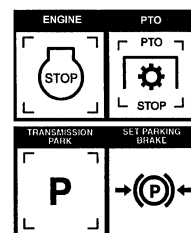

Never allow children or other persons to ride on the Tractor or Implement. Falling off can result in serious injury or death. (SG-10)



Never allow children to operate, ride on, or come close to the Tractor or Implement. Usually, 16-17 year-old children who are mature and responsible can operate the implement with adult supervision, if they have read and understand the Operator's Manuals, been trained in proper operation of the tractor and Implement, and are physically large enough to reach and operate the controls easily. (SG-11)



Do not mount or dismount the Tractor while the tractor is moving. Mount the Tractor only when the Tractor and all moving parts are completely stopped. (SG-12)



Start tractor only when properly seated in the Tractor seat. Starting a tractor in gear can result in injury or death. Read the Tractor operators manual for proper starting instructions. (SG-13)



# SAFETY

## **⚠ WARNING**

Do not operate this Equipment with hydraulic oil or fuel leaking. Oil and fuel are explosive and their presence could present a hazard. Do not check for leaks with your hand! High-pressure oil streams from breaks in the line could penetrate the skin and cause tissue damage including gangrene. To check for a hose leak, SHUT the unit ENGINE OFF and remove all hydraulic pressure. Wear oil impenetrable gloves, safety glasses and use Cardboard to check for evidence of oil leaks. If you suspect a leak, REMOVE the HOSE and have it tested at a Dealer. If oil does penetrate the skin, have the injury treated immediately by a physician knowledgeable and skilled in this procedure. (SG-15)



## **⚠ DANGER**

Never run the Tractor engine in a closed building or without adequate ventilation. The exhaust fumes can be hazardous to your health. (SG-23)

## **⚠ WARNING**

In case of mechanical difficulty during operation, place the transmission in the park position, set the parking brake, shut down all power, including the PTO and the engine and remove the key. Wait until all rotating motion has stopped before dismounting. (SG-39)

## **⚠ WARNING**

Do Not operate this equipment in areas where insects such as bees may attack you and/or cause you to lose control of the equipment. If you must enter in such areas, use a tractor with an enclosed Cab and close the windows to prevent insects from entering. If a tractor cab is not available, wear suitable clothing including head, face, and hand protection to shield you from the insects. Attacking insects can cause you to lose control of the tractor, which can result in serious injury or death to you or bystanders. Never dismount a moving tractor. (SG-40)

## **⚠ WARNING**

Objects such as wire, cable, rope, and chain can become entangled in the rotating parts of the raking components causing mechanical damage. Entangled items caught in the rakes can sling outward possibly injuring or entangling the operator or passersby. Any objects that might become entangled in a raking component should be removed from the area before operating the rake. (SRK-02)



## **⚠ DANGER**

**DO NOT** allow any person under a folded wing unless wing is securely locked up or supported. **DO NOT** approach the Implement unless the Tractor is turned off and all motion has ceased. Never work under the frame work, or any lifted component unless the implement is securely supported or blocked up. A sudden or inadvertent fall by any of these components could cause serious injury or even death. (STI-03)



# SAFETY

## SAFETY

### Connecting or Disconnecting Implement Safety Instructions and Practices



Always shut the Tractor completely down, place the transmission in park, and set the parking brake before you or anyone else attempts to connect or disconnect the Implement and Tractor hitches. (S3PT-15)



Never unhitch without using the Tongue Jack. The Tongue is very heavy. Attempting to lift the Tongue without using the Tongue Jack could cause strains or other injury. Allowing the tongue to fall suddenly and unexpectedly could result in crushing injury. Use the Tongue Jack for lifting the Implement only. Overloading the Tongue Jack can cause failure with possible serious bodily injury or even death. (STI-04)



On a fully-assembled unit, do not remove the Wing Retaining Strap until hoses are attached to the tractor and the Wing Cylinders are filled with oil. Lower the Wings slowly and carefully. Keep bystanders away during operations. (STI-05)

### Transporting Safety Instructions and Practices



Be particularly careful when transporting the Implement with the Tractor. Turn curves or go up hills only at a low speed and using a gradual steering angle. Rear mounted implements move the center of gravity to the rear and remove weight from the front wheels. Make certain, by adding front ballast, that at least 20% of the tractor's weight is on the front wheels to prevent rearing up, loss of steering control or Tractor tip-over. Slow down on rough or uneven surfaces to prevent loss of steering control which could result in property damage or possible injury. Do not transport unless 3-Point lift lever is fully raised and in the latched transport position. Dropping implement in transport can cause serious damage to the tractor and/or Implement and possibly cause the operator or others to be injured or killed. (S3PT-02)



Allow sufficient clearance for the Implement to swing outward while turning. Implements carried behind the Tractor will swing outside the tire path when making turns. Contacting a solid object while turning will cause equipment damage and possible injury. (S3PT-20)



Make certain that the "Slow Moving Vehicle" (SMV) sign is installed in such a way as to be clearly visible and legible. When transporting the Equipment use the Tractor flashing warning lights and follow all local traffic regulations. (SG-6)

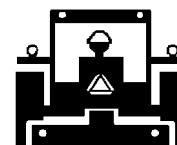

# SAFETY

## **WARNING**

Transport only at speeds where you can maintain control of the equipment. Serious accidents and injuries can result from operating this equipment at high speeds. Understand the Tractor and Implement and how it handles before transporting on streets and highways. Make sure the Tractor steering and brakes are in good condition and operate properly.



Before transporting the Tractor and Implement, determine the proper transport speeds for you and the equipment. Make sure you abide by the following rules:

Test the tractor at a slow speed and increase the speed slowly. Apply the Brakes smoothly to determine the stopping characteristics of the Tractor and Implement. As you increase the speed of the Tractor the stopping distance increases. Determine the maximum transport speed not to exceed 20 mph (30 kph) for transporting this equipment.

Test the equipment at a slow speed in turns. Increase the speed through the turn only after you determine that the equipment can be operated at a higher speed. Use extreme care and reduce your speed when turning sharply to prevent the tractor and implement from turning over. Determine the maximum turning speed for you and this equipment before operating on roads or uneven ground.

Only transport the Tractor and Implement at the speeds which allow you to properly control the equipment.

Be aware of the operating conditions. Do not operate the Tractor with weak or faulty brakes or worn tires. When operating down a hill or on wet or rain slick roads, the braking distance increases: use extreme care and reduce your speed. When operating in traffic always use the Tractor's flashing warning lights and reduce your speed. Be aware of traffic around you and watch out for the other guy. (SG-19)

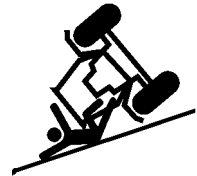

## **DANGER**

Be particularly careful when transporting the Implement using the tractor. Turn curves or go up or down hills only at a low speed and at a gradual steering angle. Make certain that at least 20% of the tractor's weight is on the front wheels to maintain safe steerage. Slow down on rough or uneven surfaces. (STI-01)

## **DANGER**

When the Wings are folded for transport, the center of gravity is raised and the possibility of overturn is increased. Drive slowly and use extreme caution when turning on hillsides. Overturning the Implement could cause the Implement to overturn the Tractor and vice versa resulting in serious injury or even death. Never fold wings on a hillside...the Implement or unit may overturn. (STI-02)

# SAFETY

## SAFETY

### **⚠ WARNING**

Only tow the Implement behind a properly sized and equipped Tractor which exceeds the weight of the Implement by at least 20%. **DO NOT** tow the Implement behind a truck or other type of vehicle. Never tow the Implement and another Implement connected in tandem. Never tow the Implement at speeds over 20 MPH. (STI-06)



### **⚠ WARNING**

Secure the Implement for transport before traveling on public roads. For pull-type Implements, secure the center axle using cylinder stops or transport pin and properly attach a safety chain between the Implement and Tractor. Secure wings in upright position on folding Implements using wing transport locks. (STI-7)

### **⚠ WARNING**

Always keep a careful lookout and use extreme care when working around overhead obstructions and electrical power lines. The Implement wing can be over 10 feet high. Never allow the Implement wing to come within 10 feet of any power line. (STI-8)



### **⚠ WARNING**

Your driving vision may be reduced or impaired by the tractor, cab, or implement. Before driving on public roadways identify any limited vision areas, and make adjustments to your operating position, mirrors, and the implement transport position so that you can clearly see the area where you will be traveling, and any traffic that may approach you. Failure to maintain adequate vision of the public roadway and traffic can result in serious injury or even death. (STI-10)

## **Maintenance and Service Safety Instructions and Practices**

### **⚠ WARNING**

Relieve hydraulic pressure prior to doing any maintenance or repair work on the Implement. Place the Implement on the ground or securely blocked up, disengage the PTO, and turn off the tractor engine. Push and pull the Remote Cylinder lever in and out several times prior to starting any maintenance or repair work. (S3PT-09)



### **⚠ WARNING**

Keep fingers clear of adjusting holes. A sudden movement could cause injury or even amputate fingers. **KEEP CHILDREN AWAY WHEN MAKING ADJUSTMENTS.** (SBL-3)

### **⚠ WARNING**

Always maintain the safety signs in good readable condition. If the safety signs are missing, damaged, or unreadable, obtain and install replacement safety signs immediately. (SG-5)

### **⚠ WARNING**

Do not modify or alter this Implement. Do not permit anyone to modify or alter this Implement, any of its components or any Implement function. (SG-8)

# SAFETY

## DANGER

Never work under the Implement, the framework, or any lifted component unless the Implement is securely supported or blocked up to prevent sudden or inadvertent falling which could cause serious injury or even death. (SG-14)



## WARNING

Never attempt to lubricate, adjust, or remove material from the Implement while it is in motion or while tractor engine is running. (SG-20)

## WARNING

Periodically inspect all moving parts for wear and replace when necessary with authorized service parts. Look for loose fasteners, worn or broken parts, and leaky or loose fittings. Make sure all pins have cotter pins and washers. Serious injury may occur from not maintaining this machine in good working order. (SG-21)

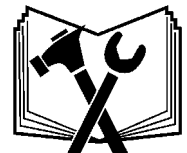
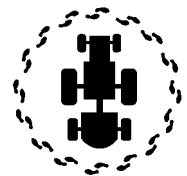

## WARNING

Perform service, repairs and lubrication according to the maintenance section. Ensure the unit is properly lubricated as specified in the lubrication schedule and all bolts and nuts are properly torqued. Failure to properly service, repair and maintain this Implement in good operating condition could cause component failure and possible serious injury or even death. (SG-35)

## WARNING

Use caution and wear protective gloves when handling sharp objects such as blades, knives, and other cutting edges. Be alert to worn component surfaces which have sharp edges. Sharp surfaces can inflict severe laceration injuries if proper hand protection is not worn. (SG-37)

### PARTS INFORMATION

Rhino products are designed utilizing specifically matched system components to ensure optimum equipment performance. These parts are made and tested to Rhino specifications. Non-genuine "will fit" parts do not consistently meet these specifications. The use of "will fit" parts may reduce equipment performance, void warranties, and present a safety hazard. Use genuine Rhino parts for economy and safety. (SPRM-2)

### SEE YOUR RHINO DEALER

SAFETY

# SAFETY

## **Storage and Parking Safety Instructions and Practices**



A rear Implement can fall if not properly supported. Always use the stand on the front hitch (if equipped) or block up securely to prevent falling and possible crushing injury and/or other injury from holding or lifting heavy components. Use the stand to stabilize the implement during storage. (S3PT-3)

## **Concluding Safety Instructions and Practices**

In addition to the design and configuration of this Implement, including Safety Signs and Safety Equipment, hazard control and accident prevention are dependent upon the awareness, concern, prudence, and proper training of personnel involved in the operation, transport, maintenance, and storage of the machine. Refer also to Safety Messages and operation instruction in each of the appropriate sections of the Tractor and Equipment Manuals. Pay close attention to the Safety Signs affixed to the Tractor and Equipment. (SG-18)

# SAFETY

## Decal Location

**NOTE:** Rhino supplies safety decals on this product to promote safe operation. Damage to the decals may occur while in shipping, use, or reconditioning. Rhino cares about the safety of its customers, operators, and bystanders, and will replace the safety decals on this product in the field, free of charge (Some shipping and handling charges may apply). Contact your Rhino dealer to order replacement decals.

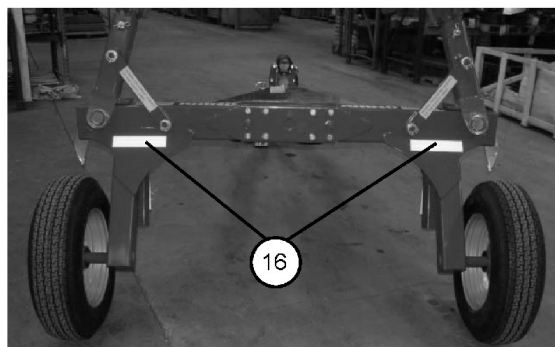
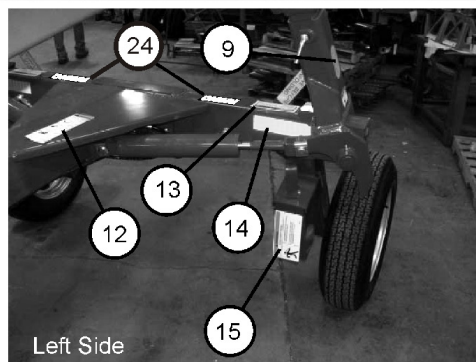
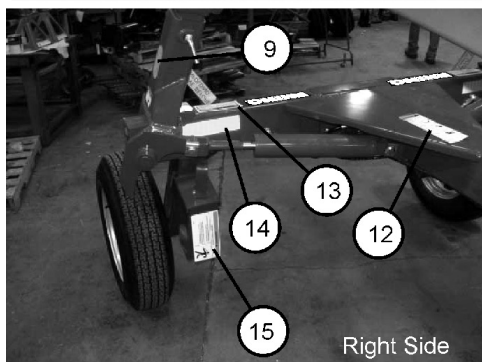
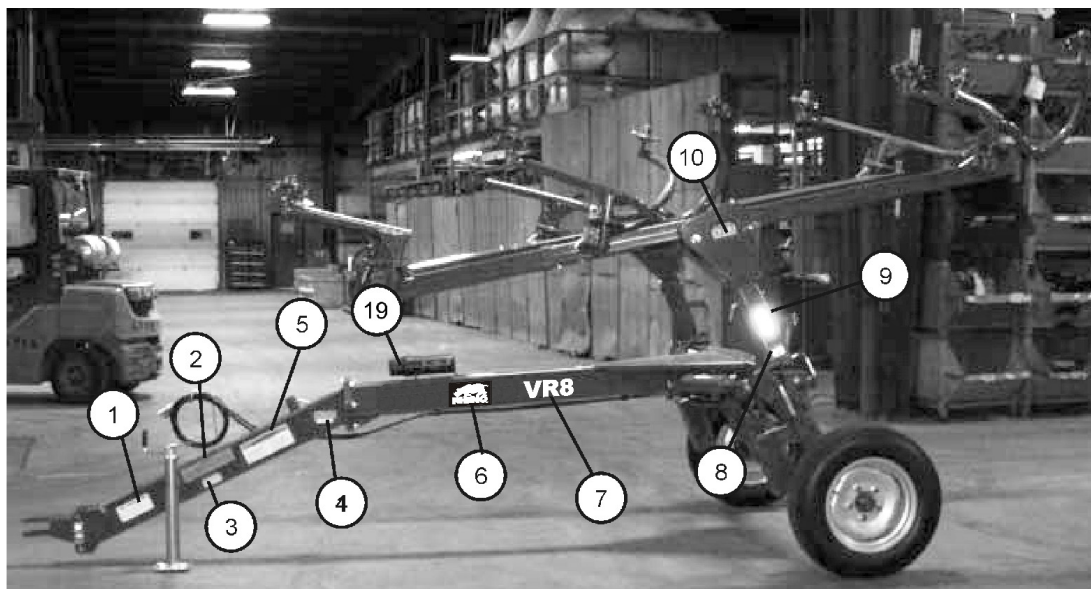

DL-RK-0007

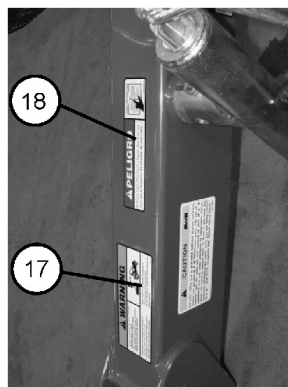

# SAFETY

## SAFETY

TEM	PART NO.	QTY	TYPE	DESCRIPTION
1.	00760657	2	IMPORTANT	Use Genuine Rhino Parts
2.	5W119	2	WARNING	Speed Restriction
3.	00763977	2	INFORMATION	Notice to Owner
4.	999200	2	WARNING	To Avoid Serious Injury or Death
5.	nfs	1	SER PLT	Serial Plate
6.	D302	2	LOGO	Rhino Logo
7.	3698313	2	NAME	VR8
	3698314	2	NAME	VR10
	3698315	2	NAME	VR12
8.	02962764	2	WARNING	Pinch Points
9.	2738333	2	REFLCTR	Yellow Oblong Reflector
10.	02962765	2	WARNING	Multi-Hazard
11.	03200347	*	REFLCTR	SMV Sign
12.	52740	1	WARNING	Do Not Operate with Oil Leaks
13.	3668308	2	WARNING	Install transport lock when in transport
14.	1458393	2	REFLECT	Yellow Rectangular Reflector
15.	2458315	2	WARNING	Thrown Objects
16.	1458392	2	REFLECT	Red Reflector
17.	999001	1	WARNING	Multi-Hazard
18.	00725746	1	PELIGRO	Spanish Translation
19.	00776031	1	_____	Canister
20.	50068770C	1	_____	Operator's Manual
21.	10058000	3	_____	Bolt
22.	00024100	3	_____	Flatwasher
23.	02959924	3	_____	Locknut
24.	D301	2	LOGO	Rhino Name Logo

\* Furnished by tractor manufacturer.

# SAFETY

## Decal Description

For safety and to guarantee optimum product reliability always use genuine RHINO replacement parts.

P/N 00760657



WARNING! Speed Restriction.

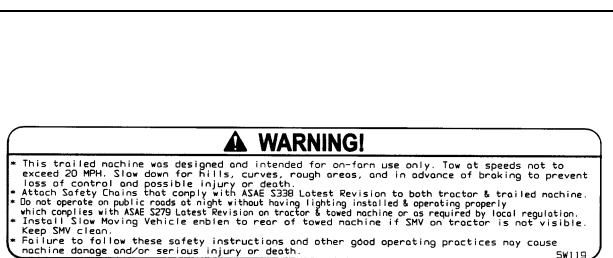

P/N 5W119

Operator's Manual (with repair parts) and warranty was attached to this implement during final inspection.



P/N 00763977

WARNING!- Multiple Hazard and General Safety



P/N 999200

SAFETY

# SAFETY

## SAFETY

Logo Product Name: Rhino



P/N D302

WARNING! Pinch Points



P/N 02962764

Yellow Reflectors

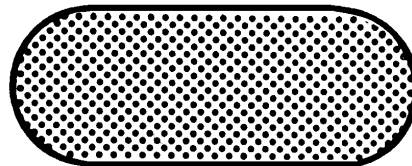

P/N 2738333

DANGER! Crushing and Pinch Points.

Moving machinery parts can pinch or crush or fall-which may cause injury or death.

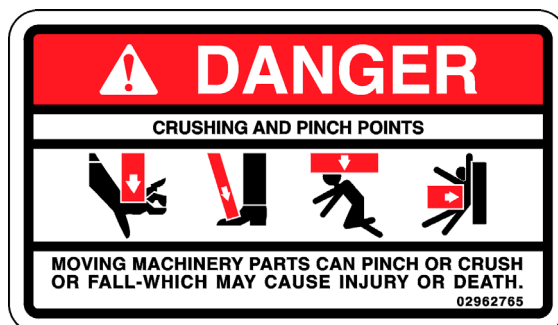

P/N 02962765

# SAFETY

Slow Moving Vehicle Decal. Keep SMV reflector clean and visible. DO NOT transport or operate without the SMV.

P/N 03200347

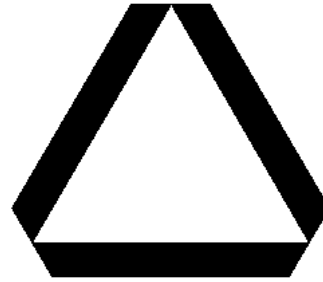

**WARNING! - DO NOT** operate with oil leaks.

-Inspect hoses regularly. Failure to inspect and replace worn hoses may allow them to rupture suddenly and violently, resulting in serious bodily injury or death from scalding, fire burn injury, or oil penetration.

-Frayed, torn or crimped hoses may rupture and spray hot oil on operator causing serious injury. Oil may spray on hot tractor parts and catch fire resulting in severe injury, burn or death.

-To check for hose leak, shut tractor off and remove hydraulic pressure. Never use hands to check for leaks.

-Wear safety glasses, oil, impenetrable gloves, and use cardboard to check for evidence of oil leaks. If you suspect a leak, remove the hose and have it tested at a dealer.

**KEEP SHIELDS IN PLACE OVER HYDRAULIC COMPONENTS.** Do not operate equipment if shields are missing or if oil leaks exist.

-Repair or replace hoses as needed to prevent unexpected failure and possible serious injury to operator or bystander. If oil penetrates skin, serious injury or gangrene could occur. A doctor familiar with this type of injury must surgically remove the injected fluid immediately.

P/N 52740

**WARNING! Transport.**

P/N 3668308



## **WARNING**

- \* Never transport equipment without correctly installing transport lock. See operators manual for correct installation.
- \* Failure to properly install transport lock arms could result in equipment damage, serious injury or death.

3668308

**SAFETY**

# SAFETY

## SAFETY

Amber Reflector. Keep reflectors clean and visible.



P/N 1458393

WARNING-Stored Energy Hazard

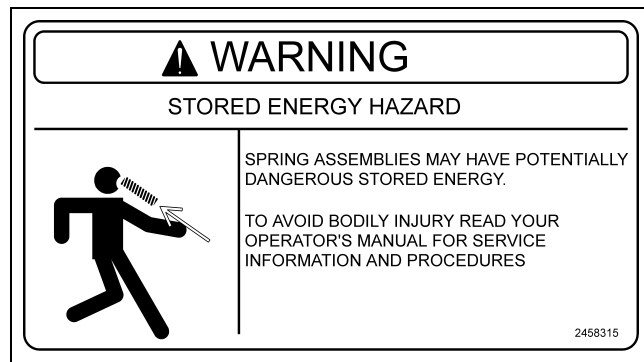

P/N 2458315

Red Reflector. Keep reflectors clean and visible.



P/N 1458392

WARNING! Tractor rearing

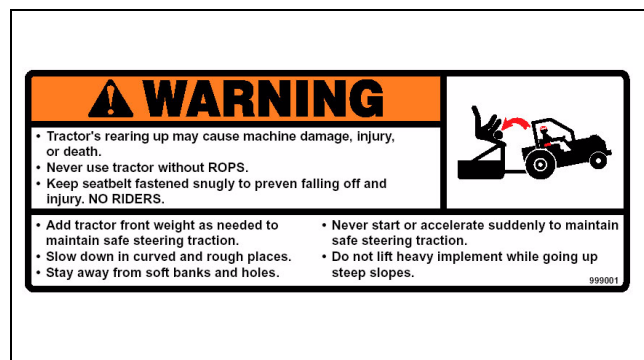

P/N 999001

# SAFETY

Peligro Translation, If you do not know how to read English, please find someone who knows how to read English.

P/N 00725746



Read Operator's Manual! The operator's manual is located inside this canister. If the manual is missing order one from your dealer.

P/N 00776031

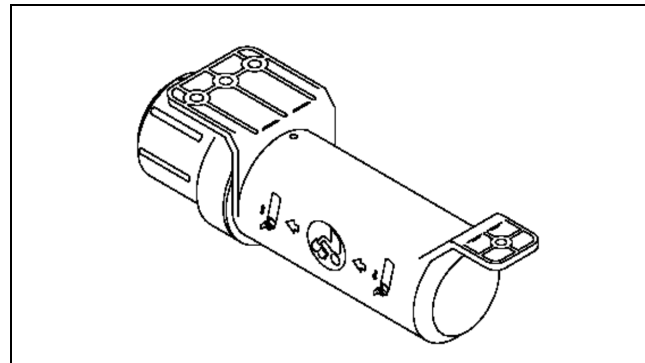

RHINO LOGO



P/N D301

SAFETY

# SAFETY

## SAFETY

### Federal Laws and Regulations

This section is intended to explain in broad terms the concept and effect of federal laws and regulations concerning employer and employee equipment operators. This section is not intended as a legal interpretation of the law and should not be considered as such.

#### Employer-Employee Operator Regulations

U.S. Public Law 91-596 (The Williams-Steiger Occupational and Health Act of 1970) OSHA

##### This Act Seeks:

“...to assure so far as possible every working man and woman in the nation safe and healthful working conditions and to preserve our human resources...”

#### DUTIES

Sec. 5 (a) Each employer-

- (1) shall furnish to each of his employees employment and a place of employment which are free from recognized hazards that are causing or are likely to cause death or serious physical harm to his employees;
- (2) shall comply with occupational safety and health standards promulgated under this Act.
- (b) Each employee shall comply with occupational safety and health standards and all rules, regulations and orders issued pursuant to this Act which are applicable to his own actions and conduct.

#### OSHA Training Requirements

**Title 29, Code of Federal Regulations Part 1928.57(a)(6). [www.osha.gov](http://www.osha.gov)**

Operator instructions. At the time of initial assignment and at least annually thereafter, the employer shall instruct every employee who operates an agricultural tractor and implements in the safe operating practices and servicing of equipment with which they are or will be involved, and of any other practices dictated by the work environment.

Keep all guards in place when the machine is in operation;

Permit no riders on equipment

Stop engine, disconnect the power source, and wait for all machine movement to stop before servicing, adjusting, cleaning or unclogging the equipment, except where the machine must be running to be properly serviced or maintained, in which case the employer shall instruct employees as to all steps and procedures which are necessary to safely service or maintain the equipment.

Make sure everyone is clear of machinery before starting the engine, engaging power, or operating the machine.

#### Employer Responsibilities:

To ensure employee safety during Tractor and Implement operation, it is the employer's responsibility to:

1. Train the employee in the proper and safe operation of the Tractor and Implement.
2. Require that the employee read and fully understand the Tractor and Implement Operator's manual.
3. Permit only qualified and properly trained employees to operate the Tractor and Implement.
4. Maintain the Tractor and Implement in a safe operational condition and maintain all shields and guards on the equipment.
5. Ensure the Tractor is equipped with a functional ROPS and seat belt and require that the employee operator securely fasten the safety belt and operate with the ROPS in the raised position at all times.
6. Forbid the employee operator to carry additional riders on the Tractor or Implement.
7. Provide the required tools to maintain the Tractor and Implement in a good safe working condition and provide the necessary support devices to secure the equipment safely while performing repairs and service.
8. Require that the employee operator stop operation if bystanders or passersby come within 300 feet.

#### Child Labor Under 16 Years of Age

Some regulations specify that no one under the age of 16 may operate power machinery. It is your responsibility to know what these regulations are in your own area or situation. (Refer to U.S. Dept. of Labor, Employment Standard Administration, Wage & Home Division, Child Labor Bulletin #102.)

# **INTRODUCTION SECTION**

Introduction Section 2-1

# INTRODUCTION

## INTRODUCTION

This V-Rake is designed with care and built with quality materials by skilled workers. Proper assembly, maintenance, and operating practices, as described in this manual, will help the owner/operator get years of satisfactory service from the machine.

The purpose of this manual is to familiarize, instruct, and train. The Safety Section is a **MUST READ** section prior to any use of the rake. The Assembly Section instructs the owner/operator in the correct assembly of the Rake using standard and optional equipment. Careful use and timely service saves extensive repairs and costly downtime losses. The Operation Section informs the owner/operator how to work the rake and explains proper procedures and safe practices prior to and during the operation of the rake. The Trouble-Shooting Guide helps diagnose difficulties with the rake and offers solutions to the problems. The Maintenance Section instructs the owner/operator of all the necessary inspection, lubrication, general maintenance needed to insure long life and trouble free operation of your rake. The Parts Listing section is designed to familiarize the owner/operator with replaceable parts on the Rake.

Safety is of primary importance to the owner/operator and to the manufacturer. The first section of this manual includes a list of Safety Messages, that, if followed, will help protect the operator and bystanders from injury or death. Many of the Safety Messages will be repeated throughout the manual. The owner/operator/dealer should know these Safety Messages before assembly and be aware of the hazards of operating this rake during assembly, use, and maintenance. The Safety Alert Symbol combined with a Signal Word, as seen below, is intended to warn the owner/operator of impending hazards and the degree of possible injury faced when operating this machine.



Indicates an imminently hazardous situation that, if not avoided, **WILL** result in **DEATH OR VERY SERIOUS INJURY**.



Indicates an imminently hazardous situation that, if not avoided, **COULD** result in **DEATH OR SERIOUS INJURY**.



Indicates an imminently hazardous situation that, if not avoided, **MAY** result in **MINOR INJURY**.



Identifies special instructions or procedures that, if not strictly observed, could result in damage to, or destruction of the machine, attachments or the environment.

# INTRODUCTION



INTRODUCTION

The Rhino VR8/10/12 V-Rakes provide the best of both worlds; clean efficient raking and budget-minded price. In maximum working widths of 19' VR8, 22' VR10 and 25'7" for the VR12 rake make fast work of big jobs. With a reasonable amount of preventive maintenance, your Rake will provide years of dependable service.

The front, rear, left, and right are determined by the normal direction of travel, the same as driving an automobile.

# INTRODUCTION

## INTRODUCTION

### Attention Owner/Operator

BEFORE OPERATING THIS MACHINE:

1. Carefully read the Operator's Manual, completely understand the Safety Messages and instructions, and know how to operate correctly both the tractor and mower.
2. Fill out the Warranty Card in full. Be sure to answer all questions, including the Serial Number of the Mower. Mail within 30 days of delivery date of this implement.

**NOTE:** Warranties are honored only if completed "Owner Registration and Warranty" forms are received by Alamo Group within thirty days of delivery of the implement.

3. Record the Mower Model and Serial Numbers on the Warranty page at the front of the Operator's Manual. Keep this as part of the permanent maintenance file for the Mower.

## IMPORTANT

For your safety and to guarantee optimum product reliability, always use Genuine RHINO replacement parts. The use of inferior "will-fit" parts will void Warranty of your RHINO implement and may cause premature or catastrophic failure which can result in serious injury or death. If you have any questions concerning the repair parts you are using, contact Rhino, 1020 S. Sangamon Ave., Gibson City, Illinois 60936 A Member of Alamo Group



# **ASSEMBLY SECTION**

Assembly Section 3-1

# ASSEMBLY

## GENERAL INSTRUCTIONS

Assembly must be done carefully and accurately, for the safety of the person(s) doing the assembling and to ensure proper machine operation.

Assembly should be done on a flat, solid surface, using the proper tools and wearing suitable clothing, making sure that all people not involved in the assembly be kept at a safe distance.

Assemblers must provide suitable lifting mechanisms and supports for stabilizing the partially assembled units, so as to prevent them from falling and causing damage or injury.

The steps for assembly are illustrated in following. Depending on the experience of the assemblers and the tools available, it is not necessary that the instructions be followed in the exact order given here, but the safety precautions described above must always be followed carefully and scrupulously.



**WARNING**

Before beginning operations, read the instruction manual carefully.



**WARNING**

Before doing any maintenance or repair work, stop the machine at a suitable spot. Turn off the tractor engine, apply the brake, remove the key from the ignition and consult this manual.



**WARNING**

This is a warning to use proper accident protection when carrying out maintenance and repairs.



**WARNING**

Indicates an impending dangerous situation which, if not avoided, will cause death or severe personal injury.



**WARNING**

Indicates a potentially dangerous situation which, if not avoided, could cause death or severe personal injury, including dangers which are present when protection is removed.



**WARNING**

Indicates a potentially dangerous situation which, if not avoided, can provoke less severe or minor injuries.



## WARNING

### TO AVOID SERIOUS INJURY OR DEATH:

1. READ AND UNDERSTAND OPERATOR'S MANUAL.
2. TRACTOR MUST BE EQUIPPED WITH ROLL-OVER PROTECTION (ROPS) AND SWAY CHAINS.
3. ALWAYS WEAR SAFETY GLASSES, SAFETY SHOES AND SEAT BELT FASTENED TIGHTLY.
4. STOP TRACTOR, LOCK BRAKES, AND BLOCK UP OR SUPPORT IMPLEMENT SECURELY BEFORE WORKING UNDER RAISED COMPONENTS.
5. ALLOW NO RIDERS AT ANY TIME ON TRACTOR OR IMPLEMENT. FALLING OFF CAN KILL.
6. KEEP BYSTANDERS CLEAR OF MOVING PARTS AND WORKING AREA. KEEP CHILDREN AWAY!
7. DO NOT LIFT, LOWER, OR OPERATE UNLESS EVERYONE IS CLEAR OF IMPLEMENT.
8. USE INCREASED CAUTION ON SLOPES & NEAR BANKS AND DITCHES TO PREVENT OVERTURN.
9. LOCK LIFT LEVER UP FOR TRANSPORT. HAVE SMV SIGN VISIBLE. FOLLOW LOCAL LAWS.
10. USE PARKING STAND OR BLOCK UP WHEN UNHITCHING FROM TRACTOR.

999200

# ASSEMBLY

## ASSEMBLY INSTRUCTIONS

1. Mount wheels (2) to hubs on frame (1) using special nuts (3). The spherical side "A" off the nut (3) must be always turned towards the wheel rim flange. The forks (4) of a forklift may also be used to support the assembly.

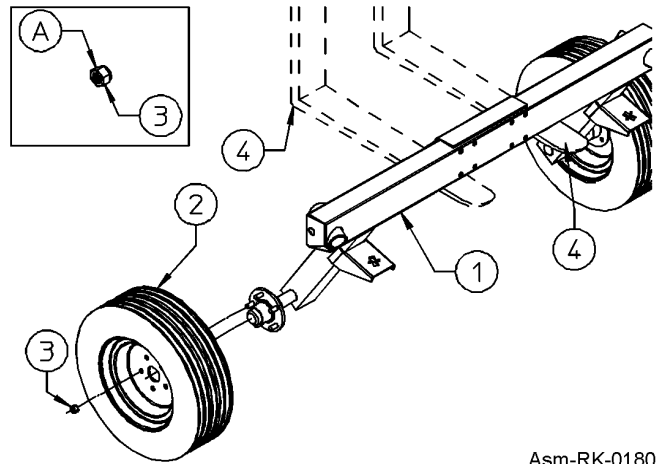

Asm-RK-0180

2. Attach the drawbar (2) to the frame (1) and fastening it with screws (5) and nuts (3).

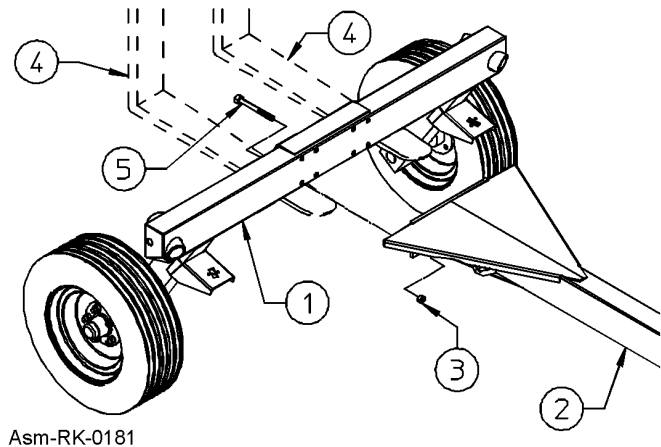

Asm-RK-0181

ASSEMBLY

# ASSEMBLY

## ASSEMBLY

3. Attach the drawbar (1) to the drawbar (2) and fastening it with screws (3) and nuts (4). Attach the tractor hitch (5) to the drawbar (1) using the two pins (6), fastening with the screws (8) and washers (7). To choose which should be used see ADJUSTMENTS FOR MACHINE USE. Attach parking stand (9) to drawbar (1), fastening it with pin (10) and clip (11). Assemble the support hose (12) with the screw (14), washer (13) and nut (15).

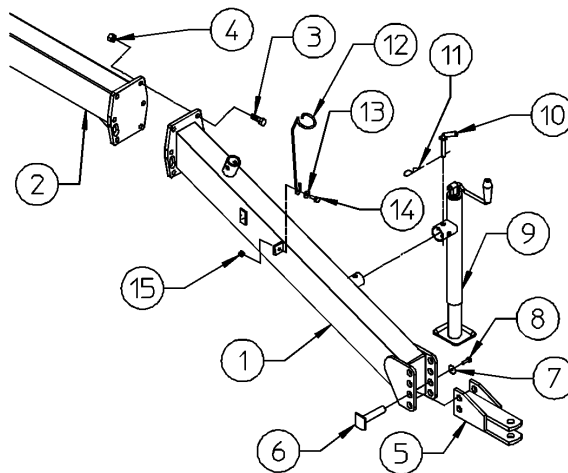

Asm-RK-0183

4. **For VR 12 Only** - Insert and attach the drawbar extension (2) and fastening it with screws (4) and nuts (5).

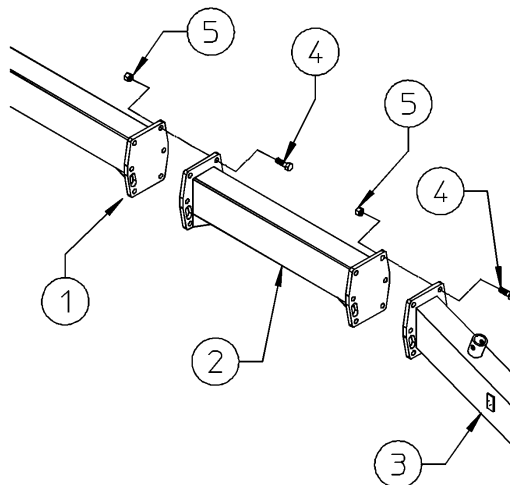

Asm-RK-0184-A

# ASSEMBLY

5. Fit bushings (6) on proper seats of frame (1). Fit in proper seats grease nipple (5). Attach the arm (2) (R.H.-L.H.) to the frame (1) using pins (3). Fasten pins (3) with spring pins (4).

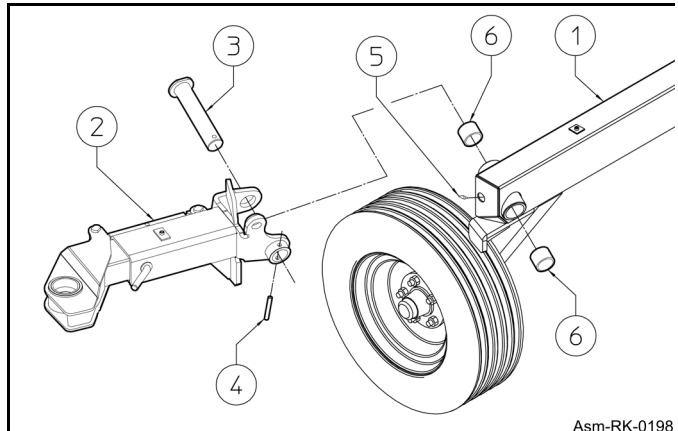

6. Attach the cylinders (2) to the lugs using pins (3) and split pins (5). Assemble the cylinders with distance washers (4) as shown in diagram.

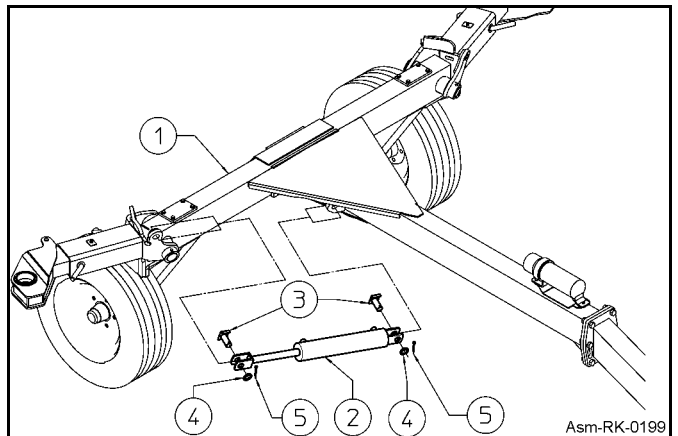

7. **For VR-8** -Attach the main pipe (1) to arm(13) using pin (10) washer (9)(11), screw (8) and nut (12). Insert pipe (2) to the main pipe (1), fastening it with the screws (3), and (4) washers (5) and nut (6). Insert plug (7) to main pipe (1)(2).

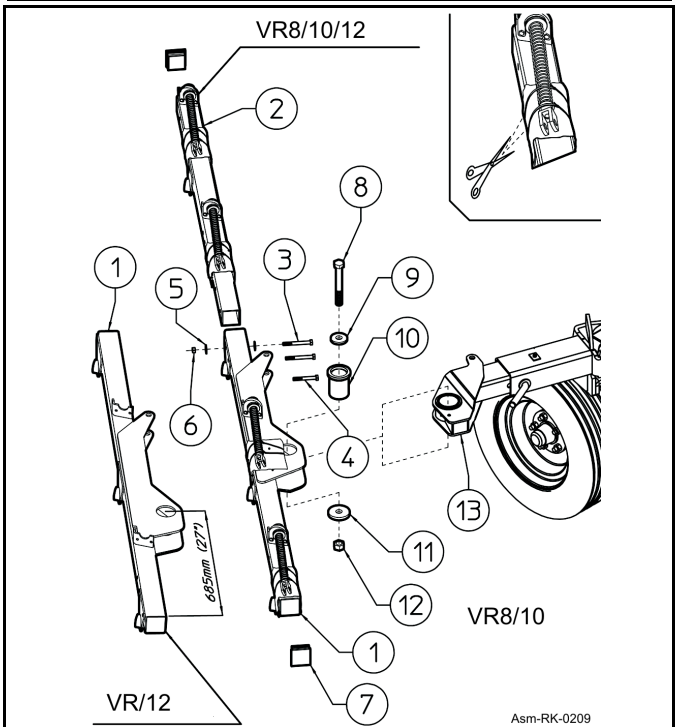

# ASSEMBLY

## ASSEMBLY

8. For VR-10 & VR-12 - Insert pipe (1) to the main pipe (2), fastening it with the screws (3), washers (5) and nuts (6). Insert plug to main pipe (1).

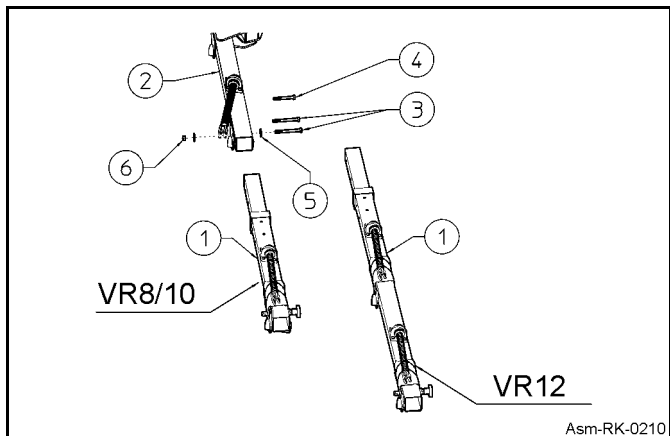

9. Attach the manual angle tie-rod (1) at the two points (A) and (B), the rear end (C) at point (A) and the front end (D) at point (B), using the pins (3), bushes (2), washers (4) and nuts (5). Insert pin (6) into the holes to choose the desired angle. Fasten with the clip (7). OPTIONAL To mount the cylinder (8) for hydraulic opening, the tie-rod (1) must be removed, then add two bushes (2) and reuse the pins (3), bushes (2), washers (4) and nuts (5) used previously. To connect the hoses, see the section ADJUSTMENTS FOR MACHINE USE.

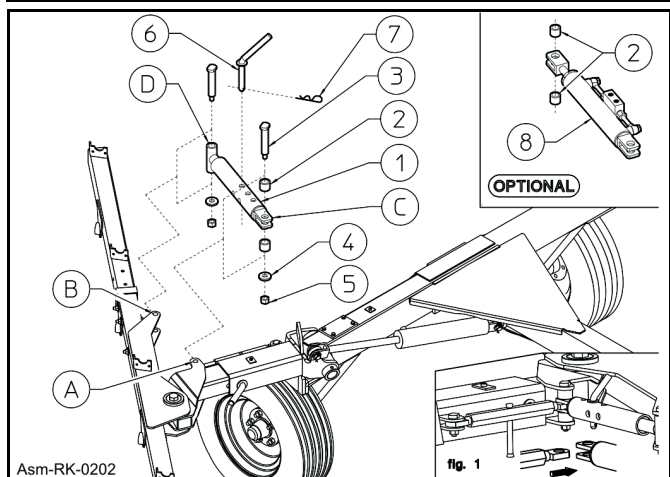

10. Insert the bushing (2) in section (A), then insert the arm (1) and fasten with washer (3) and pin (4).

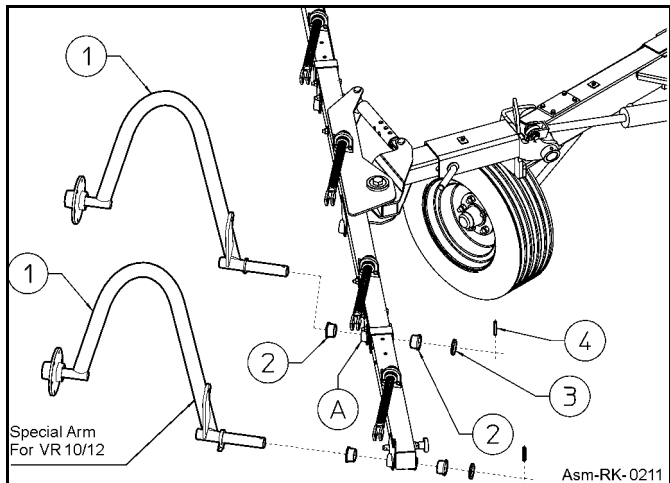

# ASSEMBLY

11. Attach the spring assembly (A) to the arm (B) using the automatic fastening pin (1). To fasten the pin in place, insert it into the fork and rotate it until it clips in place (fig. 1)

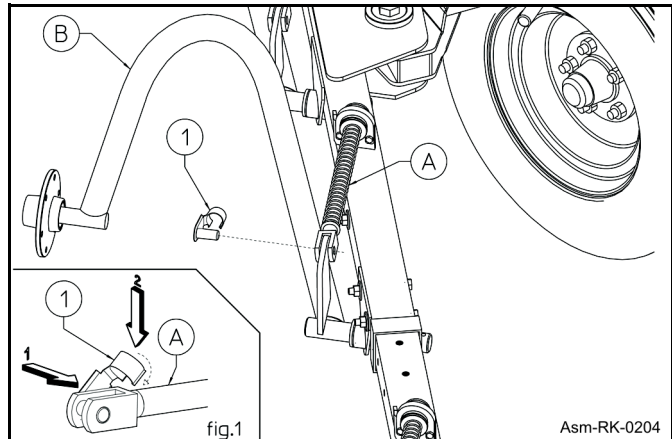

12. Attach the rake wheels (1) to the hubs (A) using screws (2), washers (3) and nuts (2).

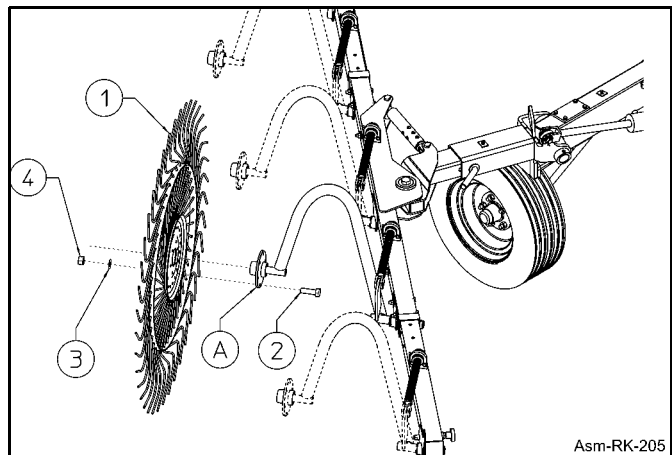

13. To lock the arm in the raised position, the spring assembly (B) must be released by sliding out the pin and hooking it onto the support (C). Then manually lift the arm (A), pull out the spring pin (D) and leave it at the hole on the arm bracket.

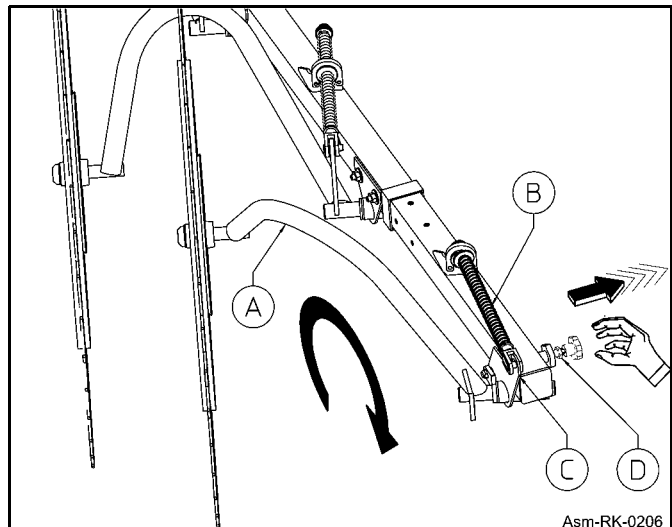

# ASSEMBLY

## Hydraulic System Assembly

Assemble the cylinders and the hydraulic system as shown. When using for the first time, make sure there are no oil leaks. If there should be any, tighten the fittings.

Attach the nipples (14) at valve (13) with washer (10) and connect this at reducer nipples (12) and fittings (9). Connect the fitting hole (9) with washer (10) and fitting screw (11) on cylinders (21). Connect hose (5) and (6) at fitting (14) and union T (15). Connect eye-ring end of pipes (7) – (8) to the other side cylinders (21) and the rotating female ends on the other union T (15). Connect the rotating female ends of hoses (3) – (4) to union T (15). Place washers (2) and connect the quick-release coupling (1) to the straight male ends of pipes (3) – (4). Check to make sure that all connections are correctly fastened. Attach the hose collar (16) and (19) to the lugs on drawbar, fastening on correctly position (see shown)

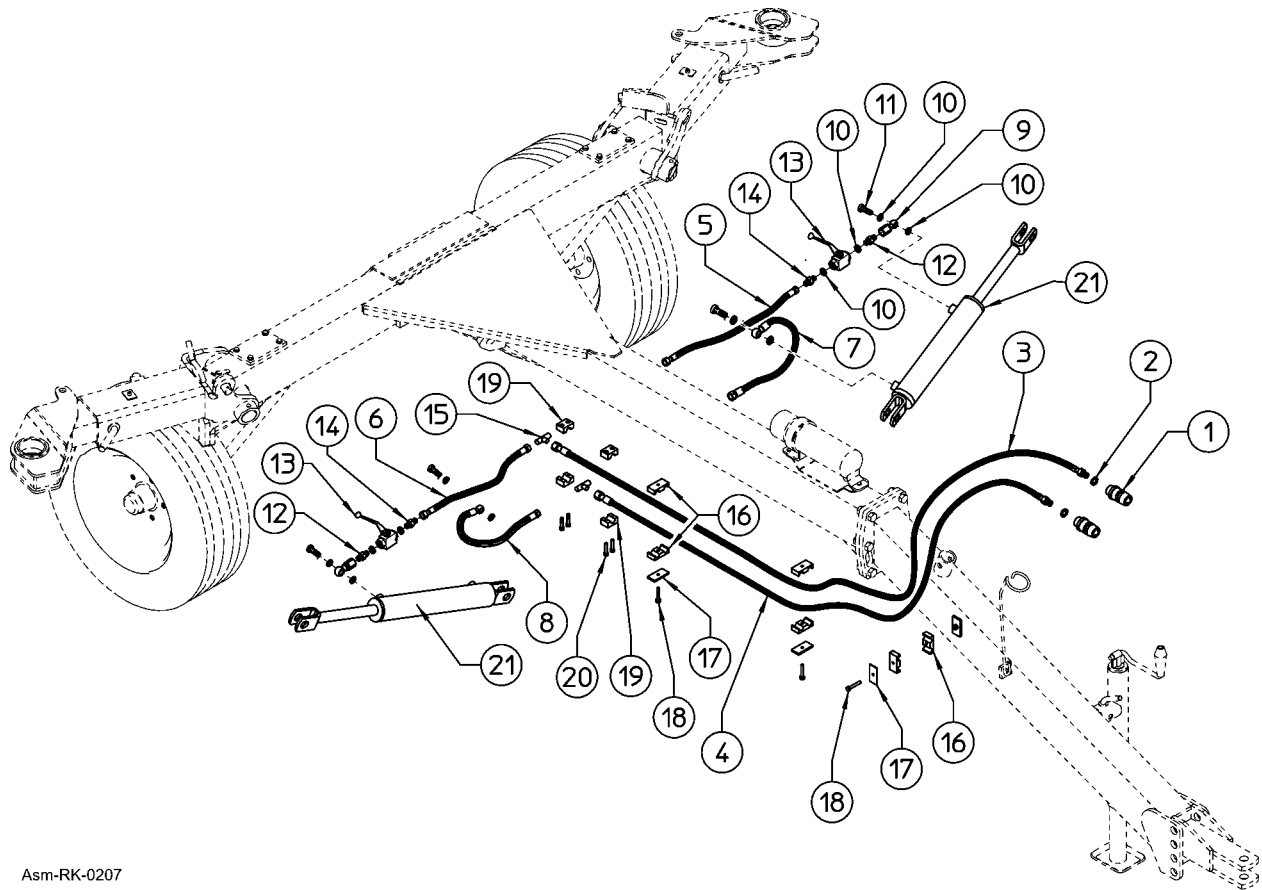

Asm-RK-0207

# ASSEMBLY

## ASSEMBLY

### Optional Center Rake Wheel Kit (3690405)

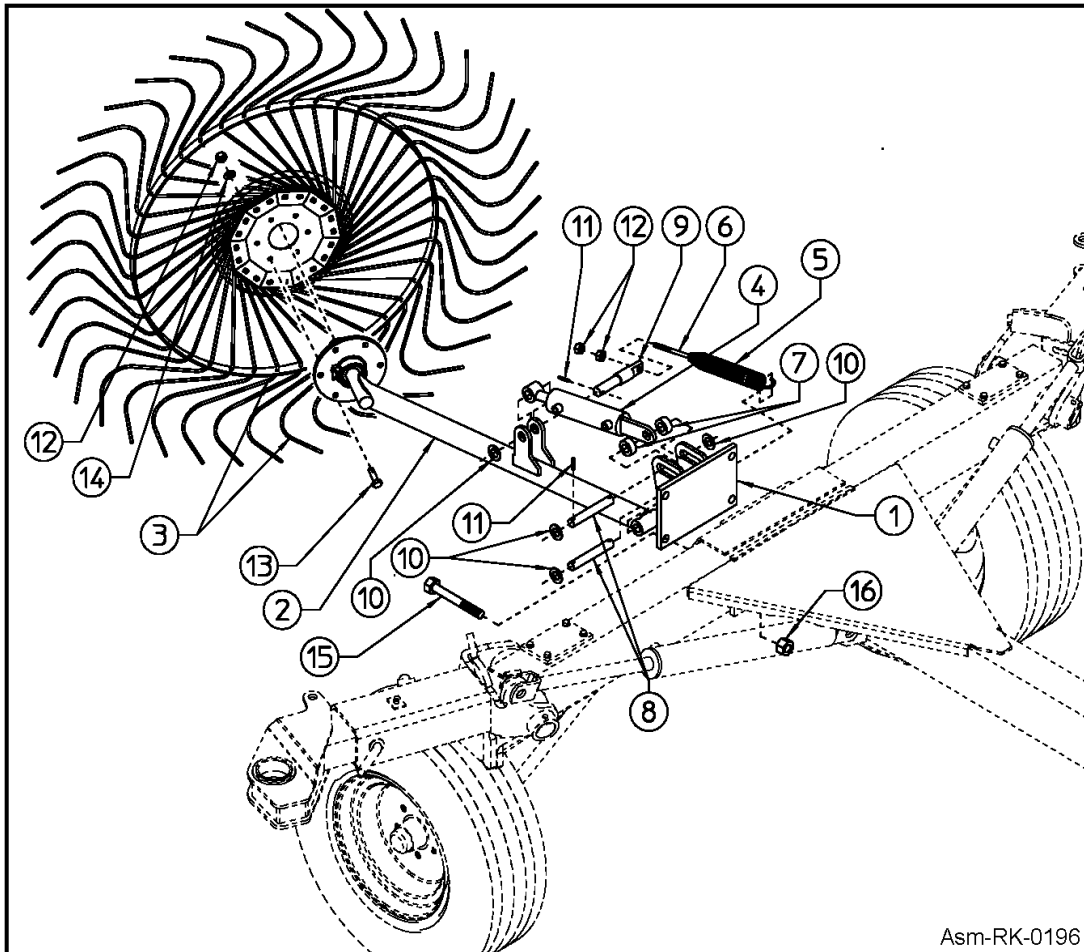

To assemble the Center Rake Wheel Kit, proceed as follows:

Remove the four central screws that connect the horizontal drawbar to the main frame and attach plate (1) using 4 long screws (15) that are supplied and nuts (16). Assemble arm (2) and hydraulic cylinder (4) to plate (1) using the two arm support pins (8), washers (10) and spring pins (11). Connect the arm and cylinder with the milled pin (9), the washer (10) and the spring pin (11). Attach the spring (5) first with hook in the hole in plate (1) and then screw (6) in hole in pin (9). Tighten nuts (12) on screw, letting a few millimeters (1/8") protrude. The spring tension must be adjusted later according to the desired pressure of the rake wheel on the ground. Attach rake wheel (3) to the arm (2) using screws (13), washers (14) and nuts (12).



Assembly must be done carefully and accurately, for the safety of the person(s) doing the assembling and to ensure proper machine operation. Assembly should be done on a flat, solid surface, using the proper tools and wearing suitable clothing, making sure that all people not involved in the assembly be kept at a safe distance. Assemblers must provide suitable lifting mechanisms and supports for stabilizing the partially assembled units, so as to prevent them from falling and causing damage or injury.

# ASSEMBLY

## ASSEMBLY

Assembly of hydraulic system for center rake wheel kit.

**Attention:** before proceeding check to make sure the hydraulic circuit is not under pressure. Wear individual protective devices (gloves, safety goggles, etc.). When loosening the fittings work carefully and cautiously. Remove the tee fittings (13) found and replace them with the crosses (45). Attach fitting 49 on relevant cylinder's base hitch through copper washers 50 and screw 51. In this phase do not tighten completely screw 51. Fit nipple 48 to fitting 49. In this phase do not tighten completely nipple 48. Attach female side 1/4" of short hose 47 to fitting 45 and female side 3/8" to nipple 48. Now position correctly hose 47 so that it does not suffer deformations or crushing during cylinder working phase. Once this is done, tighten all fittings which were previously left loose.

Attach fitting 52 to relevant hitch on rod's side of cylinder together with copper washer 50. Fit to tap 55 the nipple 53 with copper washer 54. Fit tap 55, copper washer 54 and nipple 53 to rotating fitting 52. Position the tap 55 opening lever up so that use is easy and does not interfere with anything else. Fit female side 1/4" of long hose 46 to fitting 45 and eye side 1/4" to tap 55 through copper washers 54 and screw 56. In this phase do not tighten completely screw 56.

Now position correctly hose 46 so that it does not suffer deformations or crushing during cylinder's working, then, tighten completely screw 56. The center rake wheel kit must be used to move the product to be raked into the center area before forming the swath. The hydraulic cylinder is operated in parallel with the rake arms and therefore no additional operations are required. The center rake wheel normally moves very fast; this does not mean it is not working properly. The compensating spring must be adjusted with the two nuts on the screw so as to obtain the right ground pressure according to the desired working conditions.

Tighten the nut to decrease ground pressure. Loosen the nut to increase ground pressure. If the raking conditions do not require the use of the center rake wheel the tap (55) makes it possible to keep the arm from lowering. To lock out the central wheel kit: Activate the tractor hydraulics and raise the rake arms until they reach the stops. Stop the tractor engine and remove the key. Wait until all moving parts have stopped. Close the tap (55) at the rear of the rake.

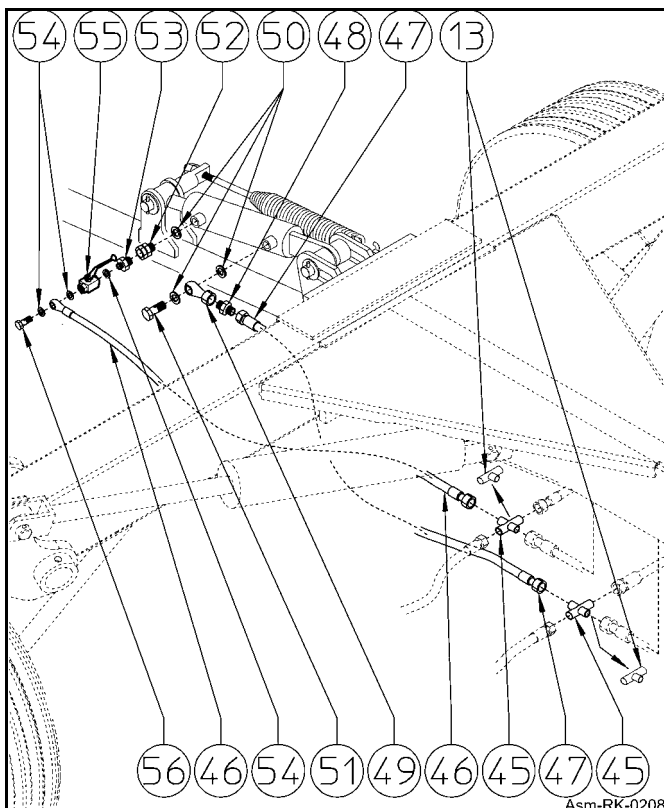

## ASSEMBLY

### Finger Wheel Wind Covers - Optional

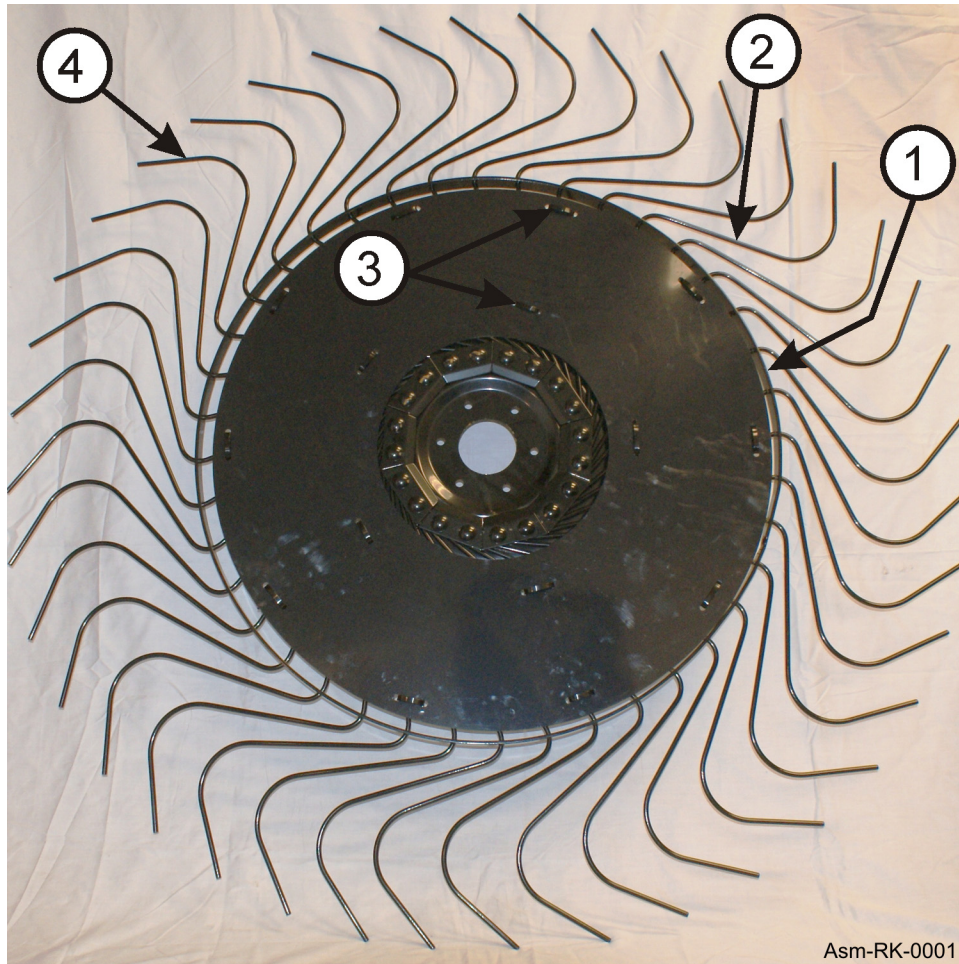

To help prevent long hay stems from getting wrapped up in the rake wheels, install the optional wheel wind covers to the rake wheels.

Start by placing the Wheel Wind Cover (1) to Rake Wheel (2) and fasten to rake wheel with Tie(s) (3) using the drilled holes on Wheel Wind Cover to attach to rake wheel fingers(4).(**Refer to Figure Asm-RK-0001**)



# OPERATION SECTION

Operation Section 4-1

# OPERATION

## VR V-RAKE OPERATION INSTRUCTIONS

Rhino V-rakes are manufactured with quality material by skilled workers.

It is the operator's responsibility to be knowledgeable of all potential operating hazards and to take every reasonable precaution to ensure oneself, others, animals, and property are not injured or damaged by the hay rake, tractor, or a thrown object. Do not operate the rake if passersby, pets, livestock, or property are directly in front or to the rear of the unit.

This section is designed to familiarize, instruct, and educate safe and proper rake use to the operator. Pictures in this section are for the purpose of explaining the operation of a rake and are not necessarily of a VR rakes. Some pictures may show shields removed for purposes of clarity. **NEVER OPERATE** this implement without all shields in place and in good operational condition. The operator must be familiar with rake and tractor operation and all associated safety practices before operating the rake and tractor. Proper operation of the VR rake, as detailed in this manual, will help ensure years of safe and satisfactory use of the implement.

**IMPORTANT:** To avoid rake damage, retorquing all bolts after the first 10 hours of operation.

**READ AND UNDERSTAND THE ENTIRE OPERATING INSTRUCTIONS AND SAFETY SECTION OF THIS MANUAL AND THE TRACTOR MANUAL BEFORE ATTEMPTING TO USE THE TRACTOR AND IMPLEMENT.** If you do not understand any of the instructions, contact your nearest authorized dealer for a full explanation. Pay close attention to all safety signs and safety messages contained in this manual and those affixed to the implement and tractor. *OPS-U- 0001*

READ, UNDERSTAND, and FOLLOW the following Safety Messages. Serious injury or death may occur unless care is taken to follow the warnings and instructions stated in the Safety Messages. Always use good common sense to avoid hazards. (SG-2)



Si no lee ingles, pida ayuda a alguien que si lo lea para que le traduzca las medidas de seguridad. (SG-3)

**SAFETY  
INSTRUCTIONS**



**¡ LEA EL  
INSTRUCTIVO!**



# OPERATION

## OPERATION

### 1. Standard Equipment and Specifications

	<u>VR 8</u>	<u>VR 10</u>	<u>VR 12</u>
Number of Finger Wheels	8	10	12
Overall Length (A)*	19'	19'	22'
Minimum Transport Height (B)	7'-9"	7'-9"	7'-9"
Transport Width (C)	8'-5"	8'-5"	8'-5"
Width (D)	6'-6"	6'-6"	6'-6"
Minimum Working Width (E)*	16'-4"	19'	21'-8"
Maximum Working Width *	19'	22"	25'-7"
Minimum Windrow Width (F)*	3'	3'	3'
Maximum Windrow Width *	6'-7"	6'-7"	6'-7"
Weight	1530 lbs	1630 lbs	1830 lbs
Tires	205-75/15	205-75/15	205-75/15P
Tractor Horse Power	30 HP	30 HP	50hp

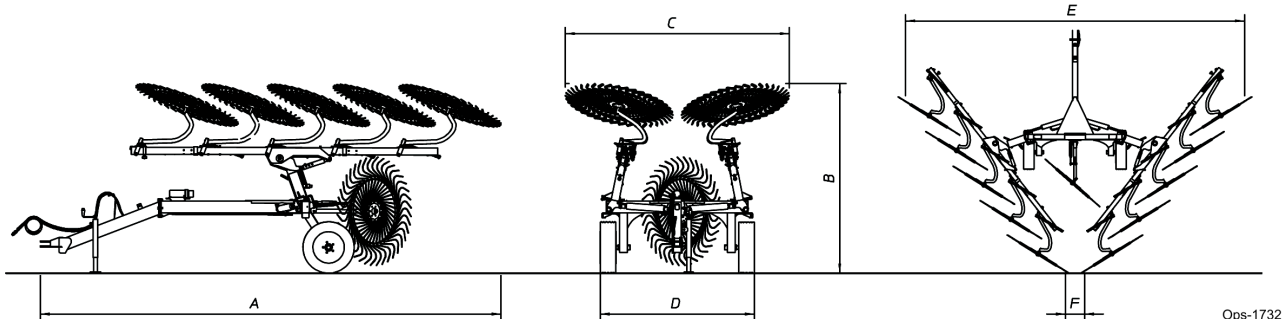

Ops-1732

# OPERATION

## OPERATION

### 2. OPERATOR REQUIREMENTS

Safe operation of the unit is the responsibility of a qualified operator. A qualified operator has read and understands the implement and tractor Operator's Manuals and is experienced in implement and tractor operation and all associated safety practices. In addition to the safety messages contained in this manual, safety signs are affixed to the implement and tractor. If any part of the operation and safe use of this equipment is not completely understood, consult an authorized dealer for a complete explanation.

If the operator cannot read the manuals for themselves or does not completely understand the operation of the equipment, it is the responsibility of the supervisor to read and explain the manuals, safety practices, and operating instructions to the operator.

Safe operation of equipment requires that the operator wear approved Personal Protective Equipment (PPE) for the job conditions when attaching, operating, servicing, and repairing the equipment. PPE is designed to provide operator protection and includes the following safety wear:

#### **PERSONAL PROTECTIVE EQUIPMENT (PPE)**

- Always Wear Safety Glasses
- Hard Hat
- Steel Toe Safety Footwear
- Gloves
- Hearing Protection
- Close Fitting Clothing
- Respirator or Filter Mask (depends on operating conditions) OPS-U- 0002

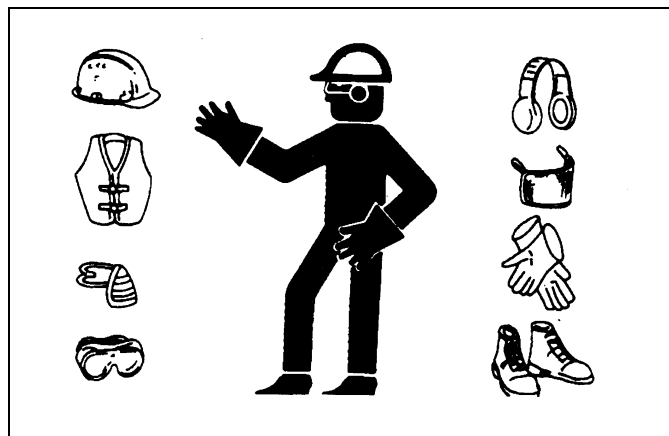

#### **⚠ DANGER**

DO NOT use drugs or alcohol immediately before or while operating the Tractor and Implement. Drugs and alcohol will affect an operator's alertness and coordination and therefore affect the operator's ability to operate the equipment safely. Before operating the Tractor or Implement, an operator on prescription or over-the-counter medication must consult a medical professional regarding any side effects of the medication that would hinder their ability to operate the Equipment safely. NEVER knowingly allow anyone to operate this equipment when their alertness or coordination is impaired. Serious injury or death to the operator or others could result if the operator is under the influence of drugs or alcohol. (SG-27)

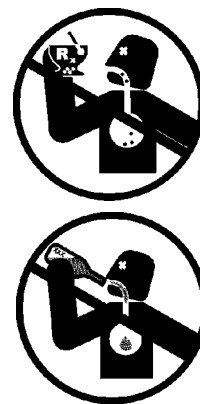

#### TRACTOR REQUIREMENTS

# OPERATION

The tractor used to operate the implement must have the power capacity to lift, pull, and operate the Power Take Off (PTO) at the implement's rated speed while traveling at a ground speed between 2 and 5 MPH. Operating the implement with a tractor that does not meet the following requirements may cause tractor or implement damage and be a potential danger to the operator and passersby.

## **Tractor Requirements and Capabilities**

- ASABE approved Roll-Over Protective Structure (ROPS) or ROPS cab and seat belt.
- Tractor Safety Devices ..... Slow Moving Vehicle (SMV) emblem, lighting, PTO master shield
- Tractor Horsepower-Minimum ..... VR8/VR10 - 30HP, VR12 - 50HP

### **2.1 ROPS and Seat Belt**

The tractor must be equipped with a Roll-Over-Protective-Structure (ROPS) (tractor cab or roll-bar) and seat belt to protect the operator from falling off the tractor, especially during a roll over where the driver could be crushed and killed. Only operate the tractor with the ROPS in the raised position and seat belt fastened. Tractor models not equipped with a ROPS and seat belt should have these life saving features installed by an authorized dealer. OPS-U- 0003



Operate this Equipment only with a Tractor equipped with an approved roll-over-protective system (ROPS). Always wear seat belts. Serious injury or even death could result from falling off the tractor--particularly during a turnover when the operator could be pinned under the ROPS. (SG-7)



### **2.2 Tractor Safety Devices**

If transporting or operating the tractor and implement near a public roadway, the tractor must be equipped with proper warning lighting and a Slow Moving Vehicle (SMV) emblem which are clearly visible from the rear of the unit. Lights and a SMV emblem must be equipped directly on implements if the visibility of the tractor warning signals are obscured.

Maintain all manufacturer equipped safety shields and guards. Always replace shields and guards that were removed for access to connect, service, or repair the tractor or implement. Never operate the tractor PTO with the PTO master shield missing or in the raised position. OPS-U- 0004

### **2.3 Tractor Horsepower**

The horsepower required to operate the rake depends on many factors including type of vegetation to be raked, terrain condition, operator experience, and condition of the implement and tractor. For most raking condition, the VR10 rakes require a tractor with at least 30 HP and the VR12 50HP. Operating the implement with a tractor that does not have adequate power may damage the tractor engine.

## **3. GETTING ON AND OFF THE TRACTOR**

Before getting onto the tractor, the operator must read and completely understand the implement and tractor operator manuals. If any part of either manual is not completely understood, consult an authorized dealer for a complete explanation. OPS-U- 0007

# OPERATION



## WARNING

Do not mount or dismount the Tractor while the tractor is moving. Mount the Tractor only when the Tractor and all moving parts are completely stopped. (SG-12)



### 3.1 Boarding the Tractor

Use both hands and equipped handrails and steps for support when boarding the tractor. Never use control levers for support when mounting the tractor. Seat yourself in the operator's seat and secure the seat belt around you.

Never allow passengers to ride on the tractor or attached equipment. Riders can easily fall off and be seriously injured or killed from falling off and being ran over. It is the operator's responsibility to forbid all extra riders at all times. OPS-U- 0008



## DANGER

Never allow children to operate, ride on, or come close to the Tractor or Implement. Usually, 16-17 year-old children who are mature and responsible can operate the implement with adult supervision, if they have read and understand the Operator's Manuals, been trained in proper operation of the tractor and Implement, and are physically large enough to reach and operate the controls easily. (SG-11)



## DANGER

Never allow children or other persons to ride on the Tractor or Implement. Falling off can result in serious injury or death. (SG-10)



### 3.2 Dismounting the Tractor

Before dismounting, park the tractor and implement on a reasonably level surface, apply the parking brake, idle the engine down, disengage the PTO, and lower the implement to the ground. Shut down the tractor engine according to the operator's manual, remove the key, and wait for all motion to completely stop. Never leave the seat until the tractor, its engine and all moving parts have come to a complete stop.

Use hand rails and steps when exiting the tractor. Be careful of your step and use extra caution when mud, ice, snow or other matter has accumulated on the steps or hand rails. Use all handrails and steps for support and never rush or jump off the tractor. OPS-U- 0009

# OPERATION

## OPERATION

### **4. STARTING THE TRACTOR**

The operator must have a complete understanding of the placement, function, and operational use of all tractor controls before starting the tractor. Review the tractor operator's manual and consult an authorized dealer for tractor operation instructions if needed.

#### **Essential Tractor Controls:**

- Locate the light control switch.
- Locate the engine shut off control.
- Locate the brake pedals and the clutch.
- Locate the PTO control.
- Locate the 3-point hitch control lever.
- Locate the hydraulic remote control levers.

#### **Before starting the tractor ensure the following:**

- Conduct all pre-start operation inspection and service according to the tractor operator's manual.
- Make sure all guards, shields, and other safety devices are securely in place.
- The parking brake is on.
- The PTO control lever is disengaged.
- The 3-point hitch control lever is in the lowered position.
- The hydraulic remote control levers are in the neutral position.
- The tractor transmission levers are in park or neutral.

Refer to the tractor owner's manual for tractor starting procedures. Only start the tractor while seated and belted in the tractor operator's seat. Never bypass the ignition switch by short circuiting the starter solenoid.

After the tractor engine is running, avoid accidental contact with the tractor transmission to prevent sudden and unexpected tractor movement. *OPS-U-0028*



Never run the Tractor engine in a closed building or without adequate ventilation. The exhaust fumes can be hazardous to your health. (SG-23)



Start tractor only when properly seated in the Tractor seat. Starting a tractor in gear can result in injury or death. Read the Tractor operators manual for proper starting instructions. (SG-13)



### **5. CONNECTING THE IMPLEMENT TO THE TRACTOR**

Use extreme caution when connecting the implement to the tractor. The implement should be securely resting at ground level or setting on blocks. Keep hands and feet from under the implement and clear of pinch points between the tractor hitch arms and implement pins. *OPS-U-0038*



Always shut the Tractor completely down, place the transmission in park, and set the parking brake before you or anyone else attempts to connect or disconnect the Implement and Tractor hitches. (S3PT-15)

# OPERATION

## OPERATION

### 6. SETTING THE IMPLEMENT

#### 6.1 Attaching the Implement

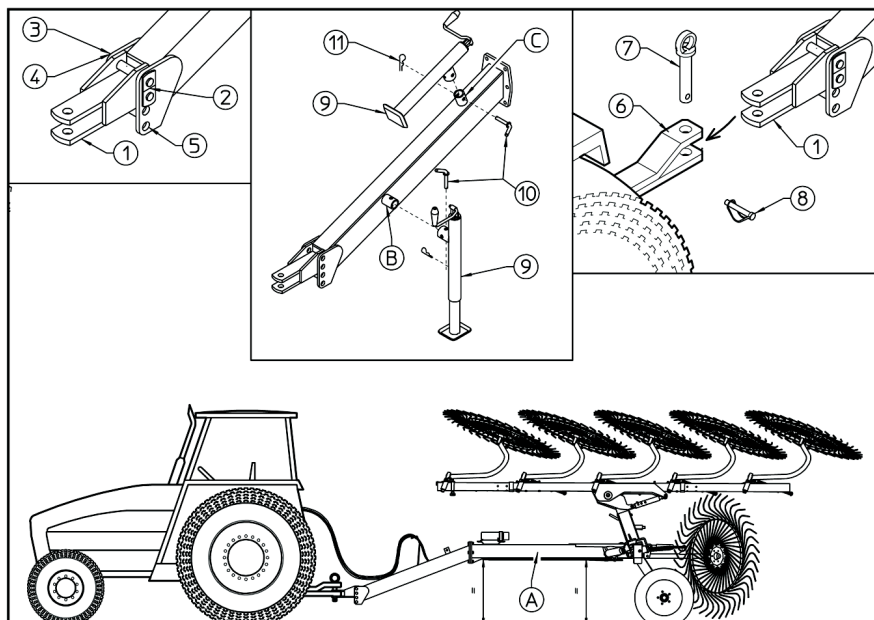

Before attempting to attach the VR rakes to your tractor, make sure the rake cannot accidentally move by chocking the wheels.

Position the hitch clevis (1) so that the main rake frame tube (A) is level, as shown in above. The clevis can be repositioned by removing pins (2&3) and moving the clevis to another set of holes. The clevis can also be flipped over for additional offset adjustment.

Connect the hitch clevis to the tractor drawbar using a 1" Hitch pin and retaining pin as shown in the right hand picture above. Make sure the rake frame tube "A" is still level, as shown.

After the rake is connected to the tractor drawbar, turn the crank handle on the parking jack release pressure. Remove retaining pins (10&11) and remove the jack from the park location. Reposition the jack to the operating position (see center figure above) and reinstall the retaining pins.

Connect the hydraulic hoses to the tractor's remote valves.

Remove the safety checks to allow the rake to move.



Before carrying out any maintenance, adjustments or repairs on the machine, switch off the tractor engine, remove ignition key, wait until all moving parts have come to a standstill.

# OPERATION

## 6.2 Setting Working Width

Working width can be adjusted by sliding the telescopic arm in or out. This will change the windrow width but not effect the rake arm angle.

To change working width: Remove pin (1). Slide the telescopic arm (A) to the desired position with tie rod (B).

Install pin (1) to lock the telescopic arm (A) in place. Secure pin (1) with washer (2) and retaining clip (3).

**NOTE:** Working width, or windrow width, should be set to match your baler's pickup unit.

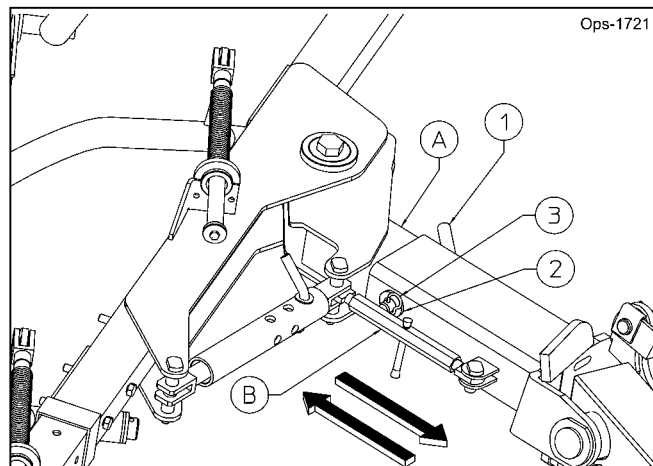

## 6.3 Setting Rake Arm Angle

The hay rake arms (A) can be pivoted and locked into different positions using tie rod (3) and pin (1). Change the rake wheel angle by rotating hay rake arms.

The hay rake arm can be pivoted to obtain a different working angle and further variation of the swath. Pin (1) is inserted in the different holes the tie rod (3) and fastened with the clip (2).

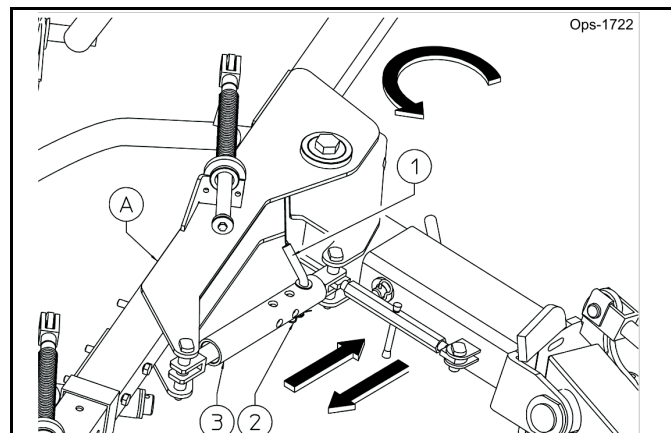

## 6.4 Optional

A hydraulic opening kit is available for adjusting the working angle.

Two cylinders (A) are fitted, which are controlled by the pipes (B), making it possible to obtain the desired section angle position without getting down from the tractor.

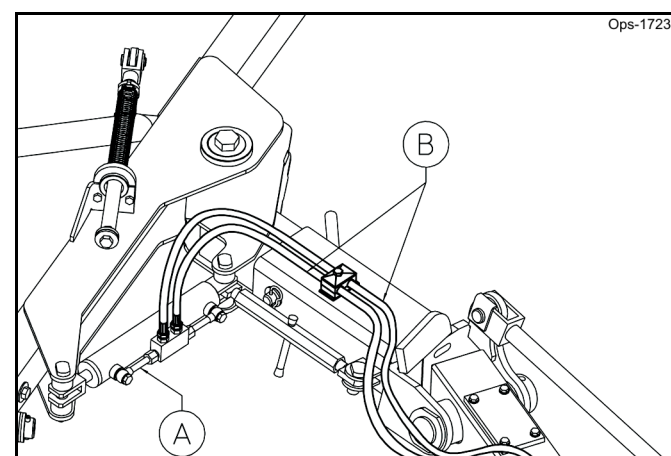

# OPERATION

## OPERATION

### 6.5 Adjusting Rake Ground Pressure

The pressure of the rake wheels against the ground can be adjusted with the

spring (1).

- Lower the rake arms, using the hydraulic lever on the tractor.

- Adjust the rake wheel pressure by turning the adjustment nut (B), using a 36mm wrench (not included).

- Compressing the spring (1) reduces the pressure against the ground.

- Loosening the spring (1) increases the pressure against the ground.

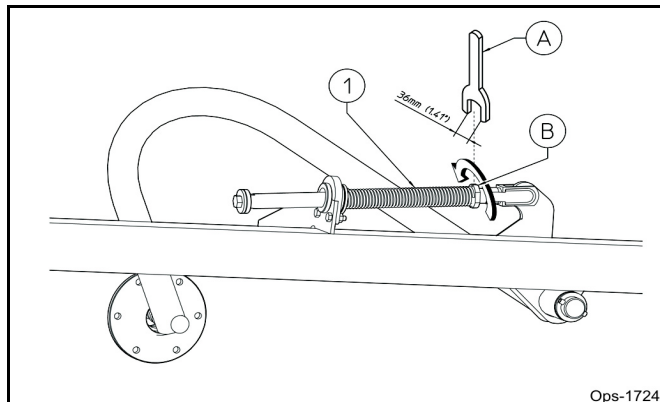

The rake wheels are driven by contacting the

ground. Adjust the wheel ground pressure for good raking action without damaging the crop. Too little ground pressure will allow rake wheels to slip over hay. Too much ground pressure will cause dirt or rocks to be mixed into the hay and will cause premature wear of the finger wheels.

Ground speed affects raking performance. Be sure to operate the rake at recommended raking ground speeds when checking ground pressure.

### 7. PRE-OPERATION INSPECTION AND SERVICE

Before each use, a pre-operation inspection and service of the implement and tractor must be performed. This includes routine maintenance and scheduled lubrication, inspecting that all safety devices are equipped and functional, and performing needed repairs. DO NOT operate the unit if the pre-operation inspection reveals any condition affecting safe operation. Perform repairs and replacement of damaged and missing parts as soon as noticed. By performing a thorough pre-operation inspection and service, valuable down time and repair cost can be avoided. OPS-U-0029



Never work under the Implement, the framework, or any lifted component unless the Implement is securely supported or blocked up to prevent sudden or inadvertent falling which could cause serious injury or even death. (SG-14)



Periodically inspect all moving parts for wear and replace when necessary with authorized service parts. Look for loose fasteners, worn or broken parts, and leaky or loose fittings. Make sure all pins have cotter pins and washers. Serious injury may occur from not maintaining this machine in good working order. (SG-21)

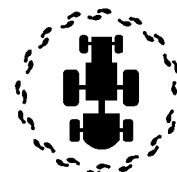

# OPERATION

## **7.1 Tractor Pre-Operation Inspection/Service**

Refer to the tractor operator's manual to ensure a complete pre-operation inspection and scheduled service is performed according to the manufacturers recommendations. The following are some of the items that require daily service and inspection:

- Tire condition/air pressure
- Wheel lug bolts
- Steering linkage
- PTO shield
- SMV sign is clean and visible
- Tractor's lights are clean and functional
- Tractor Seat belt is in good condition
- Tractor ROPS is in good condition
- ROPS is in the raised position
- No tractor oil leaks
- Radiator free of debris
- Engine oil level and condition
- Engine coolant level and condition
- Power brake fluid level
- Power steering fluid level
- Fuel condition and level
- Sufficient lubrication at all lube points
- Air filter condition *OPS-U-0030*



## **7.2 Rake Pre-Operation Inspection/Service**

Before each rake use, a complete inspection and service is required to ensure the rake is in a good and safe working condition. Damaged and/or broken parts should be repaired and/or replaced immediately. To ensure the rake is ready for operation, conduct the following. *OPS-RK-0001*

The operator's manual and safety signs affixed on the unit contain important instructions on the safe and proper use of the equipment. Maintain these important safety features on the implement in good condition to ensure the information is available to the operator at all times.

- Ensure the manual canister is secured to the equipment with the operator's manual inside.
- Ensure all safety signs are in place and legible. Replace missing, damaged, and illegible decals. *OPS-U- 0011*



# OPERATION

## OPERATION

### MAINFRAME ASSEMBLY

- Inspect condition of frame weldment.
- Ensure all bolts and screws are in position and are properly torqued.
- Ensure all pins are in place and fastened with screws.
- Ensure frame is properly mounted to tractor and hardware is properly installed and tightened. OPS-RK-0003\_B

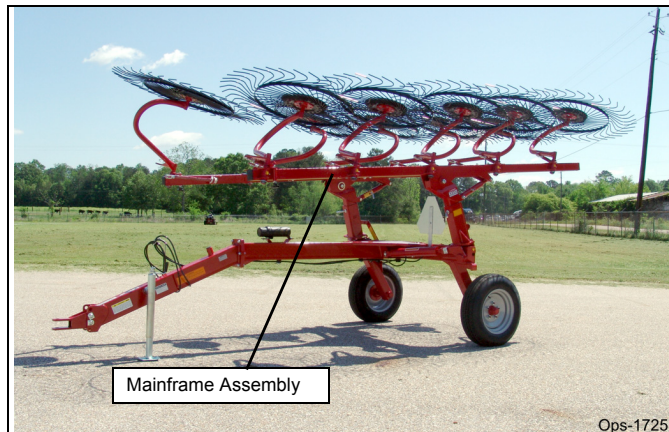

### HYDRAULIC LINE INSPECTION

- Check for hydraulic leaks along hoses, cylinders and fittings. **IMPORTANT: DO NOT use your hands to check for oil leaks. Use a piece of heavy paper or cardboard to check for hydraulic oil leaks.**
- Make sure hydraulic cylinders are in good condition.
- Make sure hydraulic cylinder pins are in place and retained. OPS-RK-0002

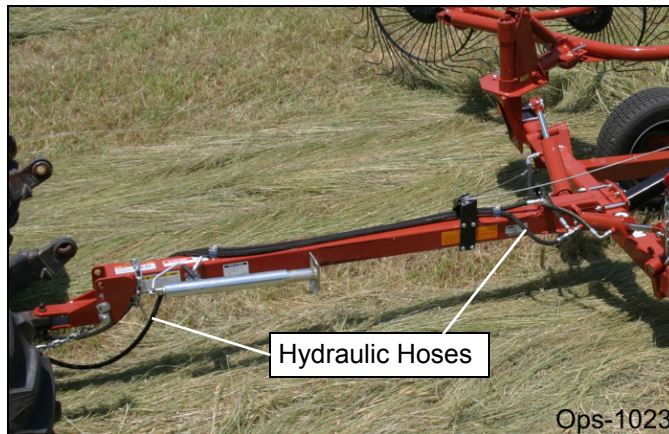

### **⚠ WARNING**

Do not operate this Equipment with hydraulic oil or fuel leaking. Oil and fuel are explosive and their presence could present a hazard. Do not check for leaks with your hand! High-pressure oil streams from breaks in the line could penetrate the skin and cause tissue damage including gangrene. To check for a hose leak, SHUT the unit ENGINE OFF and remove all hydraulic pressure. Wear oil impenetrable gloves, safety glasses and use Cardboard to check for evidence of oil leaks. If you suspect a leak, REMOVE the HOSE and have it tested at a Dealer. If oil does penetrate the skin, have the injury treated immediately by a physician knowledgeable and skilled in this procedure. (SG-15)



# OPERATION

## OPERATION

- Inspect teeth for looseness, breakage and excessive wear. Make sure implement is on the ground and securely blocked up. Replace damaged, worn, and missing teeth at the same time to maintain uniform tine height.
- Remove any hay or other debris which may be wrapped around the teeth.
- Inspect condition of all hardware. OPS-RK-0004

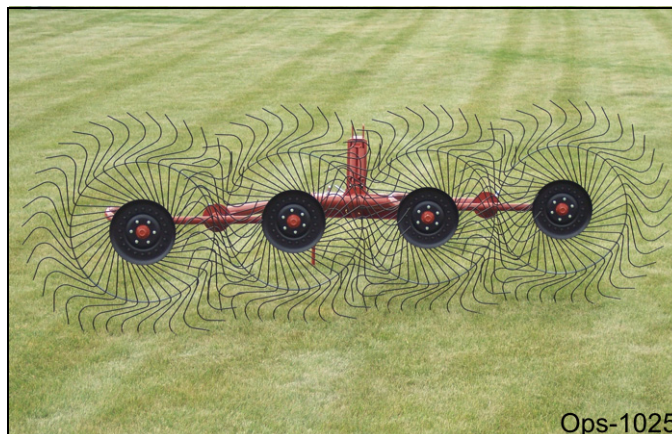

- Perform scheduled lubrication as detailed in the maintenance section.
- Check for corrosion in storage.
- Inspect that tractor hitch pin is the proper size, correctly installed, and secured to the tractor drawbar with retaining pin inserted.
- Make sure tires and wheel are in good condition. Make sure the wheel lug nuts are tight. OPS-RK-0005\_A



# OPERATION

## Tractor PRE-OPERATION Inspection



Tractor ID# \_\_\_\_\_

Make \_\_\_\_\_

Date: \_\_\_\_\_

Shift \_\_\_\_\_



Before conducting the inspection, make sure the tractor engine is off, all rotation has stopped and the tractor is in park with the parking brake engaged. Make sure the mower is resting on the ground or securely blocked up and all hydraulic pressure has been relieved.

OPERATION

Item	Condition at Start of Shift	Specific Comments if not O.K.
The flashing lights function properly		
The SMV Sign is clean and visible		
The tires are in good condition with proper pressure		
The wheel lug bolts are tight		
The tractor brakes are in good condition		
The steering linkage is in good condition		
There are no visible oil leaks		
The hydraulic controls function properly		
The ROPS or ROBS Cab is in good condition		
The seatbelt is in place and in good condition		
The 3-point hitch is in good condition		
The drawbar pins are securely in place		
The PTO master shield is in place		
The engine oil level is full		
The brake fluid level is full		
The power steering fluid level is full		
The fuel level is adequate		
The engine coolant fluid level is full		
The radiator is free of debris		
The air filter is in good condition		

Operator's Signature: \_\_\_\_\_

**DO NOT OPERATE an UNSAFE TRACTOR or MOWER**

# OPERATION

## HAY RAKE PRE-OPERATION Inspection



Rake ID# \_\_\_\_\_ Make \_\_\_\_\_

Date \_\_\_\_\_ Shift \_\_\_\_\_



Before conducting the inspection, make sure the Tractor engine is off, all rotation has stopped and the tractor is in park position with the parking brake engaged. Make sure the Rake arms is resting on the ground or securely blocked up and all hydraulic pressure has been relieved.

Item	Condition at Start of Shift	Specific Comments if not O.K.
REAR RAKE OR BOX RAKE		
The Operator's Manual is in the Canister on the Hay Rake		
All Safety Decals are in place and legible		
The Tongue/Hitch connection bolts & pins are tight		
There are no cracks in Tongue or Hitch		
The Tow chain is secured to the Tractor & Hay Rake		
The Wheel Rake Arm connection bolts & pins are tight		
Transport locks and retaining chains are in good condition		
Rake spokes are in good condition and securely attached to wheels		
Rake wheels are securely attached to the frame members		
The Hydraulic Cylinders are in good condition		
The Hydraulic Cylinder pins are in place & retained		
There are no leaking or damaged hoses		
There is no evidence of Hydraulic leaks		
The tires and wheel(s) are in good condition		
Wheel lug nuts are tight		

Operator's Signature: \_\_\_\_\_

**DO NOT OPERATE an UNSAFE TRACTOR or IMPLEMENT**

OPERATION

# OPERATION

## 8. DRIVING THE TRACTOR AND IMPLEMENT

Safe tractor transport requires the operator possess a thorough knowledge of the model being operated and precautions to take while driving with an attached implement. Ensure the tractor has the capacity to handle the weight of the implement and the tractor operating controls are set for safe transport. To ensure safety while driving the tractor with an attached implement, review the following. *OPS-U- 0012*



Never run the Tractor engine in a closed building or without adequate ventilation. The exhaust fumes can be hazardous to your health. (SG-23)



Transport only at speeds where you can maintain control of the equipment. Serious accidents and injuries can result from operating this equipment at high speeds. Understand the Tractor and Implement and how it handles before transporting on streets and highways. Make sure the Tractor steering and brakes are in good condition and operate properly.

Before transporting the Tractor and Implement, determine the proper transport speeds for you and the equipment. Make sure you abide by the following rules:

Test the tractor at a slow speed and increase the speed slowly. Apply the Brakes smoothly to determine the stopping characteristics of the Tractor and Implement. As you increase the speed of the Tractor the stopping distance increases. Determine the maximum transport speed not to exceed 20 mph (30 kph) for transporting this equipment.

Test the equipment at a slow speed in turns. Increase the speed through the turn only after you determine that the equipment can be operated at a higher speed. Use extreme care and reduce your speed when turning sharply to prevent the tractor and implement from turning over. Determine the maximum turning speed for you and this equipment before operating on roads or uneven ground.

Only transport the Tractor and Implement at the speeds which allow you to properly control the equipment.

Be aware of the operating conditions. Do not operate the Tractor with weak or faulty brakes or worn tires. When operating down a hill or on wet or rain slick roads, the braking distance increases: use extreme care and reduce your speed. When operating in traffic always use the Tractor's flashing warning lights and reduce your speed. Be aware of traffic around you and watch out for the other guy. (SG-19)



# OPERATION

## 8.1 Starting the Tractor

The procedure to start the tractor is model specific. Refer to the tractor operator's manual for starting procedures for your particular tractor. Consult an authorized dealer if the starting procedure is unclear. Ensure the 3-point control lever is in the lowered position and the PTO is disengaged before starting the tractor. OPS-U-0033



## 8.2 Brake and Differential Lock Setting

Make sure the tractor brakes are in good operating condition. Tractor brakes can be set to operate independently allowing single rear wheel braking action or locked together to provide simultaneous rear wheel braking. FOR MOST DRIVING AND OPERATING CONDITIONS, THE BRAKE PEDALS SHOULD BE LOCKED TOGETHER TO PROVIDE THE MOST EFFECTIVE BRAKING ACTION.

Always disengage the tractor differential lock when turning. When engaged the differential lock will prevent or limit the tractor from turning. During normal cutting conditions, locking the differential provides no benefit and should not be used. OPS-U-0013

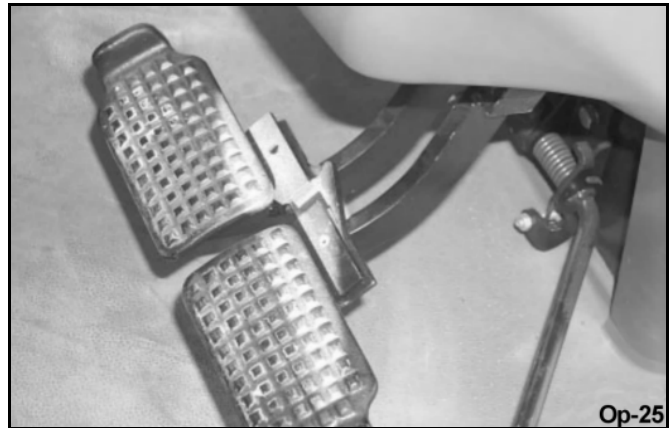

### **WARNING**

Be aware of the operating conditions. Do not operate the Tractor with weak or faulty brakes. When operating down a hill or on wet or rain slick roads, the braking distance increases; use extreme care and reduce your speed in these conditions. When operating in traffic, always use the Tractor's flashing warning lights and reduce your speed. Be aware of traffic around you and watch out for the other guy.

# OPERATION

## OPERATION

### **8.3 Driving the Tractor and Implement**

Start off driving at a slow speed and gradually increase your speed while maintaining complete control of the tractor and implement. Moving slowly at first will also prevent the tractor from rearing up and loss of steering control. The tractor should never be operated at speeds that cannot be safely handled or which will prevent the operator from stopping quickly during an emergency. If the power steering or engine ceases operating, stop the tractor immediately as the tractor will be difficult to control.

Perform turns with the tractor and implement at slow speeds to determine how the tractor with an attached implement handles a turn. Determine the safe speed to maintain proper control of the tractor when making turns. When turning with a towed implement, the overall working length of the unit is increased. Allow additional clearance for the implement when turning.

To avoid overturns, drive the tractor with care and at safe speeds, especially when operating over rough ground, crossing ditches or slopes, and turning corners. Tractor wheel tread spacing should be increased when working on inclines or rough ground to reduce the possibility of tipping.

Use extreme caution when operating on steep slopes. Keep the tractor in a low gear when going downhill. DO NOT coast or free-wheel downhill.  
*OPS-RK-0006*



## **9. OPERATING THE TRACTOR AND IMPLEMENT**

**THE OPERATOR MUST COMPLETELY UNDERSTAND HOW TO OPERATE THE TRACTOR AND IMPLEMENT AND ALL CONTROLS BEFORE ATTEMPTING TO OPERATE.** The operator must read and understand the Safety and Operation Sections of the implement and tractor operator's manuals. These manuals must be read and explained to any operator who cannot read. Never allow someone to operate the implement and tractor without complete operating instructions.

Before starting any operation, the operator must become familiar with the area to be worked in and any obstacles and hazards contained within to ensure safety to the operator, bystanders, and equipment. Special attention should be paid to foreign debris, rough terrain, steep slopes, and passersby and animals in the area.  
*OPS-U- 0015*

# OPERATION

## 9.1 Setting Implement into Work Position

Setting the machine into work position

From the transport position:

- Stop tractor engine and remove the key.
- Remove the transport safety arm (B) from the transport locked position.
- Install the transport safety arm to work position (horizontal)
- Install the retaining pin (C) and washer (D) to secure the transport safety arm (B).
- Turn the valve lever (A) in open position.
- Get back on the tractor and lower the rake arms to the working position with the hydraulic cylinder.

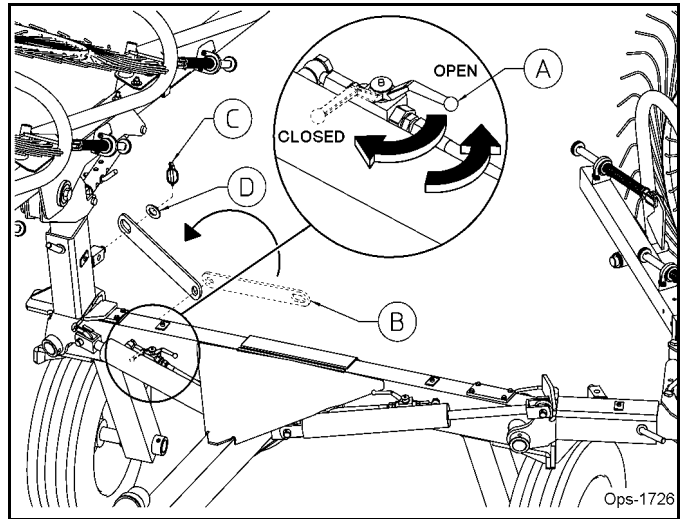

The machine is in working position.

The tractor hydraulics must be set to float mode during operation



Before placing machine in work position: Check that nobody is within the machine pivoting area. If there is someone, make sure the person moves away.

# OPERATION

## OPERATION

### 9.2 Adjustment in work position

Minimum and maximum width and windrow specifications will vary depending on crop conditions.

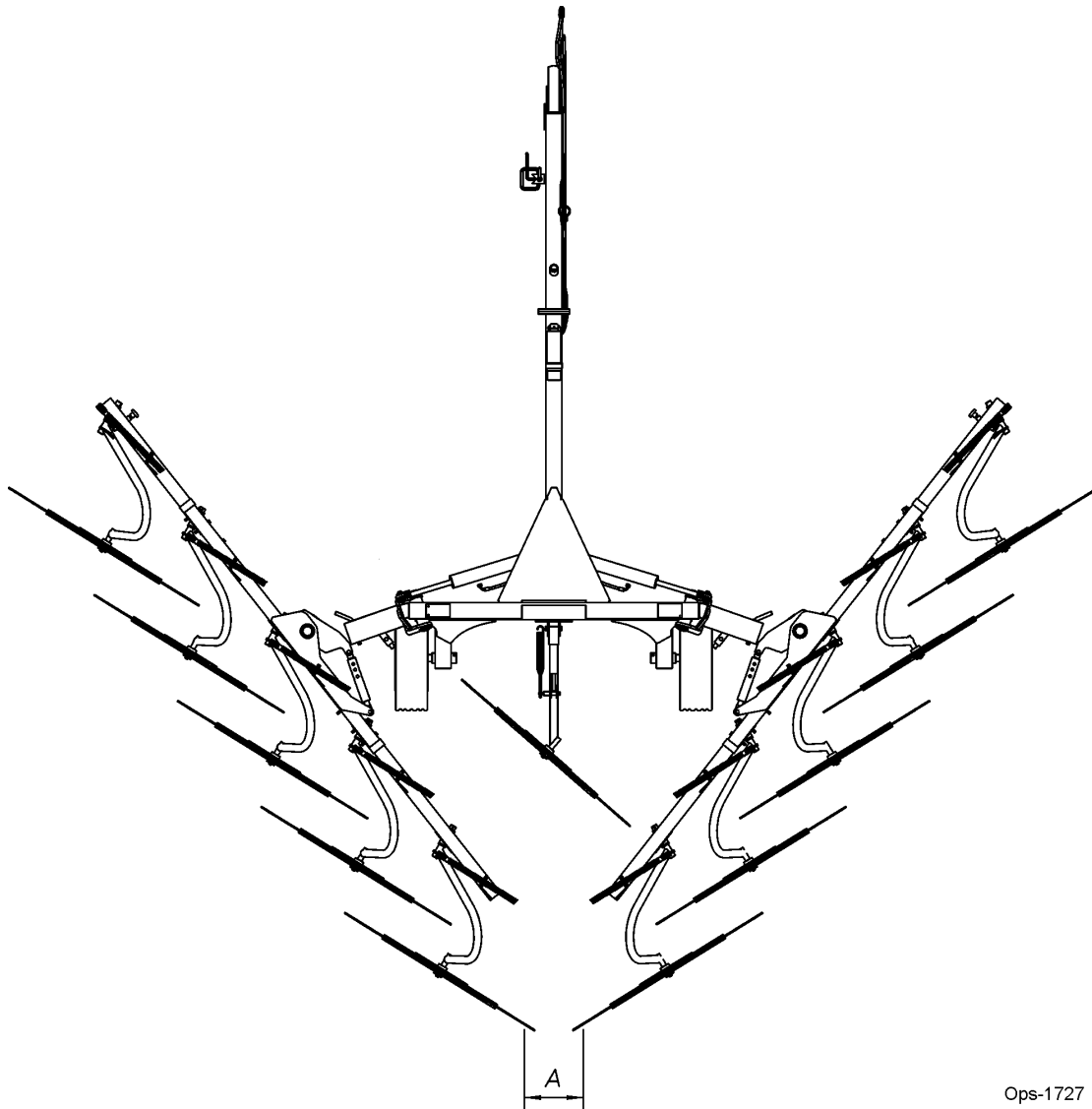

Ops-1727

#### MODEL

Minimum Windrow Width (A)  
Maximum Windrow Width (A)  
Minimum Working Width  
Maximum Working Width

#### QR 8

3' (0,9 m)  
6' 7" (2 m)  
16' 4" (5 m)  
22' (5,5 m)

#### QR 10

3' (0,9 m)  
6' 7" (2 m)  
19' (5,8 m)  
22' (6,4 m)

#### QR 12

3' (0,9 m)  
6' 7" (2 m)  
21' 8" (6,6 m)  
25' 7" (7,5 m)



Before placing machine in work position: Check that nobody is within the machine pivoting area. If there is someone, make sure the person moves away.

# OPERATION

## OPERATION

### **9.3 Operating on one side only**

Stop the tractor engine and remove the key

Remove the transport safety arm only on the side on which you want to work.

Lock the transport safety arm in the resting position (horizontal).

Install the retaining pin and washer.

Get back on the tractor and lower the hay rake arm with the hydraulic cylinder.

On the side where you have left the transport arm the hay rake arm will remain raised.

Once the arm has gone over center, place the tractor hydraulics into the float position, allowing the rake arms to finish lowering

The machine is ready to work on one side only.

(Refer to **FIGURE Ops-1731**)

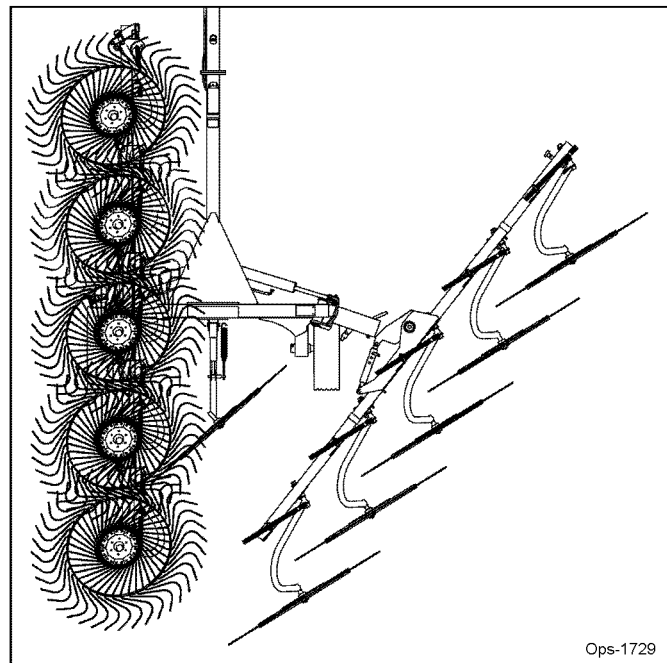
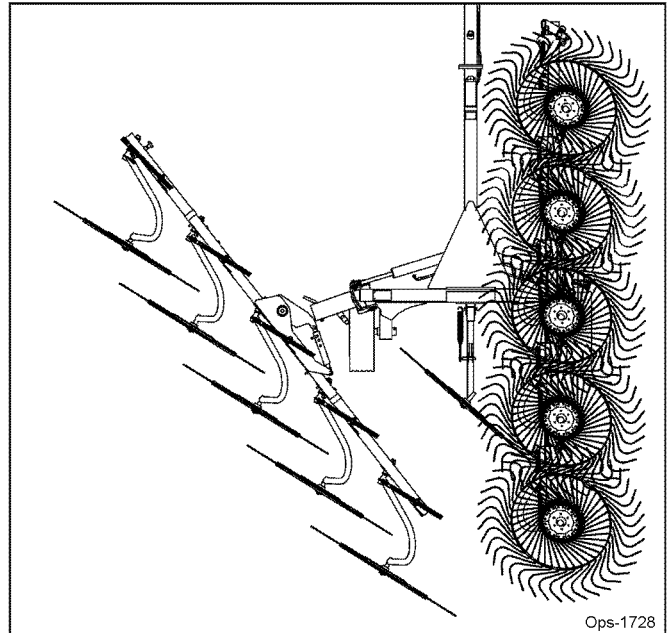

## OPERATION

### OPERATION

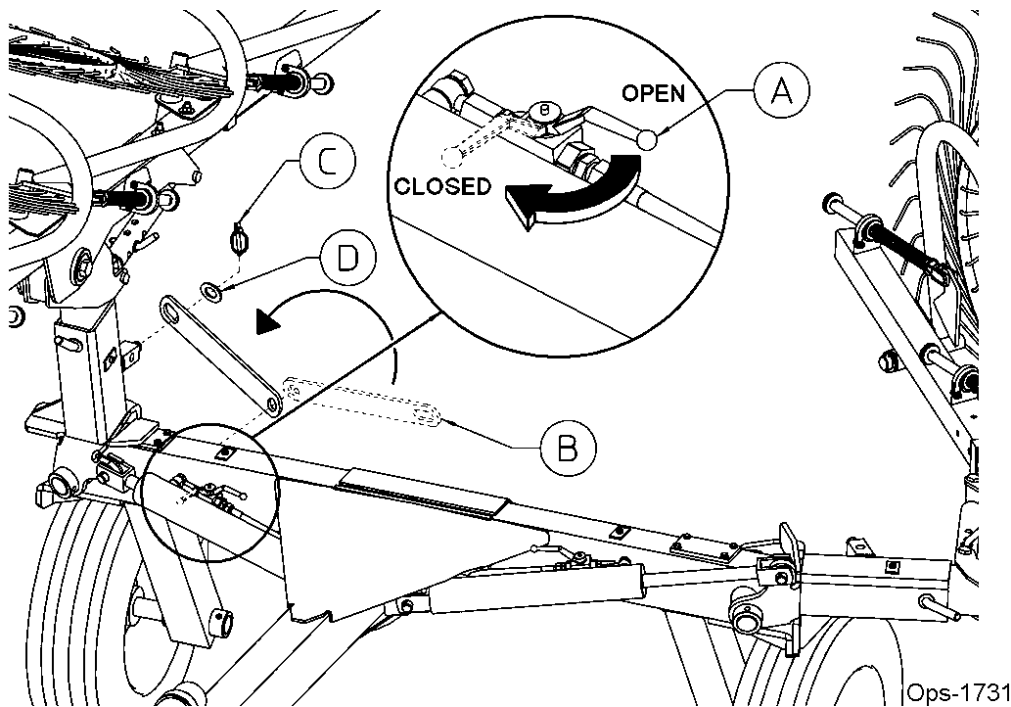

Stop the tractor engine and remove the key.

Remove the transport safety (B) arm only on the side on which you want to work.

Lock the transport safety arm in the resting position (horizontal).

Install the retaining pin (C) and washer (D).

**Close the cock valve (A) on the side where you do not want work**

Get back on the tractor and lower the hay rake arm with the hydraulic cylinder.

On the side where you have left the transport arm the hay rake arm will remain raised.

Once the arm has gone over center, place the tractor hydraulics into the float position, allowing the rake arms to finish lowering

The machine is ready to work on one side only.

# OPERATION

## **9.4 Foreign Debris Hazards**

Before raking, inspect the area to make sure there are no foreign objects that the rake teeth could hit or become entangled with. Remove all foreign objects and debris. If objects are too big to remove, mark them clearly and be sure to prevent the mower blades from contacting them.

If you hit a solid object or foreign debris, stop the implement and tractor at once. Immediately idle the engine speed and disengage the PTO. Wait for all rotating motion to stop, then raise the implement and move the tractor and implement off the object. Inspect the area and remove, or mark the location of the debris. Inspect the condition of the implement and make any needed repairs immediately. Make sure the teeth are not damaged and the tines are uniform before resuming operation.

Always wear your seat belt securely fastened and only operate the tractor and mower with the ROPS in the raised position. If the tractor or implement hits a tree stump, rock, or bump, a sudden movement could throw you off of the seat and under the tractor and/or implement. The seat belt is your best protection from falling off the tractor and the ROPS provides protection from being crushed during a tractor roll-over. OPS-RK-0007

## **9.5 PTO RPM and Ground Speed**

Ground speed for raking will depend upon the height, type, and density of vegetation to be raked. Recommended speed for efficient rake performance is between 5 and 8 mph (8 -13 kph). Operate the rake at its full rated speed to maintain tine speed for a clean raking. Adjust speed as necessary for the correct flow of cut hay through the rake. Refer to the tractor operator's manual or the tractor instrument panel for the engine speed and gear to provide the required PTO and desired ground speed. Make sure that the rake is operating at its full rated speed before entering the vegetation to be raked. If it becomes necessary to temporarily regulate engine speed, increase or decrease the throttle gradually.

Ground speed is achieved by transmission gear selection and not by the engine operating speed. The operator may be required to experiment with several gear range combinations to determine the best gear and range which provides the most ideal performance from the implement and most efficient tractor operation. As the severity of raking conditions increase, the ground speed should be decreased by selecting a lower gear to maintain the proper operating PTO speed.

Stay alert and watch for trees, low hanging limbs, power lines, and other overhead obstacles and solid ground objects while you are operating. Use care to avoid hitting these items. OPS-R-0028\_A



# OPERATION

## OPERATION

### **9.6 Shutting Down the Implement**

Park the tractor on a level surface, place the transmission in park or neutral and apply the parking brake, lower the attached implement to the ground, shut down the engine, remove the key, and wait for all motion to come to a complete stop before exiting the tractor.



### **10. DISCONNECTING THE IMPLEMENT FROM THE TRACTOR**

Before disconnecting the implement, the PTO must be disengaged and tire wheel rotation at a complete stop. Move the implement to a level storage location and lower it to the ground. If the implement is not resting securely on the ground, block the implement up securely before attempting to disconnect it from the tractor.

Use extreme care to keep feet and hands from under the implement and clear of any pinch points caused by the tractor hitch arms and implement pins. OPS-RK-0009



# OPERATION

## OPERATION

### 10.1 Disconnecting the Implement

Attention - Park the machine on even fairly level ground

Preferably park the machine in transport position with the transport lock installed.

- Block the machine with wheel chocks.
- Disconnect hydraulic hoses.
- Store hydraulic hoses in their support.
- Unhook safety chain. (If so equipped)

To prevent the implement hitch from raising rapidly, always position rake arms up against the stops or down with the finger wheels on the ground to prevent the rake from becoming unbalanced and tipping back when uncoupling.

- Remove parking stand to transport position.
- Install parking stand on tongue jack mount.
- Secure parking stand with pin and clip.
- Turn parking handle to lower the jack base to the ground and keep turning until the tongue weight is off of the tractor hitch (2).
- Remove hitch pin.

Machine is uncoupled.

When parking the machine for a long period, we recommend raising the rake arms until they butt against their stop in order to depressurize the hydraulic circuit.

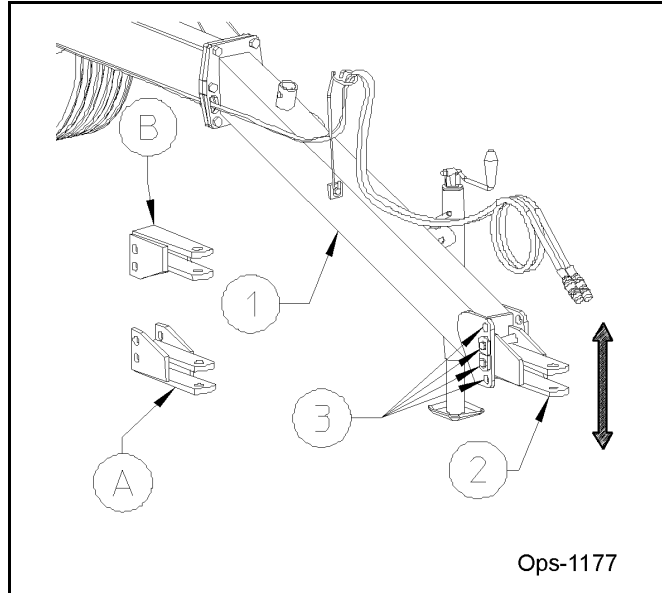

#### **⚠ DANGER**

Always shut the Tractor completely down, place the transmission in park, and set the parking brake before you or anyone else attempts to connect or disconnect the Implement and Tractor hitches. (S3PT-15)

#### **⚠ WARNING**

Never unhitch without using the Tongue Jack. The Tongue is very heavy. Attempting to lift the Tongue without using the Tongue Jack could cause strains or other injury. Allowing the tongue to fall suddenly and unexpectedly could result in crushing injury. Use the Tongue Jack for lifting the Implement only. Overloading the Tongue Jack can cause failure with possible serious bodily injury or even death. (STI-04)

# OPERATION

## OPERATION

### RAKE STORAGE

Properly preparing and storing the implement at the end of the season is critical to maintaining its appearance and to help ensure years of dependable service. The following are suggested storage procedures:

- Thoroughly clean all debris off the implement to prevent damage from rotting hay and standing water.
- Lubricate all implement grease points and fill gearbox oil levels as detailed in the maintenance section.
- Tighten all bolts and pins to the recommended torque.
- Check the implement for worn and damaged parts. Perform repairs and make replacements immediately so that the implement will be ready for use at the start of the next season.
- Store the implement in a clean, dry place with the implement housing resting securely on blocks or at ground level.
- Keep the implement from sitting in water, dirt and other contaminants.
- Use spray touch-up enamel where necessary to prevent rust and maintain the appearance of the rake. *OPS-RK-0010\_A*

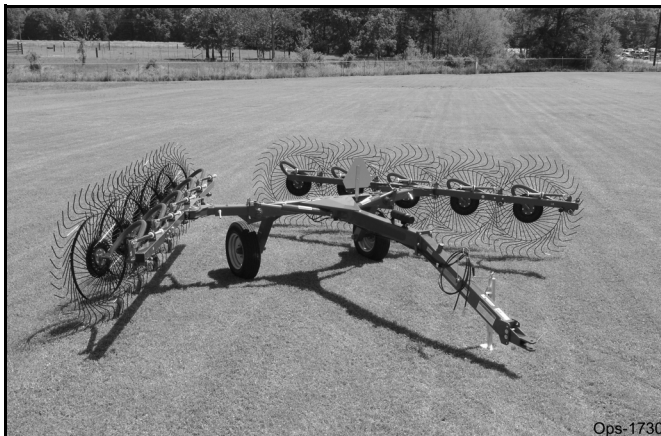

Never allow children or other persons to ride on the Tractor or Implement. Falling off can result in serious injury or death. (SG-10)



### 11. TRANSPORTING THE TRACTOR AND IMPLEMENT

Inherent hazards of operating the tractor and implement and the possibility of accidents are not left behind when you finish working in an area. Therefore, the operator must employ good judgement and safe operation practices when transporting the tractor and implement between locations. By using good judgement and following safe transport procedures, the possibility of accidents while moving between locations can be substantially minimized. *OPS-U- 0017*

## OPERATION

Before transporting the tractor and implement, idle the tractor engine, disengage the PTO and wait for all moving parts to come to a complete stop. Once all implement parts are completely stopped, raise the implement to transport height. *OPS-RK-0011*



Before transporting the tractor on a public roadway or boarding a trailer for transport, the tractor brake pedals should be locked together. Locking the pedals ensures that both wheels brake simultaneously while stopping, especially when making an emergency stop.

Use extreme caution and avoid hard applications of the tractor brakes when towing heavy loads at road speeds. Never tow the implement at speeds greater than 20 MPH (32 kph). *OPS-U- 0018*

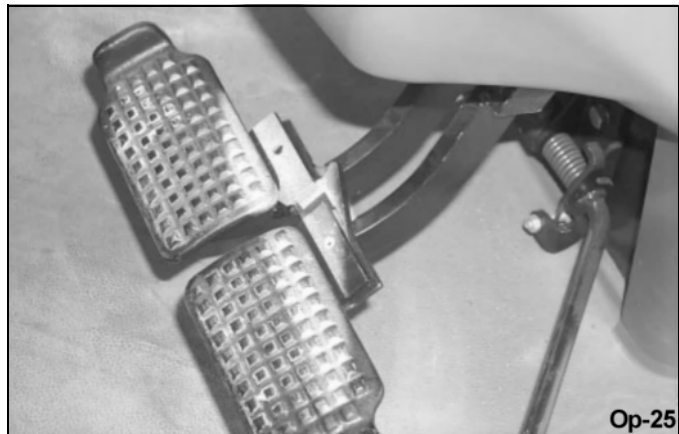

# OPERATION

## OPERATION

### 11.1 Transporting

**ATTENTION:** When the hay rake arms are lifted, the shape of the hinges carries the weight toward the tractor and makes it possible to decrease the machine dimensions.

Check carefully during the lifting stage to make sure that parts of the machine do not touch parts of the tractor.

Check to make sure that with certain tractors during transport operations, while steering or when moving over uneven ground the hay rake arms do not touch parts of the tractor, with the risk of causing damage to both machines.

If it is possible that there may be contact between parts of the hay rake and parts of the tractor, it is recommended that the angle of the arms be increased before lifting them. This operation brings them farther away from the tractor and creates a situation of greater safety.



**DANGER** Crushing hazard: Keep a safe distance from machine when raising or lowering arms, or when implement is in transport position.

Lock arms in raised position before transport and before working under this machine.

Before placing the machine into transport position:

Make sure the rotating parts have come to a complete stop. Check and move away any person located in the rake arm pivoting area.

### 11.2 Set the machine into transport position.

From the working position:

- Activate the tractor hydraulics and raise the rake arms until they reach the stops.

- Install the transport safety arm (B) to the transport position on the pins.

- Secure the transport safety arm (B) with the retaining pins (C) and washer (D).

- Close the cylinder valve by turning the lever (A).

- Make sure that all safety signs and reflectors are installed, clean and visible.

Do not operate tractor hydraulics while in transport position.

Please check that there aren't any oil leaks. This could compromise the machine's stability.

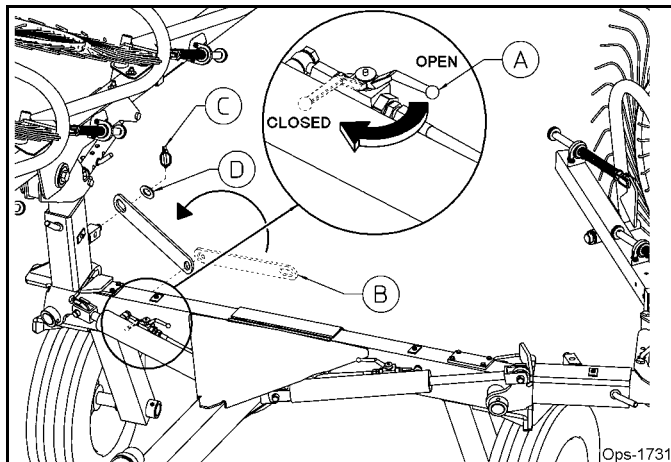

**WARNING** While transporting the machine, the safety locks must always be locked, and while working, the safety locks must always be unlocked.

# OPERATION

## 11.3 Transporting on Public Roadways

Extreme caution should be used when transporting the tractor and implement on public roadways. The tractor must be equipped with all required safety warning features including a SMV emblem and flashing warning lights to alert drivers of the tractor's presence. Remember that roadways are primarily designed for automotive drivers and most drivers will not be looking out for you, therefore, you must look out for them. Check your side view mirrors frequently and remember that vehicles will approach quickly because of the tractor's slower speed. Be extremely cautious when the piece of equipment that you are towing is wider than the tractor tire width and/or extends beyond your lane of the road.

Make sure that a proper size safety tow chain is secured between the tractor and implement before entering a public road. OPS-U- 0019



Make certain that the "Slow Moving Vehicle" (SMV) sign is installed in such a way as to be clearly visible and legible. When transporting the Equipment use the Tractor flashing warning lights and follow all local traffic regulations. (SG-6)

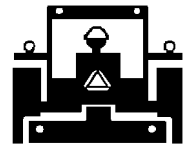

OPERATION

The SMV (Slow-Moving Vehicle) emblem is universal symbol used to alert drivers of the presence of equipment traveling on roadways at a slow speed. SMV signs are a triangular bright orange with reflective red trim for both easy day and night visibility. Make sure the SMV sign is clean and visible from the rear of the unit before transporting the tractor and implement on a public roadway. Replace the SMV emblem if faded, damaged, or no longer reflective. OPS-U- 0020



Op-43

Make sure that all tractor flashing warning lights, headlights, and brake/tail lights are functioning properly before proceeding onto public roads. While newer model tractors have plenty of lighting to provide warning signals and operating lighting, most older models are only equipped with operating lights. Consult an authorized tractor dealer for lighting kits and modifications available to upgrade the lighting on older tractor models. OPS-U- 0021



Op-595

# OPERATION

## OPERATION

### Safety Tow Chain

If the mower is towed on a public roadway, a safety chain with tensile strength equal to or greater than the gross weight of the mower must be connected between the tractor and mower. This will help control the implement in the event the tongue becomes disconnected from the drawbar. Make sure the chain is attached to a secure location on the tractor and not to an intermediate support. After connecting both ends of the safety chain, drive the tractor to the right and left to check for proper chain length. Adjust length as necessary and allow only enough slack in the chain to make a maximum turn in both directions. When not in use, store the safety chain to protect it from mud or standing water by wrapping the chain around the tongue. Replace the safety chain if one or more links or end fittings are broken, stretched or otherwise damaged or deformed.

When operating on public roads, have consideration for other road users. Pull to the side of the road occasionally to allow all following traffic to pass. Do not exceed the legal speed limit set in your country for agricultural tractors. Always stay alert when transporting the tractor and implement on public roads. Use caution and reduce speed if other vehicles or pedestrians are in the area. *OPS-U- 0022*



Reduce speed before turning or applying the brakes. Ensure that both brake pedals are locked together when operating on public roads. *OPS-U- 0023*

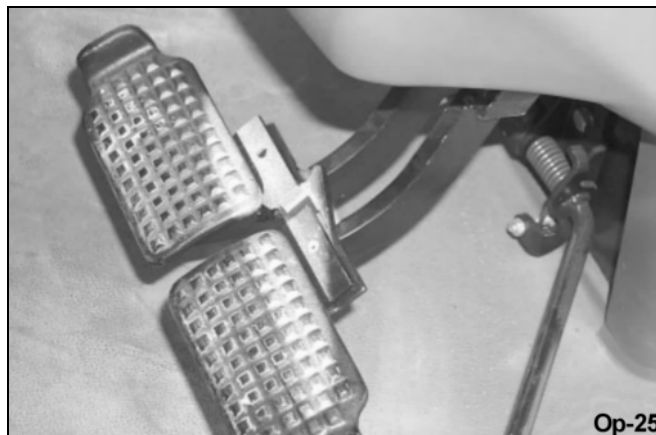

# OPERATION

## **11.4 Hauling the Tractor and Implement**

Before transporting a loaded tractor and implement, measure the height and width dimensions and gross weight of the complete loaded unit. Ensure that the load will be in compliance with the legal limits set for the areas that will be traveled through. *OPS-U- 0024*



Use adequately sized and rated trailers and equipment to transport the tractor and implement. Consult an authorized dealer to determine the proper equipment required. Using adequately sized chains, heavy duty straps, cables and/or binders, securely tie down both the front and rear of the tractor utilizing the proper tie down locations as specified by the tractor manufacturer. *OPS-U- 0025*



Arrange the chains so that when tightened, the chains are pulling downward and against themselves. Carefully tighten the securing chains or other fasteners using boomers or binders to apply maximum tension. Use extreme care when attaching and removing the securing devices as the extreme tension involved when released has the potential to inflict serious injury.

While hauling the tractor and implement, make occasional stops to check that the tractor and implement have not moved or shifted and that the securing chains have maintained tension. If during transport a hard braking, sharp turning, or swerving action was performed, stop at the next safe location to inspect the security of the load. *OPS-U- 0026*



# OPERATION

## 12. TROUBLESHOOTING GUIDE

Problem	Possible Cause	Remedy
Hay carrying over on the wheels.	Teeth not polished. Mud collected on tine ends.	Operate rake on gravel surface for a short distance. Dew on hay, wait until dry. Do not run in soft, wet ground.
Tooth Breakage.	Backing with teeth in contact with ground. Too much of down pressure on wheels. Corrosion in storage.	Avoid backing with teeth on ground. Adjust wheel spring tension  Coat teeth with grease or oil during storage.
Rake missing hay.	Not enough down pressure on wheels Teeth missing or worn.	Adjust spring tension. Replace teeth. It is best to replace all teeth at the same time to maintain uniform tine height.
Rake wheels bounce excessively.	Wheels have too little down pressure.	Adjust spring tension.
Bent teeth.	Backing with wheels down. Excessive speed on rough terrain. Narrow or deep ditches or furrows, rocky ground. Too much weight on wheels.	Avoid backing with teeth down. Reduce speed. Avoid or cross slowly.  Adjust spring tension.

# **MAINTENANCE SECTION**

Maintenance Section 5-1

# MAINTENANCE

## MAINTENANCE



ANY REPAIR WORK MUST BE CARRIED OUT WITH THE MACHINE AT REST AND DISCONNECTED FROM THE TRACTOR.



DO NOT CARRY OUT WELDING WITHOUT AUTHORIZATION AND INSTRUCTION FROM THE MANUFACTURER.



DISCONNECT THE MACHINE FROM THE TRACTOR BEFORE ANY WELDING WORK. DAMAGE TO BATTERY COULD RESULT.



ALWAYS USE A PROTECTIVE MASK, GOGGLES AND GLOVES WHEN WELDING, SANDING OR GRINDING OR WHEN USING A HAMMER OR DRILL.



ALWAYS WORK ON THE MACHINE OUT OF DOORS. IF YOU HAVE TO OPERATE THE MACHINE WHEN CONNECTED TO THE TRACTOR IN AN ENCLOSED AREA (WHEN TESTING AFTER REPAIR OR MAINTENANCE), ENSURE THAT THERE IS SUFFICIENT VENTILATION SO AS TO PREVENT NOXIOUS EXHAUST GASES FROM ACCUMULATING.



DO NOT USE GASOLINE, SOLVENTS OR OTHER FLAMMABLE LIQUIDS AS DETERGENTS.



USE COMMERCIAL NON-FLAMMABLE AND NON-TOXIC SOLVENTS.



DO NOT USE COMPRESSED AIR OR WATER AT HIGH PRESSURE TO CLEAN THE MACHINE. IF THIS IS UNAVOIDABLE, THEN WEAR GOGGLES WITH SIDE PROTECTION AND LIMIT THE PRESSURE AS MUCH AS POSSIBLE. WHEN THE WORK IS FINISHED, AND WITH THE MACHINE DISCONNECTED FROM THE TRACTOR, INSPECT AND CHECK THE MACHINE COMPLETELY.

### **The following should be noted if the machine is scrapped:**

The machine consists mainly of ferrous material which must be disposed of according to the regulations in force in the country concerned.

There is also a small amount of plastic which must be disposed of according to the regulations in force in the country concerned.

# MAINTENANCE

## MAINTENANCE

### LUBRICATION

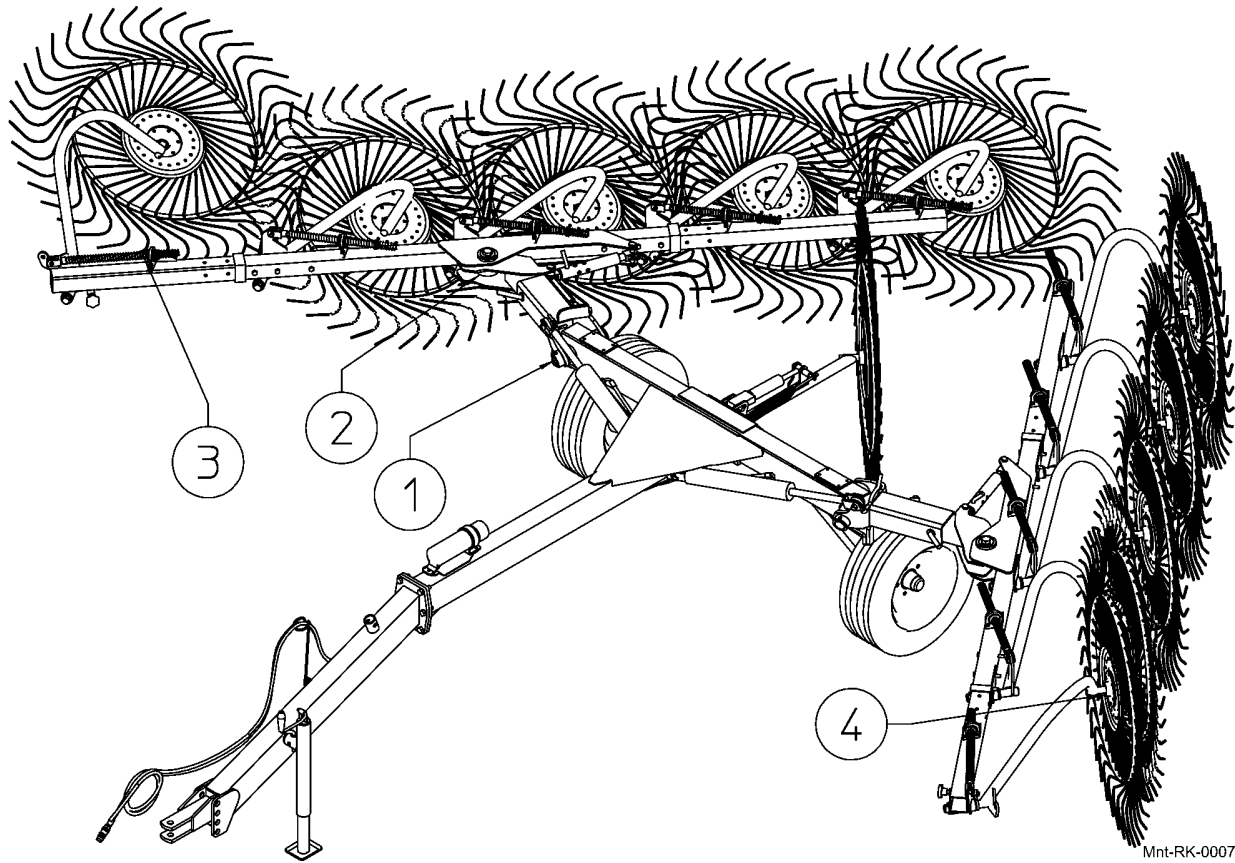

### Lubrication Fitting Schedule

ITEM	DESCRIPTION	FREQUENCY
1	PIN	EVERY 25 HOURS
2	PIN	EVERY 25 HOURS
3	SPRING GROUP	EVERY 25 HOURS
4	WHEEL HUBS	EVERY 40 HOURS

# MAINTENANCE

## TIRES

Regularly check the tire pressure. Respect manufacturer's recommendations on tire pressure.  
Assembly, disassembly and repair of wheels and tires must only be carried out by competent persons.

## HYDRAULIC CIRCUIT



The hydraulic circuit is under pressure. Maximum pressure at work: 3000 PSI (200 bar).

Before connecting hoses to the tractor hydraulics, ensure that tractor and machine circuits are not under pressure. Before disconnecting a hose, depressurize the hydraulic circuit.

To avoid making wrong connections, mark hydraulic couplers and corresponding hoses with colors.



Functions could be reversed (for example: lift/lower) and cause accidents.

Regularly check the hydraulic hoses. In case of normal wear, replace the hydraulic hoses every 5 years. Damaged or worn hoses must be immediately replaced. When replacing the hydraulic hoses, make sure to use hoses with the specifications and quality recommended by the manufacturer of the machine.

To locate a leak, use appropriate means. Protect body and hands from liquid under pressure.

Any liquid under pressure (particularly oil from hydraulics) can penetrate the skin and cause severe injury. If injured, see a doctor immediately. There could be a danger of infection.

Before any adjustments, maintenance or repairs are carried out, lower the machine on the ground, depressurize the hydraulics, turn off the engine, remove ignition key and wait until all moving parts have come to a complete stop.

## STORAGE

To prepare your Rake for storage:

1. Clean the rake following instructions and allow it to dry.
2. Thoroughly tighten all screws and bolts.
3. Store the rake on a clean, dry surface in the down (working) position.
4. Grease the machine thoroughly and then cover it completely and store in a dry place.
5. Lubricate all points and slides before storage. This prevents corrosion.

**NOTE:** Now would be a good time to replace all damaged or worn parts, and have a machine in perfect condition ready for use the next season.

### Important

During extended periods of inactivity it is necessary to close the cylinders completely. This must be done in is such a way as to protect the rods from weather effects.

The rods remaining outside the cylinder (whatever reason may be) must be carefully protected with a grease layer.

# MAINTENANCE

## BOLT TORQUE VALUES

Because of the severe operating conditions, correct bolt torque is very important. An improperly torqued bolt can be easily shaken loose or broken by the vibrations. When replacing bolts, always use the same grade of bolt as used originally. Use this chart as a guide to tightening all bolts. Torque values listed are for general use only.

### TORQUE SPECIFICATIONS

Proper torque for American fasteners.  
Recommended Torque in Foot Pounds (Newton Meters).\*

#### AMERICAN Bolt Head Markings

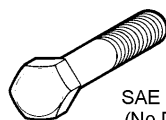

SAE Grade 2  
(No Dashes)

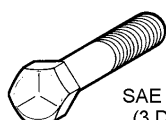

SAE Grade 5  
(3 Dashes)

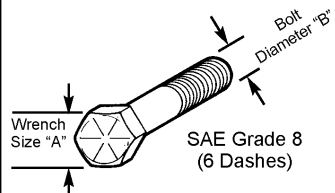

SAE Grade 8  
(6 Dashes)

WRENCH SIZE (IN.) "A"	BOLT DIAMETER (IN.) "B" AND THREAD SIZE	SAE GRADE 2	SAE GRADE 5	SAE GRADE 8
7/16	1/4 - 20 UNC	6 (7)	8 (11)	12 (16)
7/16	1/4 - 28 UNF	6 (8)	10 (13)	14 (18)
1/2	5/16 - 18 UNC	11 (15)	17 (23)	25 (33)
1/2	5/16 - 24 UNF	13 (17)	19 (26)	27 (37)
9/16	3/8 - 16 UNC	20 (27)	31 (42)	44 (60)
9/16	3/8 - 24 UNF	23 (31)	35 (47)	49 (66)
5/8	7/16 - 14 UNC	32 (43)	49 (66)	70 (95)
5/8	7/16 - 20 UNF	36 (49)	55 (75)	78 (106)
3/4	1/2 - 13 UNC	49 (66)	76 (103)	106 (144)
3/4	1/2 - 20 UNF	55 (75)	85 (115)	120 (163)
7/8	9/16 - 12 UNC	70 (95)	109 (148)	153 (207)
7/8	9/16 - 18 UNF	79 (107)	122 (165)	172 (233)
15/16	5/8 - 11 UNC	97 (131)	150 (203)	212 (287)
15/16	5/8 - 18 UNF	110 (149)	170 (230)	240 (325)
1-1/8	3/4 - 10 UNC	144 (195)	266 (360)	376 (509)
1-1/8	3/4 - 16 UNF	192 (260)	297 (402)	420 (569)
1-5/16	7/8 - 9 UNC	166 (225)	430 (583)	606 (821)
1-5/16	7/8 - 14 UNF	184 (249)	474 (642)	668 (905)
1-1/2	1 - 8 UNC	250 (339)	644 (873)	909 (1232)
1-1/2	1 - 12 UNF	274 (371)	705 (955)	995 (1348)
1-1/2	1 - 14 UNF	280 (379)	721 (977)	1019 (1381)
1-11/16	1-1/8 - 7 UNC	354 (480)	795 (1077)	1288 (1745)
1-11/16	1-1/8 - 12 UNF	397 (538)	890 (1206)	1444 (1957)
1-7/8	1-1/4 - 7 UNC	500 (678)	1120 (1518)	1817 (2462)
1-7/8	1-1/4 - 12 UNF	553 (749)	1241 (1682)	2013 (2728)
2-1/16	1-3/8 - 6 UNC	655 (887)	1470 (1992)	2382 (3228)
2-1/16	1-3/8 - 12 UNF	746 (1011)	1672 (2266)	2712 (3675)
2-1/4	1-1/2 - 6 UNC	870 (1179)	1950 (2642)	3161 (4283)
2-1/4	1-1/2 - 12 UNF	979 (1327)	2194 (2973)	3557 (4820)

#### METRIC

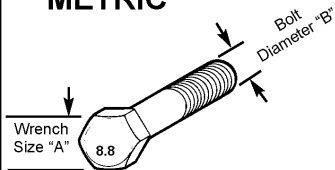

Numbers appearing on bolt heads  
indicate ASTM class.

\*Use 75% of the specified torque value for plated fasteners. Use 85% of the specified torque values for lubricated fasteners.

Proper torque for Metric fasteners.  
Recommended torque in Foot Pounds (Newton Meters).\*

WRENCH SIZE (mm) "A"	BOLT DIA. (mm) "B"	ASTM 4.6	ASTM 8.8	ASTM 9.8	ASTM 10.9
8	5	1.8 (2.4)		5.1 (6.9)	6.5 (8.8)
10	6	3 (4)		8.7 (12)	11.1 (15)
13	8	7.3 (10)		21.1 (29)	27 (37)
16	10	14.5 (20)		42 (57)	53 (72)
18	12	25 (34)	74 (100)	73 (99)	93 (126)
21	14	40 (54)	118 (160)	116 (157)	148 (201)
24	16	62 (84)	167 (226)	181 (245)	230 (312)
30	20	122 (165)	325 (440)		449 (608)
33	22		443 (600)		611 (828)
36	24	211 (286)	563 (763)		778 (1054)
41	27		821 (1112)		1138 (1542)
46	30	418 (566)	1119 (1516)		1547 (2096)

Mnt-B-0005

# RHINO

## LIMITED WARRANTY

### 1. LIMITED WARRANTIES

- 1.01. Rhino warrants for one year from the purchase date to the original non-commercial, governmental, or municipal purchaser ("Purchaser") and warrants for six months to the original commercial or industrial purchaser ("Purchaser") that the goods purchased are free from defects in material or workmanship.
- 1.02. Manufacturer will replace for the Purchaser any part or parts found, upon examination at one of its factories, to be defective under normal use and service due to defects in material or workmanship.
- 1.03. This limited warranty does not apply to any part of the goods which has been subjected to improper or abnormal use, negligence, alteration, modification, or accident, damaged due to lack of maintenance or use of wrong fuel, oil, or lubricants, or which has served its normal life. This limited warranty does not apply to any part of any internal combustion engine, or expendable items such as blades, shields, guards, or pneumatic tires except as specifically found in your Operator's Manual.
- 1.04. Except as provided herein, no employee, agent, Dealer, or other person is authorized to give any warranties of any nature on behalf of Manufacturer.

### 2. REMEDIES AND PROCEDURES.

- 2.01. This limited warranty is not effective unless the Purchaser returns the Registration and Warranty Form to Manufacturer within 30 days of purchase.
- 2.02. Purchaser claims must be made in writing to the Authorized Dealer ("Dealer") from whom Purchaser purchased the goods or an approved Authorized Dealer ("Dealer") within 30 days after Purchaser learns of the facts on which the claim is based.
- 2.03. Purchaser is responsible for returning the goods in question to the Dealer.
- 2.04. If after examining the goods and/or parts in question, Manufacturer finds them to be defective under normal use and service due to defects in material or workmanship, Manufacturer will:
  - (a) Repair or replace the defective goods or part(s) or
  - (b) Reimburse Purchaser for the cost of the part(s) and reasonable labor charges (as determined by Manufacturer) if Purchaser paid for the repair and/or replacement prior to the final determination of applicability of the warranty by Manufacturer.

The choice of remedy shall belong to Manufacturer.

- 2.05. Purchaser is responsible for any labor charges exceeding a reasonable amount as determined by Manufacturer and for returning the goods to the Dealer, whether or not the claim is approved. Purchaser is responsible for the transportation cost for the goods or part(s) from the Dealer to the designated factory.

### 3. LIMITATION OF LIABILITY.

- 3.01. MANUFACTURER DISCLAIMS ANY EXPRESS (EXCEPT AS SET FORTH HEREIN) AND IMPLIED WARRANTIES WITH RESPECT TO THE GOODS INCLUDING, BUT NOT LIMITED TO, MERCHANTABILITY AND FITNESS FOR A PARTICULAR PURPOSE.
- 3.02. MANUFACTURER MAKES NO WARRANTY AS TO THE DESIGN, CAPABILITY, CAPACITY, OR SUITABILITY FOR USE OF THE GOODS.
- 3.03. EXCEPT AS PROVIDED HEREIN, MANUFACTURER SHALL HAVE NO LIABILITY OR RESPONSIBILITY TO PURCHASER OR ANY OTHER PERSON OR ENTITY WITH RESPECT TO ANY LIABILITY, LOSS, OR DAMAGE CAUSED OR ALLEGED TO BE CAUSED DIRECTLY OR INDIRECTLY BY THE GOODS INCLUDING, BUT NOT LIMITED TO, ANY INDIRECT, SPECIAL, CONSEQUENTIAL, OR INCIDENTAL DAMAGES RESULTING FROM THE USE OR OPERATION OF THE GOODS OR ANY BREACH OF THIS WARRANTY. NOTWITHSTANDING THE ABOVE LIMITATIONS AND WARRANTIES, MANUFACTURER'S LIABILITY HEREUNDER FOR DAMAGES INCURRED BY PURCHASER OR OTHERS SHALL NOT EXCEED THE PRICE OF THE GOODS.
- 3.04. NO ACTION ARISING OUT OF ANY CLAIMED BREACH OF THIS WARRANTY OR TRANSACTIONS UNDER THIS WARRANTY MAY BE BROUGHT MORE THAN TWO (2) YEARS AFTER THE CAUSE OF ACTION HAS OCCURRED.

### 4. MISCELLANEOUS.

- 4.01. Proper Venue for any lawsuits arising from or related to this limited warranty shall be only in Guadalupe County, Texas.
- 4.02. Manufacturer may waive compliance with any of the terms of this limited warranty, but no waiver of any terms shall be deemed to be a waiver of any other term.
- 4.03. If any provision of this limited warranty shall violate any applicable law and is held to be unenforceable, then the invalidity of such provision shall not invalidate any other provisions herein.
- 4.04. Applicable law may provide rights and benefits to purchaser in addition to those provided herein.

### KEEP FOR YOUR RECORDS

ATTENTION: Purchaser should fill in the blanks below for his reference when buying repair parts and/or for proper machine identification when applying for warranty.

Rhino Implement Model \_\_\_\_\_ Serial Number \_\_\_\_\_

Date Purchased \_\_\_\_\_ Dealer \_\_\_\_\_

ATTENTION:

READ YOUR OPERATOR'S MANUAL

**RHINO®**

1020 S Sangamon Ave.

Gibson City, IL 60936

800-446-5158

Email: [parts@servis-rhino.com](mailto:parts@servis-rhino.com)





## TO THE OWNER/OPERATOR/DEALER

To keep your implement running efficiently and safely, read your manual thoroughly and follow these directions and the Safety Messages in this Manual. The Table of Contents clearly identifies each section where you can easily find the information you need.

The OCCUPATIONAL SAFETY AND HEALTH ACT (1928.51 Subpart C) makes these minimum safety requirements of tractor operators:

### REQUIRED OF THE OWNER:

1. Provide a Roll-Over-Protective Structure that meets the requirements of this Standard; and
2. Provide Seat belts that meet the requirements of this paragraph of this Standard and SAE J4C; and
3. Ensure that each employee uses such Seat belt while the tractor is moving; and
4. Ensure that each employee tightens the Seat belt sufficiently to confine the employee to the protected area provided by the ROPS

### REQUIRED OF THE OPERATOR:

1. Securely fasten seat belt if the tractor has a ROPS.
2. Where possible, avoid operating the tractor near ditches, embankments, and holes.
3. Reduce speed when turning, crossing slopes, and on rough, slick, or muddy surfaces.
4. Stay off slopes too steep for safe operation.
5. Watch where you are going - especially at row ends, on roads, and around trees.
6. Do not permit others to ride.
7. Operate the tractor smoothly - no jerky turns, starts, or stops.
8. Hitch only to the drawbar and hitch points recommended by the tractor manufacturer.
9. When the tractor is stopped, set brakes securely and use park lock, if available.

- 
- x Keep children away from danger all day, every day...
  - x Equip tractors with rollover protection (ROPS) and keep all machinery guards in place...
  - x Please work, drive, play and live each day with care and concern for your safety and that of your family and fellow citizens.



**VR8/10/12  
V-RAKE**