

Quicke®

Dealer Price List

Loaders, Implements and Options



Oct 1, 2016

Table Of Contents

	PAGE #
HOW TO USE THE PRICE LIST	
QUICKE DIMENSION SERIES LOADER SPECIFICATIONS	
QUICKE DIMENSION SERIES LOADER PRICING & DESCRIPTION	
QUICKE DIMENSION SERIES LOADER CODES	
QUICKE VERSA-X SERIES LOADER SPECIFICATIONS	
QUICKE 100 SERIES LOADER SPECIFICATIONS	
QUICKE VERSA-X SERIES LOADER PRICING & DESCRIPTION	
QUICKE VERSA X / 100 SERIES LOADER CODES	
AGCO	1
AGCO FAMILY	2
CASE IH	4
CHALLENGER	9
DEUTZ	13
JOHN DEERE	15
KIOTI	20
KUBOTA	23
LANDINI	27
MAHINDRA	31
MASSEY FERGUSON	33
MCCORMICK	39
NEW HOLLAND	43
VALTRA	49
LOADER CONTROL SYSTEMS	53
LOADER OPTIONS	55
COUNTER WEIGHT AND BUCKET RECOMMENDATIONS	58
LOADER IMPLEMENTS	59
SHIPPING WEIGHTS	66
LIMITED LOADER WARRANTY	67

HOW TO USE THIS PRICE LIST

Dimension and Versa-X Series Loaders

1. Choose Tractor Model (#1) - Note: front axle type, CAB/ROPS, and Notes
2. Choose loader model that is recommended - NSL or SL. Two loader sizes may be available in the Dimension or Versa-X series loader. Basic loaders require a US or UM bearing box (located end of each tractor section). Dimension/Versa-X series loaders have the same price for Euro and Skid Steer tool carriers. Be sure to see notes section (Pg. 50-52)

If the tractor model says **MUST BE SOURCED THROUGH XXX**, then it is not available for sale through the Quicke Dealer Program due to OEM Agreements.

PRICING A DIMENSION / VERSA-X LOADER: Add list price of the base loader (#2), sub frame which includes a grill guard (#3), and hydraulic or hose set (#4)

3. Choose bucket options - see bottom of page or pages 44 - 49
4. Choose loader options - see pages 39 - 41

100 Series Loaders

1. Choose Tractor Model (#5) - Note: front axle type, CAB/ROPS and Notes
2. Choose loader model that is recommended - NSL or SL. 100 series loaders have the same price for Euro and Skid Steer Tool Carriers. If the Tractor Model says **MUST BE SOURCED THROUGH XXX**, then it is not available for sale through the Quicke Dealer Program due to OEM.

3. Add list price of the base loader, sub frame, optional grill guard, and hydraulic or hose set.

4. Choose bucket options (#10).
5. Choose loader options (#11).
6. See Notes section on pages 50-52.

DIMENSION AND VERSA-X PRICE PAGES

Tractor Model	Axle	Velocity/Notes	EURO TOOL CARRIER STANDARD ON ALL MODELS. SKID STEER AVAILABLE ON X & Q 21-46 MODELS ONLY		Versa X - Standard Duty		Versa X - Professional Duty		Mechanical Self Levelling		Q Series - Professional Duty		Q Series - Professional Duty		SUBFRAME SET		HYDRAULIC OPTIONS				
			Non-Self Levelling		Versa X - Standard Duty		Versa X - Professional Duty		Mechanical Self Levelling		Q Series - Standard Duty		Q Series - Professional Duty		Part #	\$	22" Mechanical	22" Hydraulic	22" Hook	22" Bucket	
			Price	Notes	Price	Notes	Price	Notes	Price	Notes	Price	Notes	Price	Notes							
GT45, 55 and "A"	2/4	80%/COM	4.5		Q21	54,491	Q21	54,491	Q21	54,491	Q21	54,491	Q21	54,491	14310515	\$2,071	151578AA				
GT55 and "A"	2/4	CAB	4.6		Q21	54,491	Q21	54,491	Q21	54,491	Q21	54,491	Q21	54,491	14310505	\$2,071	151558AA				
GT65, 75 and "A"	2/4	80%/COM	4.5		Q21	54,491	Q31	54,892	Q36	57,617	Q36	57,617	Q36	57,617	14310485	\$2,071	151558AA				
GT75 and "A"	2/4	CAB	4.6		Q31	54,892			Q36	57,617			Q36	57,617	14310615	\$2,071	151558AA				
LT75, 90	2/4	80%/COM	1		X41	54,014			X46	55,069			X46	55,126	14321115	\$2,071	150138FA				
LT "A" 75, 85, 90, 95 AUTO W/ TIER II and III	2/4	80%/COM	1		X41	54,014	X51	54,428	X46	55,069	X56	55,535	X46	55,126	14320815	\$2,071	150138FA				
LT "A" 75, 90 Speed Shift	2/4	80%/COM	1		X41	54,014	X51	54,428	X46	55,069	X56	55,535	X46	55,126	14322325	\$2,071	150138FA				
RT 100, 120 Auto Quad	4	CAB	3		O61	57,964			O66	59,515			O66	59,515	14320505	\$2,071	150208AA				
RT 100, 120 Dyna VT	4	CAB	3		O61	57,964			O66	59,515			O66	59,515	14320515	\$2,071	150208AA				
RT 135, 150 Auto Quad	4	CAB	3						O76	110,123			O76	110,123	14320945	\$2,071	150208AA				
RT 135, 150 Dyna VT	4	CAB	3						O76	110,123			O76	110,123	14320855	\$2,071	150208AA				
RT "A" 100, 120 TIER 2 Auto IV	4	CAB	3		O61	57,964			O66	59,515			O66	59,515	14322355	\$2,071	150208AA				
RT "A" 100, 120 TIER 2 CVT	4	CAB	3		O61	57,964			O66	59,515			O66	59,515	14322345	\$2,071	150208AA				
RT "A" 140, 155 TIER 2 Auto IV	4	CAB	3						O76	110,123			O76	110,123	14320415	\$2,071	150208AA				
RT "A" 140, 155 TIER 2 CVT	4	CAB	3						O76	110,123			O76	110,123	14320445	\$2,071	150208AA				
RT "A" 110, 120 TIER 3 Auto VI	4	CAB	3		O61	57,964			O66	59,515			O66	59,515	14325535	\$2,071	150208AA				
RT "A" 110, 120 TIER 3 CVT	4	CAB	3		O61	57,964			O66	59,515			O66	59,515	14325525	\$2,071	150208AA				
RT "A" 140, 155 TIER 3 Auto VI	4	CAB	3						O76	110,123			O76	110,123	14323295	\$2,071	150208AA				
RT "A" 140, 155 TIER 3 CVT	4	CAB	3						O76	110,123			O76	110,123	14325515	\$2,071	150208AA				
RT 165A AUTO VI Tier 3 Serial # <T175049	4	CAB	1						O88	113,533			O88	113,533	14322465	\$2,071	150208AA				
RT 165A AUTO VI Tier 3 Serial # >T189041	4	CAB	1						O88	113,533			O88	113,533	14330965	\$2,071	150208AA				
RT 180A Tier 3 CVT	4	CAB	1						O88	113,533			O88	113,533	14330965	\$2,071	150208AA				
RT 180A Tier 3 CVT	4	CAB	1						O88	113,533			O88	113,533	14331105	\$2,071	150208AA				
DT "A" 180, 200, 220, 240	4	CAB	2						O88	113,533			O88	113,533	14330115	\$2,071	151108AA				
DT "B" 205, 225, 250, 275	4	CAB	2						O88	113,533			O88	113,533	14331054	\$2,071	151176FA				
Typical Implements																					
73" 185LJ Bucket		11251941F			11251948F				X21 - X36												
85" 210LJ Bucket		11251951F			11251959F				X21 - X36												
73" 185H Bucket					11251038F				X21-X36, Q21-Q68												
83" 210H Bucket					11251048F				X41-X56, Q31-Q78												
95" 240H Bucket					11251058F				Q51 - Q88												
83" 210HD Bucket					11251078F				Q31 - Q56												
95" 240HD Bucket					11251088F				Q61 - Q88												

Notes: Refer to Pages 50 - 52

Loader Options: Refer to Pages 37 - 41

Quicke Dimension Loader Specification

Loader Model	NON SELF LEVEL										MECHANICAL SELF LEVEL									
	Q21	Q31	Q33	Q41	Q51	Q61	Q26	Q36	Q38	Q46	Q48	Q56	Q58	Q66	Q68	Q76	Q78	Q88	Q98	
Max recommended tractor weight	6614	8818	8818	9921	11464	13228	6614	8818	8818	9921	9921	11464	11464	13228	13228	15432	15432	19841	28660	
Tractor size	50-70	50-80	50-80	60-100	80-120	100-150	50-70	50-80	50-80	60-100	60-100	80-120	80-120	100-150	100-150	120-190	120-190	>150	>200	
Lift height to pivot pin	126	138	138	148	157	167	126	138	138	148	148	157	157	167	167	177	177	195	195	
Lift height under level bucket	114	124	124	136	145	155	114	126	126	136	136	145	145	155	155	165	165	183	183	
Lift capacity max lift height 31.5" from pivot pin	2623	2690	3197	3307	3616	4343	2822	2888	3505	3593	4233	3792	4431	4674	5401	4674	5357	6107	5732	
Lift capacity 59" lift height 31.5" from pivot pin	2712	2756	3307	3439	3704	4365	3020	3175	3836	3968	4652	4255	4960	4960	5710	5225	5952	6724	7077	
Lift capacity ground level 31.5" from pivot pin	2998	3064	3660	3814	4101	4696	3307	3373	4056	5211	4960	4564	5313	5137	5908	5600	6393	7363	7959	
Lift capacity max lift height at pivot pin	3814	3880	4541	4740	5093	5974	3285	3351	3968	4189	4872	4541	5225	5379	6129	5489	6217	6768	6349	
Lift capacity 59' lift height at pivot pin																				
Lift capacity ground level at pivot pin	5026	5093	5930	6195	6437	7099	4167	4233	5004	5291	6170	5556	6371	6151	6989	6592	7452	8664	9281	
Max Rollback force 31.5" from pivot pin	5181	5313	5313	6173	6261	7407	5093	5247	5247	6107	6107	6195	8488	7407	9855	8532	9877	9833	9810	
Rollback angle (degrees)	C	41	44	44	43	46	45	44	44	43	43	45	45	45	44	44	44	44	42	
Dump angle (degrees)	D	64	58	58	60	56	52	58	58	60	60	55	55	52	52	52	49	50	50	
Implement cylinder dimensions (barrel / rod)		75/40	75/40	80/40	80/40	85/40	75/40	75/40	75/40	80/40	80/40	80/40	80/40	85/40	90/40	90/40	100/50	100/50	100/50	
Lift cylinder dimensions (barrel / rod)		70/40	70/40	80/40	85/50	90/50	65/40	65/40	70/40	75/40	80/40	80/40	85/50	85/50	90/50	90/50	95/50	95/50	100/50	
Lifting time to max lift height at 60 l/min / 15.8 GPM	Sec	3.6	3.8	4.4	5.0	5.7	6.9	3.3	3.8	4.4	5.0	5.1	5.7	6.2	6.9	7.7	9.5	9.9	9.9	
Loader weight	961	992	992	1135	1221	1384	1113	1149	1149	1290	1290	1369	1369	1590	1590	1672	1672	1843	2061	

Lift heights for loaders are approximate. Heights will vary based on the tractor.



Loader Prices, Subframe Codes and Prices

Subframe widths

Model	Price	Euro	Skid Steer	System
Q21	\$4,673	X	X	DM, DS, US
Q31	\$5,090	X	X	DM, DS, US
Q33*	\$5,472	X	X	DM
Q41	\$6,333	X	X	DM, US
Q51	\$6,667	X		DM, US
Q61	\$8,285	X		DM

Non Self Level

LOADERS AVAILABLE IN COLORS (same price):

- Case Red
- John Deere Green
- Kubota Orange (USA Only)
- Massey Ferguson Red (Q21-Q61 only)
- Quicke Grey
- New Holland
- Deutz Green

Q26	\$7,071	X	X	DM, DS, US
Q36	\$7,924	X	X	DM, DS, US
Q38*	\$8,308	X	X	DM
Q46	\$8,455	X	X	
Q48*	\$8,837	X		DM
Q56	\$9,519	X		DM, US, UM
Q58*	\$9,899	X		DM
Q66	\$9,899	X		DM, UM
Q68*	\$10,227	X		DM
Q76	\$10,532	X		DM, UM
Q78*	\$10,860	X		DM
Q88	\$14,080	X		DL
Q98	\$16,303	X		DXL

Self Level Loaders

Check with your sales rep for availability

DS, DM, DL AND DXL LOADERS
Euro Tool Carrier Standard on all models.
Skid Steer Available on Q21 - Q46 Models.
MC-4 Multicoupler is Standard Equipment.
Dimensuion Series Bearing Box with Lock and Go.

US and UM (BASIC)LOADERS
Euro Tool Carrier Standard on all models.
Skid Steer Available on Q21 - Q46 Models.
Individual Flat Face Coupling is Standard.
Basic Bearing Box with Retaining Fork.

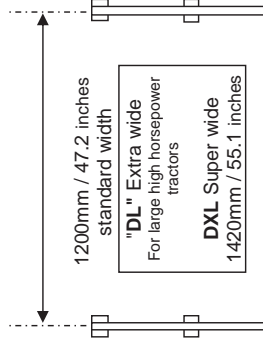
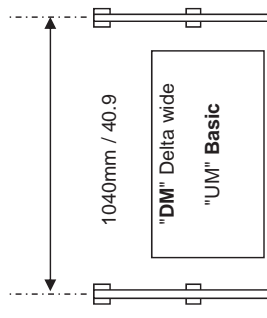
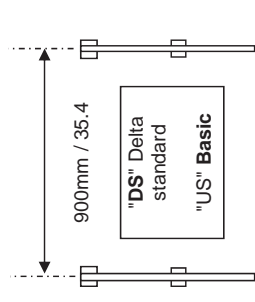

* Q33, 38, 48, 58, 68 and 78 are High Capacity alternatives to typical machines.

- Q33 is a Q31 with larger lift cylinders
- Q38 is a Q36 with larger lift cylinders
- Q48 is a Q46 with larger lift cylinders
- Q58 is a Q56 with larger lift & bucket cylinders
- Q68 is a Q66 with larger lift & bucket cylinders
- Q78 is a Q76 with larger lift & bucket cylinders



QUICKE DIMENSION SERIES PRODUCT CODES

This guide is intended to allow your customer to custom configure his loader. Orders will be placed on the factory and will be available in 8-10 weeks. Common configurations are available from Stock. When ordering loaders with short delivery times please consult your sales representative.

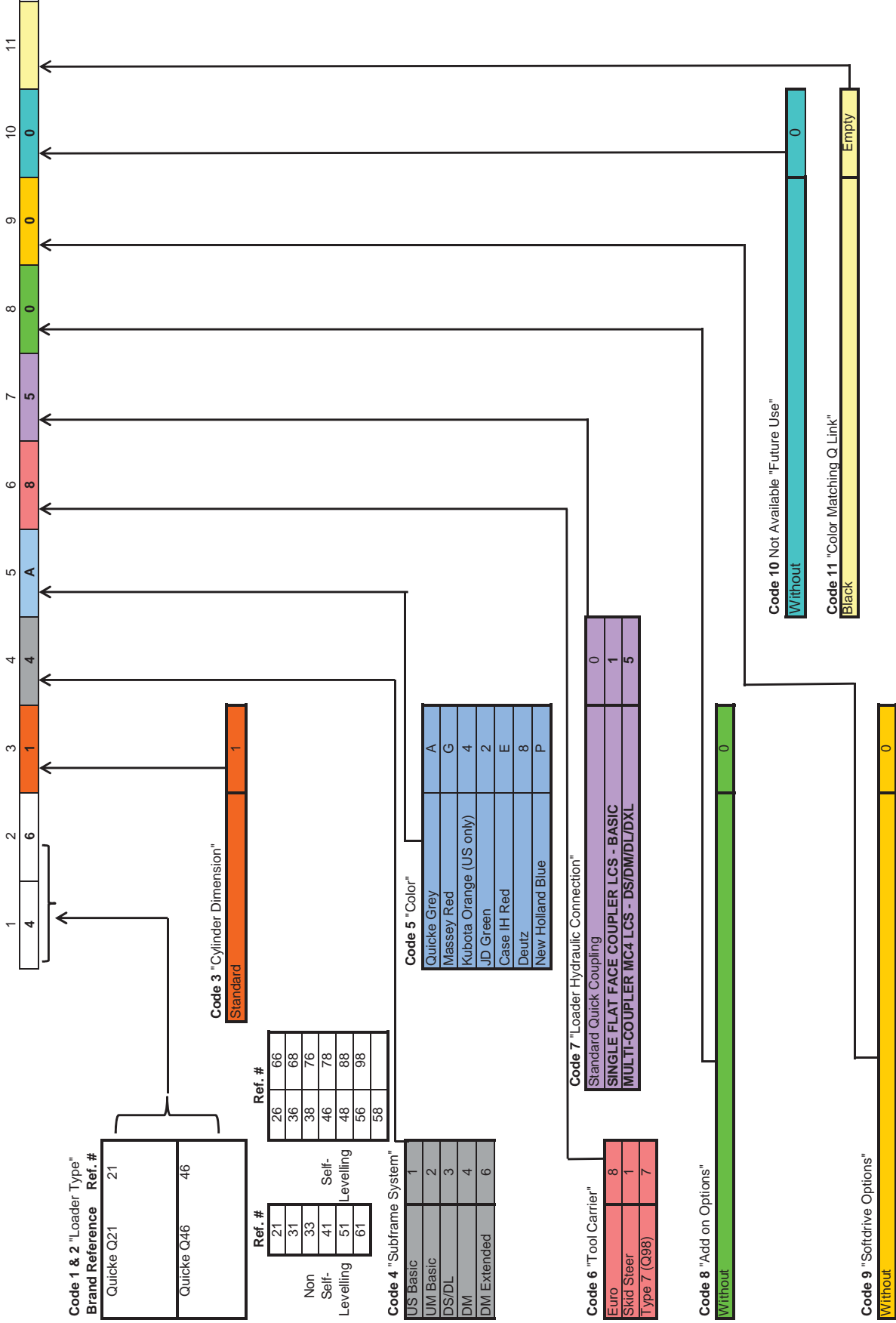

Versa-X Series Loader Specification

Loader Model	NON SELF LEVEL				MECHANICAL SELF LEVEL			
	X21	X31	X41	X51	X26	X36	X46	X56
Tractor size	40-60	50-70	60-90	70-110	40-60	50-70	60-90	70-110
Lift height to pivot pin	122	134	146	154	122	134	146	154
Lift height under level bucket	113	124	136	144	113	124	136	144
Lift capacity max lift height 31.5" from pivot pin	1920	2140	2220	2370	2680	3340	3500	3700
Lift capacity 59" lift height 31.5" from pivot pin	2660	3020	3350	3770	3080	3430	3770	4160
Lift capacity ground level 31.5" from pivot pin	3200	3540	3900	4330	3480	3660	4080	4590
Lift capacity max lift height at pivot pin	3380	3750	3980	4170	2740	3100	3330	3540
Lift capacity 59" lift height at pivot pin	4050	4480	4880	5270	3310	3720	4120	4500
Lift capacity ground level at pivot pin	5210	5540	6020	6480	4300	4640	5110	5560
Rollback Force at max lift height 31.5" from pivot pin	3140	3130	3790	4550	2550	3150	3790	4550
Rollback Force at 59" lift height 31.5" from pivot pin	4250	4370	5410	6490	3450	4350	5390	6460
Rollback Force at ground level height 31.5" from pivot pin	4140	4220	5070	6080	3300	4180	5030	6050
Digging Depth	5.9	5.9	5.9	5.9	5.9	5.9	5.9	5.9
Rollback angle (degrees)	42	44	42	43	42	44	42	43
Dump angle (degrees)	50	50	49	46	50	50	49	46
Raising time to max lift height at 60 l/min (ground level to full height)	4.1	4.8	4.1	4.7	3.5	4.1	3.6	4.1
Lowering time to max lift height at 60 l/min (full height to ground level)	3.1	3.2	2.9	3.5	1.9	2.6	2.4	2.9
Bucket dumping time (full rollback to full dump)	3.7	4.3	3.7	4.2	2.3	2.9	2.6	3.1
Bucket rollback time (full dump to full rollback)	2.8	2.9	2.6	3.1	2.3	2.9	2.6	3.1
Lift cylinder dimensions	65	70	75	80	60	65	70	75
Bucket cylinder dimensions	65/32	70/40	75/40	80/40	65/32	70/40	75/40	80/40
Loader weight	680	735	800	860	800	865	920	975

Lift heights for loaders are approximate. Heights will vary based on the tractor.

100 Series Loader Specification

Loader Model	NON SELF LEVEL			MECH SELF LEVEL		
	100C	140C	180C	160P	180P	
STANDARD EQUIPMENT →						
Tractor size	20-30	20-40	40-60	30-50	40-60	Euro or Skid Steer tool carrier
Lift height to pivot pin	75	95	103	103	110	110
Lift height under level bucket	69	88	94	94	102	102
Lift capacity max lift height 31.5" from pivot pin	463	727	1102	1102	1852	2623
Lift capacity 59" lift height 31.5" from pivot pin	595	904	1411	1411	2450	3109
Lift capacity ground level 31.5" from pivot pin	750	1124	1720	1720	3020	3703
Lift capacity max lift height at pivot pin	661	1014	1565	1565	2540	2469
Lift capacity 59" lift height at pivot pin	-	-	-	-	-	-
Lift capacity ground level at pivot pin	1080	1543	2340	2340	4030	3968
Rollback Force at max lift height 31.5" from pivot pin	-	-	-	-	-	-
Rollback Force at 59" lift height 31.5" from pivot pin	-	-	-	-	-	-
Rollback Force at ground level height 31.5" from pivot pin	2050	2310	2840	2840	5750	5730
Digging Depth	4	4	4	4	4	4
Rollback angle (degrees)	30	23	40	40	38	44
Dump angle (degrees)	51	50	53	52	53	52
Raising time to max lift height at 60 l/min (ground level to full height)	0.9	1.4	2	2	4	4
Lowering time to max lift height at 60 l/min (full height to ground level)	0.6	0.8	1.4	1.4	2.7	2.7
Bucket dumping time (full rollback to full dump)	0.9	1.4	1.4	1.4	4.6	3.3
Bucket rollback time (full dump to full rollback)	0.6	0.8	0.8	0.8	3.3	3.3
Lift cylinder dimensions	40	50	60	60	70	70
Bucket cylinder dimensions	45/25	50/32	60/32	60/32	75/40	75/40
Loader weight	386	463	529	529	617	728

Lift heights for loaders are approximate. Heights will vary based on the tractor.



Loader Prices, Color Codes, and Subframe Descriptions

Versa-X Series Non Self Level				
Model	Price	Euro	Skid	System
X21	\$3,583	x	x	DM
X31	\$3,745	x	x	DM, US
X41	\$4,176	x	x	DM, US
X51	\$4,607	x		DM, US
Versa-X Series Self Level				
X26	\$4,607	x	x	DM
X36	\$4,790	x	x	DM, US
X46	\$5,273	x	x	DM, US
X56	\$5,759	x		DM, US

Versa-X Subframe Widths

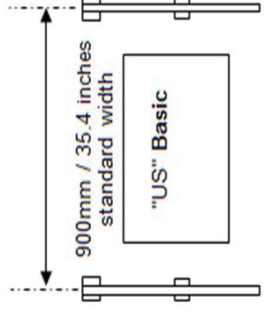

VERSAX DM, US LOADERS

- Euro Tool Carrier standard on all models.
- Skid Steer available on X21 - X46 Models.
- Individual flat face coupling is standard equipment.
- Dimension series bearing box with deluxe locking pin.

VERSAX US (BASIC) LOADERS

- Euro Tool Carrier standard on all models.
- Skid Steer available on X21 - X46 models.
- Individual flat face coupling is standard.
- Basic bearing box with retaining fork.
- Only available in Quicke Grey

VERSAX AND 100 SERIES LOADERS AVAILABLE IN COLORS:

Case Red (D) John Deere Green (1) Massey Ferguson Red (M) New Holland Blue (F) Quicke Grey (Q) Kubota Orange (K) DEUTZ GREEN (8)

* CHECK WITH YOUR REP FOR AVAILABILITY

100 Series Non Self Level				
Model	Price	Pin-on	Euro	System
100C	\$1,604	x		CM
140C	\$2,449	x		CM
160C	\$3,335		x	CM
180C	\$3,674		x	CM
100 Series Self Level				
160C	\$3,863		x	CM
180C	\$4,202		x	CM

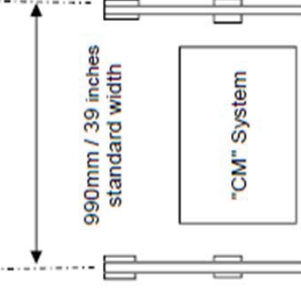

100 Series Subframe Width

100 SERIES CM LOADERS

- Pin-on Tool Carrier only on 100C and 140C models.
- Euro and Skid Steer available on 160C and 180C models.
- Pioneer coupling is standard equipment.
- CM Series bearing box with pin connection.



Versa X / 100 Series Loader Codes

This guide is intended to allow your customer to custom configure his loader. Orders will be placed on the factory and will be available in 4-6 weeks. Common configurations are available from Stock. When ordering loaders with short delivery times please consult your sales representative.

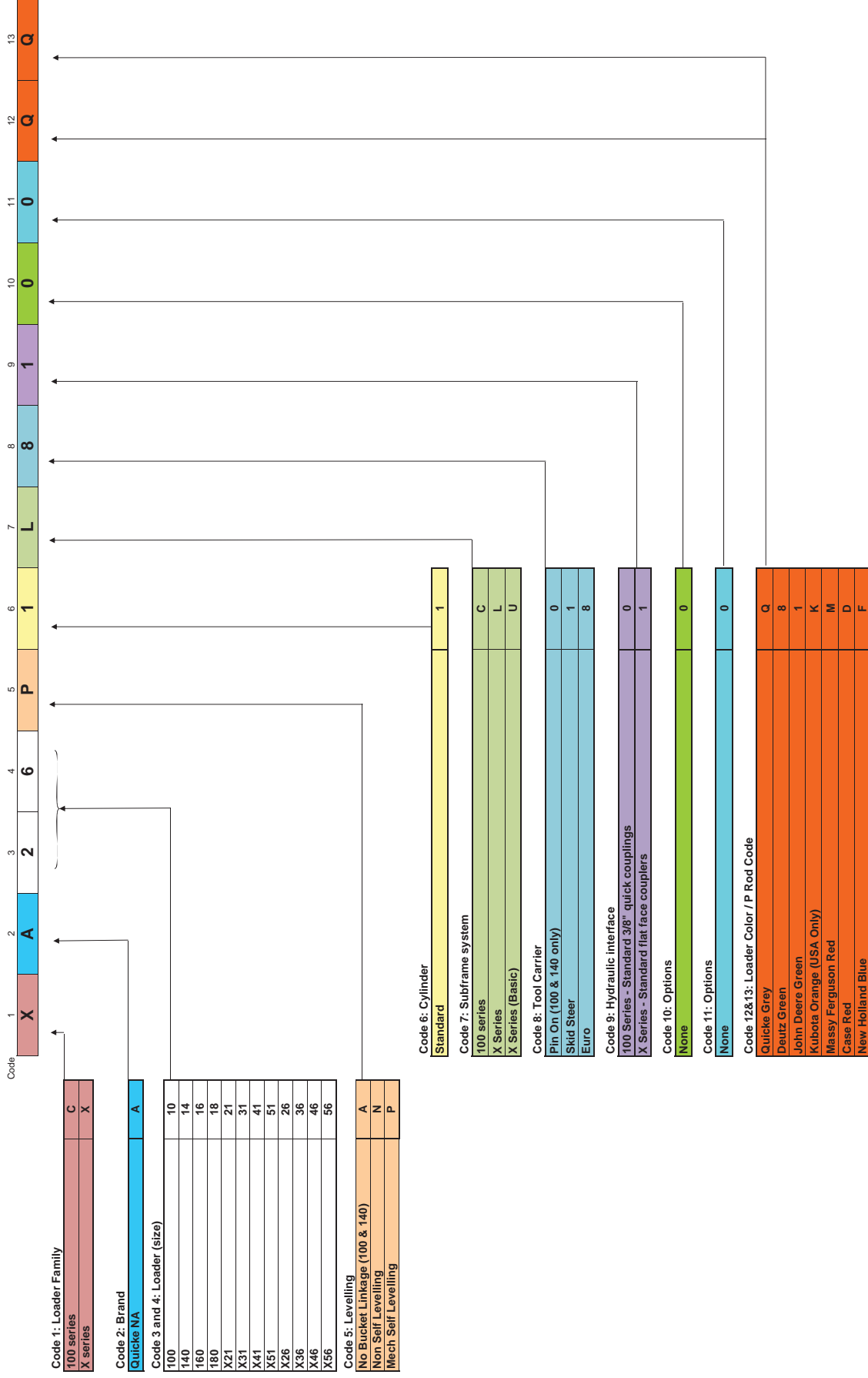

AGCO/ALLIS/WHITE

Basic Loaders

Loaders

EURO TOOL CARRIER STANDARD ON ALL MODELS. SKID STEER AVAILABLE ON X & Q 21-46 MODELS ONLY

Tractor Model	Axle	Version	Notes	Non-Self Levelling				Mechanical Self-Levelling				SUBFRAME SET	HYDRAULIC OPTIONS				
				Versa X - Standard Duty		Q Series - Professional Duty		Versa X - Standard Duty		Q Series - Professional Duty			Part #	2 Function Mechanical	2 Function Hose Kit	2 Function Electric	
				X41	X41	Q41	Q41	X46	X46	Q46	Q46						\$
AGCO																	
L170, 85 ROPS	2/4	ROPS	11,99	\$4,176	\$6,333	Q41	\$8,455	X46	\$5,273	Q46	\$8,455	345515	\$1,450	\$515	\$3,350		
L170, 85 CAB	2/4	CAB	11,99	\$4,176	\$6,333	Q41	\$8,455	X46	\$5,273	Q46	\$8,455	10347235	\$1,450	\$515	\$3,350		
RT95, 115	2/4	CAB	11,99	\$4,607	\$6,667	Q51	\$9,519	X56	\$5,759	Q56	\$9,519	345365	\$1,450	\$515	\$3,350		
RT 130, 145	4	CAB	9,12,99			Q76	\$10,532			Q76	\$10,532	320635	\$1,450	\$515	\$3,350		
AGCO ALLIS																	
8745, 8765 (Valtra Engine)	2/4	ROPS	11,99	\$4,176	\$6,333	Q41	\$8,455	X46	\$5,273	Q46	\$8,455	345495	\$1,450	\$515	\$3,350		
8745, 8765 (Cummins Engine)	2/4	ROPS	11,99	\$4,176	\$6,333	Q41	\$8,455	X46	\$5,273	Q46	\$8,455	345515	\$1,450	\$515	\$3,350		
8745, 8765 (Cummins Engine)	2/4	CAB	11,99	\$4,176	\$6,333	Q41	\$8,455	X46	\$5,273	Q46	\$8,455	10347235	\$1,450	\$515	\$3,350		
8775, 8785 (Valtra Engine)	2/4	CAB	11,99	\$4,607	\$6,667	Q51	\$9,519	X56	\$5,759	Q56	\$9,519	345355	\$1,450	\$515	\$3,350		
8775, 8785 (Cummins Engine)	2/4	CAB	11,99	\$4,607	\$6,667	Q51	\$9,519	X56	\$5,759	Q56	\$9,519	345365	\$1,450	\$515	\$3,350		
4650, 4660	2/4	ROPS	10,11,99	\$3,745	\$4,673	Q21	\$7,071	X36	\$4,790	Q26	\$7,071	341555	\$1,450	\$515	\$3,350		
5650, 5660	2/4	ROPS	10,11,99	\$3,745	\$4,673	Q21	\$7,071	X36	\$4,790	Q26	\$7,071	10347155	\$1,450	\$515	\$3,350		
5670, 5680	2/4	ROPS	10,11,99	\$4,176	\$6,333	Q31	\$5,090	X36	\$4,790	Q36	\$7,924	10347015	\$1,450	\$515	\$3,350		
8610, 8630	2/4	CAB	10,12,99			Q41	\$6,333	X46	\$5,273	Q56	\$9,519	320255	\$1,450	\$515	\$3,350		
AGCO WHITE																	
6410, 6510	2/4	ROPS	11,99	\$4,176	\$6,333	Q41	\$8,455	X46	\$5,273	Q46	\$8,455	345515	\$1,450	\$515	\$3,350		
6410, 6510	2/4	CAB	11,99	\$4,176	\$6,333	Q41	\$8,455	X46	\$5,273	Q46	\$8,455	10347235	\$1,450	\$515	\$3,350		
6710, 6810	2/4	CAB	11,99	\$4,607	\$6,667	Q51	\$9,519	X56	\$5,759	Q56	\$9,519	345365	\$1,450	\$515	\$3,350		
8310, 8410	2/4	CAB	12,99									320635	\$1,450	\$515	\$3,350		
6045	2/4	ROPS	10,11,99	\$3,745	\$4,673	Q21	\$7,071	X36	\$4,790	Q26	\$7,071	10347155	\$1,450	\$515	\$3,350		
6065 ROPS	2/4	ROPS	10,11,99	\$3,745	\$4,673	Q31	\$5,090	X36	\$4,790	Q36	\$7,924	345475	\$1,450	\$515	\$3,350		
6065 CAB	2/4	CAB	10,11,99	\$3,745	\$4,673	Q31	\$5,090	X36	\$4,790	Q36	\$7,924	341715	\$1,450	\$515	\$3,350		
6105	2/4	CAB	10,12,99									320255	\$1,450	\$515	\$3,350		

Typical Implements	Skid Steer	Euro	List Price
73" 185U Bucket	11251941F	11251948F	\$873 X21 - X36
85" 210U Bucket	11251951F	11251958F	\$957 X21 - X36
73" 185H Bucket		11251038F	\$1,221 X21-X56, Q21-Q68
83" 210H Bucket		11251048F	\$1,372 X41-X56, Q31-Q78
95" 240H Bucket		11251058F	\$1,852 Q51 - Q88
83" 210HD Bucket		11251078F	\$1,640 Q31 - Q56
95" 240HD Bucket		11251088F	\$2,271 Q51 - Q98
Bale Spike	11251694F	11251698F	\$683 ALL
Big Bale Fork	11251720F	11251728F	\$710 ALL

See Note Page after each Brand Section

For Loader Options Visit Page 53

Several Other Implement Options Available. Starting on Page 59

IT IS RECOMMENDED THAT TRACTORS ARE EQUIPPED WITH ADEQUATE COUNTER-WEIGHT. PLEASE CONTACT YOUR SALES REPRESENTATIVE FOR MORE INFORMATION



AGCO

NOTES:

1 Hydraulic Set 15097BFA for Load Sense tractors \$1,450.00

2 Deluxe Hose Set for use with factory blue joystick

3 Subframe adapted for tractors with/without 2.5 tonne front hitch

4 DS Subframe 900mm - order a DS Base Loader

6 For Tractors with Vertical Cab Corner Post Exhaust

5 For Tractors with Underslung Exhaust

6 For Tractors with Vertical Cab Corner Post Exhaust

7 Deluxe hose kit is only compatible prior to SN T262090

8 Front weight bracket must be removed

9 Not compatible with 60" tread spacing and R30 tires

10 Order conversion kit #5034021 (new loader to older valves) \$160.00

11 US Width

12 UM Width

99 Subframe is special order! Longer leadtimes should be expected. Call for availability.

IT IS RECOMMENDED THAT TRACTORS ARE EQUIPPED WITH ADEQUATE COUNTER-WEIGHT. PLEASE CONTACT YOUR SALES REPRESENTATIVE FOR MORE INFORMATION

Case IH

Loaders

EURO TOOL CARRIER STANDARD ON ALL MODELS. SKID STEER AVAILABLE ON X & Q 21-46 MODELS ONLY

Tractor Model	Axle	Version	Notes	Non-Self Levelling				Mechanical Self-Levelling				SUBFRAME SET	HYDRAULIC OPTIONS			
				Versa X - Standard Duty		Q Series - Professional Duty		Versa X - Standard Duty		Q Series - Professional Duty			Part #	2 Function Mechanical	2 Function Hose Kit	2 Function Electric
				X21	X21	Q21	Q21	X26	X26	Q26	Q26					
Farmall 65A, 75A				X21 \$3,583	Q21 \$4,673			X26 \$4,607	Q26 \$7,071			14327694	2154	15463BAA	10378214D	
FARMALL 65C,75C (STRADDLE JES)	2/4	ROPS/CAB	94	X21 \$3,583	Q21 \$4,673			X26 \$4,607	Q26 \$7,071			14323765	\$2,154	15053BAA	10378214D	
FARMALL 85C,95C (STRADDLE JES)	2/4	ROPS/CAB	94	X21 \$3,583 X31 \$3,745	Q21 \$4,673 Q31 \$5,090			X26 \$4,607 X36 \$4,790	Q26 \$7,071 Q36 \$7,924			14324025	\$2,154	15053BAA		
FARMALL 70, 80 (ANKARA)	2/4	ROPS/CAB		X21 \$3,583 X41 \$4,176	Q21 \$4,673 Q41 \$6,333			X26 \$4,607 X46 \$5,273	Q26 \$7,071 Q46 \$8,455			14325845	\$2,154	15025BAA		
FARMALL 90, 95 +JX95 (ANKARA)	2/4	ROPS/CAB		X41 \$4,176	Q41 \$6,333							14324725	\$2,154	15025BAA	10378209D	
FARMALL 85U, 95U, 105U (JES)	2/4	ROPS/CAB		X31 \$3,745 X41 \$4,176	Q31 \$5,090 Q41 \$6,333			X36 \$4,790 X46 \$5,273	Q36 \$7,924 Q46 \$8,455			14323955	\$2,154	15048BAA	10378209D	15019FCA
JX1080U, JX1090U, 1100U (JES)	2/4	ROPS/CAB		X31 \$3,745 X41 \$4,176	Q31 \$5,090 Q41 \$6,333			X36 \$4,790 X46 \$5,273	Q36 \$7,924 Q46 \$8,455			14323955	\$2,154	15048BAA		15019FCA
JX55, 60, 65, 70	2/4	ROPS/CAB		X21 \$3,583 X31 \$3,745	Q21 \$4,673 Q31 \$5,090			X26 \$4,607 X36 \$4,790	Q26 \$7,071 Q36 \$7,924			14321295	\$2,154	15025BAA		
JX75, 80, 85, 90	2/4	ROPS/CAB		X31 \$3,745 X41 \$4,176	Q31 \$5,090 Q41 \$6,333			X36 \$4,790 X46 \$5,273	Q36 \$7,924 Q46 \$8,455			14321285	\$2,154	15025BAA	10378214D	
JX1060C, 1070C, 1075C	2/4	ROPS/CAB	18	X21 \$3,583 X31 \$3,745	Q21 \$4,673 Q31 \$5,090			X26 \$4,607 X36 \$4,790	Q26 \$7,071 Q36 \$7,924			14321994	\$2,154	15023BAA	10378214D	
JX1085C, 1095C	2/4	ROPS/CAB		X21 \$3,583 X31 \$3,745	Q21 \$4,673 Q31 \$5,090			X26 \$4,607 X36 \$4,790	Q26 \$7,071 Q36 \$7,924			14324025	\$2,154	15023BAA		
JX1075N, JX1095N	4	ROPS/CAB	4,15,16	X21 \$4,673	Q21 \$4,673				Q26 \$7,071			14310324	\$2,154	15086BAA	10378209D	
JX70U, 80U, 90U, 100U	2/4	ROPS/CAB		X31 \$3,745 X41 \$4,176	Q31 \$5,090 Q41 \$6,333			X36 \$4,790 X46 \$5,273	Q36 \$7,924 Q46 \$8,455			14321215	\$2,154	15048BAA		15019FCA
JX1075N, JX1095N	4	ROPS/CAB	4,15,16	X21 \$4,673	Q21 \$4,673				Q26 \$7,071			14310324	\$2,154	15086BAA		
MXU 100, 110 Limited	2/4	ROPS/CAB		X41 \$4,176 X51 \$4,607	Q41 \$6,333 Q51 \$6,667			X46 \$5,273 X56 \$5,759	Q46 \$8,455 Q56 \$9,519			14323354	\$2,520	15039BAA	10378338D	15039FCA
Maxxum 110, 120, 130 T3	2/4	ROPS/CAB		X41 \$4,176 X51 \$4,607	Q41 \$6,333 Q51 \$6,667			X46 \$5,273 X56 \$5,759	Q46 \$8,455 Q56 \$9,519			14324847	\$2,520	15302BAB	10378137D	15039FCA
MXU 115, 130 Value (Open Center)	2/4	ROPS/CAB			Q51 \$6,667	Q61 \$8,285			Q56 \$9,519			14323364	\$2,520	15018BAB	10378137D	15021FCA
MXU 115, 125, 135 Limited (Closed Center)	2/4	ROPS/CAB			Q51 \$6,667	Q61 \$8,285			Q56 \$9,519			14323364	\$2,520	15039BAA	10378338D	15039FCA
Maxxum 115,125,140 T3	2/4	ROPS/CAB			Q51 \$6,667	Q61 \$8,285			Q56 \$9,519			14324857	\$2,520	15302BAB		15039FCA
MX 180 - 335	4	CAB	17						Q88 \$14,080			14330044	\$3,537	15090BAA		15090FCA
Magnum 180-280 (Teir 3)	4	CAB	17						Q88 \$14,080			14330044	\$3,537	15090BAA		15090FCA

Typical Implements	Skid Steer	Euro	List Price
73" 185U Bucket	11251941F	11251948F	\$873
85" 210U Bucket	11251951F	11251958F	\$957
73" 185H Bucket		11251038F	\$1,221
83" 210H Bucket		11251048F	\$1,372
95" 240H Bucket		11251058F	\$1,852
83" 210HD Bucket		11251078F	\$1,640
95" 240HD Bucket		11251088F	\$2,271
Bale Spike	11251694F	11251698F	\$683
Big Bale Fork	11251720F	11251728F	\$710

See Note Page after each Brand Section

For Loader Options Visit Page 53

Several Other Implement Options Available. Starting on Page 59

IT IS RECOMMENDED THAT TRACTORS ARE EQUIPPED WITH ADEQUATE COUNTER-WEIGHT. PLEASE CONTACT YOUR SALES REPRESENTATIVE FOR MORE INFORMATION



Version Date: Oct 1, 2016

Issue Date: Jan 1, 2016

Page 6

Version Date: Oct 1, 2016

Case IH

Loaders

EURO TOOL CARRIER STANDARD ON ALL MODELS. SKID STEER AVAILABLE ON X & Q 21-46 MODELS ONLY

Tractor Model	Axle	Version	Notes	Non-Self Levelling				Mechanical Self-Levelling				SUBFRAME SET	HYDRAULIC OPTIONS												
				Versa X - Standard Duty		Q Series - Professional Duty		Versa X - Standard Duty		Q Series - Professional Duty			Part #	\$	2 Function Mechanical	2 Function Hose Kit	2 Function Electric								
				X31	X41	X41	X41	Q31	Q41	Q31	Q41							\$							
685-985, 695-995, 3230-4240, C70 - C100 4WD	2/4	ROPS/CAB	13	X31	\$3,745	X41	\$4,176	Q31	\$5,090	Q41	\$6,333	X36	\$4,790	X46	\$5,273	Q36	\$7,924	Q46	\$8,455	14322205	\$2,154	317204			
685-985, 695-995, 3230-4240, C70 - C100 2WD	2	ROPS	94	X31	\$3,745			Q31	\$5,090			X36	\$4,790			Q36	\$7,924			14322244	\$2,154	10317683			
CX70, 80, 90, 100	2/4	ROPS/CAB	94	X31	\$3,745	X41	\$4,176	Q31	\$5,090	Q41	\$6,333	X36	\$4,790	X46	\$5,273	Q36	\$7,924	Q46	\$8,455	14322675	\$2,154	15040BAA		15040FCA	
5130 - 5250 6 Cylinder	2/4	ROPS/CAB		X41	\$4,176	X51	\$4,607	Q41	\$6,333	Q51	\$6,667	X46	\$5,273	X56	\$5,759	Q46	\$9,519	Q56	\$9,899	14320144	\$2,520	15054BAC		15044FCA	
MX80C - 100C	4	ROPS/CAB	14					Q61	\$8,285							Q66	\$9,899	Q76	\$10,532	14320044	\$2,960	15044BAA		15044FCA	
MX100-135	2/4	ROPS/CAB	14					Q61	\$8,285							Q76	\$10,532			14320044	\$2,960	15044BAA	10378137D	15044FCA	
MX150-170	2/4	ROPS/CAB	14					Q61	\$8,285							Q66	\$9,899			14322834	\$2,960	15089BAA	10378137D		
MXM 130, 140 Value (Open Center)	2/4	ROPS/CAB	87					Q61	\$8,285							Q66	\$9,899			14322834	\$2,960	15052BAA	10378137D	15052FCA	
MXM 120, 130, 140, 155 Pro (Closed Center)	2/4	ROPS/CAB	87													Q76	\$10,532			14322834	\$2,960	15052BAA		15052FCA	
MXM 175, 190 Pro	2/4	ROPS/CAB	87													Q88	\$14,080			14330924	\$3,537	15079BAA		15079FCA	
Magnum 7110 - 8950	2/4	CAB														Q46	\$8,455			14326114	\$2,154	15054BAC			
5120	2/4	ROPS/CAB		X41	\$4,176			Q41	\$6,333			X46	\$5,273			Q46	\$8,455								

Typical Implements	Skid Steer	Euro	List Price
73" 185U Bucket	11251941F	11251948F	\$873
85" 210U Bucket	11251951F	11251958F	\$957
73" 185H Bucket		11251038F	\$1,221
83" 210H Bucket		11251048F	\$1,372
95" 240H Bucket		11251058F	\$1,852
83" 210HD Bucket		11251078F	\$1,640
95" 240HD Bucket		11251088F	\$2,271
Bale Spike	11251694F	11251698F	\$683
Big Bale Fork	11251720F	11251728F	\$710

CASE IH

NOTES:

- 4 DS Subframe 900mm - order a DS Base Loader
- 10 Order conversion kit #5034021 (new loader to older valves) \$160.00
- 11 US Width
- 12 UM Width
- 13 For Cab Tractors order hydraulic set 317204 \$1,450.00
- 14 For tractors without Bosch Valve or Power Beyond Plate use Hyd Set 15063BAC \$1,450.00
- 15 For ROPS Tractors order Hyd Set 15076BAA \$1,450.00
- 16 Subframe designed for Horizontal Exhaust only
- 17 Tractor must be equipped with Power Beyond Plate
- 18 Subframe includes Front Brackets only. If tractor does not have rear brackets, order 14321996 at \$0 as well.
- 94 If tractor does not have pre-installed connections to hydraulic auxiliary valve, use 15024BAA. \$1,450.00
- 99 Subframe is special order! Longer leadtimes should be expected. Call for availability.
- B7 Subframe includes Front Brackets only. If tractor does not have rear brackets, order 14322836 at \$0 as well.

IT IS RECOMMENDED THAT TRACTORS ARE EQUIPPED WITH ADEQUATE COUNTER-WEIGHT. PLEASE CONTACT YOUR SALES REPRESENTATIVE FOR MORE INFORMATION

CHALLENGER

NOTES:

11 US Width

12 UM Width

19 Order Ergodrive 15325BAA load sensing for serial numbers up to 1008085 (2008) \$1,450.00

99 Subframe is special order! Longer leadtimes should be expected. Call for availability.

IT IS RECOMMENDED THAT TRACTORS ARE EQUIPPED WITH ADEQUATE COUNTER-WEIGHT. PLEASE CONTACT YOUR SALES REPRESENTATIVE FOR MORE INFORMATION

Deutz

Loaders

EURO TOOL CARRIER STANDARD ON ALL MODELS. SKID STEER AVAILABLE ON X & Q 21-46 MODELS ONLY

Tractor Model	Axle	Version	Notes	Non-Self Levelling				Mechanical Self-Levelling				SUBFRAME SET	HYDRAULIC OPTIONS				
				Versa X - Standard Duty		Q Series - Professional Duty		Versa X - Standard Duty		Q Series - Professional Duty			Part #	2 Function Mechanical	2 Function Hose Kit	2 Function Electric	
				X21	X31	X41	Q21	Q31	X26	X36	X46						Q26
Agrolux 45 - 75	4	Rops	B8,B8,C1														
Agroplus 310,315,320 + Ecoline	4	Cab/Rops	0	X21 \$3,583	X31 \$3,745	X41 \$4,176	Q21 \$4,673	Q31 \$5,090	X26 \$4,607	X36 \$4,790	X46 \$5,273	Q26 \$7,071	Q36 \$7,924	14327165	\$2,154	15183BAA	\$3,350
Agroplus 410, 420 + Ecoline	4	Cab/Rops	0	X21 \$3,583	X31 \$3,745	X41 \$4,176	Q21 \$4,673	Q31 \$5,090	X26 \$4,607	X36 \$4,790	X46 \$5,273	Q26 \$7,071	Q36 \$7,924	14325495	\$2,154	15184BAA	
Agrofarm 85, 100, 410, 420 and 430	2/4	Cab/Rops	20	X31 \$3,745	X41 \$4,176	X41 \$4,176	Q31 \$5,090	Q41 \$6,333	X36 \$4,790	X46 \$5,273	X46 \$5,273	Q36 \$7,924	Q46 \$8,455	14325505	\$2,154	15184BAA	
Agrofarm TTV420 and TTV430 + Profile	2/4	Cab/Rops	20	X31 \$3,745	X41 \$4,176	X41 \$4,176	Q31 \$5,090	Q41 \$6,333	X36 \$4,790	X46 \$5,273	X46 \$5,273	Q36 \$7,924	Q46 \$8,455	14324585	\$2,154	15154BAA	15154FCA
Agrofarm 85, 100, 410, 420 and 430	2/4	Cab/Rops	20	X31 \$3,745	X41 \$4,176	X41 \$4,176	Q31 \$5,090	Q41 \$6,333	X36 \$4,790	X46 \$5,273	X46 \$5,273	Q36 \$7,924	Q46 \$8,455	14324585	\$2,154	15154BAA	15154FCA
Agrofarm TTV420 and TTV430 + Profile	2/4	Cab/Rops	20	X31 \$3,745	X41 \$4,176	X41 \$4,176	Q31 \$5,090	Q41 \$6,333	X36 \$4,790	X46 \$5,273	X46 \$5,273	Q36 \$7,924	Q46 \$8,455	14324585	\$2,154	15154BAA	15154FCA
Agrofarm 410T and 420T	2/4	Rops		X31 \$3,745	X41 \$4,176	X41 \$4,176	Q31 \$5,090	Q41 \$6,333	X36 \$4,790	X46 \$5,273	X46 \$5,273	Q36 \$7,924	Q46 \$8,455	14325335	\$2,154	15154BAA	15154FCA
Agrofarm 410TB and 420TB	2/4	Rops		X31 \$3,745	X41 \$4,176	X41 \$4,176	Q31 \$5,090	Q41 \$6,333	X36 \$4,790	X46 \$5,273	X46 \$5,273	Q36 \$7,924	Q46 \$8,455	14325345	\$2,154	15154BAA	15154FCA
Agrotron K90-120, K410,420 and 430	4	Cab	21	X41 \$4,176	X51 \$4,607	X51 \$4,607	Q41 \$6,333	Q51 \$6,667	X46 \$5,273	X56 \$5,759	X56 \$5,759	Q46 \$8,455	Q56 \$9,519	14322824	\$2,520	15032BAA	15032FCA
Agrotron K90-120, K410,420, 430 (Profile)	4	Cab		X41 \$4,176	X51 \$4,607	X51 \$4,607	Q41 \$6,333	Q51 \$6,667	X46 \$5,273	X56 \$5,759	X56 \$5,759	Q46 \$8,455	Q56 \$9,519	14322824	\$2,520	15170FCA	15170FCA
Agrotron K-110 & K-610 + Profile	4	Cab					Q51 \$6,667	Q61 \$8,285				Q56 \$9,519	Q66 \$9,899	14322774	\$2,960		15170FCA
Agrotron M410 & M420 + Profile	4	Cab	22,24				Q51 \$6,667	Q61 \$8,285				Q56 \$9,519	Q66 \$9,899	14326744	\$2,960		15010FCA
Agrotron TTV 410, 420, 430	4	Cab					Q51 \$6,667	Q61 \$8,285				Q56 \$9,519	Q66 \$9,899	14326744	\$2,960		15270FCC
Agrotron M600 - M625 + Profile	4	Cab	24				Q51 \$6,667	Q61 \$8,285				Q56 \$9,519	Q66 \$9,899	14324124	\$2,960		15010FCA
Agrotron M640 + Profile	4	Cab					Q61 \$8,285	Q61 \$8,285				Q66 \$9,899	Q76 \$10,532	14324084	\$2,960		15010FCA
Agrotron TTV 610 and TTV 620	4	Cab					Q61 \$8,285	Q61 \$8,285				Q66 \$9,899	Q76 \$10,532	14324084	\$2,960		15182FCA
Agrotron M650 + Profile	4	Cab										Q76 \$10,532	Q88 \$14,080	14324064	\$2,960		15010FCA
Agrotron TTV 630, TTV7210, 7230, 7275	4	Cab												14331175	\$3,537		15254FCC
5100, 5110, 5120, 5130	4	Cab		X41 \$4,176	X51 \$4,607	X51 \$4,607	Q41 \$6,333	Q51 \$6,667	X46 \$5,273	X56 \$5,759	X56 \$5,759	Q46 \$8,455	Q56 \$9,519	14326664	\$2,154	15317BAA	
5100, 5110, 5120, 5130 Profile and TTV	4	Cab/Rops	26	X41 \$4,176	X51 \$4,607	X51 \$4,607	Q41 \$6,333	Q51 \$6,667	X46 \$5,273	X56 \$5,759	X56 \$5,759	Q46 \$8,455	Q56 \$9,519	14326664	\$2,154	15340BAA	
Agrotron 6150, 6160	4	Cab	24,26,27				Q51 \$6,667	Q61 \$8,285				Q56 \$9,519	Q66 \$9,899	14326394	\$2,520	15270BAC	15270FCC
Agrotron 6150, 6160 Profile and TTV	4	Cab	27				Q51 \$6,667	Q61 \$8,285				Q56 \$9,519	Q66 \$9,899	14326394	\$2,520	10378301B	15270FCC
Agrotron 6150.4, 6160.4	4	Cab	24,26,27	X41 \$4,176	X51 \$4,607	X51 \$4,607	Q41 \$6,333	Q51 \$6,667	X46 \$5,273	X56 \$5,759	X56 \$5,759	Q46 \$8,455	Q56 \$9,519	14327134	\$2,520	15357BAC	15357FCC
Agrotron 6150.4, 6160.4 Profile and TTV	4	Cab	27	X41 \$4,176	X51 \$4,607	X51 \$4,607	Q41 \$6,333	Q51 \$6,667	X46 \$5,273	X56 \$5,759	X56 \$5,759	Q46 \$8,455	Q56 \$9,519	14327134	\$2,520	15357BAC	15357FCC
Agrotron 6180, 6190	4	Cab	24,26,27				Q61 \$8,285	Q61 \$8,285				Q66 \$9,899	Q76 \$10,532	14326304	\$2,960	15342BAC	15342FCC
Agrotron 6180, 6190 Profile and TTV	4	Cab	27				Q61 \$8,285	Q61 \$8,285				Q66 \$9,899	Q76 \$10,532	14326304	\$2,960	10378301B	15342FCC

Typical Implements	Euro	List Price
Skid Steer		
73" 185U Bucket	11251948F	\$873
85" 210U Bucket	11251958F	\$957
73" 185H Bucket	11251038F	\$1,221
83" 210H Bucket	11251048F	\$1,372
95" 240H Bucket	11251058F	\$1,852
83" 210HD Bucket	11251078F	\$1,640
95" 240HD Bucket	11251088F	\$2,271
Bale Spike	11251694F	\$683
Big Bale Fork	11251720F	\$710
<p>Several Other Implement Options Available. Starting on Page 59</p>		
<p>See Note Page after each Brand Section</p>		
<p>For Loader Options Visit Page 53</p>		

DEUTZ

NOTES:

- 20 Loader Q31/Q36 must be ordered with long bearing boxes for tractors with front wheels larger than 420/70 R24.
- 21 If tractor has 75 litre hyd pump & no front-axle suspension, a special plug is needed for L-S signal. Order from SDF: Ref No: 04454514.4.
- 22 Hose kit 10377307C does not fit tractors with air pressure equipment.
- 23 Tractors manufactured after 2006-09-01 and without front-axle suspension a special plug is needed for L-S signal. Order from SDF: Ref No. 04454514.4.
- 24 Hose kit 10378307C doesn't fit tractors equipped with adaptor plate at rear hydraulics for front hitch.
- 25 For Tractors w/o Power beyond. Order shuttle valve 2.3729.686.0 from SDF
- 26 Adapted for tractors with or without front axle suspension
- 27 If tractor is equipped with Sauter front hitch, contact Sauter for more information.
- B8 Designed for tractors with under slung exhaust pipe.
- B9 Will only fit 4wd tractors.
- C1 Only fits tractors manufactured after 1st Jan 2008

IT IS RECOMMENDED THAT TRACTORS ARE EQUIPPED WITH ADEQUATE COUNTER-WEIGHT. PLEASE CONTACT YOUR SALES REPRESENTATIVE FOR MORE INFORMATION

John Deere

Loaders

EURO TOOL CARRIER STANDARD ON ALL MODELS. SKID STEER AVAILABLE ON X & Q 21-46 MODELS ONLY

Tractor Model	Axle	Version	Notes	Non-Self Levelling										Mechanical Self-Levelling										SUBFRAME SET		HYDRAULIC OPTIONS		
				Versa X - Standard Duty					Q Series - Professional Duty					Versa X - Standard Duty					Q Series - Professional Duty					Part #	\$	2 Function Mechanical	2 Function Hose Kit	2 Function Electric
				X21	X31	X31	X31	X31	Q21	Q21	Q31	Q31	Q31	X26	X36	X36	X36	X36	Q26	Q26	Q36	Q36	Q36					
5045E, 5055E, 5065E, 5075E (Teir 3)	2/4	ROPS/CAB	33	\$3,583	\$3,745	\$3,745	\$4,673	\$5,090	\$5,090	Q21	\$4,673	Q31	\$5,090	\$5,090	X26	\$4,607	X36	\$4,790	\$4,790	\$7,071	Q36	\$7,924	\$7,924	14328604	\$2,154	\$1,450	\$515	\$3,350
5045E, 5055E, 5065E, 5075E (Teir 4)	2/4	ROPS/CAB	33	\$3,583	\$3,745	\$3,745	\$4,673	\$5,090	\$5,090	Q21	\$4,673	Q31	\$5,090	\$5,090	X26	\$4,607	X36	\$4,790	\$4,790	\$7,071	Q36	\$7,924	\$7,924	14328784	\$2,154			
5085E, 5100E (Teir 3)	2/4	ROPS/CAB		\$3,745			\$5,090			Q31	\$5,090				X36	\$4,790				\$7,924				14327084	\$2,154			
5085E, 5100E (Teir4)	2/4	ROPS/CAB		\$3,745			\$5,090			Q31	\$5,090				X36	\$4,790				\$7,924				14328944	\$2,154			
5083E, 5093E, 5101E, 5425, 5525, 5625, 5603	2/4	ROPS/CAB	35	\$3,583	\$3,745	\$3,745	\$4,673	\$5,090	\$5,090	Q21	\$4,673	Q31	\$5,090	\$5,090	X26	\$4,607	X36	\$4,790	\$4,790	\$7,071	Q26	\$7,924	\$7,924	14325964	\$2,154	15082BAA	10378047D	
5065M, 5075M, 5085M (Teir 3&4)	2/4	ROPS/CAB		\$3,745			\$5,090			Q31	\$5,090				X36	\$4,790				\$7,924				14325324	\$2,154			
5095M, 5105M, 5100M, 5115M (Teir 3&4)	2/4	ROPS/CAB		\$3,745			\$5,090			Q31	\$5,090				X36	\$4,790				\$7,924				14325324	\$2,154			
6100D, 6115D, 6130D, 6140D T3	2/4	ROPS/CAB		\$4,176	X51	\$4,607	Q41	\$6,333	Q51	\$6,667	Q51	\$6,667		X46	\$5,273	X56	\$5,759	Q46	\$8,455	Q56	\$9,519	\$9,519	14324814	\$2,154	15141BAA	10378096D	15141FCA	
61105D, 6115D, 6130D, 60140D T4	2/4	ROPS/CAB		\$4,176	X51	\$4,607	Q41	\$6,333	Q51	\$6,667	Q51	\$6,667		X46	\$5,273	X56	\$5,759	Q46	\$8,455	Q56	\$9,519	\$9,519	14329094	\$2,960	0	10378240D		
6105E, 6120E, 6135E T4F	2/4	ROPS/CAB		\$4,176	X51	\$4,607	Q41	\$6,333	Q51	\$6,667	Q51	\$6,667		X46	\$5,273	X56	\$5,759	Q46	\$8,455	Q56	\$9,519	\$9,519	14329094	\$2,960	0	10378240D		
6105M, 6115M, 6125M	2/4	ROPS/CAB	37,4042,C4				\$6,667	Q51	\$8,285	Q61	\$8,285							Q56	\$9,519	Q66	\$9,899	\$9,899	14328584	\$2,520	15304BAA	10378435D	15304FCA	
6105R, 6110R, 6115R, 6120R, 6125R	2/4	ROPS/CAB	37,4042,C4				\$6,667	Q51	\$8,285	Q61	\$8,285							Q56	\$9,519	Q66	\$9,899	\$9,899	14328584	\$2,520	15304BAA	10378435D	15304FCA	
6130M, 6140M, 6150M	2/4	ROPS/CAB	38,C4				\$8,285	Q61	\$8,285									Q66	\$9,899	Q76	\$10,532	\$10,532	14329024	\$2,960	15304BAA	10378435D	15304FCA	
6135M, 6145M, 6155M	2/4	ROPS/CAB	38,C4				\$8,285	Q61	\$8,285									Q66	\$9,899	Q76	\$10,532	\$10,532	14329024	\$2,960	15304BAA	10378435D	15304FCA	
6130R, 6140R, 6150R	2/4	ROPS/CAB	38,C4				\$8,285	Q61	\$8,285									Q66	\$9,899	Q76	\$10,532	\$10,532	14329024	\$2,960	15304BAA	10378435D	15304FCA	
6135R, 6145R	2/4	ROPS/CAB	38,C4				\$8,285	Q61	\$8,285									Q66	\$9,899	Q76	\$10,532	\$10,532	14329024	\$2,960	15304BAA	10378435D	15304FCA	
6170M, 6190M, 6210M	2/4	CAB	36,43,44															Q76	\$10,532	Q86	\$14,080	\$14,080	14329034	\$2,960	15406BAA	10378435D	15406FCA	
6175M, 6195M, 6215M	2/4	CAB	36,43,44															Q76	\$10,532	Q86	\$14,080	\$14,080	14329034	\$2,960	15406BAA	10378435D	15406FCA	
6170R, 6190R, 6210R	2/4	CAB	36,43,44															Q76	\$10,532	Q86	\$14,080	\$14,080	14329034	\$2,960	15406BAA	10378435D	15406FCA	
6175R, 6195R, 6215R	2/4	CAB	36,43,44															Q76	\$10,532	Q86	\$14,080	\$14,080	14329034	\$2,960	15406BAA	10378435D	15406FCA	
7200R, 7210R, 7215R, 7230R	2/4	CAB																Q88	\$14,080	Q98	\$16,303	\$16,303	14331124	\$3,537				
7250R, 7260R, 7270R, 7280R, 7290R	2/4	CAB																Q88	\$14,080	Q98	\$16,303	\$16,303	14331124	\$3,537				
8245R, 8270R, 8295R, 8320R, 8335R, 8345R	2/4	CAB	39															Q98	\$16,303	Q98	\$16,303	\$16,303	14340024	\$4,173				

Typical Implements

Typical Implements	Skid Steer	Euro	List Price
73" 185U Bucket	11251941F	11251948F	\$873
85" 210U Bucket	11251951F	11251958F	\$957
73" 185H Bucket		11251038F	\$1,221
83" 210H Bucket		11251048F	\$1,372
95" 240H Bucket		11251058F	\$1,852
83" 210HD Bucket		11251078F	\$1,640
95" 240HD Bucket		11251088F	\$2,271
Bale Spike	11251694F	11251698F	\$683
Big Bale Fork	11251720F	11251728F	\$710

See Note Page after each Brand Section

For Loader Options Visit Page 53

Several Other Implement Options Available. Starting on Page 59

IT IS RECOMMENDED THAT TRACTORS ARE EQUIPPED WITH ADEQUATE COUNTER-WEIGHT. PLEASE CONTACT YOUR SALES REPRESENTATIVE FOR MORE INFORMATION



John Deere

Loaders

EURO TOOL CARRIER STANDARD ON ALL MODELS. SKID STEER AVAILABLE ON X & Q 21-46 MODELS ONLY

Tractor Model	Axle	Version	Notes	Non-Self Levelling				Mechanical Self-Levelling				SUBFRAME SET		HYDRAULIC OPTIONS				
				Versa X - Standard Duty		Q Series - Professional Duty		Versa X - Standard Duty		Q Series - Professional Duty		Part #	\$	2 Function Mechanical	2 Function Hose Kit	2 Function Electric		
				X21	X21	X21	X21	X26	X26	X26	X26							
5105, 5205	2/4	ROPS																
5103, 5203, 5303, 5403	2/4	ROPS																
5225, 5325	2/4	ROPS/CAB	31,32															
6403	2/4	ROPS																
6603	2/4	ROPS/CAB																
6000, 6100, 6200, 6300, 6400, 6405	2/4	ROPS/CAB	0															
6010, 6110, 6210, 6310, 6410	2/4	ROPS/CAB	0															
6215, 6415, 6120, 6220, 6320, 6420	2/4	ROPS/CAB	28,29															
7200, 7300, 7400	2/4	ROPS/CAB																
7210, 7310, 7410, 7510, 6605, 7405	2/4	ROPS/CAB																
7600, 7700, 7800, 7610, 7710, 7810	2/4	CAB	34															
6615, 6715, 7220, 7320, 7420, 7520	2/4	ROPS/CAB	29															
6120L, 6220L, 6320L, 6420L, 6520L	2/4	ROPS/CAB	29															
6230L, 6330L, 6430L	2/4	ROPS/CAB	29															
6230, 6330, 6430	2/4	ROPS/CAB	28,29,30															
7130, 7230, 7330	2/4	ROPS/CAB	30															
7430, 7530	2/4	ROPS/CAB	29,30															
7720, 7820, 7920, 7630, 7730, 7830, 7930	2/4	CAB																
8100 - 8400, 8110 - 8410	2/4	CAB																
2350, 2355 - 2750, 2755	2/4	ROPS/CAB	41															

Typical Implements	Skid Steer	Euro	List Price
73" 185U Bucket	11251941F	11251948F	\$873
85" 210U Bucket	11251951F	11251958F	\$957
73" 185H Bucket		11251038F	\$1,221
83" 210H Bucket		11251048F	\$1,372
95" 240H Bucket		11251058F	\$1,852
83" 210HD Bucket		11251078F	\$1,640
95" 240HD Bucket		11251088F	\$2,271
Bale Spike	11251694F	11251698F	\$683
Big Bale Fork	11251720F	11251728F	\$710

Several Other Implement Options Available. Starting on Page 59

See Note Page after each Brand Section

For Loader Options Visit Page 53



JOHN DEERE

NOTES:

11	US Width
12	UM Width
28	Q41 and Q46 will fit if tires are less than 14.9X24
29	For Tractors built prior to 2004, use Hydraulic Set 15006BAA, also fits tractors built after 2004 with 3 remotes \$1,450.00
30	To use hydraulic set, Non Premium Tractors must be equipped with John Deere Power Beyond Plate
31	For "N" Narrow only use Q21 or Q26
32	Q21, Q26 not compatible with the front weight bracket
33	Tractor must be equiped with JD power beyond plate # R259621 and adaptor set # RE251179.
34	Q61/Q66 is compatible with 2WD
35	Order subframe 14324824 for tractors produced before SN 340001
36	If the tractor has a front hitch,order subframe 14326154 \$2,520.00
37	If the tractor has a front hitch, order subframe 14326364 \$2,520.00
38	If the tractor has a front hitch, order subframe 14326314 \$2,520.00
39	If the tractor has Zuidberg front hitch, order subframe 14340034 \$4,173.00
40	Q51/Q56/Q58 is not compatible with front hitch.
41	Required to order part # RE58763 & R196840 from JD for hydraulic connection.
45	Power beyond plate for Hydraulic Set must be ordered from John Deere
46	Order conversion kit #5034021 (new loader to older valves) \$160.00
47	Hose kit serviced from rear remotes
49	IF Cab TractorJoystick Bracket must be fabricated.
99	Subframe is special order! Longer leadtimes should be expected. Call for availability.
C4	Subframe Set does not include Grill Guard. Order Grill Guard for tractors without front hitch 14220130 \$425.00

IT IS RECOMMENDED THAT TRACTORS ARE EQUIPPED WITH ADEQUATE COUNTER-WEIGHT. PLEASE CONTACT YOUR SALES REPRESENTATIVE FOR MORE INFORMATION

NOTES:

Kubota

Loaders

EURO TOOL CARRIER STANDARD ON ALL MODELS. SKID STEER AVAILABLE ON X & Q 21-46 MODELS ONLY

Tractor Model	Axle	Version	Notes	Non-Self Levelling				Mechanical Self-Levelling				SUBFRAME SET		HYDRAULIC OPTIONS		
				Versa X - Standard Duty		Q Series - Professional Duty		Versa X - Standard Duty		Q Series - Professional Duty		Part #	\$	2 Function Mechanical	2 Function Hose Kit	2 Function Electric
				X21	X31	Q21	Q31	X26	X36	Q26	Q36					
M5040-M7040, M5060-7060	2/4	ROPS/CAB	50	X21 \$3,583	Q21 \$4,673	X26 \$4,607	Q26 \$7,071	X36 \$4,790	Q36 \$7,924	14322734	\$2,154	152038EA	15203FCA	\$1,450	\$515	\$3,350
M8540, 9540	2/4	ROPS/CAB	50,51	X31 \$3,745	Q31 \$5,090	X36 \$4,790	Q36 \$7,924	X36 \$4,790	Q36 \$7,924	14322604	\$2,154	152038EA	15301FCA			
M8560, M9960 TIER 4I	2/4	ROPS/CAB		X31 \$3,745	Q31 \$5,090	X36 \$4,790	Q36 \$7,924	X36 \$4,790	Q36 \$7,924	14322604	\$2,154	15301BEA	15301FCA			
M955, M1055	2/4	CAB		X31 \$3,745	Q31 \$5,090	X41 \$4,176	Q41 \$6,333	X36 \$4,790	Q46 \$8,455	14321274	\$2,154	151258AA	15188FCA			
M965, M1085	2/4	ROPS/CAB	51	X41 \$4,176	Q41 \$6,333			X46 \$5,273	Q46 \$8,455	14323344	\$2,154	15188BAA	15188FCA			
M95X, M105X, M108X	2/4	CAB		X41 \$4,176	Q41 \$6,333			X46 \$5,273	Q46 \$8,455	14324194	\$2,154	15188BAA	15188FCA			
M100X, M110X	2/4	CAB		X41 \$4,176	Q41 \$6,333			X46 \$5,273	Q46 \$8,455	14324914	\$2,154	15188BAA	15188FCA			
M110, M120	2/4	CAB		X51 \$4,607	Q51 \$6,667			X56 \$5,759	Q56 \$9,519	14321234	\$2,154	151338AA	15188FCA			
M125X	2/4	CAB		X51 \$4,607	Q51 \$6,667			X56 \$5,759	Q56 \$9,519	14321234	\$2,154	15188BAA	15188FCA			
M126X, M135X	2/4	CAB		X51 \$4,607	Q51 \$6,667			X56 \$5,759	Q56 \$9,519	14324684	\$2,520	15188BAA	15188FCA			
M100GXDTC, M110GXDTC	2/4	CAB		X41 \$4,176	Q41 \$6,333			X46 \$5,273	Q46 \$8,455	14326374	\$2,520	15297BAA	15297FCA			
M126GXDTC, M135GXDTC	2/4	CAB		X51 \$4,607	Q51 \$6,667			X56 \$5,759	Q56 \$9,519	14326104	\$2,520	15297BAA	15297FCA			
M47/49/54/57/6800 ROPS	2/4	ROPS		X21 \$3,583	Q21 \$4,673			X26 \$4,607	Q26 \$7,071	14321504	\$2,154	151328AA				
M47/49/54/57/6800 CAB	2/4	CAB		X21 \$3,583	Q21 \$4,673			X26 \$4,607	Q26 \$7,071	14321504	\$2,154	151268AA				
M8200, M9000 ROPS	2/4	ROPS	51	X31 \$3,745	Q31 \$5,090			X36 \$4,790	Q36 \$7,924	14321714	\$2,154	151298AA				
M8200, M9000 CAB	2/4	CAB	0	X31 \$3,745	Q31 \$5,090			X36 \$4,790	Q36 \$7,924	14321714	\$2,154	151268AA				
M5-091, 101	2/4	ROPS/CAB		X31 \$3,745	Q31 \$5,090			X36 \$4,790	Q36 \$7,924	14328367	\$2,154	154208EA	15420FCA			
M6-101, 111	2/4	ROPS/CAB		X41 \$4,176	Q41 \$6,333			X46 \$5,273	Q46 \$8,455	14328277	\$2,520	154218AA	15421FCA			
M6-131, 141	2/4	ROPS/CAB		X51 \$4,607	Q51 \$6,667			X56 \$5,759	Q56 \$9,519	14328287	\$2,520	154218AA	15421FCA			
M7-131,151,171	2/4	ROPS/CAB	C5	0 #N/A	Q1 \$8,285	0 #N/A	Q61 \$8,285	0 #N/A	Q56 \$9,519	14328824	\$2,540	154218AA	15421FCA			

Typical Implements

	Skid Steer	Euro	List Price
73" 185U Bucket	11251941F	11251948F	\$873
85" 210U Bucket	11251951F	11251958F	\$957
73" 185H Bucket		11251038F	\$1,221
83" 210H Bucket		11251048F	\$1,372
95" 240H Bucket		11251058F	\$1,852
83" 210HD Bucket		11251078F	\$1,640
95" 240HD Bucket		11251088F	\$2,271
Bale Spike	11251694F	11251698F	\$683
Big Bale Fork	11251720F	11251728F	\$710

See Note Page after each Brand Section

For Loader Options Visit Page 53

Several Other Implement Options Available. Starting on Page 59



IT IS RECOMMENDED THAT TRACTORS ARE EQUIPPED WITH ADEQUATE COUNTER-WEIGHT. PLEASE CONTACT YOUR SALES REPRESENTATIVE FOR MORE INFORMATION

KUBOTA

NOTES:

4 DS Subframe 900mm - order a DS Base Loader

11 US Width

46 Order conversion kit #5034021 (new loader to older valves) \$160.00

50 For M5040 ROPS < SN 83013/M6085/9540 ROPS < SN 21001/M7040 ROPS < SN 13001 / M6040 CAB < SN 83098 / M7040 CAB < SN 83151 / M8540 CAB < SN 83060 / M9540 CAB < SN 83314 - Order Hydraulic Kit No. 15124BEA \$1,450.00

51 Low Profile models will require modifications to the underslung exhaust.

52 Requires Retaining Fork Set 10348131 (\$0)

99 Subframe is special order! Longer leadtimes should be expected. Call for availability.

C5 If Tractor is not equipped with Loader ready mounts order 60011324 \$450.00

IT IS RECOMMENDED THAT TRACTORS ARE EQUIPPED WITH ADEQUATE COUNTER-WEIGHT. PLEASE CONTACT YOUR SALES REPRESENTATIVE FOR MORE INFORMATION

Landini

Loaders

EURO TOOL CARRIER STANDARD ON ALL MODELS. SKID STEER AVAILABLE ON X & Q 21-46 MODELS ONLY

Tractor Model	Axle	Version	Notes	Non-Self Levelling										Mechanical Self-Levelling										SUBFRAME SET			HYDRAULIC OPTIONS		
				Versa X - Standard Duty					Q Series - Professional Duty					Versa X - Standard Duty					Q Series - Professional Duty					Part #	\$	2 Function Mechanical	2 Function Hose Kit	2 Function Electric	
				X21	X31	X31	X41	X41	Q21	Q31	Q31	Q41	Q41	X26	X36	X36	X46	X46	Q26	Q36	Q36	Q46	Q46						
Alpine 70, 80, 85 Tier 3 STD / GT	4	ROPS/CAB	99	X21	\$3,583	X31	\$3,745	Q21	\$4,673	Q31	\$5,090	X26	\$4,607	X36	\$4,790	Q26	\$7,071	Q36	\$7,924	Q46	\$8,455	14324905	\$2,154	15056BAA	\$1,450	15056FCA	\$3,350		
Powerfarm 60 TIER 2	4	ROPS/CAB	99	X31	\$3,745	Q31	\$5,090	Q31	\$5,090	Q41	\$6,333	X36	\$4,790	Q36	\$7,924	Q36	\$7,924	Q46	\$8,455	14322105	\$2,154	15198BAA	\$1,450	15198BAA	\$3,350				
Powerfarm 75-105 TIER 2 & 90-110 TIER 3	4	ROPS/CAB	99	X31	\$3,745	X41	\$4,176	Q31	\$5,090	Q41	\$6,333	X36	\$4,790	X46	\$5,273	Q36	\$7,924	Q46	\$8,455	14324755	\$2,154	15199BAA	\$1,450	15199BAA	\$3,350				
5-090H, 5-100H, 5-110H	2/4	ROPS/CAB	99	X31	\$3,745	Q31	\$5,090	Q31	\$5,090	Q41	\$6,333	X36	\$4,790	Q36	\$7,924	Q36	\$7,924	Q46	\$8,455	14325925	\$2,154	15199BAA	\$1,450	15199BAA	\$3,350				
Vision 80, 85, 90 TIER 2	4	ROPS/CAB	99	X31	\$3,745	X41	\$4,176	Q31	\$5,090	Q41	\$6,333	X36	\$4,790	X46	\$5,273	Q36	\$7,924	Q46	\$8,455	14324795	\$2,154	15064BAA	\$1,450	15064BAA	\$3,350				
Vision 95 - 105 TIER 2 & 3	4	ROPS/CAB	99	X41	\$4,176	X51	\$4,607	Q41	\$6,333	Q51	\$6,667	X46	\$5,273	X56	\$5,759	Q46	\$8,455	Q56	\$9,519	14324795	\$2,154	15064BAA	\$1,450	15064BAA	\$3,350				
Powermondial 100, 105, 115	4	CAB	99	X41	\$4,176	X51	\$4,607	Q41	\$6,333	Q51	\$6,667	X46	\$5,273	X56	\$5,759	Q46	\$8,455	Q56	\$9,519	14324615	\$2,520	15042BAA	\$1,450	15042BAA	\$3,350				
Landpower 125, 135 TIER 2	4	CAB	99	Q61	\$8,285	Q61	\$8,285	Q61	\$8,285	Q61	\$8,285	Q66	\$9,899	Q66	\$9,899	Q66	\$9,899	Q76	\$10,532	14323605	\$2,960	15072BAA	\$1,450	15072BAA	\$3,350				
Landpower 145 TIER 2	4	CAB	99	Q61	\$8,285	Q61	\$8,285	Q61	\$8,285	Q61	\$8,285	Q66	\$9,899	Q66	\$9,899	Q66	\$9,899	Q76	\$10,532	14323025	\$2,960	15072BAA	\$1,450	15072BAA	\$3,350				
Landpower 165, 185 TIER 2	4	CAB	99	Q61	\$8,285	Q61	\$8,285	Q61	\$8,285	Q61	\$8,285	Q66	\$9,899	Q66	\$9,899	Q66	\$9,899	Q76	\$10,532	14323025	\$2,960	15072BAA	\$1,450	15072BAA	\$3,350				
Landpower 125, 135 TIER 3	4	CAB	99	Q61	\$8,285	Q61	\$8,285	Q61	\$8,285	Q61	\$8,285	Q66	\$9,899	Q66	\$9,899	Q66	\$9,899	Q76	\$10,532	14324155	\$2,960	15072BAA	\$1,450	15072BAA	\$3,350				
Landpower 145 TIER 3	4	CAB	54,99	Q61	\$8,285	Q61	\$8,285	Q61	\$8,285	Q61	\$8,285	Q66	\$9,899	Q66	\$9,899	Q66	\$9,899	Q76	\$10,532	14324465	\$2,960	15072BAA	\$1,450	15072BAA	\$3,350				
Landpower 165, 185 TIER 3	4	CAB	54,99	Q21	\$4,673	Q21	\$4,673	Q21	\$4,673	Q21	\$4,673	Q26	\$7,071	Q26	\$7,071	Q26	\$7,071	Q36	\$7,924	14324465	\$2,960	15072BAA	\$1,450	15072BAA	\$3,350				
Rex 75, 85, 95, 105 F/GE Tier 2	4	ROPS/CAB	4,99,C3	Q21	\$4,673	Q21	\$4,673	Q21	\$4,673	Q21	\$4,673	Q26	\$7,071	Q26	\$7,071	Q26	\$7,071	Q36	\$7,924	14310665	\$2,154	15066BAA	\$1,450	15066BAA	\$3,350				
Rex 80, 90, 100, 110 F/GE Tier 3	4	ROPS/CAB	4,99,C3	Q21	\$4,673	Q21	\$4,673	Q21	\$4,673	Q21	\$4,673	Q26	\$7,071	Q26	\$7,071	Q26	\$7,071	Q36	\$7,924	14310665	\$2,154	15066BAA	\$1,450	15066BAA	\$3,350				
5865 ROPS	2	ROPS	99	X21	\$3,583	Q21	\$4,673	Q21	\$4,673	Q21	\$4,673	X26	\$4,607	Q26	\$7,071	Q26	\$7,071	Q36	\$7,924	14323575	\$2,154	15068BAA	\$1,450	15068BAA	\$3,350				
6865, 8865	2/4	ROPS	99	X31	\$3,745	X41	\$4,176	Q31	\$5,090	Q41	\$6,333	X36	\$4,790	X46	\$5,273	Q36	\$7,924	Q46	\$8,455	14322765	\$2,154	15068BAA	\$1,450	15068BAA	\$3,350				
Mythos 90, 100, 105	4	CAB	99	X41	\$4,176	X51	\$4,607	Q41	\$6,333	Q51	\$6,667	X46	\$5,273	X56	\$5,759	Q46	\$8,455	Q56	\$9,519	14323015	\$2,154	15069BAC	\$1,450	15069BAC	\$3,350				
Mythos 115	4	CAB	99	Q51	\$6,667	Q61	\$8,285	Q61	\$8,285	Q61	\$8,285	Q56	\$9,519	Q66	\$9,899	Q66	\$9,899	Q76	\$10,532	14320285	\$2,520	15069BAC	\$1,450	15069BAC	\$3,350				
Legend 115-135 NG	4	CAB	54,55,99	Q61	\$8,285	Q61	\$8,285	Q61	\$8,285	Q61	\$8,285	Q66	\$9,899	Q66	\$9,899	Q66	\$9,899	Q76	\$10,532	14320265	\$2,960	15071BAA	\$1,450	15071BAA	\$3,350				
Legend 140 - 185 NG	4	CAB	54,55,99	Q61	\$8,285	Q61	\$8,285	Q61	\$8,285	Q61	\$8,285	Q66	\$9,899	Q66	\$9,899	Q66	\$9,899	Q76	\$10,532	14320275	\$2,960	15071BAA	\$1,450	15071BAA	\$3,350				

Typical Implements	Skid Steer	Euro	List Price
73" 185U Bucket	11251941F	11251948F	\$873
85" 210U Bucket	11251951F	11251958F	\$957
73" 185H Bucket		11251038F	\$1,221
83" 210H Bucket		11251048F	\$1,372
95" 240H Bucket		11251058F	\$1,852
83" 210HD Bucket		11251078F	\$1,640
95" 240HD Bucket		11251088F	\$2,271
Bale Spike	11251694F	11251698F	\$683
Big Bale Fork	11251720F	11251728F	\$710

Several Other Implement Options Available. Starting on Page 59

Issue Date: Jan 1, 2016 Page 28 Version Date: Oct 1, 2016

IT IS RECOMMENDED THAT TRACTORS ARE EQUIPPED WITH ADEQUATE COUNTER-WEIGHT. PLEASE CONTACT YOUR SALES REPRESENTATIVE FOR MORE INFORMATION



LANDINI

NOTES:

4 DS Subframe 900mm - order a DS Base Loader

11 US Width

46 Order conversion kit #5034021 (new loader to older valves) \$160.00

54 Will only fit FIXED front axle

55 Adapted for Models with Serial Number S

56 Will not fit Tractors with Tier 2 Green engines

99 Subframe is special order! Longer leadtimes should be expected. Call for availability.

C3 Does not fit tractors with electric mid valves

IT IS RECOMMENDED THAT TRACTORS ARE EQUIPPED WITH ADEQUATE COUNTER-WEIGHT. PLEASE CONTACT YOUR SALES REPRESENTATIVE FOR MORE INFORMATION

NOTES:

Massey Ferguson

Must Be Sourced Through AGCO

Tractor Model		Axle	Version	Notes	Loaders						SUBFRAME SET		HYDRAULIC OPTIONS			
EURO TOOL CARRIER STANDARD ON ALL MODELS. SKID STEER AVAILABLE ON X & Q 21-46 MODELS ONLY					Non-Self Levelling			Mechanical Self-Levelling			Part #	\$	2 Function Mechanical	2 Function Hose Kit	2 Function Electric	
Versa X - Standard Duty	Q Series - Professional Duty	Versa X - Standard Duty	Q Series - Professional Duty	Versa X - Standard Duty	Q Series - Professional Duty	Versa X - Standard Duty	Q Series - Professional Duty	2 Function Mechanical	2 Function Hose Kit	2 Function Electric						
2605, 2615, 2625, 2635																
4608, 4609, 4610																
5609, 5610, 5611, 5612, 5613																
6614, 6615, 6616																
7619, 7620, 7622 DYNA IV Classic Cab																
7619, 7620, 7622 DYNA IV Deluxe & Premium																
7619, 7620, 7622 CVT Deluxe & Premium																
7624, 7626 DYNA IV Classic Cab																
7624, 7626 DYNA IV Deluxe & Premium																
7624 CVT Deluxe & Premium Cab																
8650, 8660, 8670, 8680 TIER 3 and Tier 4i																

Typical Implements	Skid Steer	Euro	List Price
73" 185U Bucket	11251941F	11251948F	\$873
85" 210U Bucket	11251951F	11251958F	\$957
73" 185H Bucket	11251038F	11251038F	\$1,221
83" 210H Bucket	11251048F	11251048F	\$1,372
95" 240H Bucket	11251058F	11251058F	\$1,852
83" 210HD Bucket	11251078F	11251078F	\$1,640
95" 240HD Bucket	11251088F	11251088F	\$2,271
Bale Spike	11251694F	11251698F	\$683
Big Bale Fork	11251720F	11251728F	\$710

See Note Page after each Brand Section

For Loader Options Visit Page 53

Loader Options: Refer to Pages 37 - 41



Massey Ferguson

Loaders

EURO TOOL CARRIER STANDARD ON ALL MODELS. SKID STEER AVAILABLE ON X & Q 21-46 MODELS ONLY

Tractor Model	Axle	Version	Notes	Non-Self Levelling				Mechanical Self-Levelling				SUBFRAME SET		HYDRAULIC OPTIONS				
				Versa X - Standard Duty		Q Series - Professional Duty		Versa X - Standard Duty		Q Series - Professional Duty		Part #	\$	2 Function Mechanical	2 Function Hose Kit	2 Function Electric		
				X31	X41	X31	Q41	X36	X46	Q36	Q46							
5425, 35 Tier 2 & 3 Dyna IV (Perkins)	2/4	ROPS/CAB	58,59,60	X31 \$3,745	X41 \$4,176	Q31 \$5,090	Q41 \$6,333	X36 \$4,790	X46 \$5,273	Q36 \$7,924	Q46 \$8,455	14324425	\$2,154	15013BFA	10378252A	\$1,450	\$515	\$3,350
5445, 55, 60 Tier 2 & 3 Dyna IV (Perkins)	2/4	ROPS/CAB	58,60	X41 \$4,176	Q41 \$6,333	Q41 \$6,333	Q41 \$6,333	X46 \$5,273	Q46 \$8,455	Q46 \$8,455	Q46 \$8,455	14324425	\$2,154	15013BFA	10378252A			
5425, 35, 45, 55, 60 with Speed Shift	2/4	ROPS/CAB	58,59,60	X31 \$3,745	X41 \$4,176	Q31 \$5,090	Q41 \$6,333	X36 \$4,790	X46 \$5,273	Q36 \$7,924	Q46 \$8,455	14322625	\$2,154	15013BFA				
5460 Teir 3 DynaIV (SISU)	2/4	CAB	60,61			Q51 \$6,667	Q61 \$8,285			Q56 \$9,519	Q66 \$9,899	14324855	\$2,154	15013BFA				
5465 with Speed Shift TIER 2	2/4	CAB	60,61			Q51 \$6,667	Q61 \$8,285			Q56 \$9,519	Q66 \$9,899	14320455	\$2,154	15013BFA				
5465 with DYNA IV TIER 2	2/4	CAB	60,61			Q51 \$6,667	Q61 \$8,285			Q56 \$9,519	Q66 \$9,899	14321305	\$2,520	15013BFA				
5465, 75 Teir 3 Dyna IV (Perkins)	2/4	CAB	60,61			Q51 \$6,667	Q61 \$8,285			Q56 \$9,519	Q66 \$9,899	14322155	\$2,520	15013BFA				
5465, 75 Teir 3 Dyna IV (SISU)	2/4	CAB	60,61			Q51 \$6,667	Q61 \$8,285			Q56 \$9,519	Q66 \$9,899	14326245	\$2,520	15013BFA				
6465, 75, 80 with DYNA Shift TIER 2	2/4	CAB	62,65,64,68			Q61 \$8,285	Q61 \$8,285			Q66 \$9,899	Q66 \$9,899	14320395	\$2,520	15020BAA				
6465, 75, 80 with DYNA VI TIER 2	2/4	CAB	62,65,64,68			Q61 \$8,285	Q61 \$8,285			Q66 \$9,899	Q66 \$9,899	14321305	\$2,520	15020BAA				
6465, 75, 80 with DYNA VI TIER 3 (PERKINS)	4	CAB	62,66,67,68			Q61 \$8,285	Q61 \$8,285			Q66 \$9,899	Q66 \$9,899	14322155	\$2,520	15020BAA				15014FCA
6465, 75, 80 with DYNA VI TIER 3 (SISU)	4	CAB	62,66,67,68			Q61 \$8,285	Q61 \$8,285			Q66 \$9,899	Q66 \$9,899	14326235	\$2,520	15014BFA	10378252A			15014FCA
6485, 90, 95 with DYNA Shift TIER 2	4	CAB	69							Q76 \$10,532	Q76 \$10,532	14320415	\$2,960	15020BAA				
6485, 90, 95 with DYNA VI TIER 3	4	CAB	62,65,67,69							Q76 \$10,532	Q76 \$10,532	14323295	\$2,960	15014BFA	10378252A			15014FCA
6497, 6499 with DYNA VI TIER 2 (SISU)	4	CAB	69							Q76 \$10,532	Q76 \$10,532	14320865	\$2,960	15112BAA				
6497, 6499 with DYNA VI TIER 3 <176049	4	CAB	65,68							Q76 \$10,532	Q76 \$10,532	14322465	\$2,960	15014BFA				
6497, 6499 with DYNA VI TIER 3 >T189041	4	CAB	62,67,68							Q76 \$10,532	Q76 \$10,532	14323295	\$2,960	15014BFA	10378252A			15014FCA
7465, 75, 80 with DYNA VT TIER 2	2/4	CAB	62,68							Q66 \$9,899	Q66 \$9,899	14320435	\$2,520	15020BAA				
7485, 90, 95 with DYNA VT TIER 2	4	CAB	68							Q76 \$10,532	Q76 \$10,532	14320445	\$2,960	15020BAA				
7465, 75, 80 with DYNA VT TIER 3 (PERKINS)	4	CAB	62,67,68							Q66 \$9,899	Q66 \$9,899	14323125	\$2,520	15020BAA				15014FCA
7465, 75, 80 with DYNA VT TIER 3 (SISU)	4	CAB	62,67,68							Q66 \$9,899	Q66 \$9,899	14326225	\$2,520	15014BFA	10378252A			15014FCA
8450, 60, 70, 80	4	CAB								Q88 \$14,080	Q88 \$14,080	14330115	\$3,537	15110BAA				
2650, 2660, 2670, 2680 HD	2/4	ROPS/CAB	57	X31 \$3,745	X41 \$4,176	Q31 \$5,090	Q41 \$6,333	X36 \$4,790	X46 \$5,273	Q36 \$7,924	Q46 \$8,455	14325795	\$2,154	15102BAA				
3625, 3635, 3645	2/4	ROPS/CAB		X21 \$3,583	Q21 \$4,673	Q21 \$4,673	Q21 \$4,673	Q21 \$4,673	Q21 \$4,673	Q26 \$7,071	Q26 \$7,071	14325755	\$2,154	15109BAA				

Typical Implements	Skid Steer	Euro	List Price
73" 185U Bucket	11251941F	11251948F	\$873 X21 - X36
85" 210U Bucket	11251951F	11251958F	\$957 X21 - X36
73" 185H Bucket		11251038F	\$1,221 X21-X56, Q21-Q56
83" 210H Bucket		11251048F	\$1,372 X41-X56, Q31-Q78
95" 240H Bucket		11251058F	\$1,852 Q51 - Q88
83" 210HD Bucket		11251078F	\$1,640 Q31 - Q56
95" 240HD Bucket		11251088F	\$2,271 Q51 - Q98
Bale Spike	11251694F	11251698F	\$683 ALL
Big Bale Fork	11251720F	11251728F	\$710 ALL

See Note Page after each Brand Section

For Loader Options Visit Page 53

Massey Ferguson

Loaders

EURO TOOL CARRIER STANDARD ON ALL MODELS. SKID STEER AVAILABLE ON X & Q 21-46 MODELS ONLY

Tractor Model	Axle	Version	Notes	Non-Self Levelling				Mechanical Self-Levelling				SUBFRAME SET		HYDRAULIC OPTIONS		
				Versa X - Standard Duty		Q Series - Professional Duty		Versa X - Standard Duty		Q Series - Professional Duty		Part #	\$	2 Function Mechanical	2 Function Hose Kit	2 Function Electric
				X21	X31	Q21	Q31	X26	X36	Q26	Q36					
431, 461	4	ROPS		X21 \$3,583	Q21 \$4,673	X26 \$4,607	Q26 \$7,071			14321454	\$2,154	15113BAA				
471, 481 ROPS	2/4	ROPS	75	X31 \$3,745	Q31 \$5,090	X36 \$4,790	Q36 \$7,924			14321684	\$2,154	15114BAA				
471, 481 CAB	2/4	CAB	75	X31 \$3,745	Q31 \$5,090	X36 \$4,790	Q36 \$7,924			14323595	\$2,154	15102BAA				
491, 492 ROPS	2/4	ROPS		X41 \$4,176	Q41 \$6,333	X46 \$5,273	Q46 \$8,455			14321425	\$2,154	15114BAA				
491, 492 CAB	2/4	CAB		X41 \$4,176	Q41 \$6,333	X46 \$5,273	Q46 \$8,455			14321975	\$2,154	15102BAA				
533, 543, 563	4	ROPS		X21 \$3,583	Q21 \$4,673	X26 \$4,607	Q26 \$7,071			14321454	\$2,154	15107BAA				
3435, 3445, 3455 F & S Narrow	4	ROPS/CAB	71	X21 \$3,583	Q21 \$4,673	X26 \$4,607	Q26 \$7,071			14322074	\$2,154	15114BAA				
251XE, 451	4	ROPS	46	X21 \$3,583	Q21 \$4,673	X26 \$4,607	Q26 \$7,071			14321674	\$2,154	10317736				
573, 583	2/4	ROPS/CAB	74	X31 \$3,745	Q31 \$5,090	X36 \$4,790	Q36 \$7,924			14323595	\$2,154	15098BAA				
593, 596 ROPS	2/4	ROPS		X41 \$4,176	Q41 \$6,333	X46 \$5,273	Q46 \$8,455			14321425	\$2,154	15098BAA				
593, 596 CAB	2/4	CAB		X41 \$4,176	Q41 \$6,333	X46 \$5,273	Q46 \$8,455			14321975	\$2,154	15102BAA				
265, 271, 281, 283	2/4	ROPS	46	X31 \$3,745	Q31 \$5,090	X36 \$4,790	Q36 \$7,924			14321684	\$2,154	317284				
271 X/XE, 281 X/XE	2/4	ROPS		X31 \$3,745	Q31 \$5,090	X36 \$4,790	Q36 \$7,924			14321684	\$2,154	15113BAA				
4225 - 4355, 4365	2/4	CAB		X31 \$3,745	Q31 \$5,090	X36 \$4,790	Q36 \$7,924			14320915	\$2,154	15096BAA				
4260, 4270, 4360, 4370	2/4	CAB		X51 \$4,607	Q51 \$6,667	X56 \$5,759	Q56 \$9,519			14320925	\$2,154	15096BAA				
6260 - 6280	2/4	CAB	72		Q61 \$8,285		Q66 \$9,899			14320295	\$2,520	15108BAA				
6290`	2/4	CAB	72		Q61 \$8,285		Q66 \$9,899			14320295	\$2,520	15108BAA				
6110 - 6140, 3050 - 3065	2/4	CAB	73	X31 \$3,745	Q31 \$5,090	X36 \$4,790	Q36 \$7,924			14323815	\$2,154	15106BAA				
6160 - 6180	2/4	CAB	73		Q51 \$6,667		Q56 \$9,519			14323835	\$2,520	15180BAA				

Typical Implements

	Skid Steer	Euro	List Price
73" 185U Bucket	11251941F	11251948F	\$873
85" 210U Bucket	11251951F	11251958F	\$957
73" 185H Bucket		11251038F	\$1,221
83" 210H Bucket		11251048F	\$1,372
95" 240H Bucket		11251058F	\$1,852
83" 210HD Bucket		11251078F	\$1,640
95" 240HD Bucket		11251088F	\$2,271
Bale Spike	11251694F	11251698F	\$683
Big Bale Fork	11251720F	11251728F	\$710

See Note Page after each Brand Section

For Loader Options Visit Page 53

Several Other Implement Options Available. Starting on Page 59



Massey Ferguson

Basic Loaders

Loaders

EURO TOOL CARRIER STANDARD ON ALL MODELS. SKID STEER AVAILABLE ON X & Q 21-46 MODELS ONLY

Tractor Model	Axle	Version	Notes	Non-Self Levelling				Mechanical Self-Levelling				SUBFRAME SET		HYDRAULIC OPTIONS					
				Versa X - Standard Duty		Q Series - Professional Duty		Versa X - Standard Duty		Q Series - Professional Duty		Part #	\$	2 Function Mechanical	2 Function Hose Kit	2 Function Electric			
				X31	X31	Q21	Q31	X36	X36	Q26	Q36			\$1,450	\$515	\$3,350			
240, 243, 253, 263	4	ROPS	11,4699					X36	\$4,790			Q26	\$7,071	346274	\$2,154	317251			
261'	2	ROPS	11,4699					X36	\$4,790			Q26	\$7,071	344444	\$2,154	317282			
362'	2/4	ROPS	11,7699					X36	\$4,790	X41	\$4,176	Q31	\$5,090	344455	\$2,154	15212BAA			
362'	4	ROPS	11,7799					X36	\$4,790	X41	\$4,176	Q31	\$5,090	344614	\$2,154	15212BAA			
375 - 398	2/4	ROPS/CAB	11,4678,99					X36	\$4,790	X41	\$4,176	Q31	\$5,090	343375	\$2,154	317234			
375 - 398	2/4	ROPS/CAB	11,4679,99					X36	\$4,790	X41	\$4,176	Q31	\$5,090	341505	\$2,154	317234			
399'	2/4	ROPS/CAB	11,7899					X41	\$4,176	X51	\$4,607	Q41	\$6,667	340215	\$2,154	15212BAA			
399'	4	ROPS/CAB	11,7899					X51	\$4,607			Q51	\$6,667	343415	\$2,154	15212BAA			
6150'	2/4	CAB	11,99					X41	\$4,176	X51	\$4,607	Q41	\$6,667	343845	\$2,154	15106BAA			
4225 - 4355, 4365	2/4	ROPS	11,8099					X31	\$3,745	X41	\$4,176	Q31	\$5,090	346015	\$2,154	15096BAA			
4260, 4270, 4360, 4370	2/4	ROPS	11,99					X41	\$4,176	X51	\$4,607	Q41	\$6,667	346025	\$2,154	15096BAA			

Typical Implements	Skid Steer	Euro	List Price
73" 185U Bucket	11251941F	11251948F	\$873
85" 210U Bucket	11251951F	11251958F	\$957
73" 185H Bucket		11251038F	\$1,221
83" 210H Bucket		11251048F	\$1,372
95" 240H Bucket		11251058F	\$1,852
83" 210HD Bucket		11251078F	\$1,640
95" 240HD Bucket		11251088F	\$2,271
Bale Spike	11251694F	11251698F	\$683
Big Bale Fork	11251720F	11251728F	\$710

See Note Page after each Brand Section

For Loader Options Visit Page 53

Several Other Implement Options Available. Starting on Page 59



IT IS RECOMMENDED THAT TRACTORS ARE EQUIPPED WITH ADEQUATE COUNTER-WEIGHT. PLEASE CONTACT YOUR SALES REPRESENTATIVE FOR MORE INFORMATION

MASSEY FERGUSON

NOTES:

- 11 US Width
- 46 Order conversion kit #5034021 (new loader to older valves) \$160.00
- 57 If equipped with Bondioli and Pavesi rear remote valve and SN between BV11001 - BV33001, a metric PB sleeve (AGCO part # 6286183W1), adaptor #10 JIC female to #12 JIC male (Quicke part # 5028039 - \$0) are required.
- 58 For Steepnose Tractors order Grill Guard 14323661 \$220
- 59 Q31, Q36 only compatible with Front Tires 13.6XR24 or smaller
- 60 On Open Center Twin Flow Tractors combining valve cannot be used
- 61 For Load Sensing Tractors order Hydraulic Set 15097BFA. \$1,450.00
- 62 Subframe adapted for tractors with or without front hitch
- 63 Order Hydraulic Set 15022BAA for Tractors with Open Center Hydraulic Systems. \$1,450.00
- 64 On open center Twin Flow tractors combining valve cannot be used
- 65 Order hydraulic set 15020BAA for load sense tractors up to SN T008085. \$1,450.00
- 67 Order 15100BFA for tractors after serial no T008085 with open centre hyd system. \$1,450.00
- 68 Hose set Deluxe will only fit tractors with joystick in the armrest.
- 69 Provide Tractor serial number at time of order
- 70 Please call Alo with tractor details to ensure correct subframe
- 71 Will not fit tractors with hydraulic connections in front of Cab or ROPS.
- 72 Use 15174BAA for Open Center Hydraulic Systems. \$1,450.00
- 73 Use 15106BAA for Open Center Hydraulic Systems on 6100 series or 317070 for Open Center on 3050 to 3065. \$1,450.00
- 74 For Cab Tractors order hydraulic set 15102BAA. \$1,450.00
- 75 Hydraulic Set is only compatible with the HUSCO rear remote valve
- 76 For tractors up to Serial Number 57260B 18014
- 77 For tractors greater than Serial Number 57260B 18014
- 78 For tractors greater than Serial Number C45009
- 79 For tractors up to Serial Number C45008
- 80 Q31, Q36 loaders are not recommended with tires larger than 13.6 X 24
- 99 Subframe is special order! Longer leadtimes should be expected. Call for availability.

MCCORMICK

NOTES:

- 4 DS Subframe 900mm - order a DS Base Loader
- 46 Order conversion kit #5034021 (new loader to older valves) \$160.00
- 81 15199BAA will fit ROPS and tractors with factory cab joystick. Cab Tractors without factory joystick order 15197BAC. \$1,450.00
- 82 For tractors without Bosch valve without a power beyond order Hydraulic Set 15063BAA. \$1,450.00
- 83 For tractors without Bosch valve but with a Power Beyond plate between the 2nd and 3rd section, order Hydraulic Set 15044BAA. \$1,450.00
- 84 On XTX215 Tractors with Serial Number less than JE3500994 use subframe 14320044. \$2,960.00
- 85 Max Tire Size Q31-Q38 is 440 60R 24
- 86 Subframe will fit platform and footstep versions.
- 88 The hydraulic sets don't fit the tractors with the hydraulic trailer brake valve.
- 99 Subframe is special order! Longer leadtimes should be expected. Call for availability.

IT IS RECOMMENDED THAT TRACTORS ARE EQUIPPED WITH ADEQUATE COUNTER-WEIGHT. PLEASE CONTACT YOUR SALES REPRESENTATIVE FOR MORE INFORMATION

NOTES:

New Holland

100 Series

Tractor Model	Axle	Version	Notes	Loader		Subframe	\$	Grill Guard	\$	Valve Kit	\$	Valve Kit ROPS	\$	Hose Kit	\$
T1110/Boomer 1030	4	ROPS	A2,A9	100C	\$1,604	14100154	\$1,004	14110005	\$273			18005B	\$771		
T1530	4	ROPS	A2	140C	\$2,449	14100595	\$1,004	14110014	\$273			18002B	\$771		
Boomer 3040,45,50 / T2310,2320,2330 / TC35-45	4	ROPS	A8	160C	\$3,335	14100095	\$1,004	50035527	\$273	18001A	951	18002B	\$771		
Boomer 4055,60 / T2410,2420 / TC48,55DA	4	ROPS/CAB	A8	180C	\$3,674	14100055	\$1,004	14110004	\$273	18001A	\$951	18002B	\$771		
Must be Sourced Through CNH															
Boomer 30,35	4	ROPS	A2	140C	\$2,449	14100014	\$1,004	50062947	\$273					28001D	\$264
Boomer 40,50	4	ROPS	A2	160C	\$3,335	14100025	\$1,004	50062947	\$273					28001D	\$264
TC25, TC 29, TC33	4	ROPS	A2	140C	\$2,449	14120155	\$1,004	14110046	\$273			18038B	\$771		
TC25DA,TC29DA,TC31DA,TC33DA,TC34DA	4	ROPS	A2	140C	\$2,449	14120155	\$1,004	14110046	\$273			18038B	\$771		
TC30	4	ROPS	A2	140C	\$2,449	14120155	\$1,004	14110046	\$273			18038B	\$771		
T1510,T1520	4	ROPS	A2	140C	\$2,449	14120155	\$1,004	14110046	\$273			18038B	\$771		
BOOMER 2030,2035,T2210,T2220	4	ROPS	A2	140C	\$2,449	14120155	\$1,004	14110046	\$273			18038B	\$771		
				Subframe will not fit with Mid mount Mower											
				A8 Not designed for Supersteer models.											
				A9 Order CNH part no. SBA340171000 to complete.											

Typical Implements

Loader Options

48" Pin On Bucket	11251730F	\$570	100C	Mechanical Self-Levelling(160C)	5221797	\$528
54" Pin On Bucket	11251740F	\$633	100C	Mechanical Self-Levelling(180C)	5221798	\$528
66" Pin On Bucket	11251760F	\$686	140C	Soft Drive	5221796	\$579
60" Skid Steer Bucket	11251970F	\$686	160-180C	3rd Function (Cable Control Valve)	10550452	\$579
66" Skid Steer Bucket	11251921F	\$738	160-180C	3rd Function (Direct Control Valve)	10550453	\$579
72" Skid Steer Bucket	11251931F	\$824	160-180C			
72" Euro Bucket	11251938F	\$824	160-180C			



New Holland

Loaders

EURO TOOL CARRIER STANDARD ON ALL MODELS. SKID STEER AVAILABLE ON X & Q 21-46 MODELS ONLY

Tractor Model	Axle	Version	Notes	Non-Self Levelling				Mechanical Self-Levelling				SUBFRAME SET		HYDRAULIC OPTIONS		
				Versa X - Standard Duty		Q Series - Professional Duty		Versa X - Standard Duty		Q Series - Professional Duty		Part #	\$	2 Function Mechanical	2 Function Hose Kit	2 Function Electric
				X21	X21	Q21	Q21	X26	X26	Q26	Q26					
TT60A, TT65A, TT75A	2/4	ROPS/CAB		X21 \$3,583	Q21 \$4,673	X26 \$4,607	Q26 \$7,071	14327694	\$2,154	15463BAA	\$1,450	\$515	\$3,350			
Workmaster 65, 75	2/4	ROPS/CAB		X21 \$3,583	Q21 \$4,673	X26 \$4,607	Q26 \$7,071	14327694	\$2,154	15463BAA						
T4020-4030 (STRADDLE JES)	2/4	ROPS/CAB		X21 \$3,583	Q21 \$4,673	X26 \$4,607	Q26 \$7,071	14323765	\$2,154	15053BAA	10378214D					
T4040-4050 (STRADDLE JES)	2/4	ROPS/CAB		X21 \$3,583	Q21 \$4,673	X26 \$4,607	Q26 \$7,071	14324025	\$2,154	15053BAA	10378214D					
TN55, 65, 75, TN60A, 70A, 75A	2/4	ROPS	18	X21 \$3,583	Q21 \$3,745	X26 \$4,607	Q26 \$7,924	14321994	\$2,154	15053BAA	10378214D					
TN55D, 65D, 75D, TN60DA, 70DA, 75DA	2/4	CAB	18	X21 \$3,583	Q21 \$3,745	X26 \$4,607	Q26 \$7,924	14321994	\$2,154	15053BAA	10378214D					
TN55S, 65S, 70S, 75S, TN60SA, 70SA, 75SA	4	ROPS/CAB	1887	X21 \$3,583	Q21 \$5,090	X26 \$4,607	Q26 \$7,924	14323084	\$2,154	15053BAA	10378214D					
TN85A, 95A, 85DA, 95DA	2/4	ROPS/CAB		X21 \$3,583	Q21 \$4,673	X26 \$4,607	Q26 \$7,924	14324025	\$2,154	15053BAA	10378214D					
TD 5020, 5030	2/4	CAB/ROPS	94	X21 \$3,583	Q21 \$3,745	X26 \$4,607	Q26 \$7,924	14325845	\$2,154	150525BAA			15025FCA			
TD 5040, 5050	2/4	CAB/ROPS	94	X41 \$4,176	Q41 \$6,333	X46 \$5,273	Q46 \$8,455	14324725	\$2,154	150525BAA			15025FCA			
TD75D, 80D	2/4	ROPS/CAB		X31 \$3,745	Q31 \$5,090	X36 \$4,790	Q36 \$7,924	14321285	\$2,154	150525BAA						
TD95D	2/4	ROPS/CAB		X41 \$4,176	Q41 \$6,333	X46 \$5,273	Q46 \$8,455	14324725	\$2,154	150525BAA						
T5040-5070	2/4	ROPS/CAB		X31 \$3,745	Q31 \$5,090	X36 \$4,790	Q36 \$7,924	14323955	\$2,154	150488BAA	10378209D		15019FCA			
T5000 and TL70-100A	2/4	ROPS/CAB		X31 \$3,745	Q31 \$5,090	X36 \$4,790	Q36 \$7,924	14323955	\$2,154	150198BAA	10378209D					
TL 70, 80, 90, 100	2/4	ROPS/CAB		X31 \$3,745	Q31 \$5,090	X36 \$4,790	Q36 \$7,924	14321215	\$2,154	150488BAA	10378209D					
T 6010, 6020 Delta	2/4	CAB/ROPS		X41 \$4,176	Q41 \$6,333	X46 \$5,273	Q46 \$8,455	14323354	\$2,520	150188BAA	10378137D		15021FCA			
T 6010 Plus, T 6020 Plus/Elite	2/4	CAB/ROPS		X41 \$4,176	Q41 \$6,333	X46 \$5,273	Q46 \$8,455	14323354	\$2,520	150398BAA	10378137D		15039FCA			
T 6020, 6040 & T6060 Elite	2/4	CAB/ROPS		X41 \$4,176	Q41 \$6,333	X46 \$5,273	Q46 \$8,455	14323354	\$2,520	150398BAA	10378137D		15039FCA			
T 6010, T6020 Plus/Elite Supersteer	2/4	CAB/ROPS	87	X41 \$4,176	Q41 \$6,667	X46 \$5,273	Q46 \$9,519	14323354	\$2,520	150398BAA	10378137D		15039FCA			
T 6020, 6040 & T6060 Elite Supersteer	2/4	CAB/ROPS	87	X41 \$4,176	Q41 \$6,667	X46 \$5,273	Q46 \$9,519	14323354	\$2,520	150398BAA	10378137D		15039FCA			
TS100A Plus / Deluxe	2/4	ROPS/CAB		X41 \$4,176	Q41 \$6,333	X46 \$5,273	Q46 \$8,455	14323354	\$2,520	150398BAA	10378137D		15039FCA			
TS100A, 110A Super Steer	4	ROPS/CAB	87	X41 \$4,176	Q41 \$6,667	X46 \$5,273	Q46 \$9,519	14323354	\$2,520	150398BAA	10378137D		15039FCA			
TS110A Standard	2/4	ROPS/CAB		X41 \$4,176	Q41 \$6,333	X46 \$5,273	Q46 \$8,455	14323354	\$2,520	150188BAA	10378137D					

Typical Implements

Skid Steer	Euro	List Price
73" 185U Bucket	11251941F	\$873
85" 210U Bucket	11251958F	\$957
73" 185H Bucket	11251038F	\$1,221
83" 210H Bucket	11251048F	\$1,372
95" 240H Bucket	11251058F	\$1,852
83" 210HD Bucket	11251078F	\$1,640
95" 240HD Bucket	11251088F	\$2,271
Bale Spike	11251694F	\$683
Big Bale Fork	11251720F	\$710

See Note Page after each Brand Section

For Loader Options Visit Page 53

Several Other Implement Options Available. Starting on Page 59

IT IS RECOMMENDED THAT TRACTORS ARE EQUIPPED WITH ADEQUATE COUNTER-WEIGHT. PLEASE CONTACT YOUR SALES REPRESENTATIVE FOR MORE INFORMATION



Issue Date: Jan 1, 2016

Version Date: Oct 1, 2016

Page 45

New Holland

Loaders

EURO TOOL CARRIER STANDARD ON ALL MODELS. SKID STEER AVAILABLE ON X & Q 21-46 MODELS ONLY

Tractor Model	Axle	Version	Notes	Non-Self Levelling				Mechanical Self-Levelling				SUBFRAME SET		HYDRAULIC OPTIONS		
				Versa X - Standard Duty		Q Series - Professional Duty		Versa X - Standard Duty		Q Series - Professional Duty		Part #	\$	2 Function Mechanical	2 Function Hose Kit	2 Function Electric
				Q51	Q61	Q51	Q61	Q56	Q66	Q56	Q66					
T 6030 & T6050 Delta	2/4	CAB/ROPS			Q51 \$6,667	Q61 \$8,285			Q56 \$9,519	Q66 \$9,899	14323364	\$2,520	15039BAA	10378137D	15021FCA	
T 6030, 6050, 6070 Plus/Elite	2/4	CAB/ROPS			Q51 \$6,667	Q61 \$8,285			Q56 \$9,519	Q66 \$9,899	14323364	\$2,520	15039BAA	10378137D	15039FCA	
T 6030, 6050, 6070 Plus/Elite Supersteer	2/4	CAB/ROPS	87		Q61 \$8,285				Q66 \$9,899		14323364	\$2,520	15039BAA	10378137D	15039FCA	
TS115A, 125A, 135A Plus / Deluxe	2/4	ROPS/CAB			Q51 \$6,667	Q61 \$8,285			Q56 \$9,519	Q66 \$9,899	14323364	\$2,520	15039BAA	10378137D	15039FCA	
TS115A, 125A, 135A Super Steer	4	ROPS/CAB	87		Q61 \$8,285				Q66 \$9,899		14323364	\$2,520	15039BAA	10378137D	15039FCA	
TS115A, 130A Standard	2/4	ROPS/CAB			Q51 \$6,667	Q61 \$8,285			Q56 \$9,519	Q66 \$9,899	14323364	\$2,520	15039BAA	10378137D	15039FCA	
TS 6020, 6030	2/4	CAB/ROPS			Q41 \$4,176				Q46 \$5,273		14324364	\$2,071	15018BAB	10378137D		
T 7030 + Supersteer	2/4	CAB/ROPS			Q61 \$8,285				Q66 \$9,899	0 #N/A	14325074	\$2,845	15045BAA	10378264D	15045FCA	
T 7030 CVT + Supersteer	2/4	CAB/ROPS	93		Q61 \$8,285				Q66 \$9,899	0 #N/A	14325074	\$2,845	15045BAA	10378264D	15045FCA	
T 7040, 7050, 7060 + CVT	2/4	CAB/ROPS	93		Q61 \$8,285				Q66 \$9,899		14325074	\$2,845	15045BAA	10378264D	15045FCA	
T 7040, 7050, 7060 CVT + Supersteer	2/4	CAB/ROPS			Q61 \$8,285				Q66 \$9,899		14325074	\$2,845	15045BAA	10378264D	15045FCA	
T 8020, 8030, 8040, 8050	2/4	CAB/ROPS			Q61 \$8,285				Q66 \$9,899		14325074	\$2,845	15045BAA	10378264D	15045FCA	
T 8020, 8030, 8040, 8050 + Supersteer	2/4	CAB/ROPS			Q61 \$8,285				Q66 \$9,899		14325074	\$2,845	15045BAA	10378264D	15045FCA	
TM120-165	2/4	CAB/ROPS							Q88 \$14,080		14330024	\$3,537	15090BAA		15090FCA	
TM120 - 165 Super Steer	4	CAB	87,92,87						Q88 \$14,080		14330034	\$3,537	15090BAA		15090FCA	
TM 175, 190	2/4	CAB	87		Q61 \$8,285				Q66 \$9,899	Q76 \$10,532	14322834	\$2,960	15052BAA	10378137D	15052FCA	
TM 175, 190 Super Steer	4	CAB	89,87		Q61 \$8,285				Q66 \$9,899	Q76 \$10,532	14322834	\$2,960	15052BAA	10378137D	15052FCA	
TG 210 - 305 Super Steer	4	CAB	89						Q76 \$10,532		14322834	\$2,960	15052BAA	10378137D	15052FCA	
TB100, 110	2/4	ROPS			X41 \$4,176	X51 \$4,607	Q41 \$6,333	Q51 \$6,667	Q46 \$5,273	X56 \$5,759	14330034	\$3,537	15090BAA		15090FCA	
TB120	2/4	ROPS					Q61 \$8,285		Q46 \$8,455	Q56 \$9,519	14320895	\$2,154	15093BAA		15093FCA	
4835, 5635, 6635, 7635	2/4	ROPS/CAB			X31 \$3,745	X41 \$4,176	Q31 \$5,090	Q41 \$6,333	Q36 \$7,924	Q46 \$8,455	14321215	\$2,154	15048BAA		15048FCA	
TS90, 100, 110	2/4	ROPS/CAB			X41 \$4,176	X51 \$4,607	Q41 \$6,333	Q51 \$6,667	Q46 \$5,273	X56 \$5,759	14320185	\$2,520	15051BAA		15051FCA	
5640, 6640, 7740	2/4	ROPS/CAB	C2		X41 \$4,176	X51 \$4,607	Q41 \$6,333	Q51 \$6,667	Q46 \$5,273	X56 \$5,759	14324255	\$2,154	15051BAA		15051FCA	
7840 - 8340	2/4	ROPS/CAB			X51 \$4,607		Q51 \$6,667		X56 \$5,759		14324265	\$2,520	15051BAA		15051FCA	
8160, 8260, 8360, 8560	2/4	ROPS/CAB	90,91				Q61 \$8,285		Q66 \$9,899	Q76 \$10,532	14320005	\$2,960	15087BAA		15087FCA	
8670, 8770, 8870, 8970	2/4	CAB					Q21 \$4,673		Q26 \$7,071		14330135	\$3,537	15091BAA		15091FCA	
TN65F, 75F, 90F, TN75FA, 85FA, 95FA	4	ROPS/CAB					Q21 \$4,673		Q26 \$7,071		14310334	\$2,154	15084BAA		15084FCA	
3930, 4630	2/4	ROPS/CAB	95,96		X21 \$3,583		Q21 \$4,673		Q26 \$7,071		14329234	\$2,154	15232BAA		15232FCA	

Typical Implements

	Skid Steer	Euro	List Price
73" 185U Bucket	11251941F	11251948F	\$873
85" 210U Bucket	11251951F	11251958F	\$957
73" 185H Bucket		11251038F	\$1,221
83" 210H Bucket		11251048F	\$1,372
95" 240H Bucket		11251058F	\$1,852
83" 210HD Bucket		11251078F	\$1,640
95" 240HD Bucket		11251088F	\$2,271
Bale Spike	11251694F	11251698F	\$683
Big Bale Fork	11251720F	11251728F	\$710

See Note Page after each Brand Section

For Loader Options Visit Page 53

Several Other Implement Options Available. Starting on Page 59

IT IS RECOMMENDED THAT TRACTORS ARE EQUIPPED WITH ADEQUATE COUNTER-WEIGHT. PLEASE CONTACT YOUR SALES REPRESENTATIVE FOR MORE INFORMATION



New Holland

Basic Loaders

Loaders

EURO TOOL CARRIER STANDARD ON ALL MODELS. SKID STEER AVAILABLE ON X & Q 21-46 MODELS ONLY

Tractor Model	Axle	Version	Notes	Non-Self Levelling				Mechanical Self-Levelling				SUBFRAME SET		HYDRAULIC OPTIONS							
				Versa X - Standard Duty		Q Series - Professional Duty		Versa X - Standard Duty		Q Series - Professional Duty		Part #	\$	2 Function Mechanical	2 Function Hose Kit	2 Function Electric					
				X31	X41	X36	X46	X36	X46	X36	X46			Q31	Q41	Q36	Q46	\$1,450	\$515	\$3,350	
5030	2/4	ROPS/CAB	11,95,96	\$3,745	\$4,176	\$5,090	\$6,333	X36	\$4,790	X46	\$5,273	Q36	\$7,924	Q46	\$8,455	343235	\$2,154	15232BAA			
5610 - 7610	2/4	ROPS/CAB	11,97,98	X31 \$3,745	X41 \$4,176	Q31 \$5,090	Q41 \$6,333	X36 \$4,790	X46 \$5,273	Q36 \$7,924	Q46 \$8,455	342035	\$2,154	15243BAA							
6710 - 7710	2/4	ROPS/CAB	11,97,98,99	X41 \$4,176		Q41 \$6,333		X46 \$5,273		Q46 \$8,455		342045	\$2,154	15238BAA							
7810	2/4	ROPS/CAB	11,97,98,99	X51 \$4,607		Q51 \$6,667		X56 \$5,759		Q56 \$9,519		341035	\$2,520	15242BAA							
8210	4	CAB	10,12,97,98							Q56 \$9,519		320285	\$2,520	317043							

Typical Implements	Skid Steer	Euro	List Price
73" 185U Bucket	11251941F	\$873	X21 - X36
85" 210U Bucket	11251951F	\$957	X21 - X36
73" 185H Bucket	11251038F	\$1,221	X21-X56, Q21-Q68
83" 210H Bucket	11251048F	\$1,372	X41-X56, Q31-Q78
95" 240H Bucket	11251058F	\$1,852	Q51 - Q88
83" 210HD Bucket	11251078F	\$1,640	Q31 - Q56
95" 240HD Bucket	11251088F	\$2,271	Q51 - Q98
Bale Spike	11251694F	\$683	ALL
Big Bale Fork	11251720F	\$710	ALL

See Note Page after each Brand Section
For Loader Options Visit Page 53

NEW HOLLAND

NOTES:

- 4 DS Subframe 900mm - order a DS Base Loader
- 5 For Tractors with Underslung Exhaust
- 10 Order conversion kit #5034021 (new loader to older valves) \$160.00
- 11 US Width
- 12 UM Width
- 18 Subframe includes Front Brackets only. If tractor does not have rear brackets, order 14321996 at \$0 as well.
- 87 Base loader requires Extended Bearing Boxes. See Quicke Dimension Series Product Codes
- 89 Tractors must be equipped with Power Beyond plate for the valve
- 90 Order Subframe set 14320725 for Serial Numbers prior to 116199B \$2,960.00
- 91 Order Hyd Set 15087BAA for Serial Numbers prior to 116199B \$1,450.00
- 92 For open-center systems, use valve kit no. 15089BAA \$1,450.00
- 93 Q61/66 must be ordered with extended bearing boxes for supersteer models only.
- 94 If tractor does not have pre-installed connections to hydraulic auxillary valve, use 15024BAA. \$1,450.00
- 95 Order P/B Plate from New Holland for Open Center Systems
- 96 Order 15231BAA Load Sense Valve for double pump tractors. \$1,450.00
- 97 Order 15242BAA Load Sense Valve for double pump tractors. \$1,450.00
- 98 Valve is serviced from the tractor remote valves
- 99 Subframe is special order! Longer leadtimes should be expected. Call for availability.
- 87 Subframe includes Front Brackets only. If tractor does not have rear brackets, order 14322836 at \$0 as well.
- C2 The fuel line has to be modified on tractors fitted with dual fuel tanks. Rear Axle Extensions not required on some models

IT IS RECOMMENDED THAT TRACTORS ARE EQUIPPED WITH ADEQUATE COUNTER-WEIGHT. PLEASE CONTACT YOUR SALES REPRESENTATIVE FOR MORE INFORMATION

VALTRA

NOTES:

- 11 US Width
- 10 Order conversion kit #5034021 (new loader to older valves) \$160.00
Subframe is special order! Longer leadtimes should be expected. Call for availability.
- 99 Subframe designed for tractors with New Axle when Serial Number is >K36108 for 6000 series and >K41108 for 8000 series order adapter kit 10347271 (\$155)
- B1 Hydraulic Set is designed for Hi Tech models or all chassis > Serial Number L17307
- B2 Subframe will fit all options except Zuidberg front hitch
- B3 Hydraulic Set joystick mounts on the left hand side.
- B4 Subframe for tractor with or without Zuidberg front hitch
- B5 Order additional kit 14321621 for tractors before SN K36108 (\$155)

IT IS RECOMMENDED THAT TRACTORS ARE EQUIPPED WITH ADEQUATE COUNTER-WEIGHT. PLEASE CONTACT YOUR SALES REPRESENTATIVE FOR MORE INFORMATION

NOTES:

ErgoDrive LCS - Loader Control System - Dimension & X Series

	Part No. See Price Pages	Model No ErgoDrive LCS Cable Operated 2 Function Control Valve. Available in OC and LS specifications. Hoses connect via MC-4 Multicoupler - Dimension Series	Price \$1,450
Designed for Dimension / Versa X Series Loaders Only			

Field installed Live 3rd for ErgoDrive- Dimension Series Only

	Part No. 5034284	Model No Field installed Live 3rd for ErgoDrive Electronic Live 3rd Function allows implement to be operated independently of loader "Tilt" Control Live 3rd Hose Kit Required Hoses connect via MC-2 Dimension Series	Price \$960
Designed for Dimension Series Loaders Only			

ElectroDrive LCS - Loader Control System - Dimension Series Only

	Part No. See Price Pages	Model No ElectroDrive LCS Electronic 2 Function Control Valve. Available in OC and LS specifications. Hoses connect via MC-4 Multicoupler - Dimension Series CANBUS System	Price \$3,350
Designed for Dimension / Versa X Series Loaders Only			

Field installed Live 3rd for ElectroDrive- Dimension Series Only

	Part No. 5034283	Model No Field installed Live 3rd for ElectroDrive- Dimension Series Electronic Live 3rd Function allows implement to be operated independently of loader "Tilt" Control Live 3rd Hose Kit Required Hoses connect via MC-2 - Dimension Series CANBUS System	Price \$960
Designed for Dimension Series Loaders Only			

Hose Set- to Tractor Mid Valves or Remote Vales

Part No.	Model No	Price
See Price Pages	Hose Set - 2 Function Dimension Series -LCS	\$515
See Price Pages	Hose Set - 3 Function Dimension Series-LCS	\$620
Available for Tractors that Utilize a Factory fitted Loader Control Joystick. Hoses connect to Auxiliary or Mid Mount Valve as required. Hoses connect via MC-4 Multicoupler for Dimension Series / Hoses Connect via individual Couples for Versa X Series		
313411	Switch Kit - Pre LCS	\$164
5102162F	Switch Kit - LCS	\$165
Loader Serviced from tractor remotes.		
10378005A	3 cylinder - 126" (LCS)	\$515
10378252A	4/6 cylinder - 165" (LCS)	\$515
10377005	3 cylinder - 126" (Pre LCS)	\$515
301852	4/6 cylinder - 165" (Pre LCS)	\$515



Deluxe Hose Sets - Dimension Series

Part No.	Model No	Price
	Deluxe Hose Set - 2 Function	\$1,201
Available only with Select Tractors and for Tractors that Utilize a Factory fitted Loader Control Joystick. Allows Full use of the rear remote valves when loader is not in use by means of an electronic switch Hoses connect via MC-4 Multicoupler - Dimension Series		
Designed for Dimension Series Loaders Only		

**Please Contact your Sales Rep for Tractor /
Deluxe Hose Set Availability**

Multi Coupler - MC4 - Standard on most Dimension Series

Part No.	Model No	Price
5220530	MULTICOUPLER MC-4	\$618
5220541	MULTICOUPLER MC-2	\$526
5044949	MULTICOUPLER MC-4 VERSA X	\$618



Softdrive - Dimension Series Only

Part No.	Model No	Price
5215230	Soft Drive	\$632
5215231	Soft Drive	\$813
5215232	Soft Drive	\$813
5220650	Soft Drive	\$729
5220651	Soft Drive	\$729
5220652	Soft Drive	\$907
5220653	Soft Drive	\$907
5220654	Soft Drive	\$907
5220655	Soft Drive	\$907
5220526	Electric Shut-off	\$420
5215241	Electric Shut-off	\$420
5220293	Electric Shut-off Switch Kit	\$164



Soft Drive Option - X Series

Part No.	Model No	Price
5034241	Soft Drive - All X Series	\$729



3rd / 4th Function - Dimension Series Only

Part No.	Model No	Price
5220451	3rd Function	\$823
5220452	3rd Function	\$823
5220581	3rd Function	\$823
5220454	4th Function	\$823
5220455	4th Function	\$823
5220518	4th Function	\$823
5220517	4th Function	\$823
10550380	SelectoFix - Loader Half	\$552
10550180	SelectoFix - Implement Half	\$313

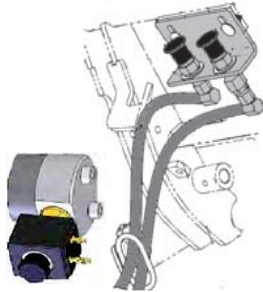

3rd Function - Versa X Series Only

Part No.	Model No	Price
60010002	3rd Function	\$1,004



Live 3rd Function Hose Kit- Dimension Series Only

Part No.	Model No	Price
9031984	Live 3rd Function - Hose Kit	\$554
9031986	Live 3rd Function - Hose Kit	\$554
9031988	Live 3rd Function - Hose Kit	\$554
9031990	Live 3rd Function - Hose Kit	\$554
9031994	Live 3rd Function - Hose Kit	\$554
9031996	Live 3rd Function - Hose Kit	\$554

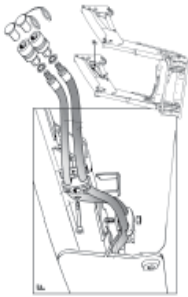

Hydraulic Implement Locking- Dimension Series Only

Part No.	Model No	Price
5220692	Q- Lock	\$597
5215267	Q- Lock	\$597
5220693	Q- Lock	\$597
5220695	Q- Lock	\$597
5033992	Switch Kit - Rocker Switch to operate Q-Lock on a 2nd Tractor equipped with LCS	\$597

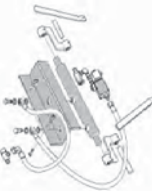

Loader Light - All Models

Part No.	Model No	Price
5048217	Loader Light Kit	\$537



MAKING IT WORK!

Old Loader to New Valve (LCS) - includes female 7 pin connector to Male Deutsch Adaptor

Part No.	Model No	Price
5033973	Individual Couple Kit - Allows old Dimension Loaders to mount to LCS valve using flat face couplers	\$160
5033977	Multicoupler Kit - Allows old Dimension Loaders to mount to LCS valve using MC-4	\$618



New Loader to Old Valve (Pre LCS) - includes female 7 pin connector to Male Deutsch Adaptor

Part No.	Model No	Price
5034067	Hose Interface Kit - Allows New Loader with LCS to mount on old hose kit	\$160
5034021	1/2" Female Pioneer Coupler Kit - Allows LCS loaders to adapt to older valves with 1/2" male Pioneer Couplers	\$160
5034071	Hydro quick - Old style quick release coupler loader half, allows connection to older valves equipped with Hydro Quick.	\$290
5044970	Interface Kit - Adapts LCS loaders with MC-4/flat face couplers to older valves  (Ideal when using one loader on two tractors - 1 x Pre-LCS and 1 x LCS Kit)	\$622
5201088	Switch Kit - Rocker Switch to operate Q-Lock on a second Tractor with older valve	\$622

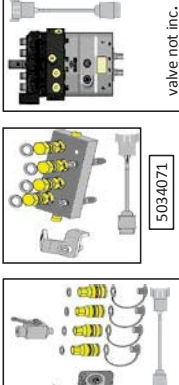



LOADER OPTIONS

MAKING IT WORK!

Old Loader to New DM Subframes

Part No.	Model No	Price
4500123	Bearing Box Conversion Kit	\$1,294
4500124	Bearing Box Conversion Kit	\$1,294
4500063	Bearing Box Conversion Kit	\$1,294
4500064	Bearing Box Conversion Kit	\$1,294
4500065	Bearing Box Conversion Kit	\$1,294
4500066	Bearing Box Conversion Kit	\$1,294
Accessories for Older Loaders		
Part No.	Model No	Price
5220469	Live 3rd Hose Kit	\$320
5220470	Live 3rd Hose Kit	\$320
5220471	Live 3rd Hose Kit	\$320
5220472	Live 3rd Hose Kit	\$320
5220473	Live 3rd Hose Kit	\$320
5201154	Hydro Quick 4	\$638
5220483	Hydro Quick 4	\$638
5201155	Hydro Quick 4	\$399
5201227	Hydro Quick 4	\$239
4500188	Hydro Quick 6	\$912
5220484	Hydro Quick 6	\$912
314010	Soft Drive	\$871
314070	Soft Drive	\$871
5048136	Soft Drive	\$871
5048137	Soft Drive	\$871
314050	Soft Drive	\$871
313413	3rd Function	\$789
10550218	3rd Function	\$1,049
313414	4th Function	\$680
313325	4th Function	\$351
245099	Hydraulic Implement Locking	\$597
246616	Hydraulic Implement Locking	\$597
246800	Hydraulic Implement Locking	\$597

Quicke® 5000 COUNTERWEIGHT AND BUCKET RECOMMENDATION MATRIX

Counterweight recommendation.
Tractor weight to loader model.

Model	Lift Capacity	TRACTOR WEIGHT (lb)												
		6600	8800	9900	11000	11500	13200	15400	17600	19800				
Q21	2623	2200	1750											
Q31	2690	2200	2200	1750										
Q33	3197	2650	2200	2200										
Q41	3307		2650	2200	2200									
Q51	3616			2650	2650	2200								
Q61	4343				3100	3100	2650	2200						
Q26	2822	2200	2200											
Q36	2888	2650	2200	2200										
Q38	3505		2650	2400										
Q46	3593		2850	2650	2400									
Q48	4233		2650	2650	2400	2400								
Q56	3792			2850	2650	2650	2200							
Q58	4431				3100	3100	2650							
Q66	4674				3300	3300	3300							
Q68	5401				3300	3300	3300							
Q76	4674						3300	2650						
Q78	5357						3300	3300	2850					
Q88	6107								3300	3300				
Q98	5732										3300	3300		2850

This information is a guide only.

Which bucket should I choose

Areas of application	BUCKET MODEL									
	H	HT	HD	HV	HDV	Hy-Tip	Grading			
Light excavation and loading work	●						●			
Loading of grain, wood chips and snow	●			●		●				
Loading of lighter materials at high lift heights				●		●	●			
Heavy excavation and loading work	●	●	●							
Work in gravel/sand, earth and stone	●	●	●							
Grading work	●		●				●			
Professional snow clearance	●		●	●	●					
	●		A Good Choice		●		Best Choice			



A counterweight increases tractor stability, traction and tractor braking force.
Regulation - EN 12525: No less than 20% of the gross tractor/loader weight must apply to the rear axle, including the counterweight.





Recommendation

IMPLEMENT - DIMENSION SERIES LOADER RECOMMENDATIONS.

MODEL	BUCKETS																			
	SERIES S	SERIES H			SERIES HT			SERIES HD			SERIES HDV									
	185	135	160	185	210	240	135	160	185	210	185	210	240	260	210	240	260	Grading	Hy-Tip	
Q21/26	●	●	●	●			●													
Q31/33/36	●			●	●	●														
Q38	●	●	●	●	●		●	●	●	●										
Q41/46	●		●	●	●		●	●	●	●										
Q48					●	●														
Q51/56/58			●	●	●	●														
Q61/66/68			●	●	●	●														
Q76/78			●	●	●	●														
Q88			●	●	●	●														
Q98 Type 7			●	●	●	●														

MODEL	ROUND BALE										SQUARE				OTHER	
	Flexibal	Flexigrp		Unigrp	Bale Spike	HD	Silosplit	Quadrogrp	Bale Fork	Hinged Fork	Lifting Arm	Counter	Weight			
	160	200	130					200	140	140	190	800	800	1000		
Q21/26	●	●	●	●	●	●	●	●	●	●	●	●	●	●		
Q31/33/36	●	●	●	●	●	●	●	●	●	●	●	●	●	●		
Q38	●	●	●	●	●	●	●	●	●	●	●	●	●	●		
Q41/46	●	●	●	●	●	●	●	●	●	●	●	●	●	●		
Q48	●	●	●	●	●	●	●	●	●	●	●	●	●	●		
Q51/56/58	●	●	●	●	●	●	●	●	●	●	●	●	●	●		
Q61/66/68	●	●	●	●	●	●	●	●	●	●	●	●	●	●		
Q76/78	●	●	●	●	●	●	●	●	●	●	●	●	●	●		
Q88	●	●	●	●	●	●	●	●	●	●	●	●	●	●		
Q98 Type 7	●	●	●	●	●	●	●	●	●	●	●	●	●	●		

FORKS AND GRABS

MODEL	MANURE FORKS			PALLET FORKS			STONE FORK		SILOGRAB						MULTIBENNE					POWER-GRAB SE			SILOCUT SE					MAXI-GRAPPLE										
	130	150	170	190	230	1000	1600	2500	150	200	130	150	170	190	210	230	130	150	170	190	210	230	185	210	240	260	120	150	190	230	210	240	260	210T	240T	260T		
Q21/26	●	●	●	●	●	●	●	●	●	●	●	●	●	●	●	●	●	●	●	●	●	●	●	●	●	●	●	●	●	●	●	●	●	●	●	●	●	
Q31/33/36	●	●	●	●	●	●	●	●	●	●	●	●	●	●	●	●	●	●	●	●	●	●	●	●	●	●	●	●	●	●	●	●	●	●	●	●	●	
Q38	●	●	●	●	●	●	●	●	●	●	●	●	●	●	●	●	●	●	●	●	●	●	●	●	●	●	●	●	●	●	●	●	●	●	●	●	●	●
Q41/46	●	●	●	●	●	●	●	●	●	●	●	●	●	●	●	●	●	●	●	●	●	●	●	●	●	●	●	●	●	●	●	●	●	●	●	●	●	●
Q48	●	●	●	●	●	●	●	●	●	●	●	●	●	●	●	●	●	●	●	●	●	●	●	●	●	●	●	●	●	●	●	●	●	●	●	●	●	●
Q51/56/58	●	●	●	●	●	●	●	●	●	●	●	●	●	●	●	●	●	●	●	●	●	●	●	●	●	●	●	●	●	●	●	●	●	●	●	●	●	●
Q61/66/68	●	●	●	●	●	●	●	●	●	●	●	●	●	●	●	●	●	●	●	●	●	●	●	●	●	●	●	●	●	●	●	●	●	●	●	●	●	●
Q76/78	●	●	●	●	●	●	●	●	●	●	●	●	●	●	●	●	●	●	●	●	●	●	●	●	●	●	●	●	●	●	●	●	●	●	●	●	●	●
Q88	●	●	●	●	●	●	●	●	●	●	●	●	●	●	●	●	●	●	●	●	●	●	●	●	●	●	●	●	●	●	●	●	●	●	●	●	●	●
Q98 Type 7	●	●	●	●	●	●	●	●	●	●	●	●	●	●	●	●	●	●	●	●	●	●	●	●	●	●	●	●	●	●	●	●	●	●	●	●	●	●

Use S Series Bucket with Bolt On Grapple

Material Bucket - U (Economy Buckets)



Part No.	Model No	width (in)	Capacity (cu ft.)	wt. (lbs)	Price
11251948F	185U BUCKET EURO	73"	16.4 cu ft	390	\$873
11251941F	185U BUCKET SKID STEER	73"	16.4 cu ft	390	\$873
11251958F	210U BUCKET EURO	83"	19.1 cu ft	437	\$957
11251951F	210U BUCKET SKID STEER	83"	19.1 cu ft	437	\$957

Material Bucket - S (Lower volume - Standard Material Bucket)



Part No.	Model No	width (in)	Capacity (cu ft.)	wt. (lbs)	Price
11251588F	BUCKET 185 S EURO	73"	21 cu. ft	401	\$1,229
11251721F	BUCKET 185 S SKID STEER	73"	21 cu. ft	401	\$1,229
11251598F	BUCKET 210 S EURO	83"	25 cu. ft	505	\$1,372
11251821F	BUCKET 210 S SKIDSTEER	83"	25 cu. ft	505	\$1,372

Utility Grapple for Material Bucket - S (Bolt-On)



Part No.	Model No	Price
11250673F	UTILITY GRAPPLE	\$3,159
11261620F	BACK SCREEN KIT UTILITY GRAPPL	\$277

Compatible with 185S/210S Buckets Only
Compatible with 185S/210S Buckets Only

Includes tool bar & uprights

Material Bucket - H (Standard Material Bucket)



Part No.	Model No	width (in)	Capacity (cu ft.)	wt. (lbs)	Price
11251018F	BUCKET 135 H EURO	53"	18 cu. Ft	325	\$872
11251028F	BUCKET 160 H EURO	63"	23 cu. Ft	365	\$1,063
11251038F	BUCKET 185 H EURO	73"	25 cu. Ft	450	\$1,221
11251048F	BUCKET 210 H EURO	83"	29 cu. Ft	555	\$1,372
11251058F	BUCKET 240 H EURO	95"	33 cu. Ft	650	\$1,852

Material Bucket - HT (Standard Material Bucket with Construction Teeth)



Part No.	Model No	Teeth	width (in)	Capacity (cu ft.)	wt. (lbs)	Price
11251108F	BUCKET 135 HT EURO	6	53"	18 cu. Ft	335	\$1,143
11251118F	BUCKET 160 HT EURO	7	63"	23 cu. Ft	380	\$1,375
11251128F	BUCKET 185 HT EURO	8	73"	25 cu. Ft	465	\$1,518
11251138F	BUCKET 210 HT EURO	9	83"	29 cu. Ft	570	\$1,744

Material Bucket - HD (Heavy Duty Material Bucket)



Part No.	Model No	width (in)	Capacity (cu ft.)	wt. (lbs)	Price
11251068F	BUCKET 185 HD EURO	73"	25 cu. Ft	518	\$1,444
11251078F	BUCKET 210 HD EURO	83"	29 cu. Ft	628	\$1,640
11251088F	BUCKET 240 HD EURO	95"	33 cu. Ft	750	\$2,271
11251098F	BUCKET 260 HD EURO	102"	37 cu. Ft	805	\$2,748
11251087F	BUCKET 240 HD EURO - Q98 Only	95"	33 cu. Ft	800	\$2,417
11251097F	BUCKET 260 HD EURO - Q98 Only	102"	37 cu. Ft	855	\$2,876

High Volume Bucket - HV/ Heavy Duty High Volume Bucket - HDV

Part No.	Model No	width (in)	Capacity (cu ft.)	wt. (lbs)	Price
11251148F	BUCKET 200 HV EURO	79"	41 cu. Ft	602	\$1,546
11251158F	BUCKET 220 HV EURO	87"	45 cu. Ft	648	\$1,931
11251808F	BUCKET 210 HDV EURO	83"	43 cu. Ft	915	\$2,220
11251818F	BUCKET 240 HDV EURO	95"	60 cu. Ft	955	\$2,603
11251828F	BUCKET 260 HDV EURO	102"	65 cu. Ft	1036	\$3,231
11251827F	BUCKET 260 HDV EURO - Q98 Only	102"	65 cu. Ft	1100	\$3,338



Maxi Grapple



Part No.	Model No	Tines	width (in)	wt. (lbs)	Price
11250533F	MAXI GRAPPLE 210 EURO		83"	1335	\$5,423
11250534F	MAXI GRAPPLE 240 EURO		95"	1410	\$5,773
11250535F	MAXI GRAPPLE 260 EURO		102"	1565	\$6,116
11250536F	MAXI GRAPPLE 210T WITH TINES EURO	6	83"	1365	\$5,579
11250537F	MAXI GRAPPLE 240T WITH TINES EURO	7	95"	1445	\$5,927
11250538F	MAXI GRAPPLE 260T WITH TINES EURO	8	102"	1610	\$6,395
11262087F	MAXI GRAPPLE 260T W/TINES, BACKSCREEN- Q98 Only	8	102"	1700	\$6,726
11260914F	BACK SCREEN H-D BUCKET, GRAPPLE	Not included with Maxi Grapple			\$327

Comes with or without bucket teeth (backscreen opt.)

Maxi Grapple Accessories

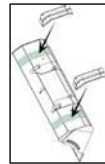

Part No.	Model No	width (in)	wt. (lbs)	Price
11250657F	GRAPPLE ASSEMBLY KIT - Includes Grapple Assy with 4 Claws, Hoses and Cylinders.			\$3,299
11260141-1	WELD-ON UPPER GRAPPLE SUPPORTS	Bucket Weldments - 2 Required		\$340
11250654F	MAXI GRAPPLE 210 - BUCKET ONLY EURO	83"	711	\$2,396
11250655F	MAXI GRAPPLE 240 - BUCKET ONLY EURO	95"	832	\$2,919
11250656F	MAXI GRAPPLE 260 - BUCKET ONLY EURO	102"	887	\$3,204
11260118F	MAXI GRAPPLE 210T - BUCKET ONLY EURO Requires 6 Tines	83"	724	\$2,493
11260120F	MAXI GRAPPLE 240T - BUCKET ONLY EURO Requires 7 Tines	95"	847	\$3,038
11260122F	MAXI GRAPPLE 260T - BUCKET ONLY EURO Requires 8 Tines	102"	904	\$3,335
11260141-1	WELD-ON UPPER GRAPPLE SUPPORTS	Bucket Weldments		\$340
10834142F	BUCKET TINE	Replacement Tine (for Buckets with Holders)		\$91
10834140F	BUCKET TINE with Holders	Add Tine (for Buckets without Holders)		\$109
10834138/10834147	TINE HOLDER KIT (Front = 10834138 / Rear = 10834147)			AVAILABLE THRU PARTS



Without bucket teeth



With bucket teeth

Specialty Buckets



Part No.	Model No	width (in)	wt. (lbs)	Price
11251528F	H-D GRADING BUCKET 85" 23CU. FT EURO	87"	742	\$1,622

Multipurpose - 4 in 1



Part No.	Model No	TEETH	width (in)	Capacity (cu ft.)	wt. (lbs)	Price
11252148F	160MP EURO		63"	13.44 cu. Ft	807	\$3,463
11252141F	160MP SKID STEER		63"	13.44 cu. Ft	807	\$3,463
11252158F	185MP EURO		73"	15.57 cu. Ft	882	\$3,645
11252151F	185MP SKID STEER		73"	15.57 cu. Ft	882	\$3,645
11252168F	210MP EURO		83"	23.35 cu. Ft	955	\$4,287
11252161F	210MP SKID STEER		83"	23.35 cu. Ft	955	\$4,287
11252448F	160MPT EURO	7	63"	13.44 cu. Ft	820	\$3,687
11252441F	160MPT SKID STEER	7	63"	13.44 cu. Ft	820	\$3,687
11252458F	185MPT EURO	8	73"	15.57 cu. Ft	895	\$3,904
11252451F	185MPT SKID STEER	8	73"	15.57 cu. Ft	895	\$3,904
11252468F	210MPT EURO	9	83"	23.35 cu. Ft	970	\$4,578
11252461F	210MPT SKID STEER	9	83"	23.35 cu. Ft	970	\$4,578

Multipurpose Utility - 4 in 1



Part No.	Model No	width (in)	Price
11252111F	160MPU SKID STEER	63"	\$2,601
11252121F	180MPU SKID STEER	73"	\$2,732
11252131F	210MPU SKID STEER	83"	\$2,861
11252118F	160 MPU EURO	63"	\$2,601
11252128F	180 MPU EURO	73"	\$2,732
11252138F	210 MPU EURO	83"	\$2,861

Hi-Tipping Bucket



Part No.	Model No.	width(in)	wt. (lbs)	Price
11252658F	200XH EURO	80"	1219	\$4,630
11252668F	220XH EURO	87"	1294	\$4,812
11252678F	240XH EURO	95"	1371	\$4,994
11252688F	260XH EURO	102"	1446	\$5,177

Snow Clearing Bucket



Part No.	Model No	width (in)	Price
11252848F	Snow Clearing Bucket SC PRO	90 - 142"	\$7,089
11262540	Serrated Cutting Edge Kit		\$969

Bale Spike

Part No.	Model No	Tines	wt. (lbs)	Price
11254051F	BALE SPIKE EURO	1 Long, 2 Short	132	\$473
11254065F	BALE SPIKE SKID STEER	1 Long, 2 Short	121	\$473



Silo Split

Part No.	Model No	length (in)	wt. (lbs)	Price
11209793F	SILO SPLIT HD EURO	63"	243	\$1,575



Big Bale Fork

Part No.	Model No	width (in)	wt. (lbs)	Price
11251720F	BIG BALE FORK SKID STEER	54"	169	\$537
11251728F	BIG BALE FORK EURO	54"	180	\$537
11215019F	EXTENSION FRAME			\$257



Ext. frame

Hinged Bale Fork

Part No.	Model No	width (in)	wt. (lbs)	Price
11251368F	HINGED BALE FORK 140 - 2 TINES EURO	55"	293	\$1,740
11251378F	HINGED BALE FORK 190 - 5 TINES EURO	75"	370	\$2,566
11260349F	BAG LIFTER, EXTENSION			\$269
11260348F	SQUARE BALE FORK, EXTENSION SET			\$269



For Handling more than one Bale

Flexibal

Part No.	Model No	wt. (lbs)	Price
11250768F	FLEXIBAL EURO	430	\$2,593
11209682F	FLEXIBAL BALE SUPPORT		\$785



Price includes Euro brackets & hoses

with integral tines

UniGrip

Part No.	Model No	wt. (lbs)	Price
11250178F	UNIGRIP 130 EURO	441	\$2,376
11250788F	UNIGRIP 160 EURO	529	\$2,491



Price includes Euro brackets & hoses

light applications

Quadrogrip

Part No.	Model No	wt. (lbs)	Price
11250358F	Quadrogrip 200 EURO	916	\$4,543



Price includes Euro brackets & hoses

Flexigrip

Part No.	Model No	wt. (lbs)	Price
11252008F	FLEXIGRIP 160 EURO	607	\$2,743
11252018F	FLEXIGRIP 200 EURO	686	\$2,975



Price includes Euro brackets & hoses

for vertical stacking

Pallet Forks



Part No.	Model No	Type	Fork Length	Capacity	Price
11252311F	PALLET FORK 1000/1220	Skid Steer	48"	2200lbs	\$935
11252718F	PALLET FORK 1000/1220	Euro	48"	2200lbs	\$935
11252331F	PALLET FORK 1600/1220	Skid Steer	48"	3500lbs	\$1,030
11252738F	PALLET FORK 1600/1220	Euro	48"	3500lbs	\$1,030
11252341F	PALLET FORK 2500/1220	Skid Steer	48"	5500lbs	\$1,209
11252748F	PALLET FORK 2500/1220	Euro	48"	5500lbs	\$1,209
11252050F	HYDRAULIC PALLET FORK SIDE SHIFT ADD-ON KIT				\$1,182
11252211F	LOG GRAB				\$1,848

Manure Fork



Part No.	Model No	Tines	width (in)	wt. (lbs)	Price
11251838F	MANURE FORK 130 EURO	7	51"	278	\$890
11251848F	MANURE FORK 150 EURO	8	59"	300	\$1,011
11251858F	MANURE FORK 170 EURO	9	67"	335	\$1,233
11251868F	MANURE FORK 190 EURO	10	75"	363	\$1,510
11251878F	MANURE FORK 230 EURO	12	91"	446	\$1,599

Silograb



Part No.	Model No	Tines	width (in)	wt. (lbs)	Price
11250888F	SILOGRAB 130 EURO	7	51"	560	\$2,682
11250898F	SILOGRAB 150 EURO	8	59"	605	\$2,786
11250908F	SILOGRAB 170 EURO	9	67"	670	\$3,480
11250918F	SILOGRAB 190 EURO	10	75"	717	\$3,980
11250928F	SILOGRAB 210 EURO	11	83"	805	\$4,354
11250938F	SILOGRAB 230 EURO	12	91"	838	\$4,730
11250948F	SILOGRAB 250 EURO	13	98"	899	\$5,145

Price includes hoses

Multibenne

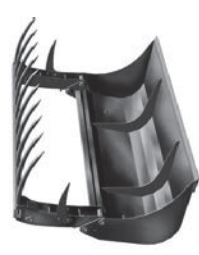

Part No.	Model No	Tines	width (in)	wt. (lbs)	Price
11250818F	MULTIBENNE 130 EURO	7	51"	616	\$3,265
11250828F	MULTIBENNE 150 EURO	8	59"	669	\$3,395
11250838F	MULTIBENNE 170 EURO	9	67"	792	\$3,644
11250848F	MULTIBENNE 190 EURO	10	75"	849	\$4,142
11250858F	MULTIBENNE 210 EURO	11	83"	930	\$4,389
11250868F	MULTIBENNE 230 EURO	12	91"	983	\$4,638
11250878F	MULTIBENNE 250 EURO	13	98"	1049	\$5,345
11260828F	SIDE PLATE EXTENSION - MULTIBENNE				\$168

Price includes hoses

Silocut SG



Part No.	Model No	width (in)	wt. (lbs)	Price
11252918F	SILOCUT 125SG	49"	925	\$6,308
11252928F	SILOCUT 150SG	59"	1079	\$6,770
11292938F	SILOCUT 175SG	68"	1377	\$7,268
11252948F	SILOCUT 200SG	78"	1586	\$8,396
11252958F	SILOCUT 225SG	88"	1800	\$8,708

Stonefork



Part No.	Model No	width (in)	wt. (lbs)	Price
11251548F	STONE FORK 150 EURO	110mm/4.3" tine spacing	522	\$2,245
11251558F	STONE FORK 200 EURO	110mm/4.3" tine spacing	653	\$2,840

Powergrab



Part No.	Model No	width (in)	wt. (lbs)	Price
11250728F	POWERGRAB 185 EURO	73"	1189	\$5,595
11250738F	POWERGRAB 210 EURO	83"	1431	\$6,001
11250748F	POWERGRAB 240 EURO	94"	1519	\$6,408
11250758F	POWERGRAB 260 EURO	102"	1717	\$7,019

Price includes loader fittings & hoses

Weld On Hook Set

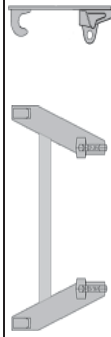

Part No.	Model No	Price
10830555F	HOOKS SET (PAIR)	\$225

Tool Carriers



Part No.	Model No	Price
5220297F	Euro to Skidsteer Adaptor	\$780
5201117	SKID STEER TOOL CARRIER - US (700 / 900 Series)	\$908
5220447-1	SKID STEER TOOL CARRIER - DM	\$1,056
5220449-1	SKID STEER TOOL CARRIER - US,DS	\$1,056
5220312-1	EURO TOOL CARRIER - DM	\$1,056
5220302-1	EURO TOOL CARRIER - DS	\$1,056
5221158-1	EURO TOOL CARRIER - DM, US (Versa X)	\$1,056
5221281-1	SKID STEER TOOL CARRIER - DM,US (Versa X)	\$940
5221748-1	EURO TOOL CARRIER - 100 SERIES	\$940
5221741-1	SKID STEER TOOL CARRIER - 100 SERIES	\$1,056
5221251	F-SERIES TOOL CARRIER	\$1,056

* All tool carriers listed are black. Please contact your sales representative for color options.

Miscellaneous



Part No.	Model No	Price
11208073F	*LIFT ARM EURO	\$1,260
11251438F	3-POINT LINKAGE ALO ATTACHMENT CAT 2	\$823
11251661F	BALLASTING BOX, 3-PT,HITCH CAT 2/3	\$1,019

SHIPPING WEIGHTS

LOADER MODEL	WEIGHT lbs/kg	AVERAGE LOADER PACKAGE COMPLETE lbs/kg
100 SERIES COMPACT LOADERS		
100C	386/175	1086/680
120C	386/175	1086/680
140C	463/210	1163/730
160C	529/240	1229/770
180C	617/280	1317/825
VERSA-X SERIES LOADERS		
X21	680/310	1875/1172
X31	735/335	1950/1220
X41	800/360	2000/1250
X51	860/390	2050/1280
X26	800/360	2000/1250
X36	865/390	2050/1280
X46	920/420	2125/1328
X56	975/440	2175/1359
DIMENSION SERIES LOADERS		
Q21	959 / 436	2598 / 1181
Q31/Q33	990 / 450	2618 / 1190
Q41	1133 / 515	2761 / 1255
Q51	1219 / 554	2836 / 1289
Q61	1382 / 628	2867 / 1303
Q26	1111 / 505	2750 / 1250
Q36/ Q38	1146 / 521	2796 / 1271
Q46/ Q48	1287 / 585	2926 / 1330
Q56/ Q58	1366 / 621	2851 / 1296
Q66/ Q68	1566 / 712	3060 / 1390
Q76/ Q78	1672 / 760	3454 / 1570
Q88	1843 / 838	3856 / 1753
Q98	2061 / 935	4575 / 2080

Weights are typical. Weights may vary depending on options, subframe and bucket size.

* Loader Package consists of Base Loader, Subframe Set, Valve Set and Material Bucket.



DISTRIBUTED IN USA BY:

Rhino

1020 S. Sangamon Avenue

Gibson City, IL 60936

877-408-3297

www.rhinoag.com