

9616239  
BUNDLE 2-5522  
LOADER MOUNTING KIT INSTRUCTIONS  
FOR FORD 7710 TWD & FWD TRACTORS

The mounting brackets can be installed on the tractor and loader using tools ordinarily available. Shut off the tractor engine and engage tractor brakes during installation.

**NOTE:** Unless otherwise specified, leave all attaching hardware loose until loader mounting bracket installation is complete to facilitate assembly and proper alignment of mounting brackets.

Before installing the loader mounting kit, first remove headlights with headlight brackets, front fenders, and front weights with weight brackets if any are present.

If tractor is equipped with optional tractor performance meter, disconnect radar cable, remove radar bracket with radar and spacers for bracket. Keep radar, cable, and all attaching hardware for later use.

#### INSTALLING MOUNTING BRACKETS

1. For earlier model tractors, remove and save the hex head cap screws from the front of the tractor front casting which bolt through the axle mount casting. Position the front mounting bracket (1) so holes of axle mount casting are behind two lower holes of bracket. Placing two spacers (6) behind upper holes of bracket, fasten bracket (1), spacers (6) and axle mount casting to tractor front casting using 3/4 x 3-1/2 cap screws (7) and lock washers (13). Fasten 3/4 x 2" cap screws (9) and lock washers (13) into tractor front casting through holes in sides of front mounting bracket (1).

For newer model front wheel assist tractors with Carraro axles (which can be distinguished by the Ford oval on the front axle hubs), align holes of right and left sides of front mounting bracket (1) with holes in sides of tractor front casting and fasten 3/4 x 2 cap screws (9) and lock washers (13) into holes. Positioning spacers (6) between front mounting bracket (1) and tractor, install 3/4 x 3-1/2 cap screws (7) and lock washers (13) into holes in tractor front casting.

2. Remove hardware fastening battery cable clamp nearest the battery to the tractor. Remove and save step from right side of tractor and fastening hardware from lower pad of clutch casting. Place right mid mounting bracket (3) to right side of tractor as shown and keeping battery cables to outside of right mid mounting bracket, fasten to tractor front casting using 3/4 x 2 cap screws (9), lock washers (13) and flat washers (14) in the front-most holes, 3/4 x 1-1/2 cap screw (10) and lock washers (13) in holes in lower pad of transmission casting, and 3/4 x 1-1/2 cap screws (10), lock washers (13) and flat washers (14) in holes in upper pad of transmission casting.

**NOTE:** It may be necessary to trim the cover for drive shaft on front wheel assist tractors to provide clearance for right mid mounting bracket (3) and also for left mid mounting bracket (2) and crosstie plate (4): see figure 2.

### INSTALLING MOUNTING BRACKETS (continued)

3. Slide mid crosstie plate (4) into channel of right mid mounting bracket (3) from left side of tractor and loosely fasten to right mid mounting bracket (3) using a 3/4 x 2 cap screw (9) and lock nut (17). Loosely fasten one 3/4 x 2-1/2 cap screw (8) with lock washer (13) through mid crosstie plate (4) and right mid mounting bracket (3) into underside of tractor transmission casting.
4. Fasten left mid mounting bracket (2) to left side of tractor using 3/4 x 2 cap screws (9), lock washers (13) and flat washers (14) in the frontmost holes, 3/4 x 1-1/2 cap screws (10) and lock washers (13) in holes in lower pad of transmission casting, and 3/4 x 1-1/2 cap screws (10), lock washers (13) and flat washers (14) in holes in upper pad of transmission casting.

**NOTE:** On tractors equipped with air conditioning, reverse hose clamps and relocate hoses and clamps to inner side of oil line tube brackets. Make sure that hoses do not rub against tractor or loader mounting brackets.

Fasten left mid mounting bracket (2) to mid crosstie plate (4) using a 3/4 x 2 cap screw (9) and lock nut (17). Fasten 3/4 x 2-1/2 cap screw (8) with lock washer (13) through mid crosstie plate (4) and left mid mounting bracket (2) into underside of transmission casting.

5. On tractors with a cab, remove and save the existing cotter pin holding the battery case pivot pin in place. Trim off the side of the battery case cover which is normally toward the tractor. See figure 3. Relocate battery pivot assembly to receptacle provided on the right mid mounting bracket, installing pivot pin from bottom, and reinstall cotter pin. Relocate battery cable clamp (removed in instruction 2) to location shown on right mid mounting bracket (3). Fasten battery cable clamp to right mid mounting bracket (3) using 5/16 x 1-1/4 cap screw (12), washer (16) and lock nut (19).

Tractors without a cab do not require battery case relocation or trimming of battery case cover. Fasten battery cable clamp (removed in instruction 2) to right mid mounting bracket (3) using 5/16 x 1-1/4 cap screw (12), washer (16) and lock nut (19).

6. When all mounting brackets have been installed, tighten all hardware to the torque specified by the table in the SPECIFICATIONS section of the loader operator's manual.

### INSTALLING LOADER TO MOUNTING BRACKETS

1. Attach front support bracket (5) to loader side frame channels with 5/8 x 1-3/4 cap screws (11), washers (15) and lock nuts (18).

**NOTE:** Use the set of holes in the loader side frame channel which place the front support bracket (5) as far forward as possible.

2. Remove and save bucket level indicator with attaching hardware from loader. Attach nylon sling around the loader front bumper and use an overhead hoist to raise loader off skids.

## INSTALLING MOUNTING BRACKETS (continued)



**WARNING:** To avoid injury during installation, do not permit bystanders within 10 feet of loader.

3. Remove and save bucket level indicator with attaching hardware from loader. Attach nylon sling around the loader front bumper and use an overhead hoist to raise loader off skids.
4. Lower loader to a horizontal position on ground and disconnect from overhead hoist.
5. Connect four 1/2 x 180" hoses (supplied in hose kit) onto boom oil line tubes, starting with bottom oil line tube and working up. Install quick couplers (not supplied with loader) onto free ends of hoses.

**NOTE:** Apply sealant to all tapered threads except when coupled with swivel adaptors. When using teflon tape, wrap tape clockwise (as viewed from end) and wrap tape only twice, keeping tape away from first two threads of tapered end to prevent contamination of hydraulic fluid.

6. Attach nylon slings around both boom arms near side frame uprights. Raise side frame uprights approximately one foot (310 mm) off ground.

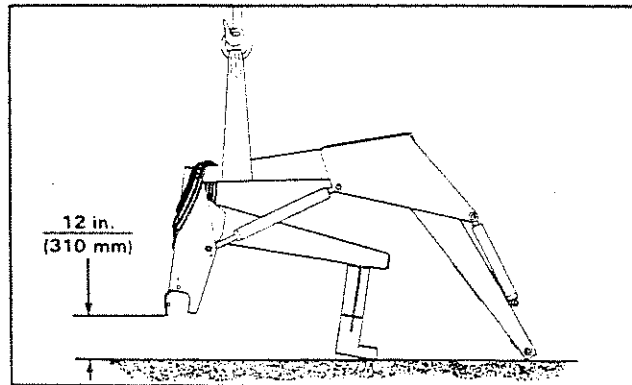

7. Start the tractor engine, release tractor brakes and back tractor up to loader plug quick couplers into tractor remote hydraulic couplers.

**NOTE:** When plugging couplers into tractor remote hydraulic couplers, make sure the hoses for the lift cylinders are connected to the two #1 remote couplers (color coded blue on tractors with cab) and hoses for the bucket cylinders are connected to the two #2 remote couplers (color coded green on tractors with cab).



**WARNING:** Escaping hydraulic fluid under pressure can penetrate the skin causing serious injury.

- DO NOT use your hand to check for leaks. Use a piece of cardboard or paper to search for leaks.
- Stop engine and relieve pressure before connecting or disconnecting lines.
- Tighten all connections before starting engine or pressurizing lines.

## INSTALLING MOUNTING BRACKETS (continued)

If any fluid is injected into the skin, obtain medical attention immediately or gangrene may result.

**IMPORTANT:** Check tractor remote control valve for proper detent operation before connecting loader quick couplers to tractor hydraulics. See REMOTE CONTROL VALVE DETENT CONVERSION section of loader operator's manual for instructions.

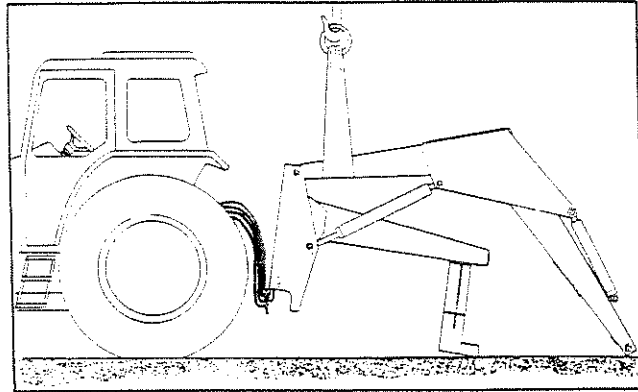

8. Activate valve to extend lift cylinder to full length, then shut off the tractor engine and engage tractor brakes.

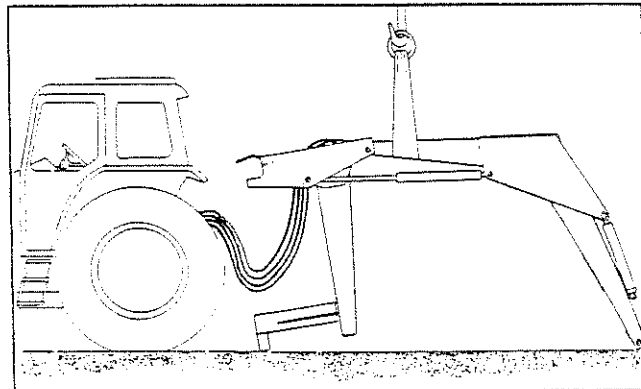

9. Lower loader to the ground and remove overhead hoist. Move lift and bucket control levers back and forth several times to relieve pressure on the lift and bucket cylinders, then disconnect quick couplers from the tractor remote hydraulic couplers.

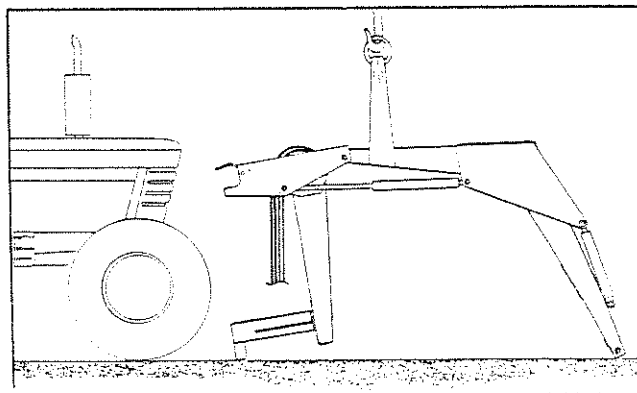

## INSTALLING MOUNTING BRACKETS (continued)

10. Start tractor engine, release tractor brakes and turn tractor around. Slowly drive tractor into loader until hoses will reach from loader to tractor. Engage tractor brakes and shut off tractor engine.
11. Connect quick couplers between tractor and loader.
12. Start tractor engine and release tractor brakes. Slowly drive tractor forward while activating lift control lever to retract lift cylinders. Position tractor so hinges hook mid mounting bracket tubes as loader side frame rotates.

**NOTE:** On tractor models equipped with cab, observe clearance between loader side frame upright and fuel tank when mounting loader.

13. Put the tractor in neutral. Retract the lift cylinders bringing side frame channels up so front support bracket tube contacts front mounting bracket channel. Move the tractor ahead so front support bracket tube engages in front mounting bracket channel and loader side frame uprights seat properly on mid mounting bracket tubes (with no gap between upright cut-out and front of tube). Engage tractor brakes and shut off tractor engine.
14. Remove 3/4 x 3-1/2 cap screw from hole in each side frame upright and clamp hinges around mid mounting tubes. Fasten hinges shut with 3/4 x 3-1/2 cap screws, washers, and lock nuts.
15. Wrap one end of rubber strap (supplied with hose kit) around the 1/2" hoses and hook back onto itself. Position rubber strap about 44 inches away from boom oil line tubes. Attach other end of rubber strap to loader front support bracket.
16. Loosely attach hoses together with one reusable tie strap (supplied with hose kit). On tractors with cabs, loosely attach hoses to the foot rest platform with remaining reusable tie strap. On tractors with cabs, attach hoses to the tractor step or front cab mounting with remaining reusable tie strap.
17. After all plumbing has been completed, start the tractor engine and slowly cycle lift and bucket cylinders several times to free the system of air, then retract cylinders and stop engine. Add additional Ford 134 hydraulic oil as specified in your tractor operator's manual, to bring the oil line up to full.

**NOTE:** When cycling the loader, pulling lift control lever up should raise the loader and pushing it down should lower the loader. Pulling bucket control lever up should roll back bucket and pushing it down should dump the bucket. If direction of control lever is reversed, switch quick coupler connections at the tractor remote hydraulic couplers.

INSTALLING MOUNTING BRACKETS (continued)

18. After mounting the loader, check tire clearances. Adjustment of steering stops may be required. The minimum recommended front tire tread setting is 67.3 inches (1710 mm). Refer to tractor operator's manual for front wheel adjustment.

PARTS LIST

Item	Part No.	Description	Qty.
1	37196	MOUNTING ASSY., Front	1
2	38036	MOUNTING ASSY., Mid Left	1
3	38037	MOUNTING ASSY., Mid Right	1
4	37212	PLATE, Mid Crosstie	1
5	38020	BRACKET ASSY., Front Support	1
6	35685-6	SPACER, Front	4
7	G271777	SCREW, Cap, 3/4-10 x 3-1/2	4
8	G271773	SCREW, Cap, 3/4-10 x 2-1/2	2
9	G271771	SCREW, Cap, 3/4-10 x 2	10
10	G271767	SCREW, Cap, 3/4-10 x 1-1/2	8
11	G271548	SCREW, Cap, 5/8-11 x 1-3/4	4
12	G180081	SCREW, Cap, 5/16-18 x 1-1/4	1
13	G131046	WASHER, Lock, 3/4	22
14	G131017	WASHER, Flat, 3/4	8
15	G131016	WASHER, Flat, 5/8	4
16	G120393	WASHER, Flat, 5/16	1
17	G9414076	NUT, Lock, 3/4-10	2
18	G9414075	NUT, Lock, 5/8-11	4
19	G9413447	NUT, Lock, 5/16-18	1
20	39240	Decal, Warning	2

**Figure 2**  
FWA Drive Shaft Guard  
Modification For  
Newer Model FWA Tractors

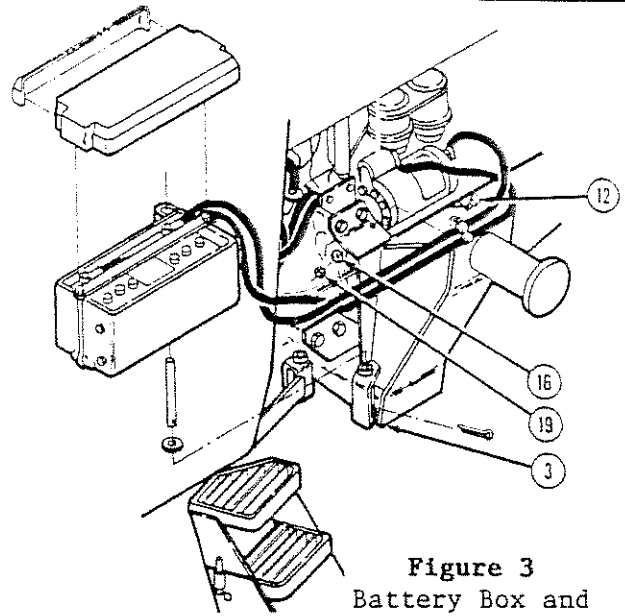
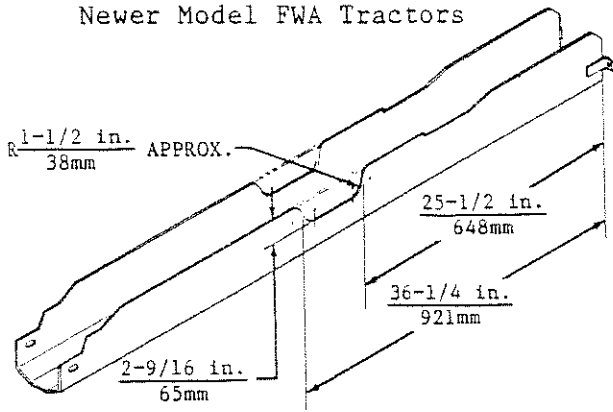

**Figure 3**  
Battery Box and  
Cable Clamp Relocation

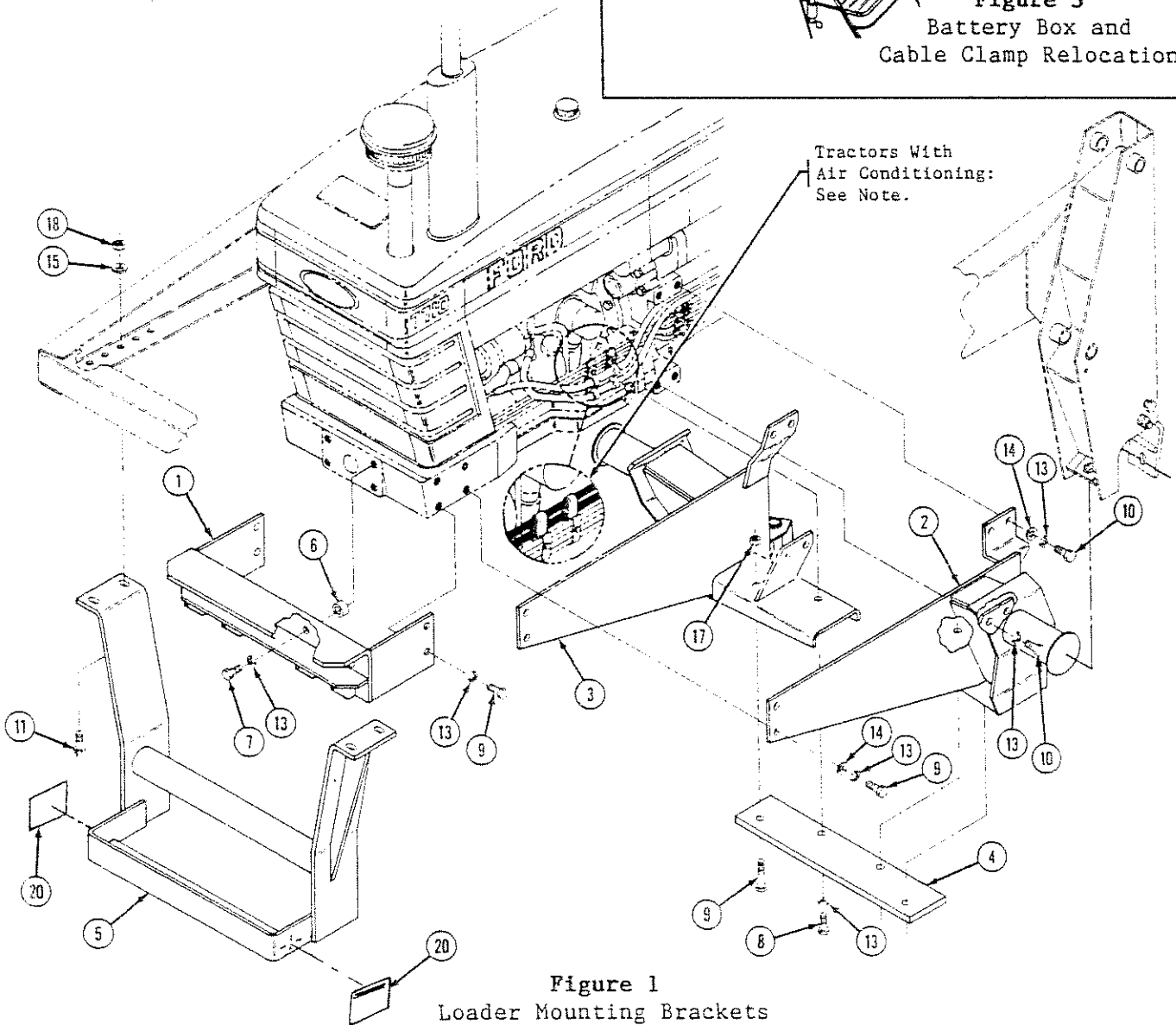

**Figure 1**  
Loader Mounting Brackets