

Keep With Operator's Manual

84Q LOADER MOUNTING KIT AND REINFORCING KIT INSTRUCTIONS FORD 1910 2WD & 4WD TRACTORS

Mount kit and reinforcing kit can be installed on tractor using tools ordinarily available. Shut off tractor engine and engage tractor brakes during installation.

NOTE: Leave all attaching hardware loose until loader is completely assembled to facilitate assembly and proper loader alignment. Torque hardware to torque specifications in loader operator's manual.

INSTALLING MOUNTING BRACKETS (Figure 3)

1. Fasten front mounting bracket (1) to tractor with 5/8" x 1-3/4" cap screws (2) and lock nuts (3).
2. Fasten mid mounting bracket (4) to tractor transmission casting with M16 x 35 metric cap screws (5) and lock washers (6).

INSTALLING REINFORCING BRACKETS (Figure 2)

1. Position reinforcing brackets (10 & 11) to underside of rear axle. Install clamp flat (9) 5/8" x 6-1/2" cap screws (8) and lock nuts (3) but do not tighten.
2. If necessary, using the reinforcing brackets (10 & 11) as a template, drill four holes into mid mounting bracket on each side. If desired, reinforcing brackets (10 & 11) may be welded to mid mounting bracket.
3. Fasten brackets (10 & 11) to mid mounting bracket with 1/2" x 1-1/2" cap screws (12) and 1/2"-x lock nuts (13).
4. Tighten cap screws (8) and lock nuts (3) to 126-139 ft. lb. (171-188 N•m).

INSTALLING LOADER TO MOUNTING BRACKETS

1. Position hinges inside of side frames. Fasten hinges to side frames with 518 x 4-112 carriage bolts and 518 lock nuts (supplied with loader).
2. Attach nylon slings around loader front bumper and use an overhead hoist to raise loader off pallet and lower to a horizontal position.

NOTE: Lower lip of side frame channel must be between front mounting tubes. (Figure 1)

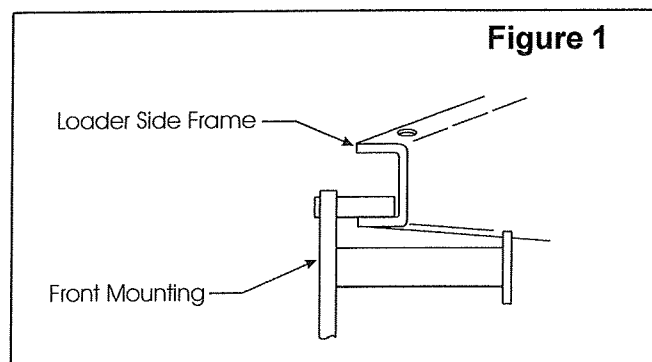

3. Clamp hinges around tubes of mid mounting brackets with 518 x 2-114 cap screws, flat washers, and hex nuts (supplied with loader).
4. Cut striping decal (7) to match length of silver decals on boom arm sides. Apply below silver decals on boom arm sides. Remove clear tape covering decal stripes.
5. Refer to loader owner's manual and plumbing kit instructions to complete loader installation.

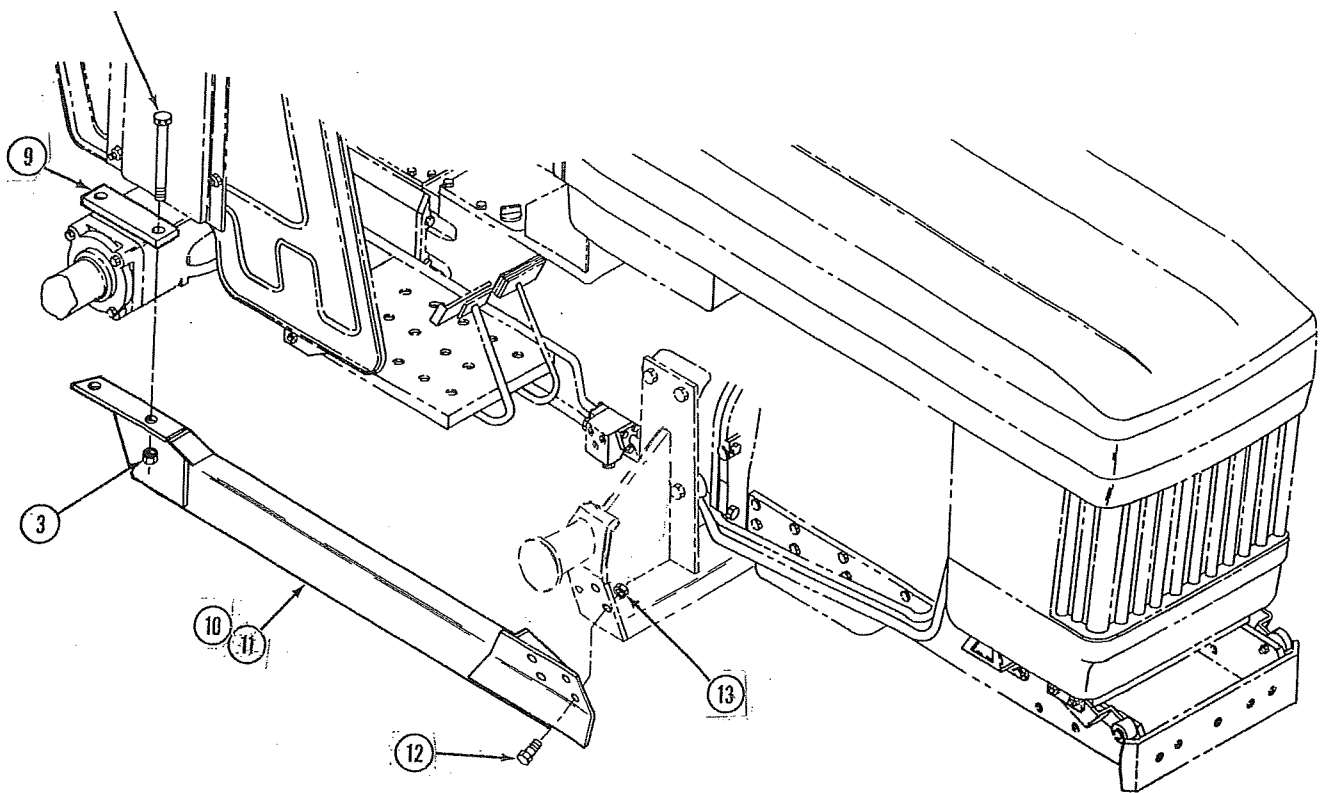
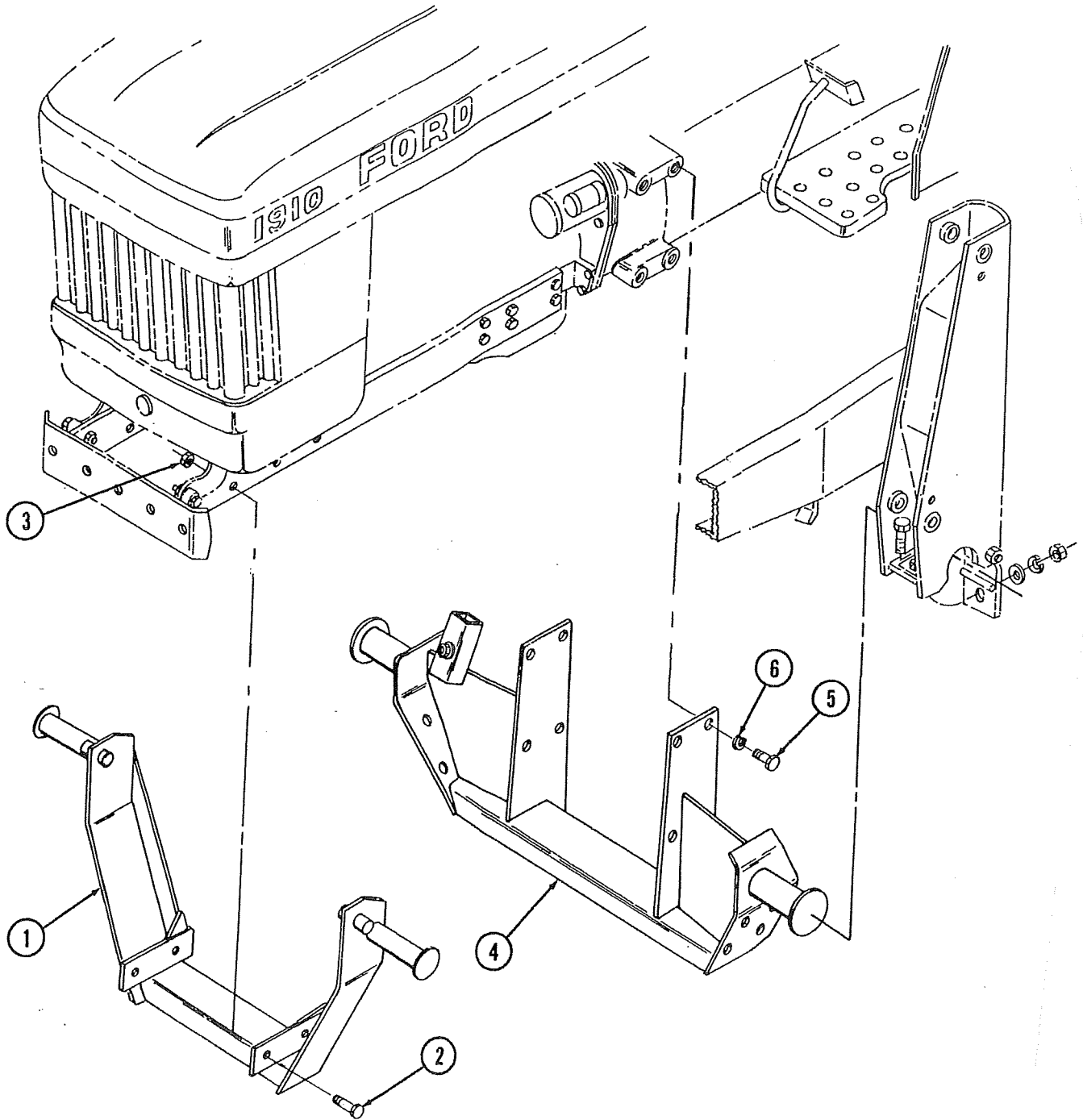

Figure 2
Installing
Reinforcing Brackets

PARTS LIST

Item	Part No.	Description	QTY.
1	36543	BRACKET, Front Mounting	1
2	G271548	SCREW, Cap, 5/8" x 1-3/4"	4
3	G9414075	NUT, Lock, 5/8"	8
4	36547	BRACKET, Mid Mounting	1
5	6090-62	SCREW, Metric Cap, M16-2.0 x 35	8
6	GI21574	WASHER, Lock, 5/8"	8
7	35674-2	DECAL, Blue Multi-stripe (Not Shown)	11.5ft
8	G9429873	SCREW, Cap, 5/8" x 6-1/2"	4
9	35789	CLAMP, Flat	2
10	35788-1	BRACKET, Reinforcing, Left (Not Shown)	1
11	35788-2	BRACKET, Reinforcing, Right	1
12	GI80177	SCREW, Cap, 1/2" x 1-1/2"	8
13	G9414074	NUT, Lock, 1/2"	8

Figure 3
Installing
Reinforcing Brackets



GENERAL TORQUE SPECIFICATIONS

USE THE FOLLOWING TORQUES WHEN SPECIAL TORQUES ARE NOT GIVEN

Standard American and Metric Cap Screws

AMERICAN STANDARD CAP SCREWS									METRIC CAP SCREWS								
SAE Grade	5				8				Metric Class	8.8				10.9			
Typ. Head Markings									Typ. Head Markings								
Cap Screw	TORQUE				TORQUE				Cap Screw	TORQUE				TORQUE			
Size	FT-LBS		N-m		FT-LBS		N-m		Size	FT-LBS		N-m		FT-LBS		N-m	
Inches	MIN	MAX	MIN	MAX	MIN	MAX	MIN	MAX	Millimeters	MIN	MAX	MIN	MAX	MIN	MAX	MIN	MAX
1/4 - 20	6.25	7.25	8.5	10	8.25	9.5	11	13	M6 x 1.00	6	8	8	11	9	11	12	15
1/4 - 28	8	9	11	12	10.5	12	14	16	M8 x 1.25	16	20	21.5	27	23	27	31	36.5
5/16 - 18	14	15	19	20	18.5	20	25	27	M10 x 1.50	29	35	39	47	42	52	57	70
5/16 - 24	17.5	19	23	26	23	25	31	34	M12 x 1.75	52	62	70	84	75	91	102	123
3/8 - 16	26	28	35	38	35	37	47.5	50	M14 x 2.00	85	103	115	139	120	146	163	198
3/8 - 24	31	34	42	46	41	45	55.5	61	M16 x 2.50	130	158	176	214	176	216	238	293
7/16 - 14	41	45	55.5	61	55	60	74.5	81	M18 x 2.50	172	210	233	284	240	294	325	398
7/16 - 20	51	55	69	74.5	68	75	92	102	M20 x 2.50	247	301	335	408	343	426	465	577
1/2 - 13	65	72	88	97.5	86	96	116	130	M22 x 2.50	332	404	450	547	472	576	639	780
1/2 - 20	76	84	103	114	102	112	138	152	M24 x 3.00	423	517	573	700	599	732	812	992
9/16 - 12	95	105	129	142	127	140	172	190	M27 x 3.00	637	779	863	1055	898	1098	1217	1488
9/16 - 18	111	123	150	167	148	164	200	222	M30 x 3.00	872	1066	1181	1444	1224	1496	1658	2027
5/8 - 11	126	139	171	188	168	185	228	251	<p>NOTE: These values apply to fasteners as received from supplier, dry or when lubricated with normal engine oil. They do not apply if special graphite or molysulphide greases or other extreme lubricants are used.</p>								
5/8 - 18	152	168	206	228	203	224	275	304									
3/4 - 10	238	262	322	355	318	350	431	474									
3/4 - 16	274	305	371	409	365	402	495	544									
7/8 - 9	350	386	474	523	466	515	631	698									
7/8 - 14	407	448	551	607	543	597	736	809									
1 - 8	537	592	728	802	716	790	970	1070									
1 - 14	670	740	908	1003	894	987	1211	1337									

INSTALLATION INSTRUCTIONS