

Keep with Operators Manual

HOSE KIT 2408TL LOADER CASE IH & NEW HOLLAND CLASS II TRACTORS

CASE IH MODEL	NEW HOLLAND MODEL
D25, DX25	TC25, TC25D
D29, DX29	TC29, TC29D, TC29A, TC29DA
D33, DX33	TC33, TC33D, TC33A, TC33DA
	1530, 1630, 1725, 1925
D35, DX35	TC35, TC35D, TC35A, TC, 35DA
D40, DX40	TC40, TC40D, TC40A, TC40DA
D45, DX45	TC45, TC45D, TC45A, TC45DA

INSTALLING HOSE KIT

1. Fasten hoses (1) to loader boom hydraulic lines.
 2. Slip nylon sleeves (2) over hoses. Hoses from top two oil lines (blue & red marked) are bundled together. Hoses from bottom two oil lines (yellow & green marked) are bundled together.
 3. Install 45° fittings (5) onto ends of hoses as noted (see figure 1A).
 4. Install male couplers (3) to ends of hoses.
 5. Install spiral bands (4) to ends of hoses according to function as shown in figure 1.
 6. After all plumbing has been completed, slowly cycle lift and bucket cylinders several times to purge air from hydraulic system. Retract cylinders and shut of engine. Replenish tractor hydraulic system.
- NOTE:** When cycling loader, operate loader according to operation decal for valve. If direction of control lever is wrong, or loader will not lower, recheck connections.
7. Install remaining spiral bands (4) on female couplers to match bands on male couplers.



WARNING: Escaping fluid under pressure can penetrate skin causing serious personal injury.

- Do not use your hands to check for leaks. Use a piece of cardboard or paper. Always wear eye protection when searching for leaks.
- Stop engine and relieve pressure before connecting and disconnecting lines.
- Tighten all connections before starting engine or pressurizing lines.

If any fluid is injected into skin, obtain medical attention immediately or gangrene may result.

PARTS LIST - HOSE KIT

Item	Part No.	Description	Qty.
1	36336-3	HOSE, 3/8 X 72	4
2	34853-2	SLEEVE, Nylon Hose	2
3	45273-1	COUPLER, Male Quick	4
4	36240-5	BAND, Color ID, 5/8, Blue	2
	36240-6	BAND, Color ID, 5/8, Red	2
	36240-7	BAND, Color ID, 5/8, Yellow	2
	36240-8	BAND, Color ID, 5/8, Green	2
5	6098-2	FITTING, Adapter, 3/8" NPT x 45°	2
6	7438-1	STRAP, Tarp	1

**Figure 1
Hose Kit**

For Case IH DX Series & New Holland TCA Series

- Lift Cylinder Rod (Yellow)
- Bucket Cylinder Base (Blue)
- Bucket Cylinder Rod (Red)
- Lift Cylinder Base (Green)



Figure 1A

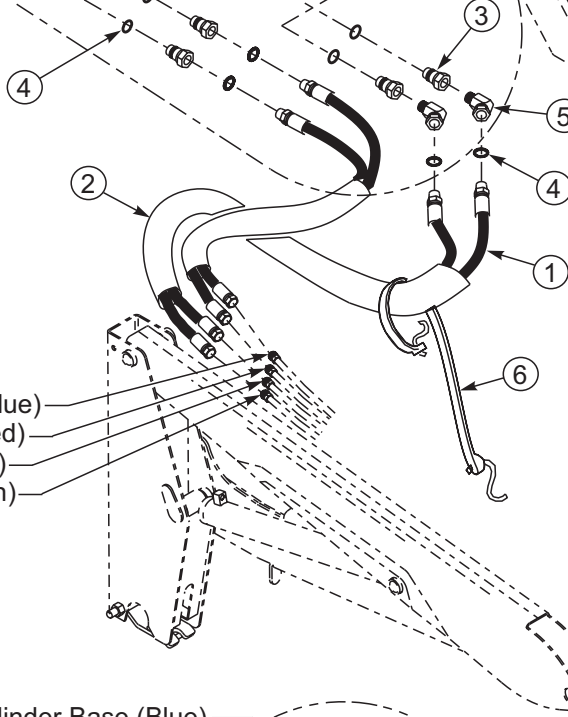

- Bucket Cylinder Base (Blue)
- Bucket Cylinder Rod (Red)
- Lift Cylinder Rod (Yellow)
- Lift Cylinder Base (Green)

- Bucket Cylinder Base (Blue)
- Bucket Cylinder Rod (Red)
- Lift Cylinder Base (Green)
- Lift Cylinder Rod (Yellow)



Figure 1B

