

Keep With Loader Operator's Manual

LOADER MOUNTING KIT INSTRUCTIONS

MODEL	2WD	4WD	LESS CAB	WITH CAB
2000, 2100, 2600, 2610, 2810, 2910	X		X	
3000, 3100, 3600, 3610, 3910	X		X	
4000SU, 4100SU, 4600SU, 4610SU	X		X	

Mounting brackets can be installed using tools ordinarily available. If tractor is equipped with headlights mounted on side of tractor, front fenders or front weights mounted bracket, they must be removed before installing mounting brackets. For tractors equipped with a tool box, it will be necessary to relocate it to where it will not interfere with loader. Set tread width.

NOTE: If steering arms are above axle, set tread width to 60". If steering arms are below axle, 52", 56" or 60", tread width may be used.

Check tire clearances once loader is installed. Shut off tractor engine and engage tractor brakes during installation.

NOTE: Leave all attaching hardware loose until mounting brackets are completely assembled to facilitate assembly and proper alignment. Tighten all hardware to torque specifications in loader operators manual.

INSTALLING MOUNTING BRACKETS (Figure 1)

1. Before installing loader mounting brackets, add two 5/8 x 3-1/2 cap screws (15), flat washer (16) and nut (17) to each side of tractor front axle to improve the weight carrying capacity of the axle. Torque cap screws to 150 - 180 ft. lbs.

2. Using a floor jack positioned under tractor transmission, raise tractor until front tires are off the ground. Doing one side at a time, remove hardware securing front casting to engine block. Install left or right

support bracket (5 or 6) using 3/4 x 6 cap screws (10) and 3/4 lock nuts (18). Do not torque cap screws (10) until installation is complete. Repeat for other side and remove floor jack.

3. Install right midmounting bracket (3) and spacer (14) to support bracket and transmission casting using 3/4 x 2-1/4 cap screws (21) and 3/4 lock washers (12).

NOTE: Midmounting brackets are angled toward rear of tractor.

4. Install left midmounting bracket (4) to support bracket and transmission casting using 3/4 x 3 cap screws (19) and 3/4 lock washers (12) in top holes and 3/4 x 2-1/4 cap screws (21) and 3/4 lock washers (12) in bottom holes.

NOTE: To ease installation install top rear cap screw (19) first.

5. Fasten front mounting bracket (1) to tractor front casting using 5/8 x 1-1/2 cap screws (7) and 5/8 lock washers (17). It may be necessary to adjust sheet metal to allow clearance for socket wrench.

NOTE: Relocate headlights to top of hood if necessary to clear loader side frames.

6. Fasten support brackets (5 & 6) to front mounting bracket (1) using 1/2 x 1-1/2 cap screws (9) and 1/2 lock nuts (11).

BUNDLE 2-6223
BUNDLE 2-6551

715787001

PARTS LIST - MOUNTING KIT

ITEM	PART NO.	DESCRIPTION	QTY.
1	43256	BRACKET, Front Mounting	1
2	43257	YOKE Assembly	1
3	43250	BRACKET, Midmounting, Right	1
4	43251	BRACKET, Midmounting, Left	1
5	43330	SUPPORT, Right	1
6	43331	SUPPORT, Left	1
7	G271547	SCREW, Cap, 5/8-11 X 1-1/2	2
8	G121574	WASHER, Lock, 5/8	2
9	G180177	SCREW, Cap, 1/2-13 x 1-1/2	4
10	G9429889	SCREW, Cap, 3/4-10 x 6	4
11	G9414074	NUT, Lock, 1/2-13	4
12	G131046	WASHER, Lock, 3/4	8
13	G271773	SCREW, Cap, 3/4-10 x 2-1/2	4
14	36772-6	SPACER, Flat	1
15	G271729	SCREW, Cap, 5/8-11 x 3-1/2	4
16	G131016	WASHER, Flat, 5/8	4
17	G9414075	NUT, Lock, 5/8-11	4
18	G9414076	NUT, Lock, 3/4-10	8
19	G271774	SCREW, Cap, 3/4-10 x 2-3/4	2
20	39240	DECAL, "Warning - Do Not Tow..."	2
21	G271772	SCREW, Cap, 3/4-10 x 2-1/4	6
22	43128	CYLINDER (JW) 2-3/4"	2
23	6075-4	FITTING, Grease, 1/4-28, Straight	4

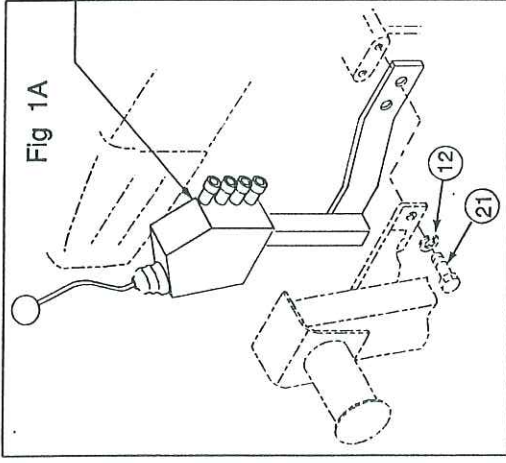

NOTE: To ease installation, install top rear cap screw (19) first on left side.

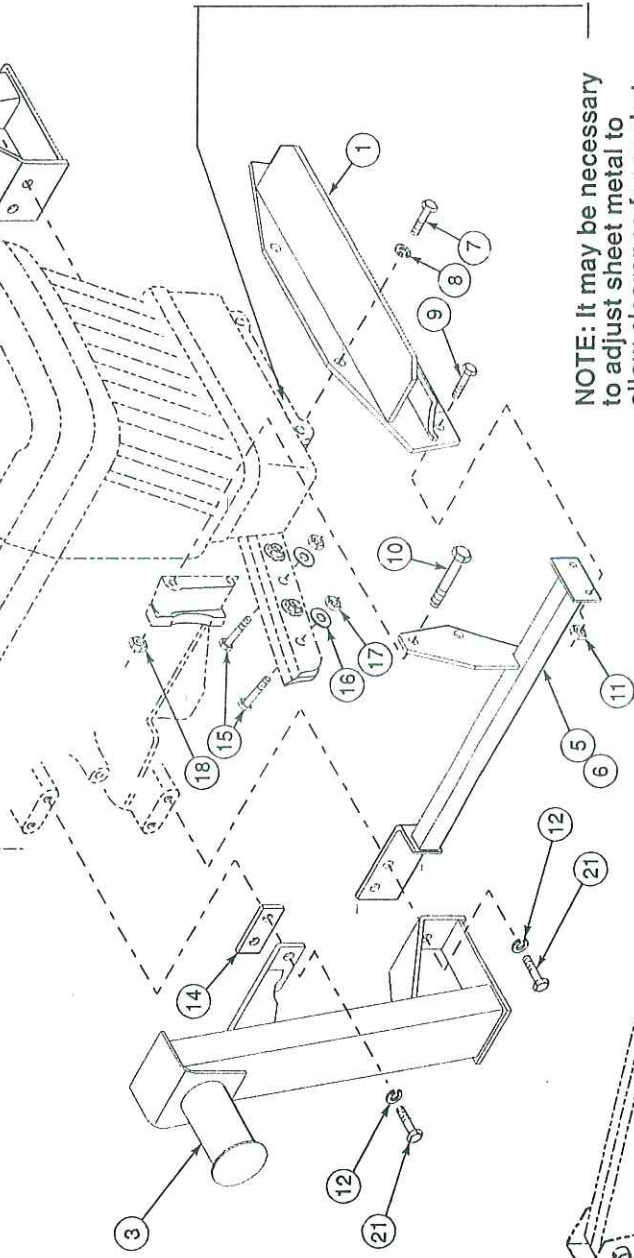
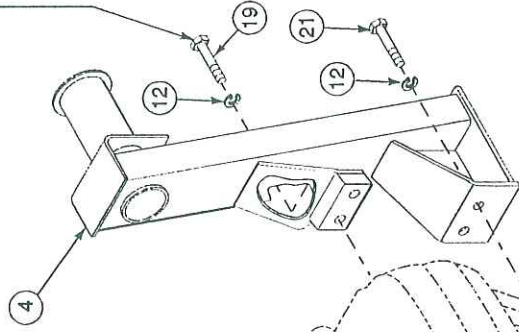

NOTE: It may be necessary to adjust sheet metal to allow clearance for socket wrench.

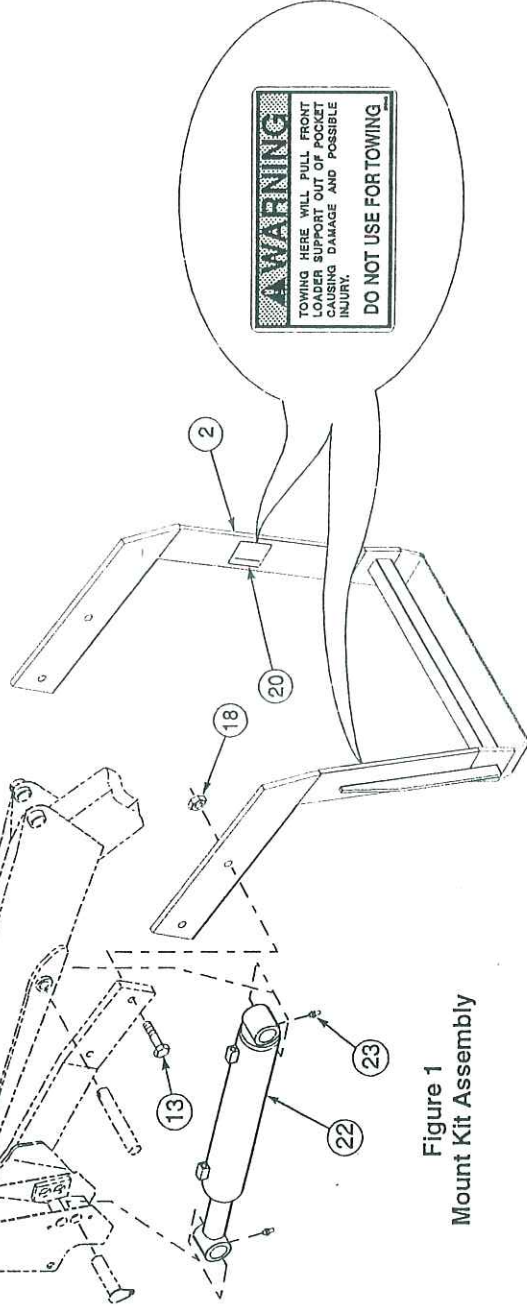

Figure 1
Mount Kit Assembly

INSTALLING LIFT CYLINDERS

1. Install grease fittings (23) to base and rod ends of lift cylinders (22) with fittings pointing down.



WARNING: Be sure to support loader using an overhead hoist. Installed lift cylinders will not support loader in upright position. Boom may fall causing serious personal injury.

2. Loop nylon strap around center of boom crossmember. Using overhead hoist to support loader, remove cap screws and pins which secure shipping braces.

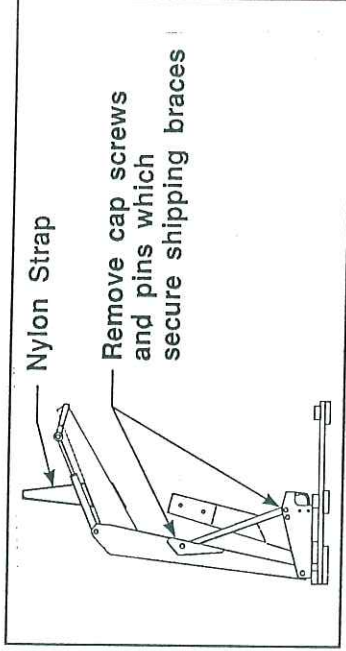

3. Install lift cylinders (22), with base end toward front and hydraulic ports toward top, using hardware previously removed. See chart for optional cylinder placement.

NOTE: Pin rod end into loader upright first, then pin base end into loader boom.

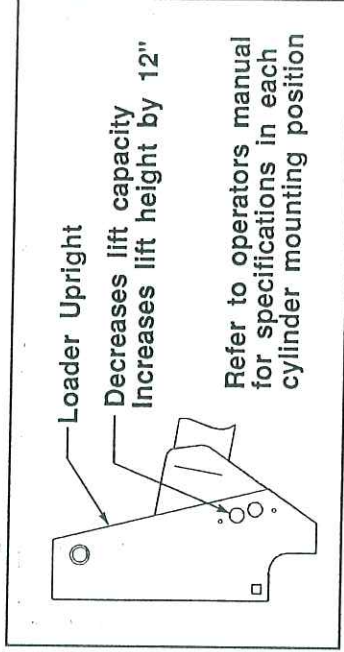

4. Disconnect lift cylinder hoses one at a time from steel oil lines to avoid error when reconnecting.

NOTE: Lift cylinder hoses must be free to turn while they are being connected to lift cylinders.

5. Connect hoses to lift cylinders. Reconnect hoses to steel oil lines.

INSTALLING LOADER TO MOUNTING BRACKETS



WARNING: To avoid injury during installation of quick attach loader, do not permit bystanders within ten feet of loader.

1. Install yoke assembly (2) using 3/4 x 2-1/2 cap screws (13) and 3/4 lock nuts (18). Install rear cap screws first and swing yoke into position, then install front cap screws.

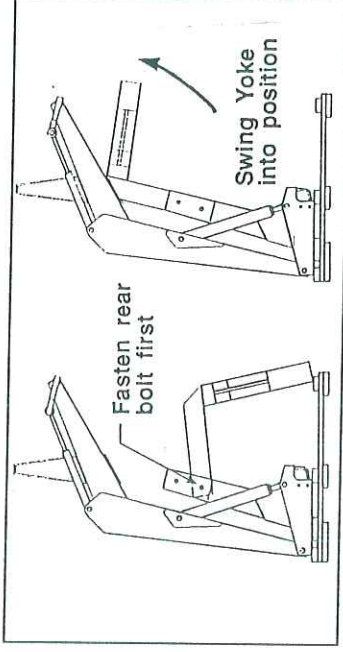

NOTE: Hardware connecting yoke to loader sideframes should be snug but do not torque completely. After loader has been mounted to tractor and aligned with midmounting brackets and front mounting brackets, torque hardware to 238-262 ft. lb.

2. Remove hardware securing loader to pallet. Using overhead hoist, lower loader from vertical shipping position to horizontal position (scraps of cardboard may be used to protect paint).
3. Install hose or valve kit to tractor and loader. Refer to assembly manual provided for installation instructions.
4. Position tractor close enough so plumbing can be connected to tractor. Shut off tractor engine and engage tractor brakes. Route hoses loosely to allow maximum reach. Reposition overhead hoist by looping nylon strap around yoke near loader-side frames at balance point of loader.

INSTALLING LOADER TO MOUNTING BRACKETS (Continued)

- Using overhead hoist, raise loader until side frame uprights will clear front tires. Remove lock nut and washer from loader hinge and swing each hinge open.

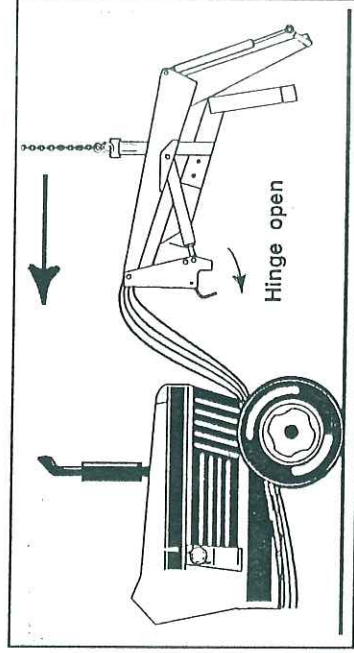
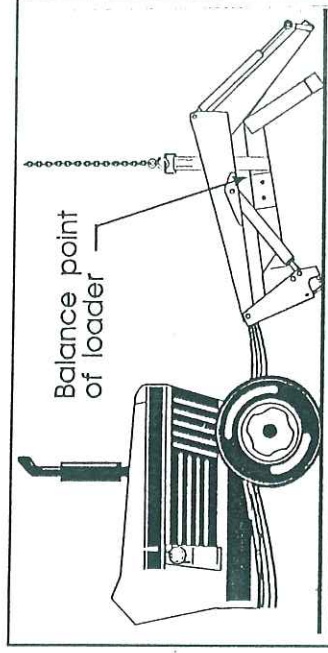

- Position loader so hinges hook over mid mounting tubes and yoke tube fits inside front mounting bracket.

BUNDLE 2-6223 BUNDLE 2-6551

- Clamp hinges to midmounting tubes with 3/4 flat washers and 3/4 flex-lock nuts (supplied with loader).

IMPORTANT: Be sure to use flex-lock nuts to clamp hinge. Tighten flex-lock nuts against hinge securely, but not to more than 125 ft.-lb. torque.

- Wrap rubber strap around hoses and hook to itself. Hook other end of rubber strap to front of yoke.

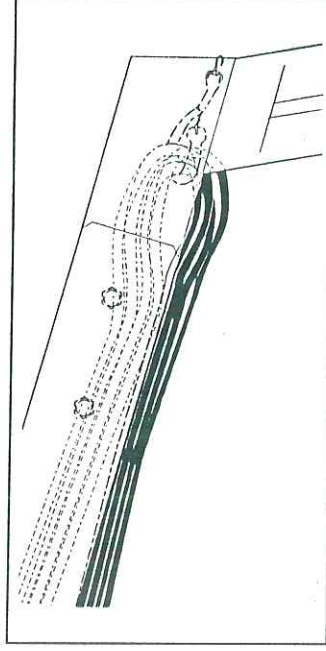

- Adjust front wheel tread settings or steering stops, if necessary to prevent interference between tires and loader. Refer to tractor operator's manual for adjustment procedures.

**BUNDLE 2-6223
BUNDLE 2-6551
INSTALLING BUCKET OR OPTIONAL
ATTACHMENT**

715787001

Refer to loader operator's manual for instructions on installing bucket or optional attachment.

INSTALLING BUCKET LEVEL INDICATOR

1. Attach indicator guide tube to cylinder pin. Guide tube is positioned to outside of boom for pin on attachments and inside of boom when quick attach device is used.

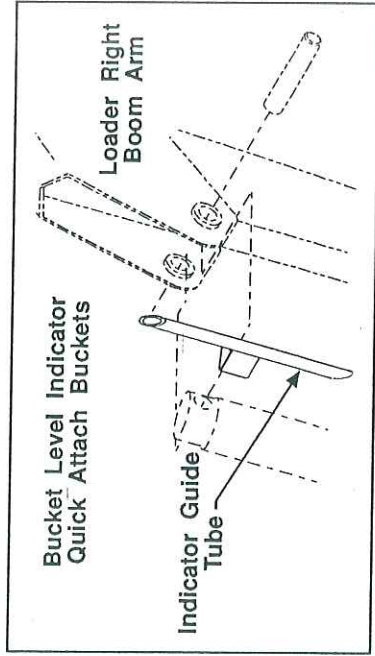
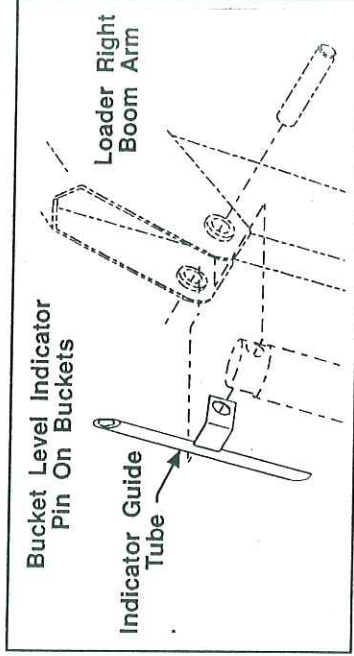

2. Slide bucket level indicator rod through guide tube. Attach other end of rod with 1/8 x 1 cotter pins and 3/8 flat washers. If pin on bucket is used, attach lower end of rod to bucket ear. If quick attach device is used, attach lower end of rod to quick attach device.

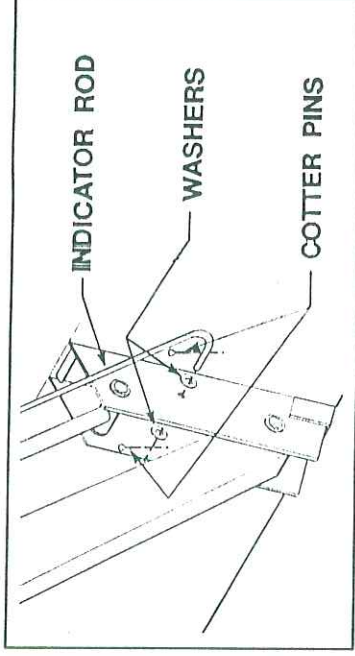

3. Locate tractor and loader on level surface. With bottom of bucket resting on surface, cut off excess rod flush with end of guide tube or paint exposed rod a contrasting color.

NOTES

INSTALLATION INSTRUCTIONS