

Keep With Operator's Manual
-----------------------------

**THIRD FUNCTION PLUMBING KIT**  
**NEW HOLLAND 32LA & 32LA-MSL LOADERS**  
**NEW HOLLAND TN SERIES & TN SERIES DELUXE TRACTORS**

MODEL	FWA	2WD
TN55 & TN55D	X	X
TN65 & TN65D	X	X
TN75 & TN75D	X	X

**NEW HOLLAND 33LA & 33LA-MSL LOADERS**  
**NEW HOLLAND TN SERIES SUPER-STEER TRACTORS**

MODEL	SUPER-STEER
TN55S	X
TN65S	X
TN75S	X

Plumbing kit can be installed using tools ordinarily available.

Shut off engine and engage brakes during installation.

**PLUMBING THIRD FUNCTION KIT TO REAR REMOTE VALVE (Figure 1)**

- Position the bulkhead assembly (1) on top of loader crossmember on rear side of hydraulic oil lines, 9" from where crossmember meets left side boom arm (see figure 1). Square with rear of crossmember. Using bracket (1) as template, drill two 3/16 holes into crossmember. Fasten bulkhead assembly bracket (1) to crossmember using 1/4 x 3/4 self tapping screws (2).

**NOTE:** Loaders equipped with cover over loader oil lines may require removal of cover to install bulkhead assembly (1). Bulkhead bracket should be placed so that center of bulkhead assembly is aligned with left edge of oil line cover. Using bulkhead assembly (1) as template, drill two 3/16 holes into crossmember. Fasten bulkhead assembly to crossmember using 1/4 x 3/4 self tapping screws (2). Reinstall oil line cover.

- Assemble couplers (6 & 7) to bulkhead fittings (5) and fasten to bulkhead assembly (1) using nuts supplied with bulkhead union fittings (5). Assemble 90° adapter fitting (8) to bulkhead fitting (5) and attach female end of hoses (4) to 90° adapter fittings (8).
- Install colored dust caps (9 & 10) to couplers (6 & 7) as illustrated in figure 1.
- Route 3/8 x 242" hoses (4) from bulkhead assembly (1) to rear remote.

- Install color coded dust caps (11 & 12) and male couplers (13) to the male end of hoses (4). Attach colored spiral bands (14 & 15) to corresponding female couplers on tractor rear remote.

**NOTE:** It is important to make sure color coding corresponds between dust caps and spiral bands on each hose.

- Using adjustable plastic straps (3), bundle hoses together to avoid interference with moving parts.
- After all plumbing has been completed slowly cycle third function attachment several times to purge air from hydraulic system. Retract cylinders and shut off engine. Replenish tractor hydraulic system.

**NOTE:** When cycling third function, operate loader according to operation decal for valve. If direction of control lever is wrong, reverse hose connections and recheck operation.



**WARNING:** Escaping fluid under pressure can penetrate skin causing serious personal injury.

- Do not use your hands to check for leaks. Use a piece of cardboard or paper. Always wear eye protection when searching for leaks.
- Stop engine and relieve pressure before connecting and disconnecting lines.
- Tighten all connections before starting engine or pressurizing lines.

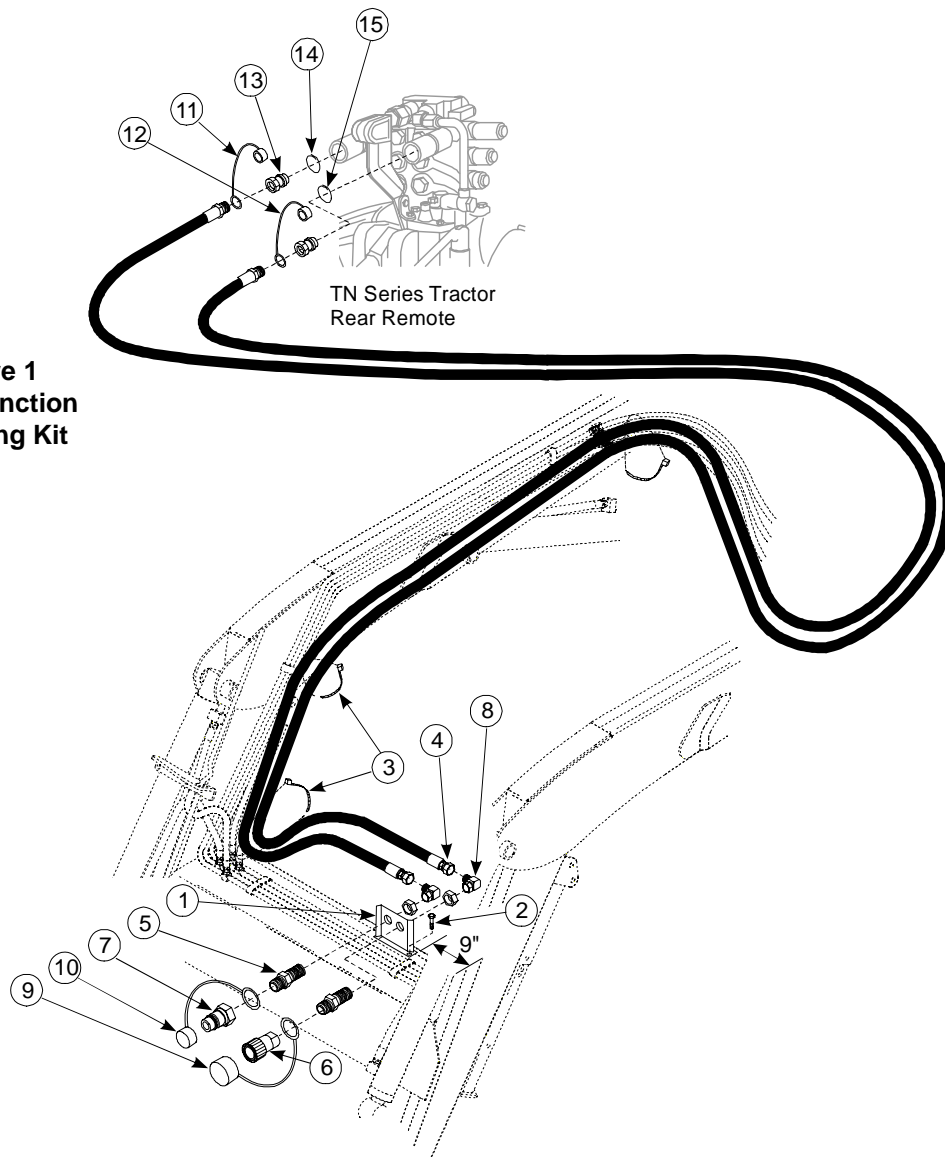

**Figure 1**  
**Third Function**  
**Plumbing Kit**

**PARTS LIST - THIRD FUNCTION PLUMBING KIT (Figure 1)**

ITEM	SMC NO.	NH NO.	DESCRIPTION	QTY.
1	47580	SML47580	BULKHEAD ASSEMBLY	1
2	36354-2	SML363541	SCREW, 1/4-14 x 3/4, Self tapping	2
3	8137-1	SML81371	STRAP, Adjustable, .19 x 11	6
4	47579-1	SML475791	HOSE, 3/8 x 242	2
5	47297-1	SML472971	FITTING, Bulkhead Union, O-ring, 3/4-16	2
6	45291-2	SML452912	COUPLER, Flat face, Female	1
7	45292-2	SML452922	COUPLER, Flat face, Male	1
8	34128-2	00248974	FITTING, Elbow, 90°, 3/4-16 x 3/4-16	2
9	4838-15	SML483815	DUST CAP	1
10	4838-16	SML483816	DUST CAP	1
11	4838-3	SML48383	DUST CAP, Red	1
12	4838-8	SML48388	DUST CAP, Blue	1
13	6137-10	SML613710	COUPLER, Male	2
14	36240-10	SML3624010	SPIRAL BAND, Red, 1"	1
15	36240-9	SML362409	SPIRAL BAND, Blue, 1"	1