

Keep with Operators Manual

PLUMBING KIT FOR NEW HOLLAND 52LA OR 5211 LOADER

NEW HOLLAND TL & 35 SERIES TRACTORS WITH MID-MOUNTED REMOTE VALVE

MODEL	2WD	4WD	LESS CAB	WITH CAB
TL70 & TL80	X	X	X	X
TL90 & TL100	X	X	X	X
4835 & 5635	X	X	X	X
6635 & 7635	X	X	X	X

INSTALLING PLUMBING KIT (Figure 1, 2 & 3)

- Remove plugs from working ports of mid-mounted remote valve.
- Install and tighten 18mm x 3/4-16 O-ring adapter fittings (1), 3/4-16 O-ring swivel adapter fittings (2) and female quick couplers (3) to ports of valve.
- Install colored dust plugs (4-7) to female couplers (3) with colors as illustrated in figure 3.
- Install 90° elbow (15), swivel adapter (2) male coupler (14) and color coded dust cap (8 & 9) to one end of each of two 3/8 x 70" hoses (12). Hand tighten male couplers (14) to 90° elbow (16) then tighten jam nut on 90° elbow (16) to male coupler (14) and install color coded dust cap (10 & 11) to one end of each of two remaining 3/8 x 70" hoses (12). Install color coded spiral bands (17-20) to the opposite end of hoses (12).

NOTE: It is important to make sure color coding corresponds between dust caps and spiral bands on each hose.

- Slide nylon sleeve (13) over 3/8 x 70" hoses (12) and install hoses to steel oil lines on loader in sequence shown in Figure 3. Hose with blue coding attaches to bucket cylinder base. Hose with red coding attaches to bucket cylinder rod. Hose with yellow coding attaches to lift cylinder rod. Hose with green coding attaches to lift cylinder base.
- During loader installation, attach loader hoses with male couplers and colored dust caps to tractor couplers with corresponding dust plug color coding. Hoses may need to be loosened at 90° elbow (15 & 16) for better routing. Attach dust caps to dust plugs.
- Route hoses (12) behind tool box on cab tractors as illustrated in figure 1 or at handrail on less cab tractors as illustrated in figure 2. Bundle hoses together and secure with tarp strap (21) to avoid interference with moving parts as necessary. Tarp strap hooks are located in parts bag.
- After plumbing and loader installation has been completed, slowly cycle lift and bucket cylinders several

times to purge air from hydraulic system. Retract cylinders and shut off engine. Replenish tractor hydraulic system with New Holland 134 hydraulic oil.

NOTE: When cycling loader, operate loader according to operation decal for valve. If direction of control lever is wrong, or loader will not lower, recheck connections.



WARNING: Escaping fluid under pressure can penetrate skin causing serious personal injury.

- Do not use your hands to check for leaks. Use a piece of cardboard or paper. Always wear eye protection when searching for leaks.
- Stop engine and relieve pressure before connecting and disconnecting lines.
- Tighten all connections before starting engine or pressurizing lines.

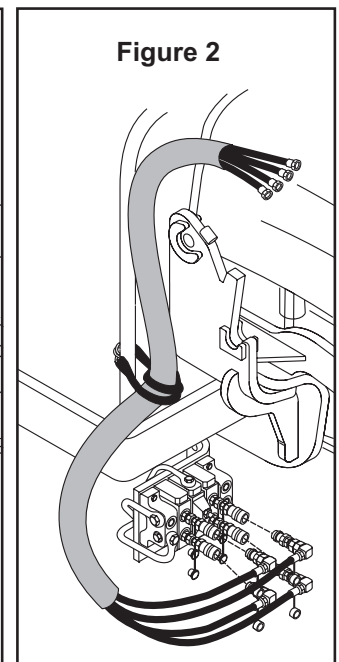
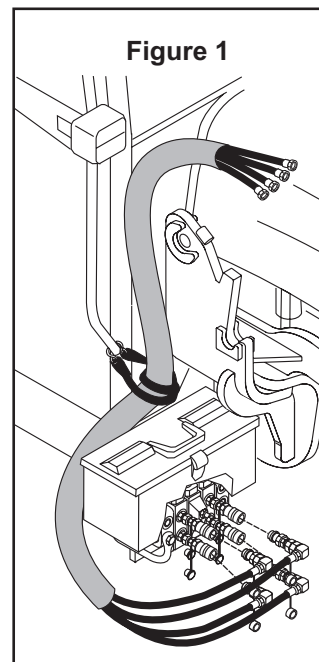
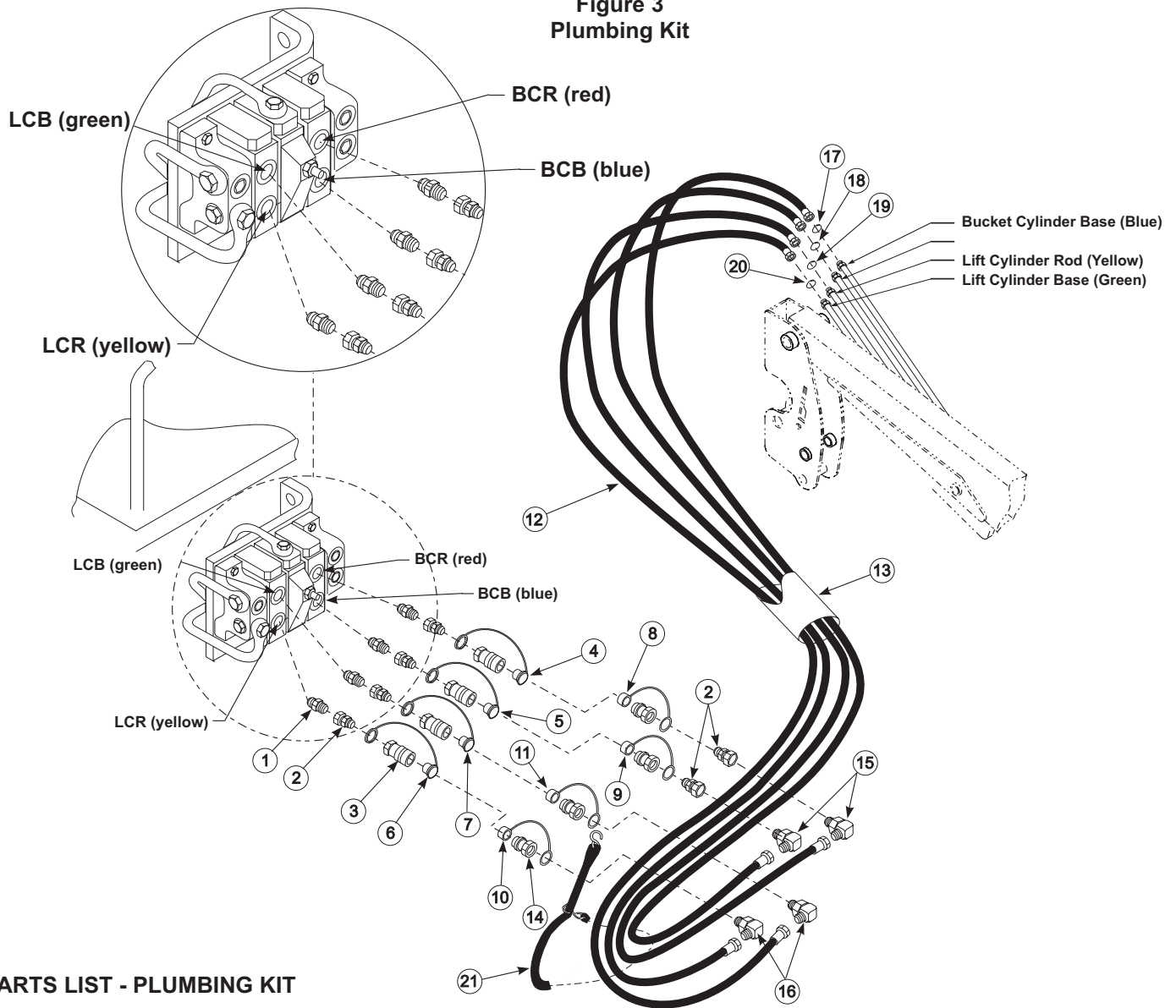

Figure 3
Plumbing Kit



PARTS LIST - PLUMBING KIT

ITEM	SMC NO.	NH NO.	DESCRIPTION	QTY.
1	41173-2	86581709	FITTING, Adapter, 18mm-1.50 x O-ring 3/4-16	4
2	42062-1	9601709	FITTING, Adapter, Swivel, O-ring 3/4-16	6
3	47110-1	86582375	COUPLER, Female, O-ring 3/4-16	4
4	4838-4	86581710	DUST PLUG, Red	1
5	4838-12	86581711	DUST PLUG, Blue	1
6	4838-13	86581712	DUST PLUG, Yellow	1
7	4838-14	86581713	DUST PLUG, Green	1
8	4838-3	86581687	DUST CAP, Red	1
9	4838-8	86581686	DUST CAP, Blue	1
10	4838-9	86581688	DUST CAP, Yellow	1
11	4838-10	86581689	DUST CAP, Green	1
12	47422-2	86581675	HOSE, 3/8 x 70"	4
13	34853-26	86581681	SLEEVE, Nylon, 52"	1
14	6137-10	86581680	Coupler, Male, O-ring 3/4-16	4
15	36664-2	216791	FITTING, 90° Elbow, 3/4-16 JIC Male x 3/4-16 JIC Male	2
16	32845-2	86582376	FITTING, 90° Elbow, 3/4-16 O-Ring Male x 3/4-16 JIC Male	2
17	36240-5	86581714	SPIRAL BAND, Plastic, Blue, 5/8	1
18	36240-6	86581715	SPIRAL BAND, Plastic, Red, 5/8	1
19	36240-7	86581716	SPIRAL BAND, Plastic, Yellow, 5/8	1
20	36240-8	86581717	SPIRAL BAND, Plastic, Green, 5/8	1
21	7438-1	86581718	TARP STRAP	1