

**BACKHOE SUBFRAME KIT
NEW HOLLAND OR CASE IH TRACTORS
WITH OR LESS COMPATIBLE LOADER OR FRONT BLADE**

MODEL	BACKHOE	TRACTOR	LOADER	BLADE
NEW HOLLAND	756C, 757C, 758C	TC35, TC40, TC45, TC35A, TC35D, TC35DA, TC40A, TC40D, TC40DA, TC45A, TC45D, TC45DA	16LA, 17LA	702C, 702D, 72CBH, 84CBH
CASE IH	BHX172, BHX190, BHX1102	D35, DX35, D40, DX40, D45, DX45	LX116	702C, BMX172H, BMX184H

Subframe can be installed on tractor and backhoe using tools ordinarily available. Tractor must be equipped with loader to install subframe. References to left or right is from perspective of someone sitting on tractor seat facing forward.

Complete backhoe installation requires hydraulic kit 715431006 (2-6739). Install hydraulic kit to tractor before installing backhoe to tractor.

NOTE: *This subframe is not compatible with 914A or MWX mowers.*

**INSTALLING SUBFRAME TO BACKHOE
(Figures 1 & 2)**

1. Install subframe (1) (with crosstube to bottom) to backhoe using 3/4 x 2-3/4 cap screws (9) and 3/4 lock nuts (10) in front holes and 7/8 x 3-1/2 cap screws (11), 7/8 lock washers (12) and 7/8 hex nuts (28) in rear holes.
2. Fasten support braces (6) to outside of subframe and inside of backhoe frame using 3/4 x 2-3/4 cap screws (9), 3/4 lock nuts (10) and then install double nut (10) (Torque to 350 ft lbs).

INSTALLING MOUNTING BRACKET

1. Remove 16mm cap screws which secure hitch to underside of tractor.

NOTE: *It may be necessary to support hitch assembly when 16mm cap screws are removed.*

NOTE: *756C backhoe use front set of mounting holes for braces.*

2. Remove PTO shield. Install rear support (21) to rear mounting bracket (2) using 1/2 x 1-1/2 cap screws (19) and 1/2 lock nuts (20). Leave hardware loose. Attach rear hanger bracket (21) and PTO shield to transmission housing using 16mm x 35mm cap screws (17) and 5/8 lock washers (15), also use 5/8 flat washers (18) at PTO shield.
3. Install mounting bracket (2) using 16mm x 100mm cap screws (16) and original lock washers.

NOTE: *If tractor is equipped with cast iron swinging drawbar bracket use spacer washers (5) between*

mounting (2) and drawbar bracket, if necessary to line up bolt holes.

4. Remove rear cap screws which secure loader mid-mounting brackets to tractor.
5. If tractor is equipped with 16LA or 17LA loader, install front mounting brackets (3 & 4) using 16mm x 110mm cap screw (13) with 5/8 lock washer (15) in lower front hole and 16mm x 100mm cap screws (16) with 5/8 lock washers (15) in upper and lower rear holes.
6. If tractor is equipped with 702C Dozer Blade install front mounting bracket (3) on right side of tractor. Space bracket (3) out from tractor with spacer tube (26) at upper hole and spacer flat (25) at bottom holes. Use similar spacers to space mounting bracket (4) on left side. Fasten front mounting brackets (3 & 4) using 16mm x 70mm cap screws (27) with 5/8 lock washers (15).
7. For 757C & 758C backhoes, install 3-point lift arm stop (22) on right side of subframe using 5/8 x 1-3/4 cap screw (23), 5/8 flat washer (18) and 5/8 lock nut (24).

For 756C backhoe, install 3-point lift arm stop (22) on right side of subframe using 3/4 x 2-3/4 cap screw (9), and double nut (10).

8. Switch bolt around attaching right 3-point lift arm to stabilizer bracket on tractor to prevent bolt from catching on 3-point arm stop bracket (22).
9. Torque all bolts to specifications in backhoe manual unless otherwise specified.

MOUNTING BACKHOE TO TRACTOR (Figure 1)

1. Back tractor slowly toward backhoe, parallel to subframe assembly, until hoses can be connected to tractor.
2. Connect hoses to tractor hydraulics.
3. Using backhoe controls, extend bucket and lower stabilizers to provide a base for raising subframe. Using backhoe controls, raise subframe to proper height to connect to tractor.

MOUNTING BACKHOE TO TRACTOR (Figure 1) (Continued)

4. Position 3-point hitch arms inside subframe support braces.
5. Back tractor and position subframe so crosstube engages pocket in rear mounting bracket (2) and holes in front of subframe align with front mounting

brackets (3 & 4). Install 3/4 pins (7) and lynch pins (8).

NOTE: After backhoe is mounted, swing backhoe full right and full left to be sure there is not interference between swing cylinders and 3-point hitch arms.

PARTS LIST - REPAIR PARTS

ITEM	PART NO.	NH NO.	DESCRIPTION	QTY.
1	48101	SML48101	SUBFRAME	1
2	48106	SML48106	BRACKET, Mounting, Rear	1
3	48111-1	SML481111	BRACKET, Mounting, Front, Left	1
4	48111-2	SML481112	BRACKET, Mounting, Front, Right	1
5	6120-27	SML612027	BUSHING, .75 I.D. x 1.25 O.D. x 10 GA.(.140")	4
6	44836	SML44836	BRACE	2
7	44892	SML44892	PIN ASSEMBLY	2
8	44756-1	SML447561	LYNCH PIN	2
9	42969-4	SML429694	SCREW, Cap, 3/4-10 x 2-3/4, Grade 8	6
10	47264-8	SML472648	NUT, Lock, 3/4-10	10
11	41838-56	SML4183856	SCREW, Cap, 7/8-9 x 3-1/2	2
12	41837-9	87341	WASHER, Lock, 7/8	2
13	49040-16	43874	SCREW, Cap, 16mm-2.0mm x 110mm	2
15	41837-7	84057	WASHER, Lock, 5/8	14
16	49040-8	374889	SCREW, Cap, 16mm -2.0mm x 100mm	8
17	42672-11	86508583	SCREW, Cap, 16mm -2.0mm x 35mm, Class 8.8	4
18	42502-12	87365	WASHER, Flat, 5/8	3
19	41838-33	87689	SCREW, Cap, 1/2-13 x 1-1/2	4
20	41840-5	9636698	NUT, Lock, 1/2-13	4
21	48114	SML48114	BRACKET, Hanger, Rear	1
22	48116	SML48116	BRACKET, Stop	1
23	41838-32	9627896	SCREW, Cap, 5/8-11 x 1-3/4	1
24	41840-7	85700693	NUT, Lock, 5/8-11	1
25	48117	SML48117	SPACER	2
26	48118-1	SML481181	SPACER, Bushing	2
27	42672-41	120092	SCREW, Cap, 16mm-2.0mm x 70mm	6
28	41836-9	9849647	NUT, Hex, 7/8-9	2

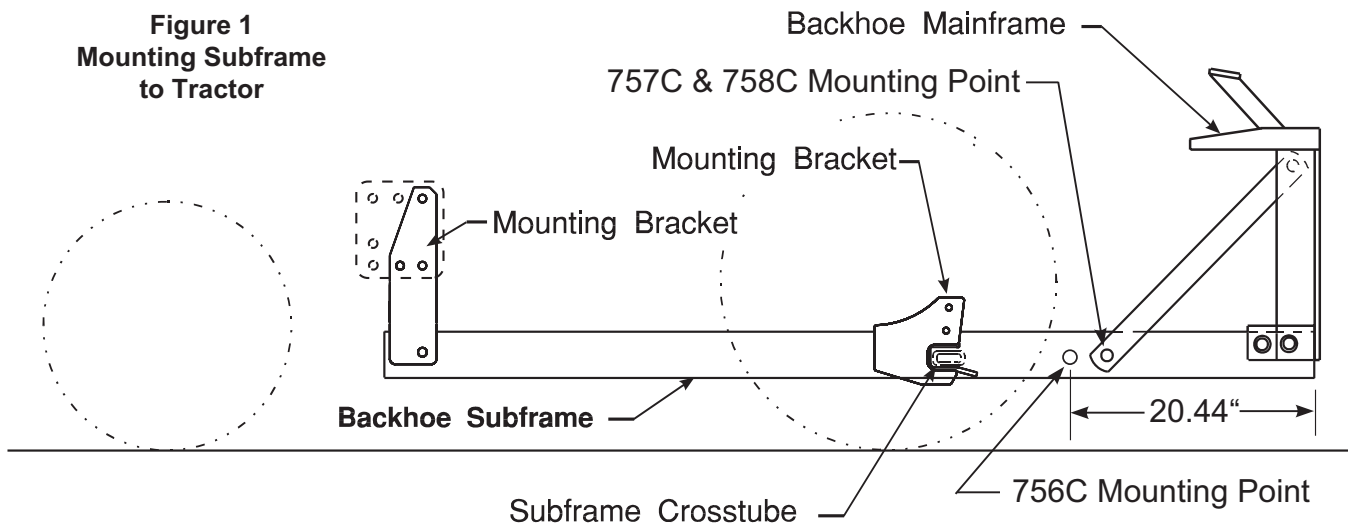
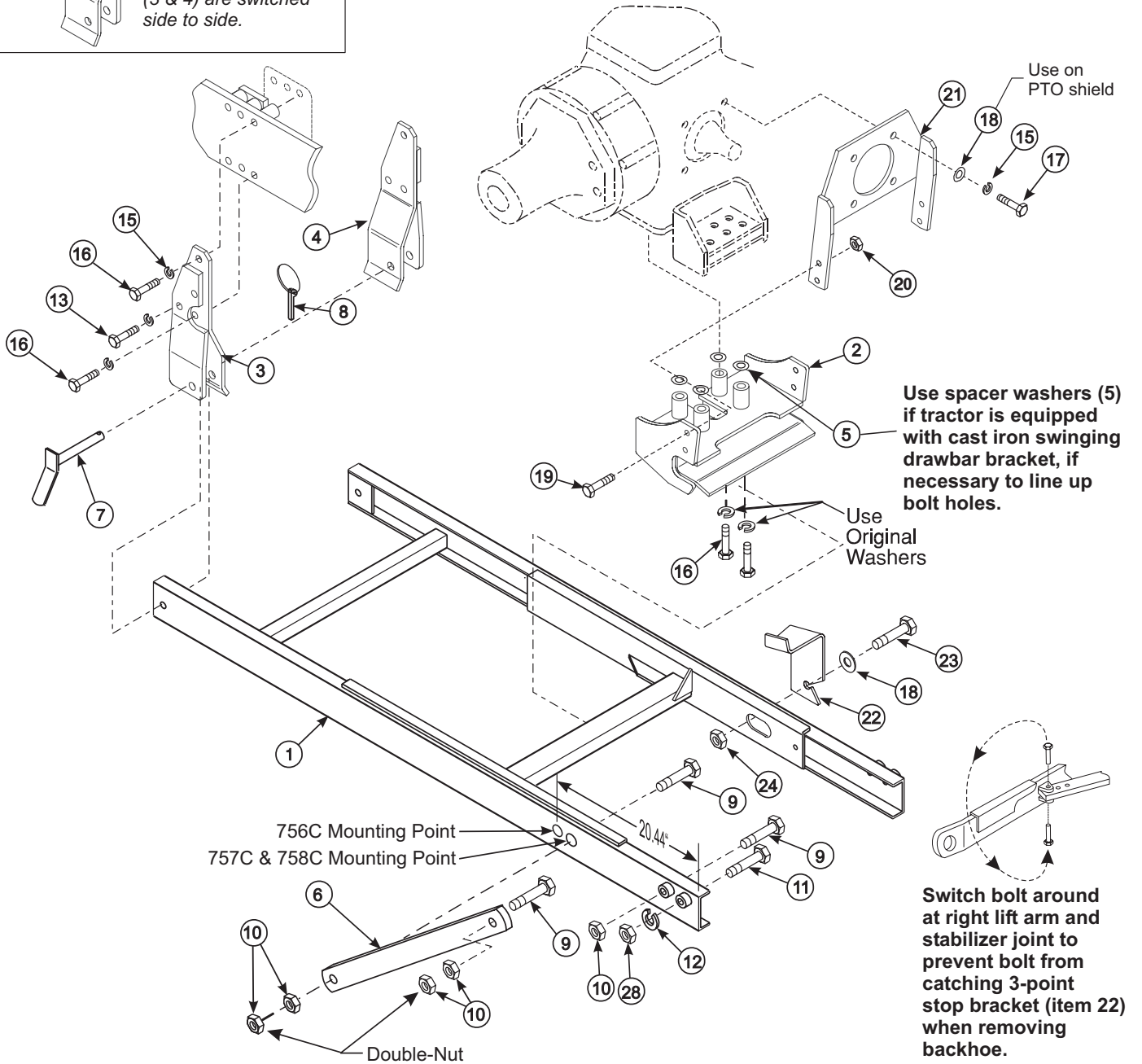
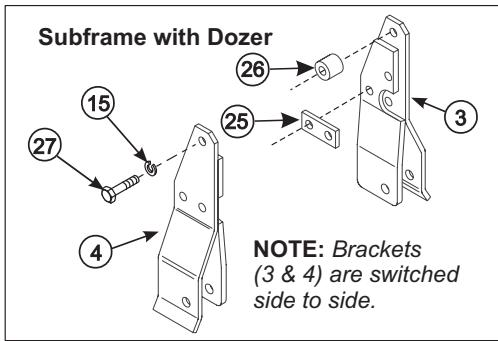

Figure 2
Subframe Assembly
with Loader



INSTALLATION INSTRUCTIONS