

Keep with Operators Manual

## TWO FUNCTION PLUMBING KIT FOR MID MOUNT VALVE

NEW HOLLAND 7312 & 7314 LOADERS  
NEW HOLLAND TM SERIES TRACTORS

MODEL	FWD	FWD with <i>Terra-Glide</i> ™	2 WD
TM115	X	X	X
TM125	X	X	X
TM135	X	X	X
TM150	X	X	X
TM165	X	X	X

Plumbing kit can be installed using tools ordinarily available.  
Shut off engine and engage brakes during installation.

### INSTALLING TWO-WAY COUPLERS (Figure 3)

1. Install two-way couplers (9) to four inside holes of hose bracket (2) using retaining rings (3) and bushings (8).  
**NOTE:** *Rear retaining ring must be installed in second slot from back of coupler (third slot from rear for older style couplers). Be sure bushings (8) are behind hose mounting bracket.*

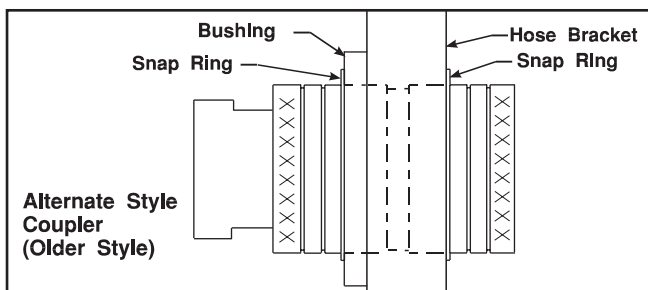
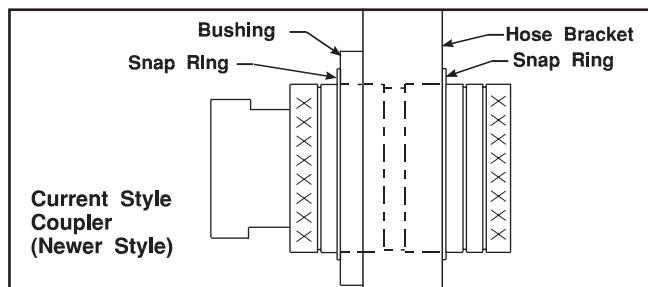

### INSTALLING HOSE BRACKET (Figure 3)

Install hose bracket (2) to right midmounting bracket using 1/2 x 1-1/2 cap screws (11) and 1/2 lock nuts (12).

### PLUMBING TWO FUNCTION KIT TO MID MOUNT VALVE

1. Remove rearmost plug on bottom side of valve section one and install 90° elbow (1) (See figure 3). **NOTE:** *Copper washer furnished with 90° fitting (1), must be installed over o-ring to seal properly.*
2. Install 1/2 x 31 hose (14) to coupler in position 1 and attach opposite end to 90° elbow (1) as illustrated in figure 3.
3. Install 1/2 x 27 hose (15) to coupler in position 2 and attach opposite end to fitting at front of valve section one as illustrated in figure 3.
4. Install 1/2 x 31 hose (17) to coupler in position 3. Remove rearmost plug on bottom side of valve section 2 and attach banjo end of 1/2 x 31 hose (17) using flow bolt (18), spacer washer (19) and dowty washers (20).  
**IMPORTANT:** *Banjo fitting must be installed as illustrated in figure 3.*
5. Install 1/2 x 27 hose (15) to coupler in position 4 and attach opposite end to fitting at front of valve section two as illustrated in figure 3.
6. Install spiral bands (4, 5, 6 & 7) on hoses installed above in the following order. Green position 1, yellow position 2, red position 3 and blue position 4 (See figure 3).

**NOTE:** *It is important to make sure color coding is installed correctly.*



**WARNING:** *Escaping fluid under pressure can penetrate skin causing serious personal injury.*

- *Do not use your hands to check for leaks. Use a piece of cardboard or paper. Always wear eye protection when searching for leaks.*
- *Stop engine and relieve pressure before connecting and disconnecting lines.*
- *Tighten all connections before starting engine or pressurizing lines.*

*If any fluid is injected into skin, obtain medical attention immediately or gangrene may result.*

**PLUMBING LOADER TO TWO-WAY COUPLERS**  
(Figures 1, 2 & 3)

**7314 ONLY - (Figure 1)**

1. Install 1/2 x 72 hoses (16) to lift cylinder base (LCB) oil line, swivel tee fittings on lift cylinder rod (LCR) & bucket cylinder rod (BCR) oil lines and adapter fitting on relief valve.

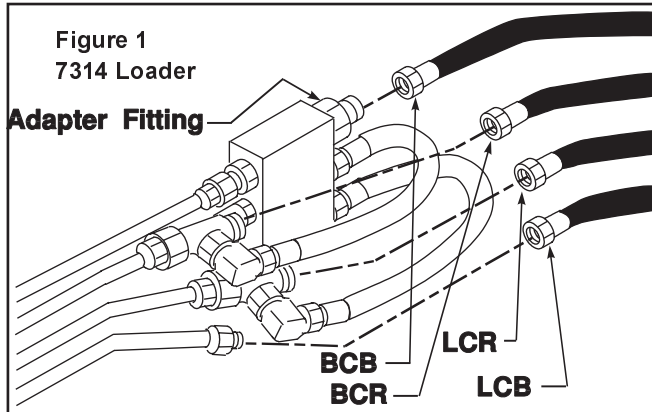

**7312 ONLY - With Self Leveling Option 9807499 Bundle 2-5454 (Figure 2)**

Install 1/2 x 72 hoses (16) to top port on self leveling valve, lift cylinder rod (LCR) oil line, and tee fittings on bucket cylinder rod (BCR) and bucket cylinder base (BCB) oil lines.

**7312 ONLY - Without Self Leveling Valve Option (Figure 3)**

Install 1/2 x 72 hoses (16) to lift cylinder base oil line (LCB), lift cylinder rod oil line (LCR), bucket cylinder rod oil line (BCR), and bucket cylinder base oil line (BCB)(Figure 3).

2. Install male couplers (10) to free ends of 1/2 x 72 hoses.
3. Connect 1/2 x 72 hoses (16) to two-way quick couplers.

**NOTE:** Be sure top two oil lines are connected to remote valve that controls bucket operation and bottom two oil lines are connected to remote valve that controls lift cylinder operation.

4. Install colored bands (4-7) to ends of 72 inch hoses (16) at male coupler, colors should be as shown in figure 3.
5. Wrap rubber strap (13) around 1/2 x 72 hoses (16) approximately 12 inches in front of quick couplers (10) and hook ends to handle on tractor hood.
6. After all plumbing has been completed and all parts are secure, start engine and slowly cycle lift and bucket cylinders several times to purge air out of system, then retract cylinders and shut off tractor engine. Add additional tractor hydraulic fluid as specified in tractor owners manual to bring level of hydraulic fluid up to full.

**NOTE:** If operation of loader is reversed from desired joy-stick operation reverse connections at remote valve.

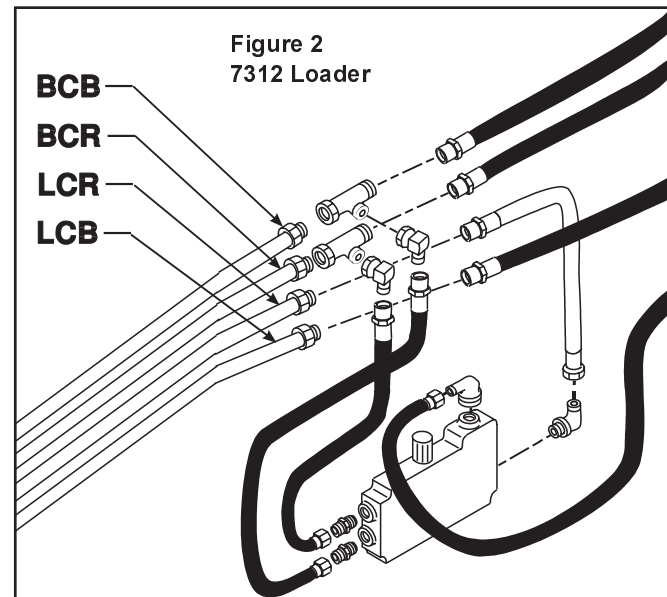

**PARTS LIST - TWO FUNCTION PLUMBING KIT FOR MID MOUNT VALVE (Figure 3)**

ITEM	SMC NO.	NH NO.	DESCRIPTION	QTY.
1	48324	86511408	FITTING, Elbow, 90°	1
2	44167	SML44167	BRACKET, Hose	1
3	6040-16	86018680	RETAINING RING, 1-1/2	8
4	36240-1	86581682	SPIRAL BAND, 3/4", Blue	2
5	36240-2	86581683	SPIRAL BAND, 3/4", Red	2
6	36240-3	86581684	SPIRAL BAND, 3/4", Yellow	2
7	36240-4	86581685	SPIRAL BAND, 3/4", Green	2
8	6120-44	86582532	BUSHING, 1-1/2 x 2-1/4	4
9	47110-1	86582375	COUPLER, Female	4
10	6137-10	86581680	COUPLER, Male	4
11	G180177	87689	SCREW, Cap, 1/2-13 x 1-1/2	2
12	G9414074	9636698	NUT, Lock, 1/2-13	2
13	7438-1	86581718	TARP STRAP	1
14	48323-1	86583550	HOSE, 1/2 x 31	1
15	48323-4	SML483234	HOSE, 1/2 x 27	2
16	48550-1	SML485501	HOSE, 1/2 x 72	4
17	48329-3	SML483293	HOSE, 1/2 x 31	1
18	48330	86583640	FLOW BOLT	1
19	48331-1	82020496	SPACER WASHER	1
20	48272-1	5167640	DOWTY WASHER	3

**Figure 3**  
**Two Function**  
**Plumbing Kit**  
**To Mid Mount Valve**

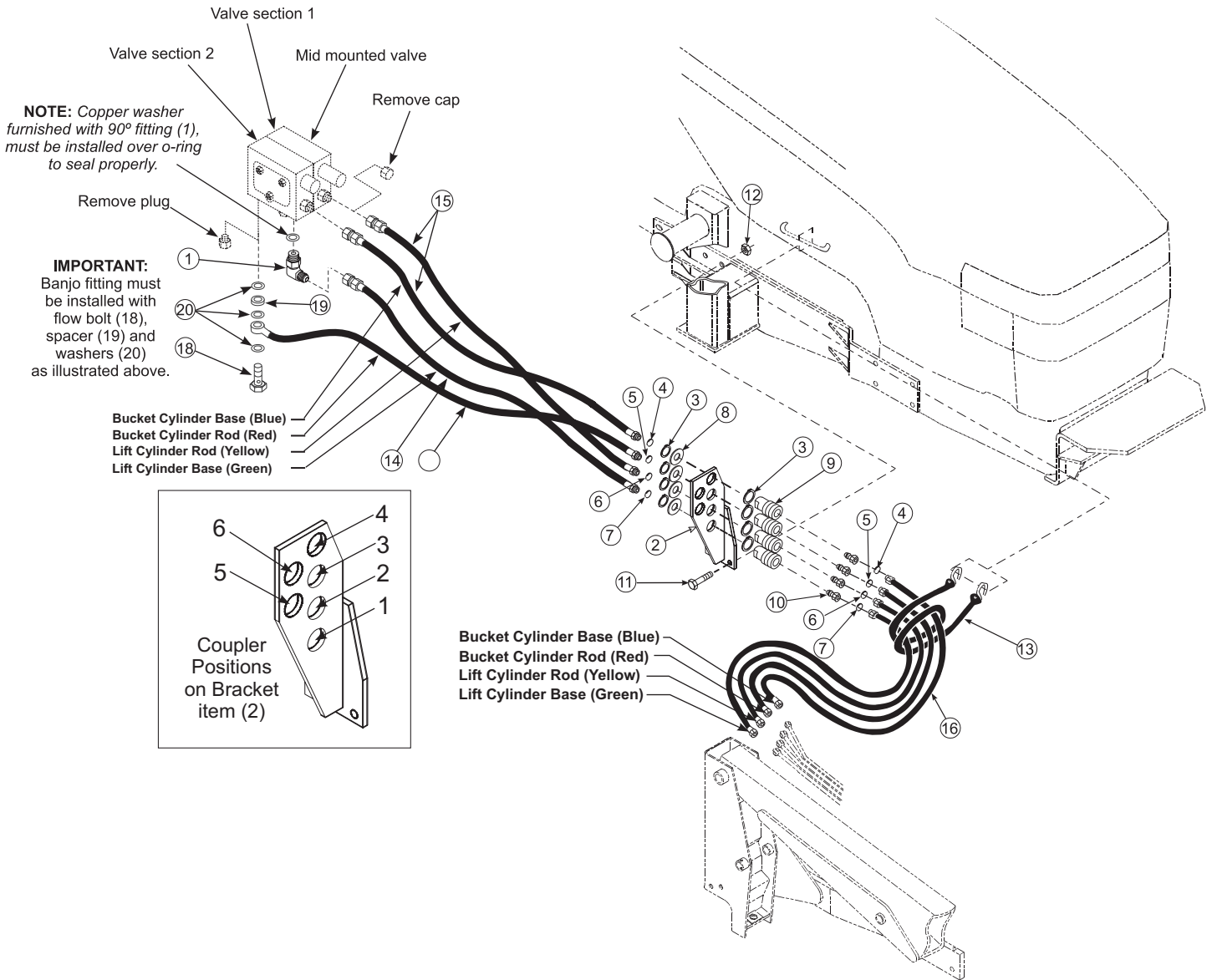

2-6773  
2-7020

715842016  
715842036

# **INSTALLATION INSTRUCTIONS**