

Keep With Operator's Manual

ALAMO SMC INSTALLATION MANUAL 4211 & 4211SS LOADER PLUMBING KIT MASSEY FERGUSON & JOHN DEERE TRACTORS WITH REAR REMOTE VALVE

Plumbing kit can be installed using tools ordinarily available.

Shut off engine and engage brakes during installation.

IMPORTANT: Check for proper tractor valve operation before plumbing loader to tractor. See tractor owner's manual for instructions.

NOTE: Apply sealant only to all tapered threads unless coupled with swivel adapters. When using teflon tape, wrap tape clockwise (as viewed from end) and wrap only twice. Keep sealant away from first two threads of tapered end to prevent contamination of hydraulic fluid. Do not use sealant on o-ring or flare adapter threads.

PLUMBING LOADER TO REAR REMOTE VALVE (Figure 1)

1. Temporarily install color coded spiral bands to same loader hose ends with colored dust caps installed from factory. It is important to make sure color coding corresponds between dust caps and spiral bands on each hose.
2. Connect female end of 3/8 x 154" hoses (1) to loader. It is important to make sure color coding corresponds between dust cap and spiral band on each hose.
3. Remove color coded spiral bands from hoses and attach to tractor rear remote couplers in sequence shown in Figure 1.



WARNING: For proper loader function, operate loader only from approved valves. When plugging couplers into tractor remote couplers, be sure to connect the hoses from the upper two boom oil lines to the tractor remote couplers controlled by the valve which is to control bucket rotation. The hoses from the lower two boom oil lines should be connected to the tractor remote couplers controlled by the valve which is to raise or lower the boom. This will insure proper function of loader.

4. Using 1/2" x 20" adjustable straps (2) and tarp strap (3), bundle hoses together. Secure hoses to tractor approximately equal distance along the length of the hoses to avoid interference with moving parts.
5. After all plumbing has been completed slowly cycle lift and bucket cylinders several times to purge air from hydraulic system. Retract cylinders and shut off engine. Replenish tractor hydraulic system.

NOTE: When cycling the loader, operate the lever(s) according to the functioning desired. If direction of a control lever is wrong, exchange the quick couplers at the remote couplers controlled by that valve lever.



WARNING: Escaping hydraulic fluid under pressure can penetrate skin causing serious injury.

- DO NOT use your hands to check for leaks. Use a piece of cardboard or paper to search for leaks.
- Stop engine and relieve pressure before connecting or disconnecting lines.
- Tighten all connections before starting engine or pressurizing lines.

If any fluid is injected into skin, obtain medical attention immediately or gangrene may result.

**Figure 1
Plumbing Kit**

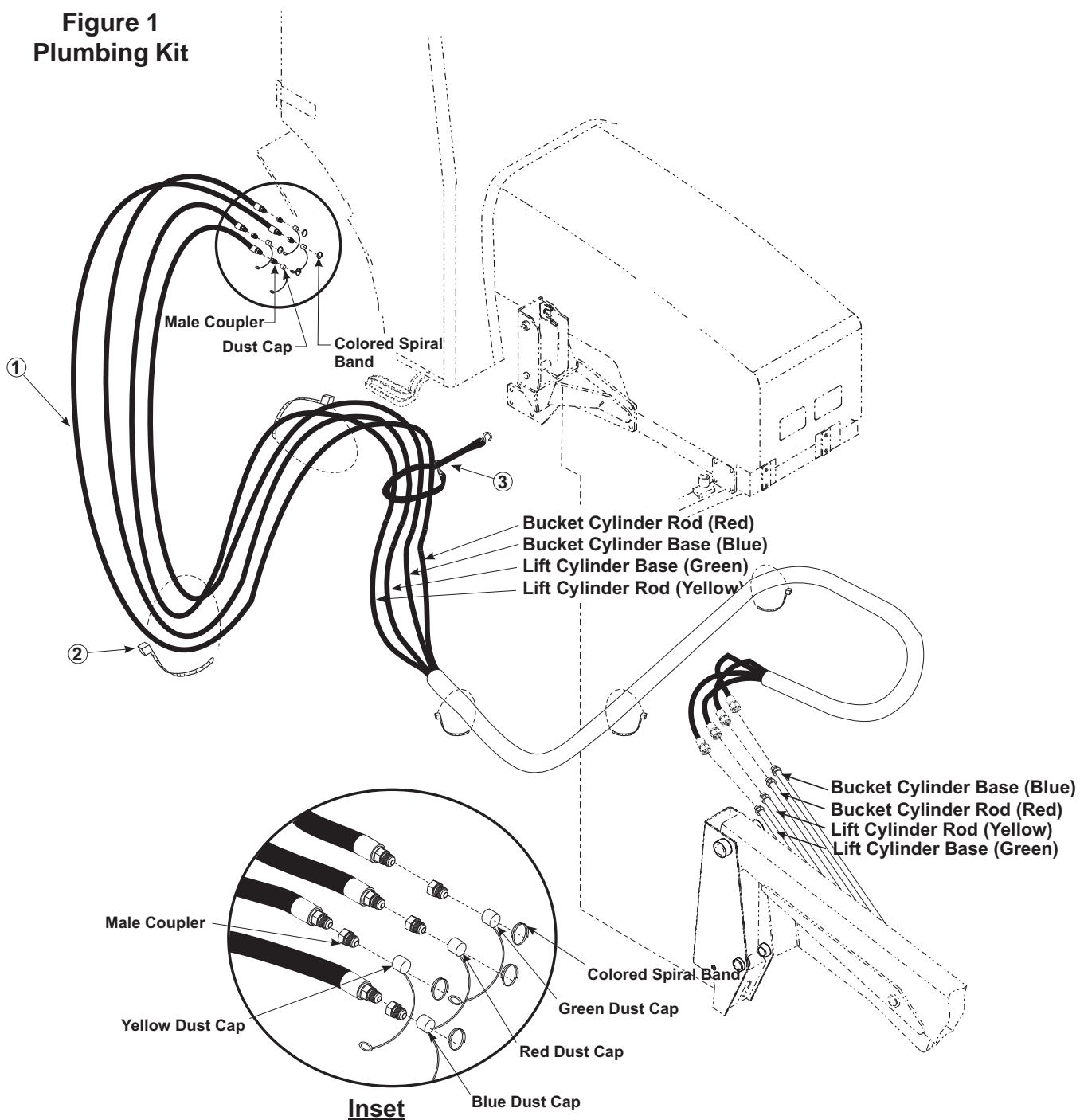





PARTS LIST - Coupler & Bucket

ITEM	PART NO.	DESCRIPTION	QTY.
1	46487-6	HOSE, 3/8" x 154"	4
2	8137-3	STRAP, Adjustable, 1/2" x 20"	3
3	7438-1	TARP STRAP	1

GENERAL TORQUE SPECIFICATIONS

USE THE FOLLOWING TORQUES WHEN SPECIAL TORQUES ARE NOT GIVEN

Standard American and Metric Cap Screws

AMERICAN STANDARD CAP SCREWS									METRIC CAP SCREWS								
SAE Grade	5				8				Metric Class	8.8				10.9			
Typ. Head Markings									Typ. Head Markings								
Cap Screw	TORQUE				TORQUE				Cap Screw	TORQUE				TORQUE			
Size	FT·LBS		N·m		FT·LBS		N·m		Size	FT·LBS		N·m		FT·LBS		N·m	
Inches	MIN	MAX	MIN	MAX	MIN	MAX	MIN	MAX	Millimeters	MIN	MAX	MIN	MAX	MIN	MAX	MIN	MAX
1/4 - 20	6.25	7.25	8.5	10	8.25	9.5	11	13	M6 x 1.00	6	8	8	11	9	11	12	15
1/4 - 28	8	9	11	12	10.5	12	14	16	M8 x 1.25	16	20	21.5	27	23	27	31	36.5
5/16 - 18	14	15	19	20	18.5	20	25	27	M10 x 1.50	29	35	39	47	42	52	57	70
5/16 - 24	17.5	19	23	26	23	25	31	34	M12 x 1.75	52	62	70	84	75	91	102	123
3/8 - 16	26	28	35	38	35	37	47.5	50	M14 x 2.00	85	103	115	139	120	146	163	198
3/8 - 24	31	34	42	46	41	45	55.5	61	M16 x 2.50	130	158	176	214	176	216	238	293
7/16 - 14	41	45	55.5	61	55	60	74.5	81	M18 x 2.50	172	210	233	284	240	294	325	398
7/16 - 20	51	55	69	74.5	68	75	92	102	M20 x 2.50	247	301	335	408	343	426	465	577
1/2 - 13	65	72	88	97.5	86	96	116	130	M22 x 2.50	332	404	450	547	472	576	639	780
1/2 - 20	76	84	103	114	102	112	138	152	M24 x 3.00	423	517	573	700	599	732	812	992
9/16 - 12	95	105	129	142	127	140	172	190	M27 x 3.00	637	779	863	1055	898	1098	1217	1488
9/16 - 18	111	123	150	167	148	164	200	222	M30 x 3.00	872	1066	1181	1444	1224	1496	1658	2027
5/8 - 11	126	139	171	188	168	185	228	251	<p>NOTE: These values apply to fasteners as received from supplier, dry or when lubricated with normal engine oil. They do not apply if special graphite or molysulphide greases or other extreme lubricants are used.</p>								
5/8 - 18	152	168	206	228	203	224	275	304									
3/4 - 10	238	262	322	355	318	350	431	474									
3/4 - 16	274	305	371	409	365	402	495	544									
7/8 - 9	350	386	474	523	466	515	631	698									
7/8 - 14	407	448	551	607	543	597	736	809									
1 - 8	537	592	728	802	716	790	970	1070									
1 - 14	670	740	908	1003	894	987	1211	1337									

INSTALLATION INSTRUCTIONS