

| |
|----------------------------|
| Keep With Operators Manual |
|----------------------------|

LOADER MOUNTING KIT 2406 LOADER AGCO ST25 TRACTORS

INSTALLING MOUNTING KIT (Figure 1)

Mounting kit can be installed using tools ordinarily available.

NOTE: Leave *all hardware loose until mounting kit is completely installed to facilitate alignment of parts.*

1. Remove weight bracket from front of tractor.
2. Install front mounting bracket (1) onto tractor using 12MM-1.75 x 30MM cap screws (3) and 1/2 lock washers (4).
3. If tractor is equipped with mower, detach mower deck linkage from mounting at middle of tractor. Remove mower deck mountings from left and right side of tractor. Install mid mounting bracket (2) into position and fasten using twelve 12MM-1.75 x 30MM cap screws (3) and 1/2 lock washers (4). Re-attach mower deck linkage to mounting ear provided on loader mid mounting bracket (2).
4. Torque all hardware to torque specifications listed in loader operator's manual.

2-6901

INSTALLING LOADER TO MOUNTING BRACKETS

1. Attach nylon slings around the loader front bumper and use an overhead hoist to support loader while removing pallet attachment brackets from loader: remove 3/8 lock nuts and shoulder bolts which secure flat brackets to loader and remove 3/4 lock nuts and carriage bolts which secure angle brackets to loader, then remove pallet. Reinstall hardware to loader to secure pins and hinges.
2. Remove 5/8 x 2-1/4 cap screws, washers and lock nuts so hinges can be opened. Lower loader to a horizontal position and attach nylon slings around the loader lift boom arms. Use the overhead hoist to raise the loader and position the side frame channels over the front mounting brackets. Slide the loader to the rear until side frames are on the tubes of mid mounting brackets.

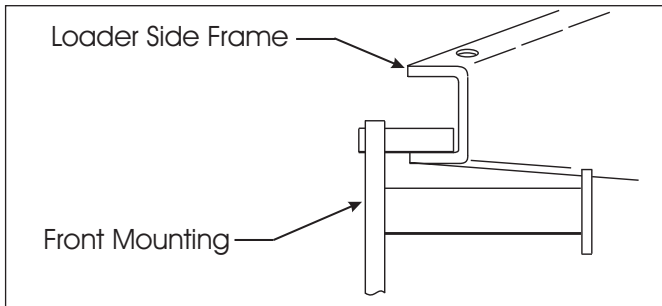

CAUTION: *If mower deck is mounted to tractor, lower mower deck before lowering side frame uprights onto the mid mounting brackets. Failure to do so may result in damage to the mower deck.*

NOTE: *Lower lip of side frame channel must be between front mounting tubes.*

3. Clamp hinges around tubes of mid mounting bracket with 5/8 x 2-1/4 cap screws, flat washers and hex nuts (supplied with loader).
4. Refer to loader owner's manual and plumbing kit instructions to complete loader installation

PARTS LIST - MOUNTING KIT

| ITEM | Part No. | DESCRIPTION | QTY. |
|------|----------|---|------|
| 1 | 50284 | BRACKET, Front Mounting | 1 |
| 2 | 50295 | BRACKET, Mid Mounting | 1 |
| 3 | 42672-19 | SCREW, Cap, 12MM-1.75 x 30MM YDP | 18 |
| 4 | 41837-5 | WASHER, Lock, 1/2 YDP | 18 |
| 5 | 48117 | SPACER (Only needed without mower deck) | 2 |

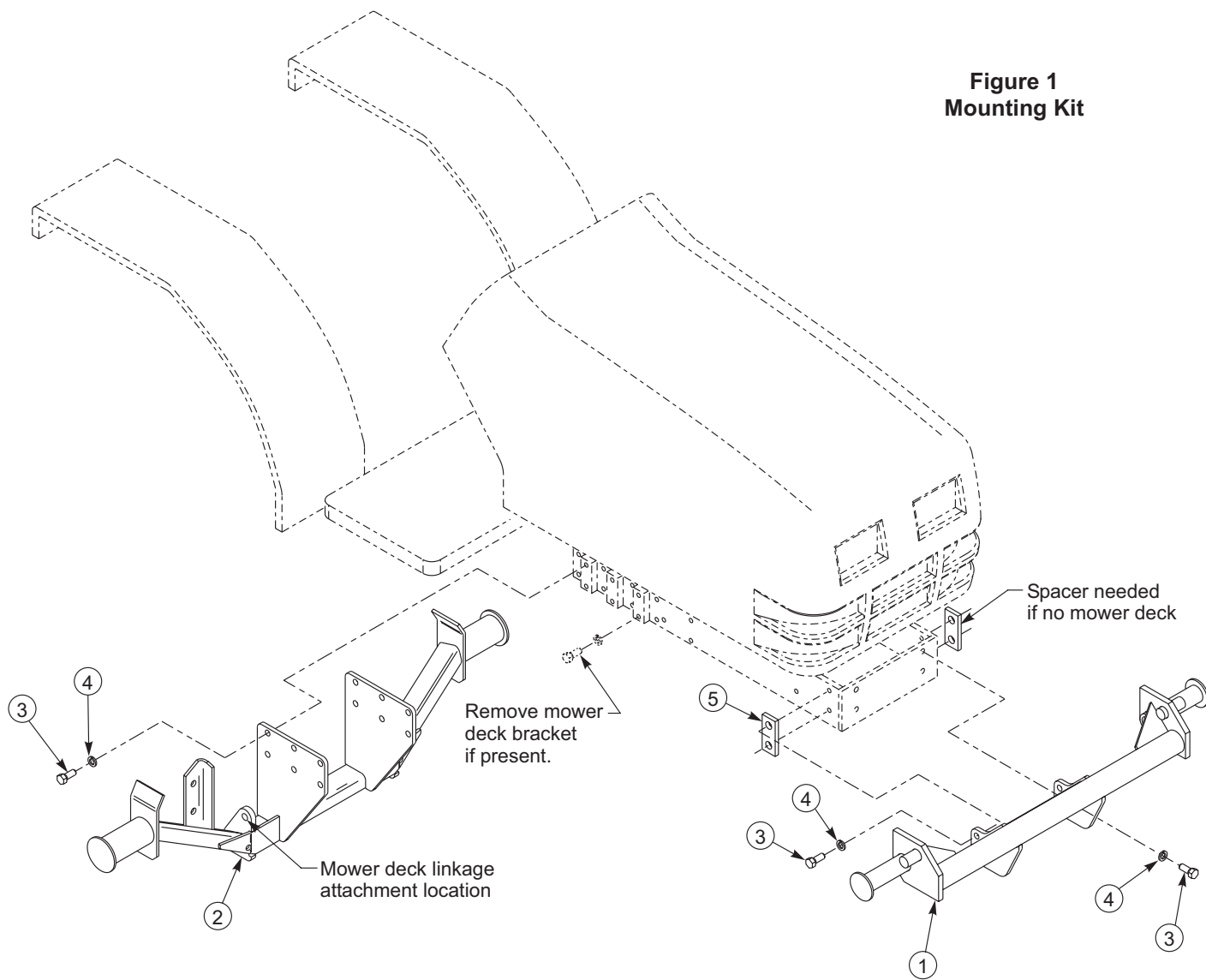

Figure 1
Mounting Kit



GENERAL TORQUE SPECIFICATIONS

USE THE FOLLOWING TORQUES WHEN SPECIAL TORQUES ARE NOT GIVEN

Standard American and Metric Cap Screws

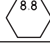
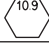
| AMERICAN STANDARD CAP SCREWS | | | | | | | | | METRIC CAP SCREWS | | | | | | | | |
|------------------------------|---|------|------|------|---|-----|------|------|--|---|------|------|------|---|------|------|------|
| SAE Grade | 5 | | | | 8 | | | | Metric Class | 8.8 | | | | 10.9 | | | |
| Typ. Head Markings |  | | | |  | | | | Typ. Head Markings |  | | | |  | | | |
| Cap Screw | TORQUE | | | | TORQUE | | | | Cap Screw | TORQUE | | | | TORQUE | | | |
| Size | FT-LBS | | N·m | | FT-LBS | | N·m | | Size | FT-LBS | | N·m | | FT-LBS | | N·m | |
| Inches | MIN | MAX | MIN | MAX | MIN | MAX | MIN | MAX | Millimeters | MIN | MAX | MIN | MAX | MIN | MAX | MIN | MAX |
| 1/4 - 20 | 6.25 | 7.25 | 8.5 | 10 | 8.25 | 9.5 | 11 | 13 | M6 x 1.00 | 6 | 8 | 8 | 11 | 9 | 11 | 12 | 15 |
| 1/4 - 28 | 8 | 9 | 11 | 12 | 10.5 | 12 | 14 | 16 | M8 x 1.25 | 16 | 20 | 21.5 | 27 | 23 | 27 | 31 | 36.5 |
| 5/16 - 18 | 14 | 15 | 19 | 20 | 18.5 | 20 | 25 | 27 | M10 x 1.50 | 29 | 35 | 39 | 47 | 42 | 52 | 57 | 70 |
| 5/16 - 24 | 17.5 | 19 | 23 | 26 | 23 | 25 | 31 | 34 | M12 x 1.75 | 52 | 62 | 70 | 84 | 75 | 91 | 102 | 123 |
| 3/8 - 16 | 26 | 28 | 35 | 38 | 35 | 37 | 47.5 | 50 | M14 x 2.00 | 85 | 103 | 115 | 139 | 120 | 146 | 163 | 198 |
| 3/8 - 24 | 31 | 34 | 42 | 46 | 41 | 45 | 55.5 | 61 | M16 x 2.50 | 130 | 158 | 176 | 214 | 176 | 216 | 238 | 293 |
| 7/16 - 14 | 41 | 45 | 55.5 | 61 | 55 | 60 | 74.5 | 81 | M18 x 2.50 | 172 | 210 | 233 | 284 | 240 | 294 | 325 | 398 |
| 7/16 - 20 | 51 | 55 | 69 | 74.5 | 68 | 75 | 92 | 102 | M20 x 2.50 | 247 | 301 | 335 | 408 | 343 | 426 | 465 | 577 |
| 1/2 - 13 | 65 | 72 | 88 | 97.5 | 86 | 96 | 116 | 130 | M22 x 2.50 | 332 | 404 | 450 | 547 | 472 | 576 | 639 | 780 |
| 1/2 - 20 | 76 | 84 | 103 | 114 | 102 | 112 | 138 | 152 | M24 x 3.00 | 423 | 517 | 573 | 700 | 599 | 732 | 812 | 992 |
| 9/16 - 12 | 95 | 105 | 129 | 142 | 127 | 140 | 172 | 190 | M27 x 3.00 | 637 | 779 | 863 | 1055 | 898 | 1098 | 1217 | 1488 |
| 9/16 - 18 | 111 | 123 | 150 | 167 | 148 | 164 | 200 | 222 | M30 x 3.00 | 872 | 1066 | 1181 | 1444 | 1224 | 1496 | 1658 | 2027 |
| 5/8 - 11 | 126 | 139 | 171 | 188 | 168 | 185 | 228 | 251 | <p>NOTE: These values apply to fasteners as received from supplier, dry or when lubricated with normal engine oil. They do not apply if special graphite or moly sulphide greases or other extreme lubricants are used.</p> | | | | | | | | |
| 5/8 - 18 | 152 | 168 | 206 | 228 | 203 | 224 | 275 | 304 | | | | | | | | | |
| 3/4 - 10 | 238 | 262 | 322 | 355 | 318 | 350 | 431 | 474 | | | | | | | | | |
| 3/4 - 16 | 274 | 305 | 371 | 409 | 365 | 402 | 495 | 544 | | | | | | | | | |
| 7/8 - 9 | 350 | 386 | 474 | 523 | 466 | 515 | 631 | 698 | | | | | | | | | |
| 7/8 - 14 | 407 | 448 | 551 | 607 | 543 | 597 | 736 | 809 | | | | | | | | | |
| 1 - 8 | 537 | 592 | 728 | 802 | 716 | 790 | 970 | 1070 | | | | | | | | | |
| 1 - 14 | 670 | 740 | 908 | 1003 | 894 | 987 | 1211 | 1337 | | | | | | | | | |

INSTALLATION INSTRUCTIONS