

**PIN ON MATERIAL BUCKETS**

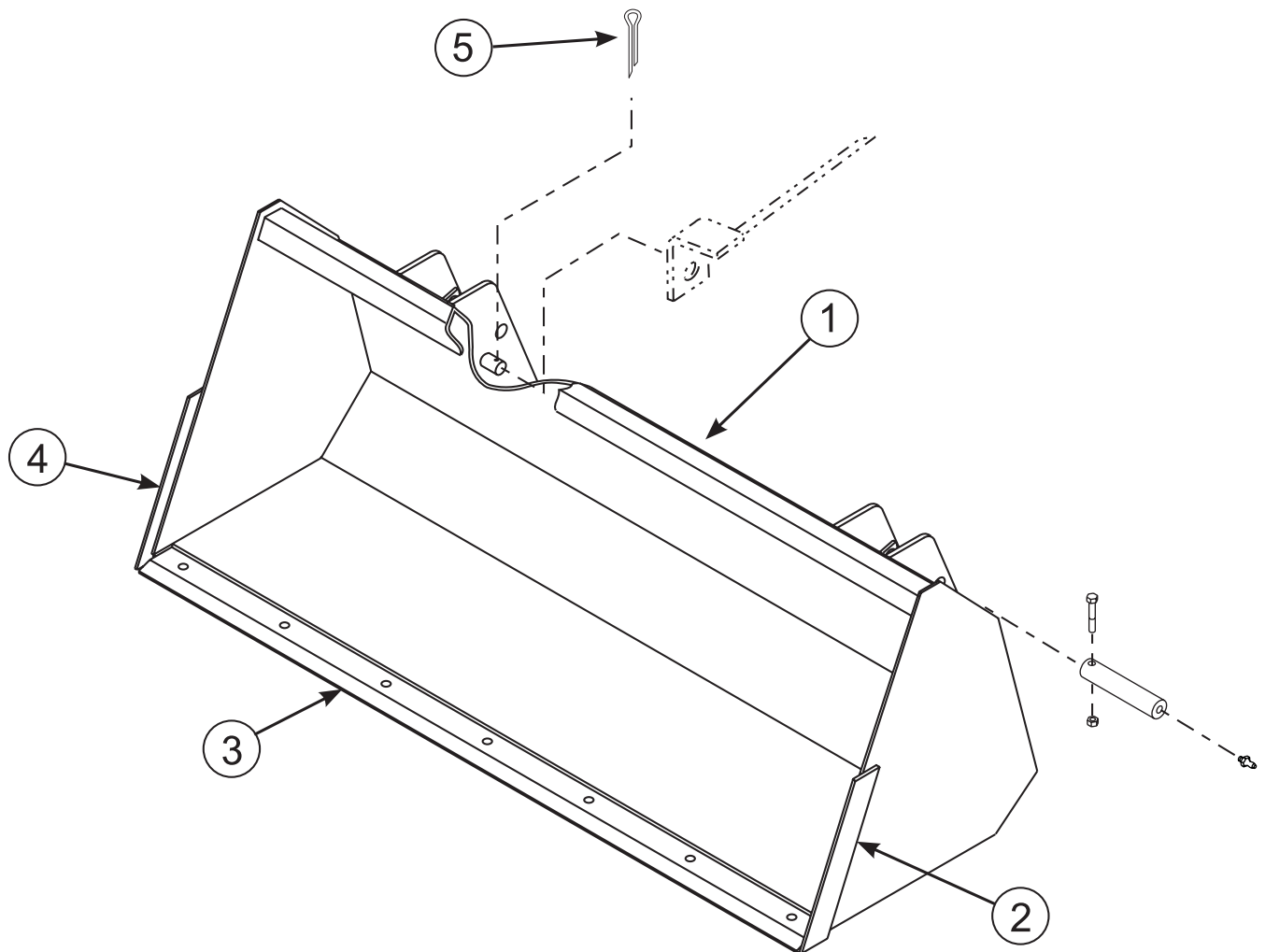

**PARTS LIST - MOUNTING KIT**

Item	Part No.	Description	Qty.
1	*	BUCKET, 72" Standard Pin On (Includes cutting edges)	1
	*	BUCKET, 72" Heavy Duty Pin On (Includes cutting edges)	1
	*	BUCKET, 84" Heavy Duty Pin On (Includes cutting edges)	1
	*	BUCKET, 84" Snow & Light Material (Includes cutting edges)	1
2	MT328171	CUTTING EDGE, Left Side (72" Standard & 84" Snow & Light Material)	1
3	MT225425	CUTTING EDGE, Bottom (72" Standard, no holes)	1
	MT467341	CUTTING EDGE, Bottom (72" Heavy Duty, with holes)	1
	MT467342	CUTTING EDGE, Bottom (84" Heavy Duty, with holes)	1
	MT225428	CUTTING EDGE, Bottom (84" Snow & Light Material, no holes)	1
4	MT280862	CUTTING EDGE, Right Side (72" H.D., 84" H.D.)	1
	MT328172	CUTTING EDGE, Right Side (72" Standard & 84" Snow & Light Material)	1
5	MT419039	COTTER PIN, 3/16 x 2.00	1

\* Not sold as repair part.

2-6931-88  
 2-6932-88  
 2-6933-88  
 2-6935-88

**ATTACHING PIN ON MATERIAL BUCKETS**  
 (Figure 1)

Material buckets can be installed using tools ordinarily available.

Attach bucket to lift boom frame and bucket cylinders with four pins, 3/8 cap screws and 3/8 lock nuts (supplied with loader).

Attach bucket leveling rod (supplied with loader) through slot in bucket leveling bracket attached to tilt cylinder and inner ear on right side of bucket with 3/16 x 2 cotter pin (5) as shown in figure 1.



**WARNING:** Always use a drift and hammer made of non-sparking material (a shot filled mallet is recommended) to install or remove pins. A steel hammer or drift could generate flying metal fragments and result in injury. Always wear safety glasses when using a hammer to remove or install pins.

BUCKET MODEL	BUCKET WIDTH		STRUCK CAPACITY	
	Inches	Centimeters	Cubic Yards	Cubic Meters
72" Standard	72	183	0.58	0.45
72" H.D.	72	183	0.55	0.42
84" H.D.	84	213	0.68	0.48
84" Snow & Light Material	84	213	0.92	1.18

**GENERAL TORQUE SPECIFICATIONS**

USE THE FOLLOWING TORQUES WHEN SPECIAL TORQUES ARE NOT GIVEN

**Standard American and Metric Cap Screws**

AMERICAN STANDARD CAP SCREWS										METRIC CAP SCREWS							
SAE Grade	5				8				Metric Class	8.8				10.9			
Typ. Head Markings									Typ. Head Markings								
Cap Screw	TORQUE				TORQUE				Cap Screw	TORQUE				TORQUE			
Size	FT-LBS		N-m		FT-LBS		N-m		Size	FT-LBS		N-m		FT-LBS		N-m	
Inches	MIN	MAX	MIN	MAX	MIN	MAX	MIN	MAX	Millimeters	MIN	MAX	MIN	MAX	MIN	MAX	MIN	MAX
1/4 - 20	6.25	7.25	8.5	10	8.25	9.5	11	13	M6 x 1.00	6	8	8	11	9	11	12	15
1/4 - 28	8	9	11	12	10.5	12	14	16	M8 x 1.25	16	20	21.5	27	23	27	31	36.5
5/16 - 18	14	15	19	20	18.5	20	25	27	M10 x 1.50	29	35	39	47	42	52	57	70
5/16 - 24	17.5	19	23	26	23	25	31	34	M12 x 1.75	52	62	70	84	75	91	102	123
3/8 - 16	26	28	35	38	35	37	47.5	50	M14 x 2.00	85	103	115	139	120	146	163	198
3/8 - 24	31	34	42	46	41	45	55.5	61	M16 x 2.50	130	158	176	214	176	216	238	293
7/16 - 14	41	45	55.5	61	55	60	74.5	81	M18 x 2.50	172	210	233	284	240	294	325	398
7/16 - 20	51	55	69	74.5	68	75	92	102	M20 x 2.50	247	301	335	408	343	426	465	577
1/2 - 13	65	72	88	97.5	86	96	116	130	M22 x 2.50	332	404	450	547	472	576	639	780
1/2 - 20	76	84	103	114	102	112	138	152	M24 x 3.00	423	517	573	700	599	732	812	992
9/16 - 12	95	105	129	142	127	140	172	190	M27 x 3.00	637	779	863	1055	898	1098	1217	1488
9/16 - 18	111	123	150	167	148	164	200	222	M30 x 3.00	872	1066	1181	1444	1224	1496	1658	2027
5/8 - 11	126	139	171	188	168	185	228	251									
5/8 - 18	152	168	206	228	203	224	275	304									
3/4 - 10	238	262	322	355	318	350	431	474									
3/4 - 16	274	305	371	409	365	402	495	544									
7/8 - 9	350	386	474	523	466	515	631	698									
7/8 - 14	407	448	551	607	543	597	736	809									
1 - 8	537	592	728	802	716	790	970	1070									
1 - 14	670	740	908	1003	894	987	1211	1337									

**NOTE:** These values apply to fasteners as received from supplier, dry or when lubricated with normal engine oil. They do not apply if special graphite or moly sulphide greases or other extreme lubricants are used.

# INSTALLATION INSTRUCTIONS