

Keep with Operators Manual

PLUMBING KIT FOR NEW HOLLAND 52LA OR 5211 LOADER

NEW HOLLAND TL & 35 SERIES TRACTORS WITH REAR REMOTE VALVE

MODEL	2WD	4WD	LESS CAB	WITH CAB
TL70 & TL80	X	X	X	X
TL90 & TL100	X	X	X	X
4835 & 5635	X	X	X	X
6635 & 7635	X	X	X	X



WARNING: All tractors equipped with remote valve detents must have two remote valve detent removal kits NH 710408014 installed (one kit in each spool) prior to operation of loader.

Plumbing kit can be installed using tools ordinarily available.

Shut off engine and engage brakes during installation.

PLUMBING LOADER TO REAR REMOTE VALVE (Figure 1, 2 & 3)

1. Remove and discard two rear 16mm cap screws from right cab/platform support bracket.
2. Install coupler bracket (1) to two rear holes of cab/platform support bracket with 16mm-1.50 x 45mm (5) in top hole and 16mm-1.50 x 70mm (6) in bottom hole. Tighten and torque hardware to 177 ft. lbs.
3. Install colored dust plugs (10-13) and female couplers (9) to coupler bracket (1). Connect couplers (9) to coupler bracket (1) using 1-1/2 retaining rings (2) (see figure 3 for correct color plug placement).
4. Install spiral bands (26-29) to female couplers on tractor remote as indicated in figure 3.
5. Install male couplers (3) to tractor remote end of 94" hoses (8). Attach the opposite end of hose (8) to female coupler (9). Install corresponding color coded dust caps (14-17) to male couplers. Route 3/8 x 94" hoses (8) from coupler bracket (1) to rear tractor remote valve and connect to corresponding color female couplers.
6. Using 1/2 x 20 adjustable straps (7), bundle hoses together and tie to tractor steel tubes to avoid interference with moving parts.

7. Install long 90° elbow (20), male coupler (3) and color coded dust cap (14 & 15) to one end of each of two 3/8 x 70" hoses (18). Hand tighten male couplers (3) to 90° elbow (21) then tighten jam nut on 90° elbow (21) to male coupler (3). Install 90° elbow (21), male coupler (3) and color coded dust cap (16 & 17) to one end of each of two remaining 3/8 x 70" hoses (18). Install color coded spiral bands (22-25) to the opposite end of hoses (18).

NOTE: It is important to make sure color coding corresponds between dust caps and spiral bands on each hose.

8. Slide nylon sleeve (19) over 3/8 x 70" hoses (18) and install hoses to steel oil lines on loader in sequence shown in Figure 3. Hose with blue coding attaches to bucket cylinder base. Hose with red coding attaches to bucket cylinder rod. Hose with yellow coding attaches to lift cylinder rod. Hose with green coding attaches to lift cylinder base.
9. During loader installation, attach loader hoses with male couplers and colored dust caps to tractor couplers with corresponding dust plug color coding. Hoses may need to be loosened at 90° elbow (20 & 21) for better routing. Attach dust caps to dust plugs.
10. Route hoses (18) behind tool box on cab tractors as illustrated in figure 1 or at handrail on less cab tractors as illustrated in figure 2. Bundle hoses together and secure with tarp strap (30) to avoid interference with moving parts as necessary. Tarp strap hooks are located in parts bag.
11. After plumbing and loader installation has been completed, slowly cycle lift and bucket cylinders several times to purge air from hydraulic system. Retract cylinders and shut off engine. Replenish tractor hydraulic system with New Holland 134 hydraulic oil.

NOTE: When cycling loader, operate loader according to operation decal for valve. If direction of control lever is wrong, or loader will not lower, recheck connections.

2-6673
2-6954

715767006
715767026



WARNING: Escaping fluid under pressure can penetrate skin causing serious personal injury.

- Do not use your hands to check for leaks. Use a piece of cardboard or paper. Always wear eye protection when searching for leaks.
- Stop engine and relieve pressure before connecting and disconnecting lines.
- Tighten all connections before starting engine or pressurizing lines.
- If any fluid is injected into skin, obtain medical attention immediately or gangrene may result.

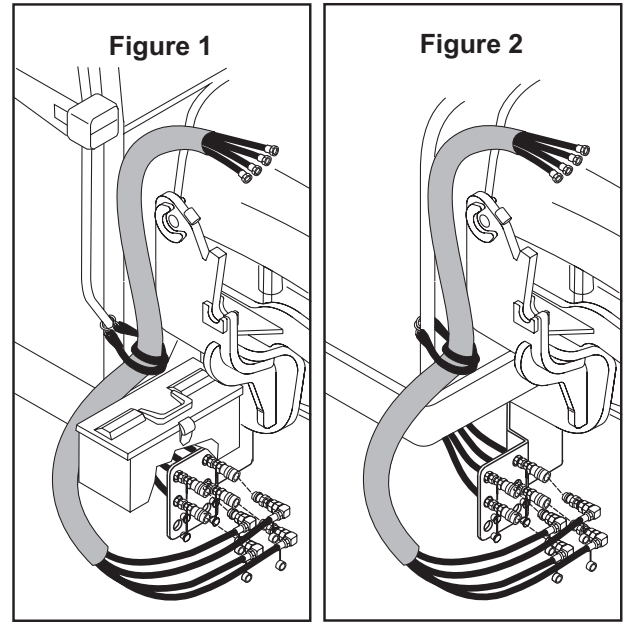

PARTS LIST - HOSE KIT

ITEM	SMC NO.	NH NO.	DESCRIPTION	QTY.
1	48773	SML48773	COUPLER BRACKET	1
2	6040-16	86018680	RETAINING RING, 1-1/2"	8
3	6137-10	86581680	COUPLER, Male, O-ring, 3/4-16	8
4	G121574	84057	WASHER, Lock, 5/8	2
5	6090-53	86601712	SCREW, Cap, 16mm-1.50 x 45mm, Class 8.8	1
6	6090-61	86601710	SCREW, Cap, 16mm-1.50 x 70mm, Class 8.8	1
7	8137-3	86581720	STRAP, Adjustable, 1/2 x 20	2
8	48318-2	SML483182	HOSE, 3/8 x 94"	4
9	47110-1	86582375	COUPLER, Female, O-ring, 3/4-16	4
10	4838-4	86581710	DUST PLUG, Red	1
11	4838-12	86581711	DUST PLUG, Blue	1
12	4838-13	86581712	DUST PLUG, Yellow	1
13	4838-14	86581713	DUST PLUG, Green	1
14	4838-3	86581687	DUST CAP, Red	2
15	4838-8	86581686	DUST CAP, Blue	2
16	4838-9	86581688	DUST CAP, Yellow	2
17	4838-10	86581689	DUST CAP, Green	2
18	47422-2	86581675	HOSE, 3/8 x 70"	4
19	34853-26	86581681	SLEEVE, Nylon, 52"	1
20	41796-1	128830	FITTING, 90° Elbow, 3/4-16 JIC Male x 3/4-16 JIC Male	2
21	32845-2	86582376	FITTING, 90° Elbow, 3/4-16 O-Ring Male x 3/4-16 JIC Male	2
22	36240-5	86581714	SPIRAL BAND, Plastic, Blue, 5/8	1
23	36240-6	86581715	SPIRAL BAND, Plastic, Red, 5/8	1
24	36240-7	86581716	SPIRAL BAND, Plastic, Yellow, 5/8	1
25	36240-8	86581717	SPIRAL BAND, Plastic, Green, 5/8	1
26	36240-9	86581690	SPIRAL BAND, Plastic, Blue, 1"	1
27	36240-10	86581691	SPIRAL BAND, Plastic, Red, 1"	1
28	36240-11	86581692	SPIRAL BAND, Plastic, Yellow, 1"	1
29	36240-12	86581693	SPIRAL BAND, Plastic, Green, 1"	1
30	7438-1	86581718	TARP STRAP	1

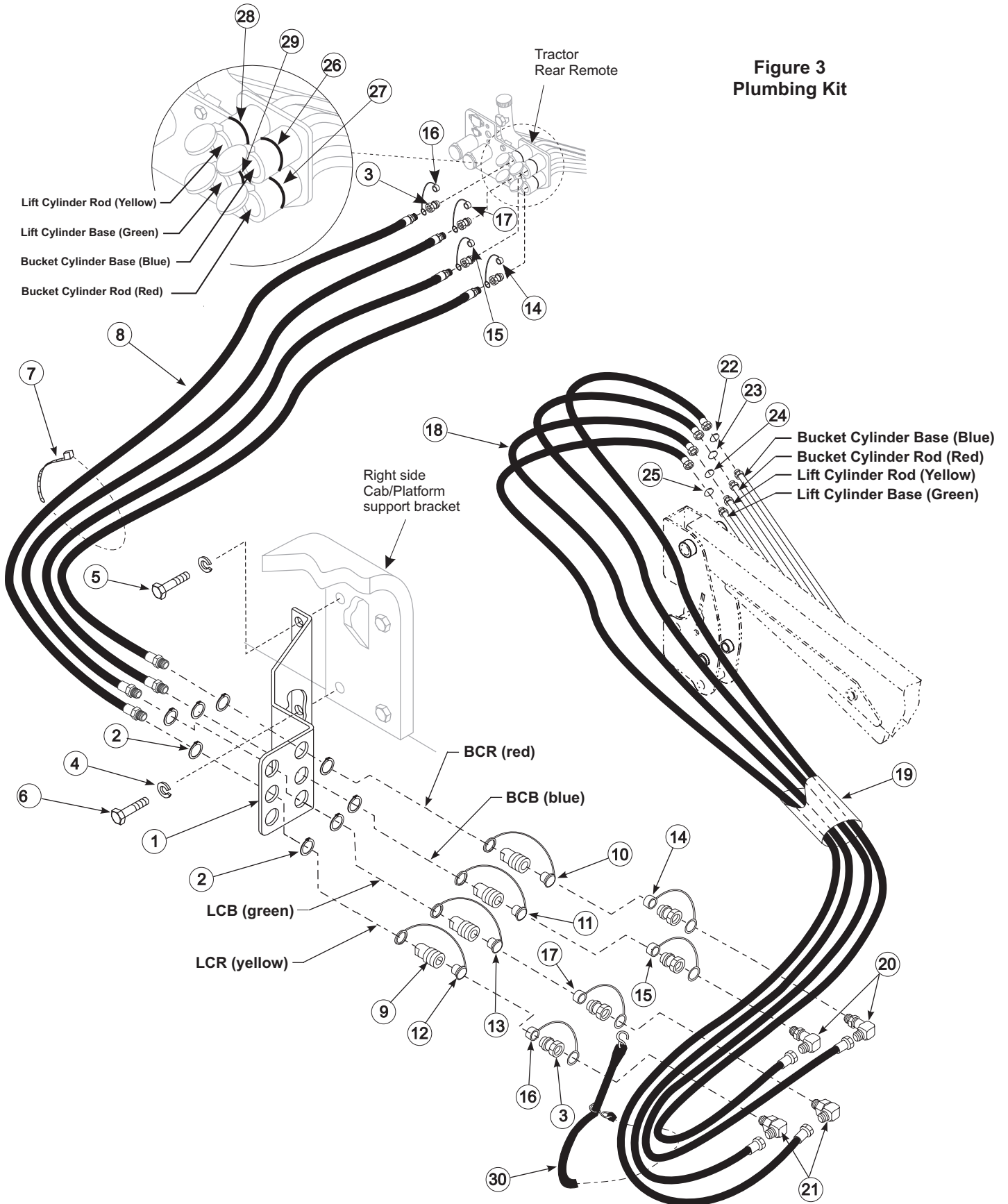

2-6673
2-6954

715767006
715767026

INSTALLATION INSTRUCTIONS