

Keep with Operator's Manual

**SSL QUICK ATTACH PALLET FORK
SKID STEER COMPATIBLE**

IMPORTANT: Loader must be equipped with skid-steer compatible quick-attach device to attach pallet fork.



WARNING: Do not weld to pallet fork tines. Tines are high-carbon steel and may break under load after being welded, causing serious injury or death.

If an attachment is attached to loader, remove attachment from loader before attaching pallet fork.

ASSEMBLING PALLET FORK

1. Use overhead hoist to lift pallet fork frame (1) and tines (2) and place them upright on a smooth level surface. Continue to support pallet fork frame (1) with overhead hoist until tines (2) are installed.
2. Lift latch pin lever on one pallet fork tine assembly (2) to hold pin in unlatched position. Slide tine assembly (2) onto pallet fork frame at center, slide tine to desired width setting, and lower latch pin lever to secure tine in place at one of the tine center

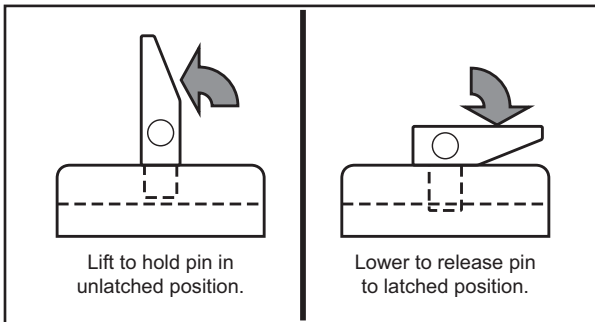

detent locations provided.

NOTE: Upper tine attachment plate of pallet fork frame (1) has detent slots spaced at 4" centers to allow tines (2) to be spaced at center widths of 10", 18", 26", 34" or 42". When installing pallet fork tines (2), adjust them to equal distances of center of pallet fork frame (1) to avoid unbalanced loading.

3. Repeat previous instruction above to attach remaining pallet fork tine (2) to other side of pallet fork frame (1).

ATTACHING PALLET FORK TO LOADER



WARNING: To avoid injury during installation of pallet fork, do not allow bystanders within 10 feet of loader or pallet fork.

1. Locate tractor and attachment on level ground. Lower boom to rest on ground. Place tractor in neutral, set tractor brake, shut off tractor. Look at quick attach device to make sure quick attach handles are in unlatched (raised) position.

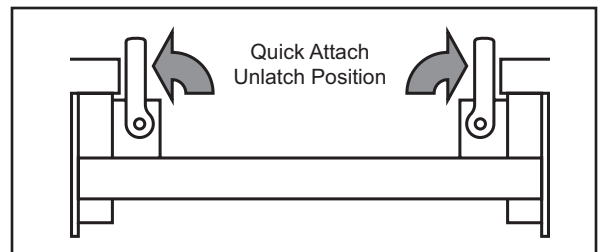

2. Start tractor engine, extend bucket cylinders slightly, while raising boom to provide three to five inches of ground clearance. Drive tractor ahead slowly toward back of pallet fork, aligning quick attach bracket with pallet fork attaching pads.
3. While driving tractor ahead slowly to maintain contact with pallet fork, activate lift cylinders to raise loader until quick attach engages under lip of pallet fork attachment pad.
4. Activate tilt cylinders to retract, continuing to roll pallet fork back completely.
5. Place tractor in neutral, set parking brake, shut off tractor. Move quick attach handles to latch (down) position.

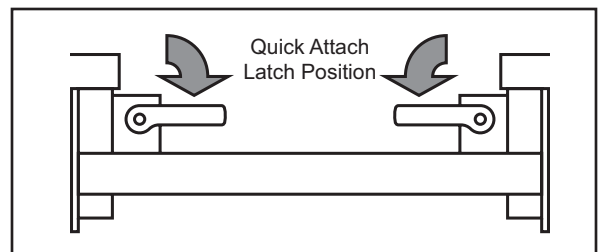

6. Start tractor and activate lift cylinders to raise pallet fork two or three feet off ground and extend tilt cylinders at a slight downward angle, so quick attach latch pins are visible. Visually inspect attachment mechanism to verify that pins are engaged through latch plate at bottom of pallet fork attachment pads.

ADJUST LEVEL INDICATOR

(4211, 4211SS AND 5211 LOADERS ONLY)

IMPORTANT: Level setting varies for each loader attachment. It is important to make sure level indicator is adjusted to indicate level whenever a different attachment is mounted, or else indicator will not indicate true level.

To adjust level indicator properly, locate tractor and loader attachment on a firm level surface, with attachment resting on level surface in level operation position. Loosen u-bolt that fastens level indicator bracket to right tilt cylinder and position it so it is centered on the offset in level indicator rod, then retighten u-bolt hardware.

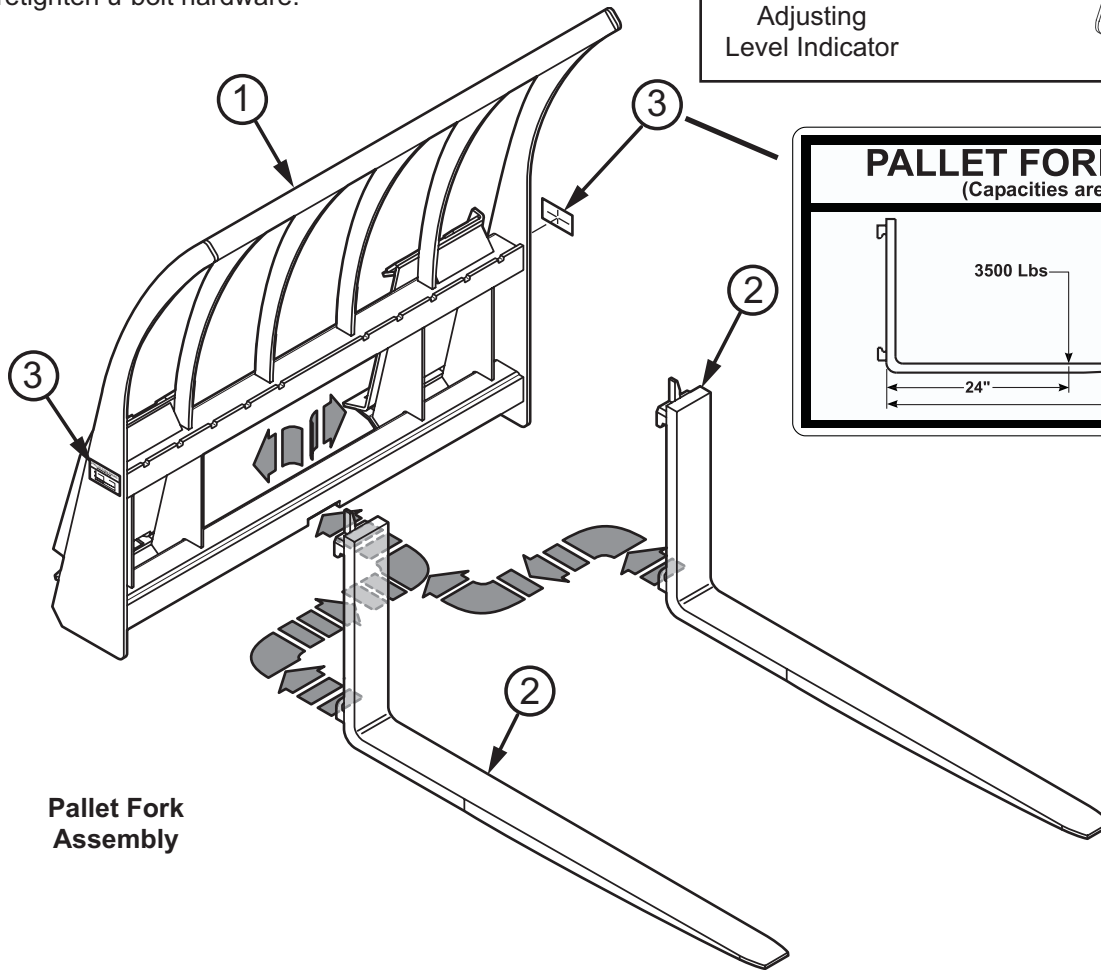
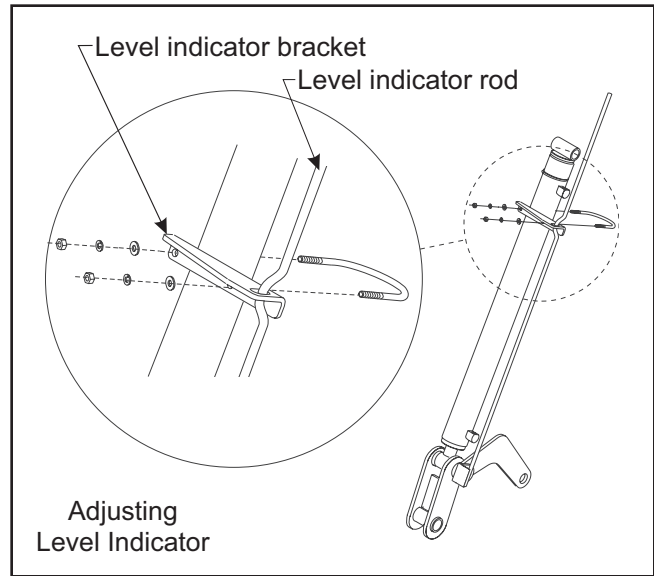

Pallet Fork Assembly

PARTS LIST – PALLET FORK

Item	Part No.	Description	Qty.
1	50638	FRAME, Pallet Fork	1
2	50650	TINE ASSEMBLY, Pallet Fork	2
3	50903	DECAL, Pallet Fork Rating	2

INSTALLATION INSTRUCTIONS