

Keep with Operators Manual
----------------------------

## BACKHOE SUBFRAME KIT 756C BACKHOE CASE IH & NEW HOLLAND TRACTORS

CASE IH MODEL	NEW HOLLAND MODEL
	TC18 (S/N UD33666 & Higher)
DX21, DX23	TC21D (S/N UF33357 & Higher), TC21DA, TC23DA
DX24, DX26	TC24D, TC24DA, TC26DA

Reference to right, left, front and back refers to operator seated in tractor seat in normal operating position.

### INSTALLING MOUNTING BRACKETS (Figure 2)

1. Remove 3-point hitch lower adjusters and brackets bolted to rear axle casting. Save hardware for installing rear axle brackets.
2. Install rear axle brackets (2 & 3) to rear axle casting using hardware previously removed.

**IMPORTANT:** *If tractor is equipped with turf tires, change wheels from left to right sides and reverse wheels to provide clearance for subframe.*

3. Install center support bracket (13) to clutch housing area of tractor.

**If mounting with the CNH 12LA or LX112 loader,** the loader mounting is installed over mounting bracket (13) and secured with 16mm x 50mm cap screws and 5/8 lock washers (15) supplied with loader mounting. Torque bolts to 110-135 Ft. Lbs. (149-184 Nm).

**If backhoe is being used with 702C, 702D or BMX160H Front Dozer,** install center support bracket (13) to clutch housing area of tractor using 16mm x 40mm cap screws (14) and 5/8 lock washers (15). Torque bolts to 110-135 ft.-lbs. (149-184 Nm)

### INSTALLING SUBFRAME (Figure 3)

1. Install subframe (1) to backhoe mainframe using 7/8 x 4 cap screws (10), 7/8 lock washers (12) and 7/8 hex nuts (11) in rear holes and 3/4 x 3-1/2 cap screws (9) and 3/4 lock nuts (8) in front holes.

**IMPORTANT:** *Torque 7/8" hardware to 350-386 ft.-lbs. (474-523 Nm). Torque 3/4" hardware to 238-262 ft.-lbs. (322-355 Nm).*

2. Install mount bars (4) to subframe and backhoe mainframe using 3/4 x 2-3/4 cap screws (7) and 3/4 lock nuts (8).

**IMPORTANT:** *Torque 3/4" hardware to 238-262 ft.-lbs. (322-355 Nm).*

### MOUNTING BACKHOE TO TRACTOR (Figure 1)

1. Back tractor over subframe close enough to connect backhoe hydraulic system. Refer to instruction sheet packed with hydraulic kit to connect hydraulics.
2. Using backhoe hydraulic controls, extend stabilizer, dipper and boom cylinders until rear mounting tube is level with rear axle brackets and front of subframe level with center support bracket tube (Figure 1).
3. Slowly back tractor until subframe is connected to center support bracket and rear axle brackets.
4. Secure subframe using clevis pins (5) and hair pin clips (6) (Figure 2).

**Figure 1**  
**Mounting Subframe**  
**To Tractor**

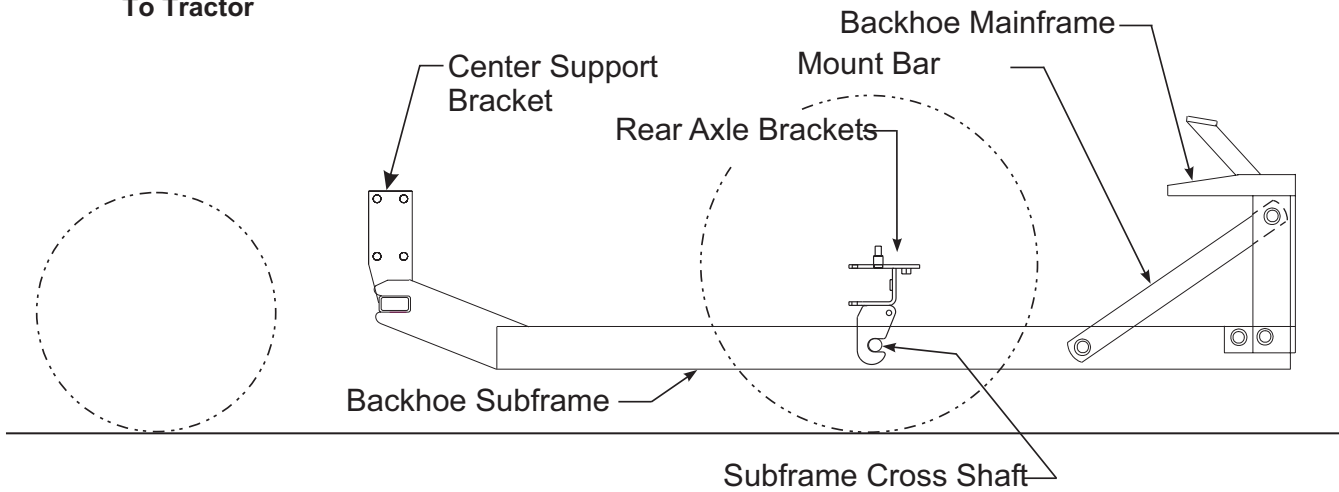

**PARTS LIST - SUBFRAME MOUNTING KIT**

ITEM	SMC NO.	NH NO.	DESCRIPTION	QTY.
1	46010	SML46010	SUBFRAME	1
2	46458-2	SML464582	REAR AXLE BRACKET, Right	1
3	46458-1	SML464581	REAR AXLE BRACKET, Left	1
4	44836	SML44836	BAR, Mount	2
5	44892	SML44892	CLEVIS PIN, 3/4 x 3	2
6	44756-1	SML447561	LINCH PIN	2
7	42969-4	SMLG223527	SCREW, Cap, 3/4-10 x 2-3/4 (Grade 8) (Torque to 350 ft lbs)	4
8	47264-8	09626598	NUT, Lock, 3/4-10	8
9	41838-43	00088558	SCREW, Cap, 3/4-10 x 3-1/2	2
10	41838-46	SMLG271823	SCREW, Cap, 7/8-9 x 4	2
11	41836-9	09849647	NUT, Hex, 7/8-9	2
12	41837-9	00087341	WASHER, Lock, 7/8	2
13	50171	SML50171	BRACKET, Center Support	1
14	42672-15	00848780	SCREW, Cap, 16mm-2.0 x 40mm	8
15	41837-7	0084057	WASHER, Lock, 5/8	8

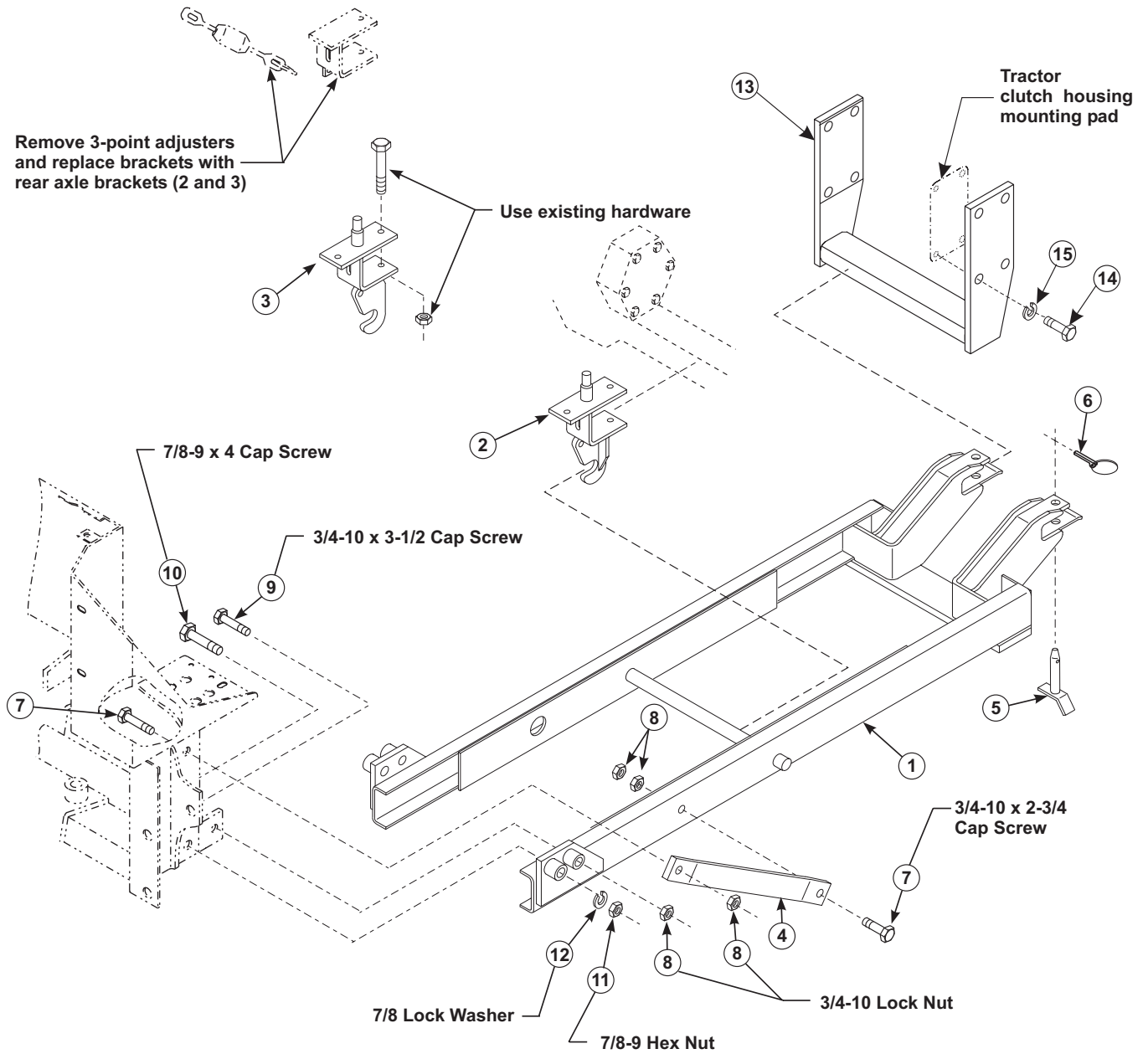

Figure 2  
Subframe Mounting Kit

**GENERAL TORQUE SPECIFICATIONS**

USE THE FOLLOWING TORQUES WHEN SPECIAL TORQUES ARE NOT GIVEN

**Standard American and Metric Cap Screws**

AMERICAN STANDARD CAP SCREWS										METRIC CAP SCREWS							
SAE Grade	5				8				Metric Class	8.8				10.9			
Typ. Head Markings									Typ. Head Markings								
Cap Screw	TORQUE				TORQUE				Cap Screw	TORQUE				TORQUE			
Size	FT-LBS		N-m		FT-LBS		N-m		Size	FT-LBS		N-m		FT-LBS		N-m	
Inches	MIN	MAX	MIN	MAX	MIN	MAX	MIN	MAX	Millimeters	MIN	MAX	MIN	MAX	MIN	MAX	MIN	MAX
1/4 - 20	6.25	7.25	8.5	10	8.25	9.5	11	13	M6 x 1.00	6	8	8	11	9	11	12	15
1/4 - 28	8	9	11	12	10.5	12	14	16	M8 x 1.25	16	20	21.5	27	23	27	31	36.5
5/16 - 18	14	15	19	20	18.5	20	25	27	M10 x 1.50	29	35	39	47	42	52	57	70
5/16 - 24	17.5	19	23	26	23	25	31	34	M12 x 1.75	52	62	70	84	75	91	102	123
3/8 - 16	26	28	35	38	35	37	47.5	50	M14 x 2.00	85	103	115	139	120	146	163	198
3/8 - 24	31	34	42	46	41	45	55.5	61	M16 x 2.50	130	158	176	214	176	216	238	293
7/16 - 14	41	45	55.5	61	55	60	74.5	81	M18 x 2.50	172	210	233	284	240	294	325	398
7/16 - 20	51	55	69	74.5	68	75	92	102	M20 x 2.50	247	301	335	408	343	426	465	577
1/2 - 13	65	72	88	97.5	86	96	116	130	M22 x 2.50	332	404	450	547	472	576	639	780
1/2 - 20	76	84	103	114	102	112	138	152	M24 x 3.00	423	517	573	700	599	732	812	992
9/16 - 12	95	105	129	142	127	140	172	190	M27 x 3.00	637	779	863	1055	898	1098	1217	1488
9/16 - 18	111	123	150	167	148	164	200	222	M30 x 3.00	872	1066	1181	1444	1224	1496	1658	2027
5/8 - 11	126	139	171	188	168	185	228	251	<p><b>NOTE:</b> These values apply to fasteners as received from supplier, dry or when lubricated with normal engine oil. They do not apply if special graphite or moly sulphide greases or other extreme lubricants are used.</p>								
5/8 - 18	152	168	206	228	203	224	275	304									
3/4 - 10	238	262	322	355	318	350	431	474									
3/4 - 16	274	305	371	409	365	402	495	544									
7/8 - 9	350	386	474	523	466	515	631	698									
7/8 - 14	407	448	551	607	543	597	736	809									
1 - 8	537	592	728	802	716	790	970	1070									
1 - 14	670	740	908	1003	894	987	1211	1337									

# INSTALLATION INSTRUCTIONS