

Keep With Operator's Manual

BACKHOE MOUNTING KIT 60C, 65A, 75, 75C, 85, & 85C BACKHOES JOHN DEERE MODEL 990 TRACTORS

Reference to left and right used in this installation instruction sheet refer to position when seated in the operating position on tractor.

Complete backhoe mounting requires this subframe kit (2-7155) and subframe channel kit (2-6509).

NOTE: Leave all attaching hardware loose until backhoe subframe is completely assembled to facilitate assembly and proper alignment. Torque hardware to torque specifications located in backhoe owner's manual.

IMPORTANT: Remove lynch pins and disconnect supports to disable 3-point hitch arms.

INSTALLING FRONT MOUNTING BRACKET (Figure 1)

1. Loosen two cap screws (do not remove) securing support bracket for quick couplers supplied with tractor, if so equipped.
2. Remove right loader left mid mount by removing four 45mm cap screws.
3. Remove two 16mm x 45mm cap screws from lower two holes on loader left mid mount. Loosen upper two 16mm x 45mm cap screws and tilt loader left mid mount up and from inside out insert two 5/8 x 1.75 cap screws (17) into lowest holes in loader mid mount bracket. Attach backhoe subframe front mounting bracket (1) to left loader mid mount bracket with 5/8 x 1.75 cap screws (17) and 5/8 lock nuts (18). Tilt loader mid mount back tight to tractor casting and fasten loader mounting and backhoe front mounting bracket to tractor with two 16mm x 60mm cap screws (15) and 5/8 lock washers (16).
4. Mount right loader mid mount to tractor with two 16mm x 45mm cap screws. Attach backhoe subframe mounting bracket (1) to loader right mid mount with two 16mm x 60mm cap screws (15), 5/8 lock washers (16), two 5/8 x 1.75 cap screws (17) and lock nuts (18).
5. Re-secure support bracket for tractor quick couplers supplied with tractor, if so equipped.
6. Torque hardware.

INSTALLING REAR MOUNTING BRACKET (Figure 1)

1. Remove pin securing drawbar to tractor and remove drawbar.
2. Remove four 14mm x 30mm cap screws from under hitch assembly.
3. Attach subframe rear mounting bracket (2) and tractor hitch assembly with four 14mm x 45mm cap screws (8), 9/16 lock washers (10).
4. Fasten side plate (7) to PTO shield mounting holes using 12mm-1.75 x 35mm cap screws (21) and 1/2 lock washers (22). Attach side plate (7) to rear mounting bracket (2) using 5/8 x 2 cap screws (20) and 5/8 lock nuts (18).
5. Torque hardware.
6. Install drawbar and secure with pin.

INSTALLING SUBFRAME (Figure 1)

1. Install front and rear crosstubes (3 & 4) to channels (24 & 25) using 1/2 x 1.50 cap screws (23) and 1/2 lock nuts (9).
- NOTE:** Install front and rear crosstubes (3 & 4) in rearward most set of holes in subframe channels (24 & 25).
2. Install subframe assembly to backhoe mainframe using 7/8 x 3 cap screws (13), 7/8 lock washers (14) and 7/8 nuts (19) in rear holes and 3/4 x 2 cap screws (11) and 3/4 lock nuts (12) in front holes.
 3. On 65 backhoe install support braces (26) in front set of holes on subframe channels (24 & 25). On 75 & 85 backhoes install support braces (26) in rear set of holes on subframe channels (24 & 25) (See figures 1, 2 & 3). Secure with 3/4 x 2.75 cap screws (27) and 3/4 lock nuts (28). Secure remaining end of support braces (26) to backhoe mainframe using 3/4 x 2.75 cap screws (27) and 3/4 lock nuts (28).

60C ONLY: Use support braces 55884 (29) & 55885 (30).

NOTE: Double nut cap screw (27) after torquing the first nut to 350 ft.·lbs.

2-7155**PARTS LIST - SUBFRAME MOUNTING KIT - 2-7155**

Item	Part No.	Description	Qty.
1	46325	MOUNTING BRACKET ASSEMBLY, Front	1
2	50337	MOUNTING BRACKET ASSEMBLY, Rear	1
3	46318	FRONT CROSSTUBE ASSEMBLY	1
4	46320	REAR CROSSTUBE ASSEMBLY	1
5	44892	PIN ASSEMBLY	2
6	44756-1	LINCH PIN	2
7	50338	SIDE PLATE	2
8	42672-38	SCREW, Cap, 14mm-2.0 x 45mm	4
9	41840-5	NUT, Lock, 1/2-13	8
10	41837-6	WASHER, Lock, 9/16	4
11	41838-8	SCREW, Cap, 3/4-10 x 2	2
12	41840-8	NUT, Lock, 3/4-10	2
13	41838-53	SCREW, Cap, 7/8-9 x 3	2
14	41837-9	WASHER, Lock, 7/8	2
15	42672-31	SCREW, Cap, 16mm-2.0 x 60mm	4
16	41837-7	WASHER, Lock, 5/8	4
17	41838-32	SCREW, Cap, 5/8-11 x 1-3/4	4
18	41840-7	NUT, Lock, 5/8-11	6
19	41836-9	NUT, 7/8-9	2
20	41838-27	SCREW, Cap, 5/8-11 x 2	2
21	42672-30	SCREW, Cap, 12mm-1.75 x 35mm	4
22	41837-5	WASHER, Lock, 1/2	4
23	41838-33	SCREW, Cap, 1/2-13 x 1-1/2	8
29	55884	SUPPORT BRACE, Left	1
30	55885	SUPPORT BRACE, Right	1

PARTS LIST - SUBFRAME CHANNEL KIT - 2-6509 - Order Separately

Item	Part No.	Description	Qty.
24	45700-1	CHANNEL, Left	1
25	45700-2	CHANNEL, Right	1
26	44836	SUPPORT BRACE	2
27	42969-4	SCREW, Cap, 3/4-10 x 2-3/4, Grade 8	4
28	47264-8	NUT, Lock, 3/4-10	8

Figure 1
Subframe Mounting Kit

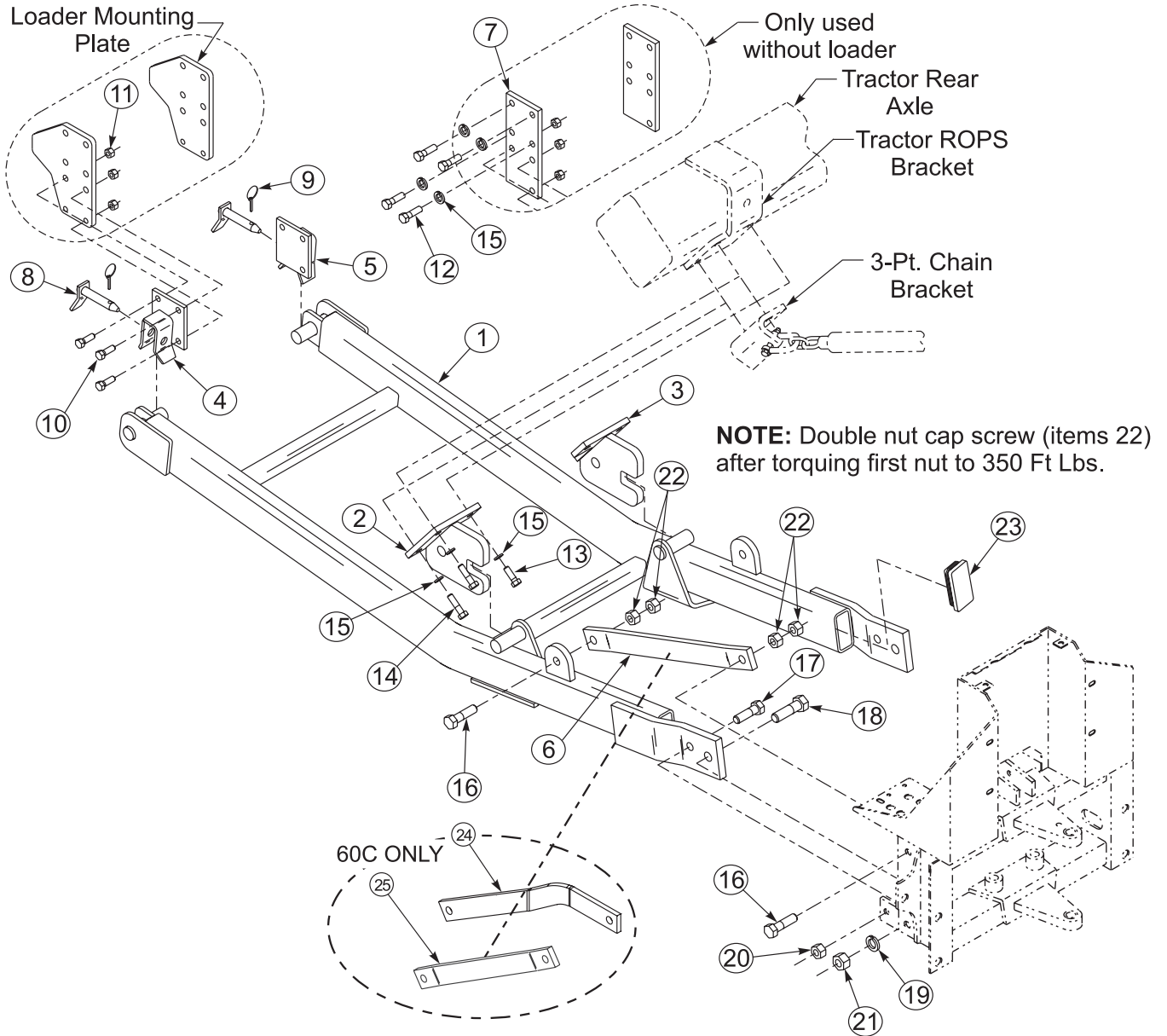

2-7155

MOUNTING BACKHOE TO TRACTOR (Figures 2 & 3)

1. Back tractor over subframe close enough to connect to backhoe hydraulic system.
2. Using backhoe hydraulic controls, extend stabilizer cylinders and boom cylinder until rear cross tube (4) is level with rear mounting bracket (2) and front of subframe is on ground (Figure 2).
3. Slowly back tractor until rear cross tube (4) is seated in rear mounting bracket (2).
4. Retract boom cylinder and stabilizer cylinders so front of subframe swings up until front cross tube (3) is seated in front mounting bracket (1) (See figure 3).
5. Secure front cross tube (3) in place using pin assembly (5) and lynch pins (6).

Figure 2
Mounting Subframe to Tractor

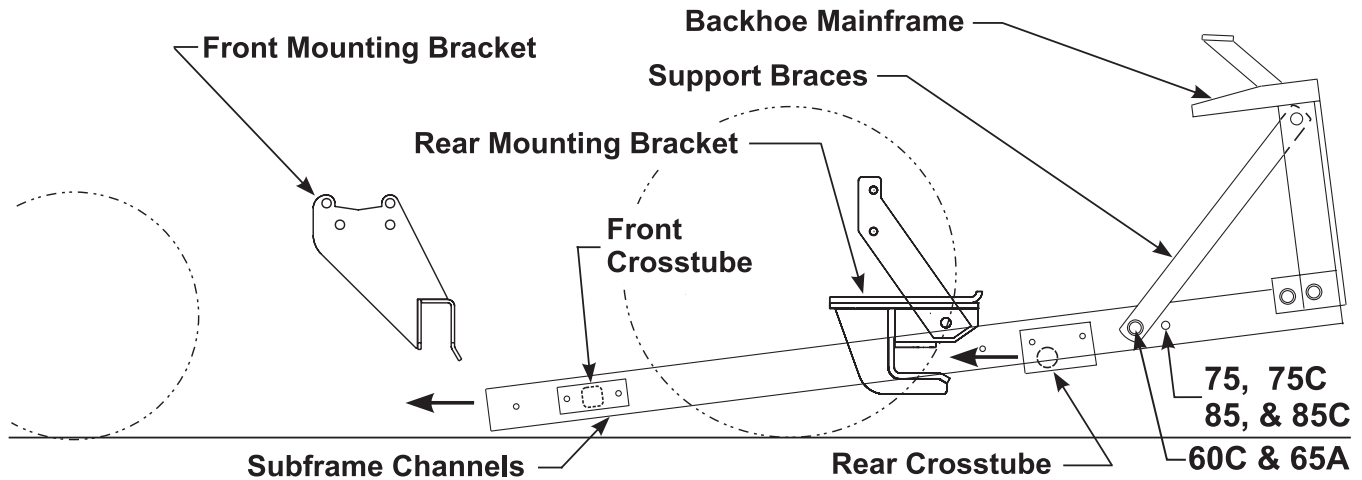
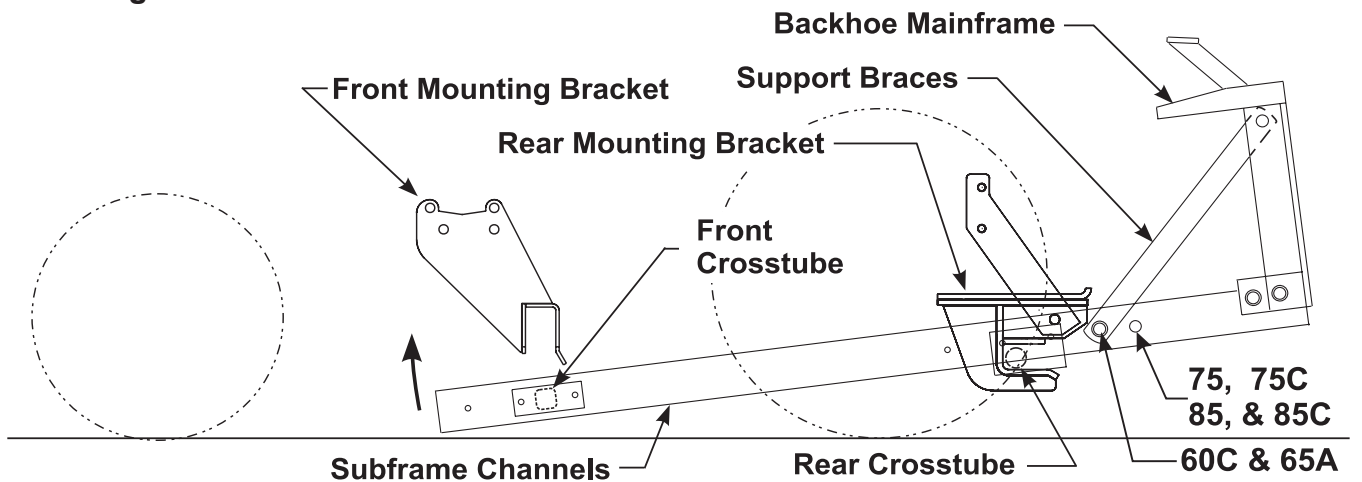

Figure 3
Mounting Subframe to Tractor



INSTALLATION INSTRUCTIONS