

Keep with Operators Manual

LOADER MOUNTING KIT 2409 LOADER CUB CADET 8454, KIOTI DK45 & DK50 TRACTORS

Mounting brackets can be installed using tools ordinarily available. Shut off engine and engage brakes.

NOTE: 2409 Loader installation requires valve and plumbing kit 2-7314 for non-cab tractors.

NOTE: Leave all attaching hardware loose until loader is completely assembled to facilitate assembly and proper alignment. Tighten all hardware to torque specifications listed below or in loader operator's manual.

TRACTOR PREPARATION

1. Remove tractor hood side panels and front grille to prevent damage during installation.
2. Loosen lower side hood support panel by removing two rear bolts from both left and right side of tractor.
3. Remove all dust plugs from transmission housing on left and right side.
4. Remove cap screw and inspection cover plate from right side clutch housing. Leave original gasket in place. Inspection opening will be covered by loader mid mount bracket. Store for later possible use.
5. Remove two rear 12mm x 35mm cap screws from side frame on both sides of tractor.
6. Remove two inner 14mm x 35mm cap screws on sway bar mounting plates on both sides.

INSTALLING MOUNTING BRACKETS

1. Install front mount (4) with four 1/2 x 1-1/2 cap screws (18), lock nuts (20) and flat bar with two 1/2 x 2 cap screws (19) and lock nuts (20). Torque hardware to 72 ft. lbs.
2. Install right mid mount (2) to transmission housing with four 14mm x 40mm cap screws (12) and lock washers (15) and to engine block with two 12mm x 50mm cap screws (11) and lock washers (14). Torque 14mm hardware to 103 ft. lbs. and 12mm hardware to 62 ft. lbs.
3. Install left mid mount (1) to transmission housing with four 14mm x 40mm cap screws (12) and lock washers (15) and to engine block with two 12mm x 50mm cap screws (11) and lock washers (14). Torque 14mm hardware to 103 ft. lbs. and 12mm hardware to 62 ft. lbs.
4. Install right side bar assembly (8) by raising left side of front axle with floor jack to oscillate right side down. Slide bar (8) over right side axle, through right side mid mount (2) back to sway bar mount. Secure bar to engine block with two 12mm x 45mm cap screws (21), lock washers and flat washers (16). Secure to sway bar mount holes

with two 14mm x 45mm (17) and lock washers (15). Torque 14mm hardware to 103 ft. lbs. and 12mm hardware to 62 ft. lbs. Remove floor jack.

5. Install left side bar assembly (7) by sliding over left side front axle, through left side mid mount back to sway bar mount. Secure bar to engine block with two 12mm x 45mm cap screws (21), lock washers and flat washers (16). Secure to sway bar mount holes with two 14mm x 45mm (17) and lock washers (15). Torque 14mm hardware to 103 ft. lbs. and 12mm hardware to 62 ft. lbs.
6. Install cross tie (plate) to connect left and right mid mounts and side bars (7 & 8) with four 1/2 x 3 cap screws (13), 1/2" flat washers (16) and lock nuts (9). Torque hardware to 72 ft. lbs.
7. Replace and tighten bolts in lower side hood support panel on both sides of tractor.
8. Install tractor hood side panels and front grille

INSTALLING LOADER TO MOUNTING BRACKETS



WARNING: To avoid injury during installation of quick attach loader, do not permit bystanders within ten feet of loader.

1. Loop chain or strap around each tilt cylinder above base port and hook onto chain or through strap loop. Using overhead hoist to support loader remove hardware securing loader to pallet. Lift loader and remove pallet.



CAUTION: Do not damage grease fitting on end of cylinder. Be sure chain does not pinch tilt cylinder hose.

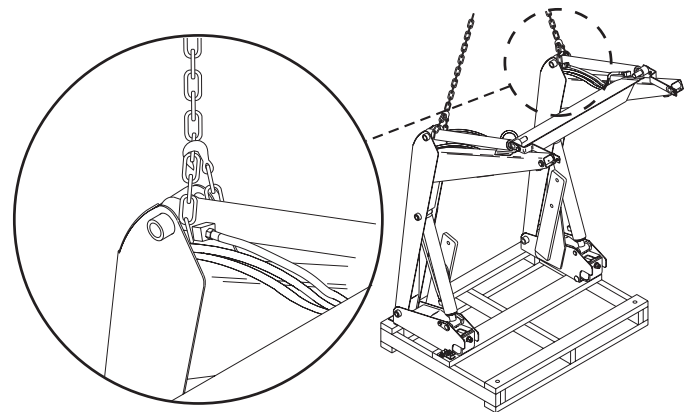

2. Using overhead hoist, lower loader from vertical shipping position to horizontal position leaving enough room to install yoke (scraps of cardboard may be used to protect paint). Install yoke assembly (3) using 3/4 x 2-1/2 cap screws (10) and 3/4 lock nuts (9). Lower loader completely to the ground.

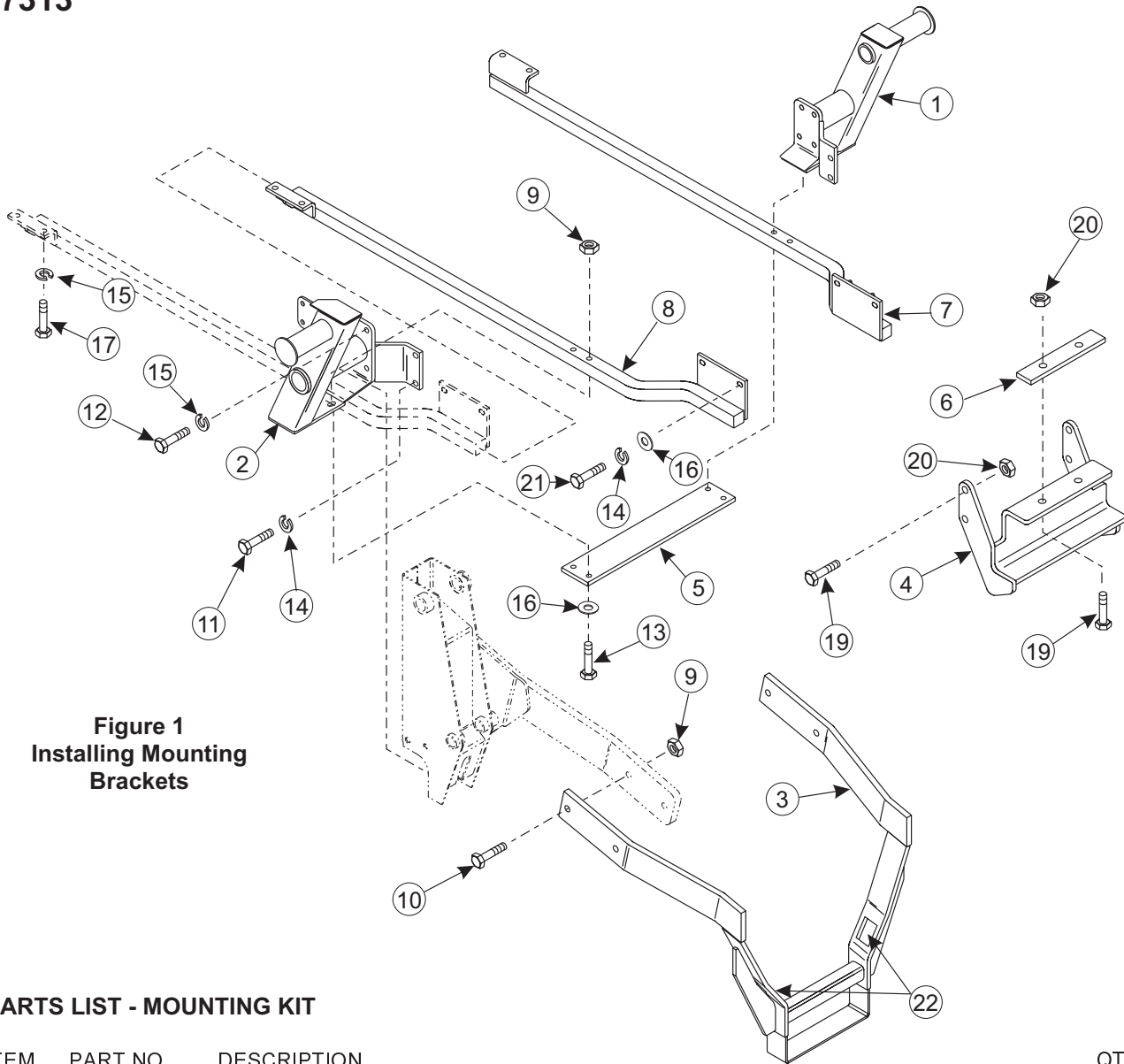
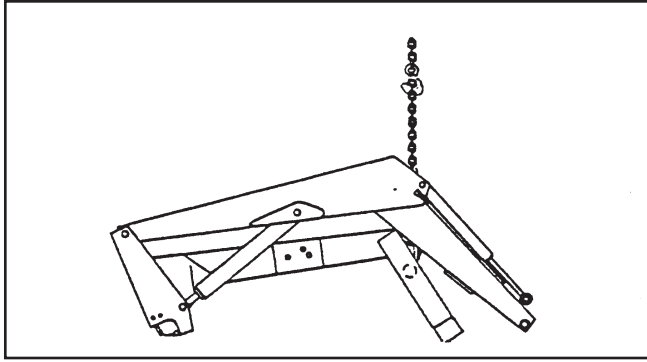

Figure 1
Installing Mounting
Brackets

PARTS LIST - MOUNTING KIT

| ITEM | PART NO. | DESCRIPTION | QTY. |
|------|----------|------------------------------|------|
| 1 | 47811 | MID MOUNT, Assembly, Left | 1 |
| 2 | 51531 | MID MOUNT, Assembly, Right | 1 |
| 3 | 47884 | YOKE, with Decal | 1 |
| 4 | 47820 | FRONT MOUNT, Assembly | 1 |
| 5 | 47817 | CROSS TIE | 1 |
| 6 | 47819 | FLAT | 1 |
| 7 | 51402 | BAR Assembly, Left | 1 |
| 8 | 51403 | BAR Assembly, Right | 1 |
| 9 | 41840-8 | NUT, Lock 3/4-10 | 4 |
| 10 | 41838-7 | SCREW, Cap, 3/4-10 x 2-1/2 | 4 |
| 11 | 42672-68 | SCREW, Cap, 12mm-1.25 x 50mm | 4 |
| 12 | 42672-23 | SCREW, Cap, 14mm-1.5 x 40mm | 8 |
| 13 | 41838-67 | SCREW, Cap, 1/2-13 x 3 | 4 |
| 14 | 41837-5 | WASHER, Lock, 1/2 | 8 |
| 15 | 41837-6 | WASHER, Lock, 9/16 | 12 |
| 16 | 42502-10 | WASHER, Flat, 1/2 | 8 |
| 17 | 42672-60 | SCREW, Cap, 14mm-1.5 x 45mm | 4 |
| 18 | 41838-33 | SCREW, Cap, 1/2-13 x 1-1/2 | 4 |
| 19 | 41838-13 | SCREW, Cap, 1/2-13 x 2 | 2 |
| 20 | 41840-5 | NUT, Lock, 1/2-13 | 10 |
| 21 | 42672-67 | SCREW, Cap, 12mm-1.25 x 45mm | 4 |
| 22 | 39240 | DECAL, Warning | 2 |

INSTALLING LOADER TO MOUNTING BRACKETS (Continued)



NOTE: Hardware connecting yoke to loader sideframes should be snug but do not torque completely. After loader has been mounted to tractor and aligned with midmounting brackets and front mounting brackets, torque hardware to 262 ft. lbs.

3. Install valve kit to tractor and loader. Refer to instruction sheet for 2-7314, Valve and Plumbing Kit, for installation instructions.
4. Position tractor close enough so plumbing can be connected to tractor. Route hoses loosely to allow maximum reach. Using nylon straps reposition overhead hoist to loader boom arms near pivot point to side frames.
5. Operate loader control valve to extend lift cylinders until front yoke is resting on ground and side frame uprights will clear front tires. Shut off tractor engine and engage tractor brakes. Reroute loader hoses to inside of right midmount bracket. Remove locknut and washer from loader hinge and swing each hinge open.

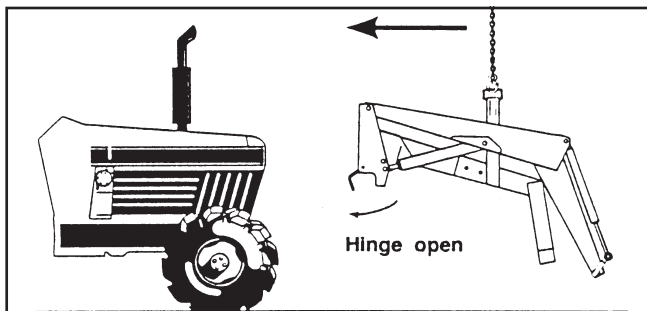

6. Start tractor engine, release tractor brakes and slowly drive forward while operating lift control levers to retract lift cylinders. Position loader so hinges hook over mid mounting tubes. Use of overhead hoist will facilitate positioning loader into mid mounting tubes.

IMPORTANT: Position loader uprights so mid mounting tubes are tight against hinges until loader has finished rotating so loader front bumper tube does not hit lower flange of front mounting channel.

7. With tractor in neutral, retract lift cylinders, bringing side frame up so front yoke tube contacts lower surface of tractor frame. Move tractor ahead until front yoke tube engages in front mounting channel and upright hinges can clamp around mid mounting tube. Engage tractor brakes and shut off tractor engine.
8. Clamp hinges to midmounting tubes with 3/4 flat washers and 3/4 flex-lock nuts (supplied with loader).
9. Start tractor engine and slowly cycle lift and bucket cylinders several times to purge air out of system, then retract cylinders and shut off tractor engine. Add additional tractor hydraulic fluid as specified in tractor owners manual to bring level of hydraulic fluid up to full.

IMPORTANT: Be sure to use flex-lock nuts to clamp hinge. Tighten flex-lock nuts against hinge securely, but not to more than 125 ft.-lb. torque.

10. Adjust front wheel tread settings or steering stops, if necessary to prevent interference between tires and loader. Refer to tractor operator's manual for adjustment procedures.

INSTALLING BUCKET

Refer to instruction sheet for instructions on installing bucket.

INSTALLING BUCKET LEVEL INDICATOR

1. Attach indicator guide tube to cylinder pin. Guide tube is positioned to outside of boom.

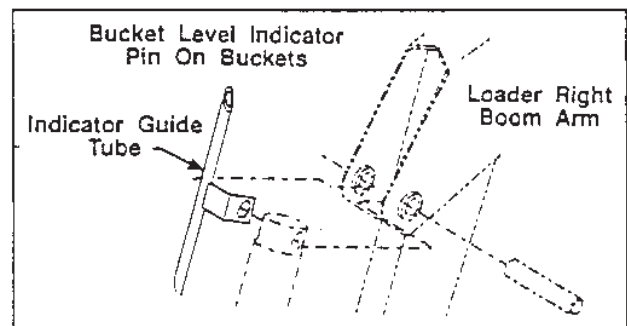

2. Slide bucket level indicator rod through guide tube. Attach other end of rod with 1/8 x 1 cotter pins and 3/8 flat washers.

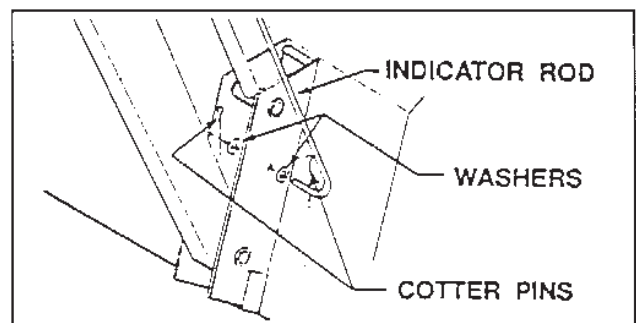

3. Locate tractor and loader on level surface. With bottom of bucket resting on surface, cut off excess rod flush with end of guide tube or paint exposed rod a contrasting color.

INSTALLATION INSTRUCTIONS