

**HOSE KIT
4211 & 4211 MSL LOADER
CASE IH TRACTORS WITH MID MOUNTED REMOTE VALVE**

MODEL	ROPS	CAB
JX80U	x	x
JX90U	x	x
JX100U	x	x

GENERAL INFORMATION

Hose kit can be installed on tractor using tools ordinarily available. Shut off engine and engage brakes during installation.

Hose kit is to be used with a Case IH factory mid mounted joystick valve kit and Alamo SMC or Rhino 4211 front end loader.



WARNING: Escaping hydraulic fluid under pressure can penetrate skin causing serious injury.

- | DO NOT use your hands to check for leaks. Use a piece of cardboard or paper to search for leaks.
- | Stop engine and relieve pressure before connecting or disconnecting lines.
- | Tighten all connections before starting engine or pressurizing lines.

If any fluid is injected into skin, obtain medical attention immediately or gangrene may result.

PLUMBING KIT TO TRACTOR VALVE (Figure 1, 2 & 3)

1. Remove plugs from working ports of mid-mounted remote valve.
2. Install and tighten 18mm x 3/4-16 O-ring adapter fittings (1) to ports of valve.
3. Install colored dust plugs (3-6) and female couplers (2) with colors as illustrated in figure 3.

NOTE: It is important to make sure color coding corresponds between dust caps and spiral bands on each hose.

4. During loader installation, attach loader hoses with male couplers and colored dust caps to tractor couplers with corresponding dust plug color coding. Attach dust caps to dust plugs.
5. Route hoses behind tool box on cab tractors as illustrated in figure 1 or at handrail on less cab tractors as illustrated in figure 2. Bundle hoses together and secure with tarp strap (7) to avoid interference with moving parts as necessary. Tarp strap hooks are located in parts bag.
8. After plumbing has been completed, start tractor engine and slowly cycle lift and bucket cylinders several times to purge air from hydraulic system. Retract cylinders and shut off engine. Add additional hydraulic fluid as specified in tractor operator's manual to bring oil level up to full.

NOTE: When cycling loader, operate loader according to decal on tractor remote valve. If direction of control lever is wrong, correct related quick coupler connections and switch spiral identification bands accordingly.

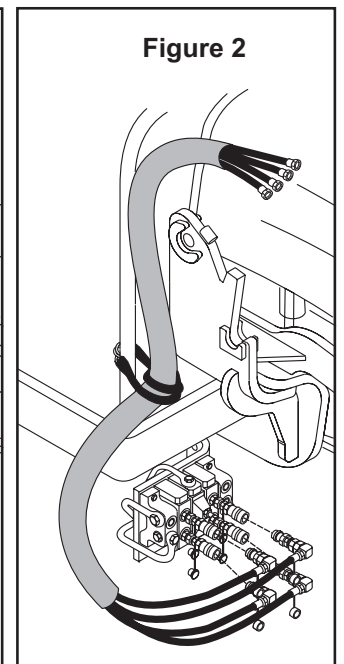
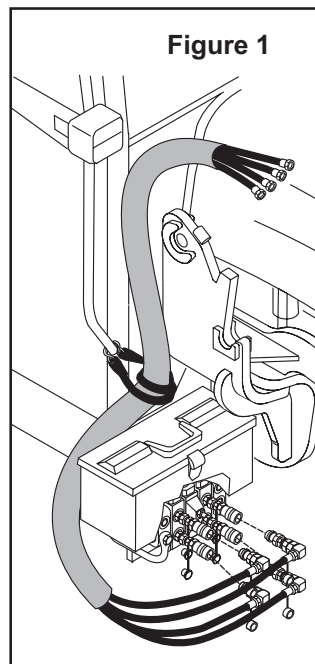
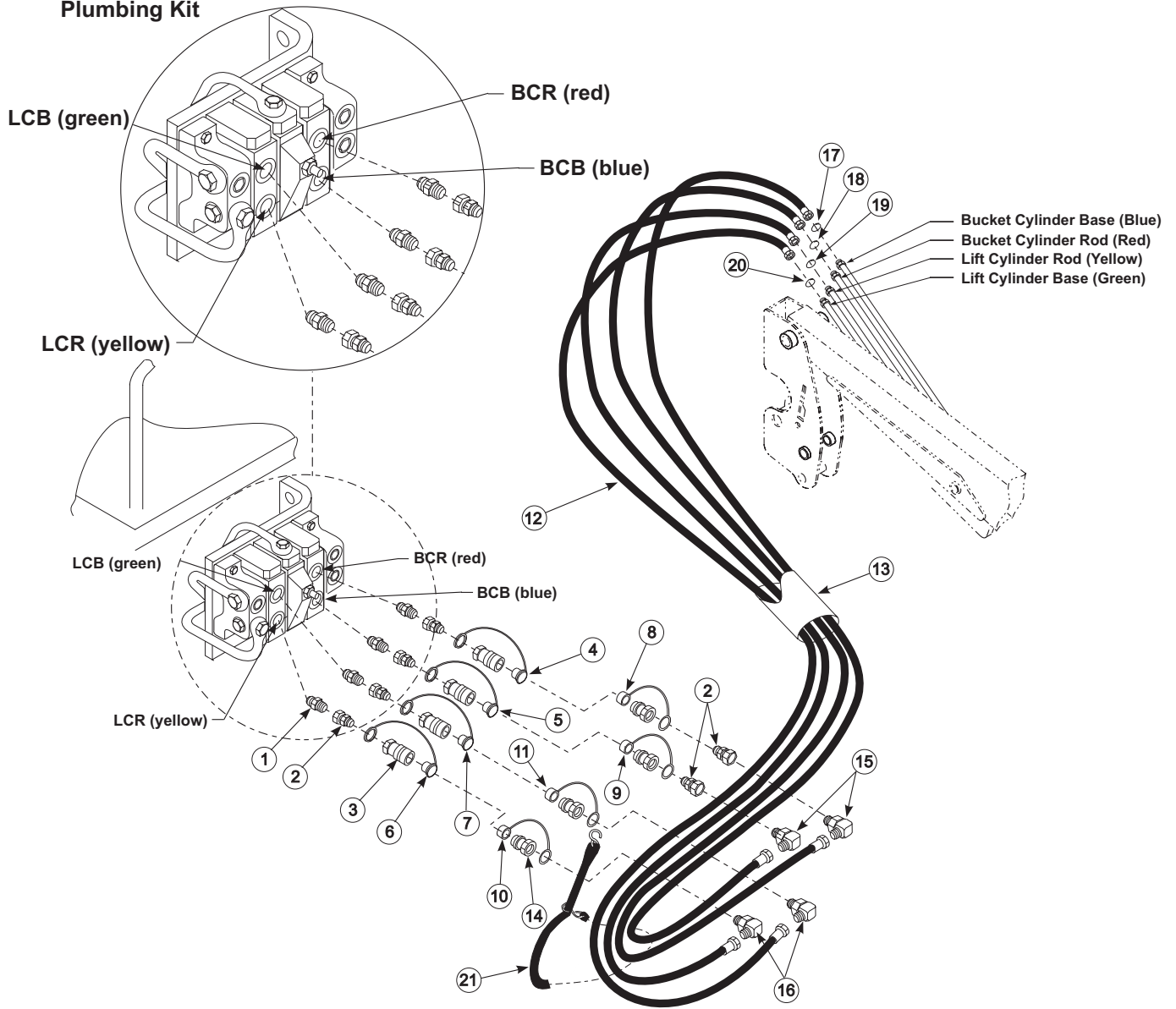

Figure 3
Plumbing Kit



PARTS LIST - PLUMBING KIT

ITEM	SMC NO..	DESCRIPTION	QTY.
1	51374-1	FITTING, Adapter, 18mm-1.50 x O-ring 3/4-16	4
2	47110-1	COUPLER, Female, O-ring 3/4-16	4
3	4838-4	DUST PLUG, Red	1
4	4838-12	DUST PLUG, Blue	1
5	4838-13	DUST PLUG, Yellow	1
6	4838-14	DUST PLUG, Green	1
7	7438-1	TARP STRAP	1