

Keep With Operator's Manual

## PLUMBING KIT FOR ALAMO/SMC RHINO 4211SS LOADERS CASE-IH JX U SERIES TRACTORS WITH REAR REMOTE

MODEL	2WD	4WD	LESS CAB	WITH CAB
JX80U	X	X	X	X
JX90U	X	X	X	X
JX100U	X	X	X	X



**WARNING:** All tractors equipped with remote valve detents must have two remote valve detent removal kits installed (one kit in each spool) prior to operation of loader.

Hose kit can be installed on tractor using tools ordinarily available. Shut off the tractor engine and engage tractor brakes and remove key during installation.

**NOTE:** Apply sealant only to all tapered threads unless coupled with swivel adapters. When using teflon tape, wrap tape clockwise (as viewed from end) and wrap tape only twice. Keep sealant away from first two threads of tapered end to prevent contamination of hydraulic fluid. Do not use sealant on o-ring or flare adapter threads.

### PLUMBING LOADER TO REAR REMOTE VALVE (Figure 1)

1. Remove and discard two rear 16MM cap screws from right cab/platform support bracket.
2. Install female couplers (9) to coupler bracket (1). Connect couplers (9) to coupler bracket (1) using 1-1/2 retaining rings (2).
3. Install coupler bracket (1) to two rear holes of cab/platform support bracket with 16MM-1.50 x 45MM (5) in top hole and 16MM-1.50 x 70MM (6) in bottom hole. Tighten and torque hardware to 177 ft. lbs. (233 N•m).
4. Install spiral bands (26-29) to female couplers on tractor remote as indicated in figure 1.
5. Install male couplers to one end of 94" hoses. Attach the opposite end of the hose and corresponding dust plugs to female couplers (see figure 1 for proper dust plug color placement). Install corresponding dust caps to male couplers.

Route hoses from coupler bracket (1) to rear remote valve and connect to corresponding color female couplers.

6. Using 1/2 x 20 adjustable straps (7), bundle hoses together and tie to tractor steel tubes to avoid interference with moving parts.
7. During loader installation, attach loader hoses with male couplers and colored dust caps to tractor couplers with corresponding dust plug color coding. Attach dust caps to dust plugs.
8. Route hoses (8) under tool box on cab tractors. Bundle hoses together and secure with tie strap (7) to avoid interference with moving parts as necessary.
9. Connect 64" Long hoses from coupler bracket to loader. Making sure to match colors on the hoses to the corresponding colors on the bracket.
10. After plumbing and loader installation has been completed, slowly cycle lift and bucket cylinders several times to purge air from hydraulic system. Retract cylinders and shut off engine. Replenish tractor hydraulic system.

**NOTE:** When cycling loader, operate loader according to operation decal for valve. If direction of control lever is wrong, or loader will not lower, recheck connections.



**WARNING:** Escaping fluid under pressure can penetrate skin causing serious personal injury.

- Do not use your hands to check for leaks. Use a piece of cardboard or paper. Always wear eye protection when searching for leaks.
- Stop engine and relieve pressure before connecting and disconnecting lines.
- Tighten all connections before starting engine or pressurizing lines.
- If any fluid is injected into skin, obtain medical attention immediately or gangrene may result.

#### PARTS LIST - VALVE & PLUMBING KIT

ITEM	SMC NO.	DESCRIPTION	QTY.
1	48773	COUPLER BRACKET	1
2	6040-16	RETAINING RING, 1-1/2"	8
3	6137-10	COUPLER, Male, O-ring, 3/4-16	4
4	41837-7	WASHER, Lock, 5/8	2
5	42672-66	SCREW, Cap, 16mm-1.50 x 45mm, Class 8.8	1
6	42672-75	SCREW, Cap, 16mm-1.50 x 70mm, Class 8.8	1
7	8137-3	STRAP, Adjustable, 1/2 x 20	2
8	48318-2	HOSE, 3/8 x 94", 3-4"-16M "O" Ring x 3/4"-16 M "O" Ring	4
9	47110-1	COUPLER, Female, O-ring, 3/4-16	4
10	4838-4	DUST PLUG, Red	1
11	4838-12	DUST PLUG, Blue	1
12	4838-13	DUST PLUG, Yellow	1
13	4838-14	DUST PLUG, Green	1
14	4838-3	DUST CAP, Red	1
15	4838-8	DUST CAP, Blue	1
16	4838-9	DUST CAP, Yellow	1
17	4838-10	DUST CAP, Green	1
18	36240-9	SPIRAL BAND, Plastic, Blue, 1"	1
19	36240-10	SPIRAL BAND, Plastic, Red, 1"	1
20	36240-11	SPIRAL BAND, Plastic, Yellow, 1"	1
21	36240-12	SPIRAL BAND, Plastic, Green, 1"	1

**Figure 1**  
**Plumbing Kit**

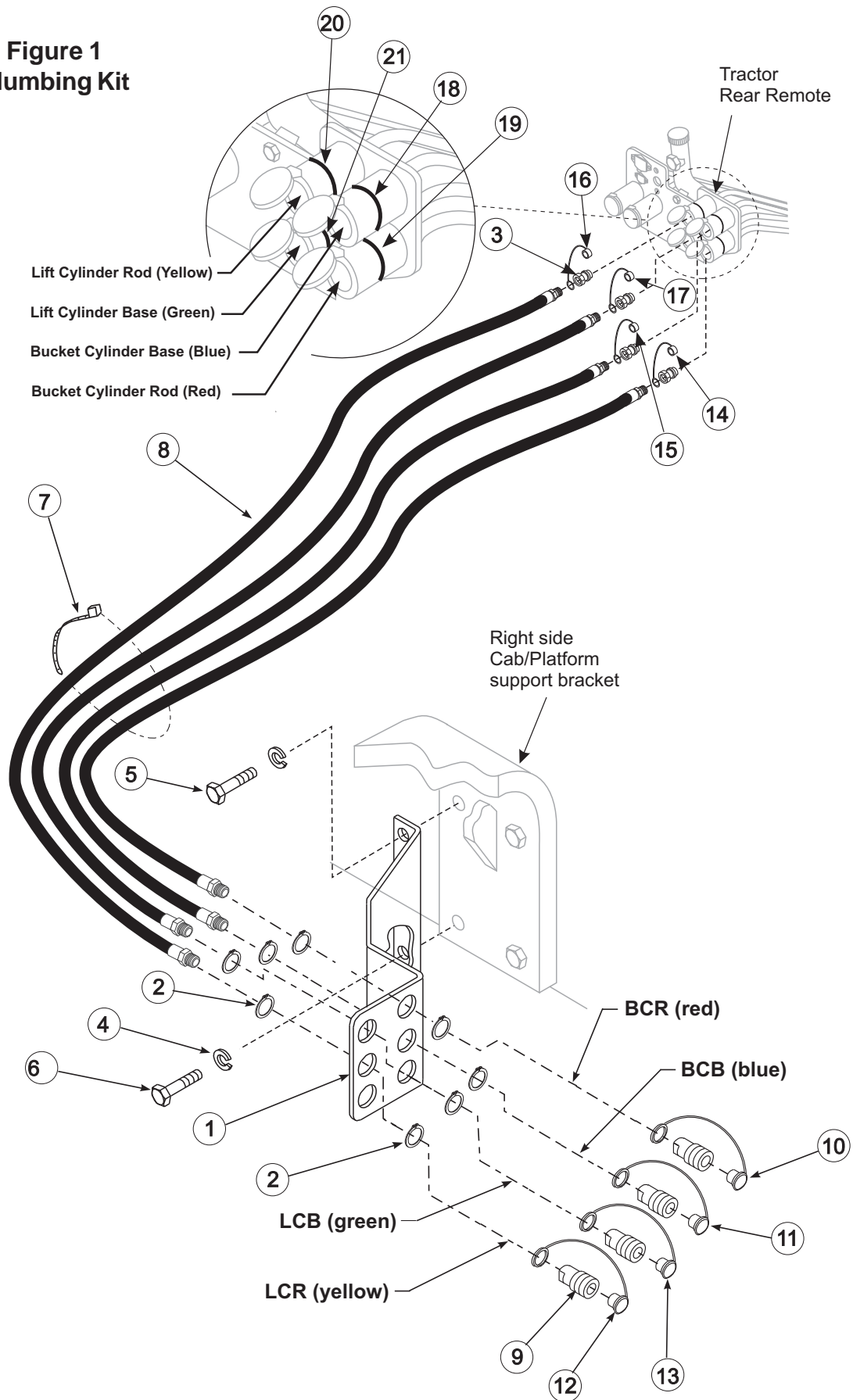

# **INSTALLATION INSTRUCTIONS**