

Keep with Operators Manual

ALAMO SMC 4211 LOADER MOUNTING KIT KIOTI DK55

MODEL	2WD	FWA	CAB	LESS CAB
DK55		X	X	X

Mount kit can be installed using tools ordinarily available. Shut off engine and engage brakes during installation.

NOTE: Leave all attaching hardware loose until loader is completely assembled to facilitate assembly and proper alignment. When special torques are not given, torque hardware to specifications listed on page 6.

TRACTOR PREPARATION

1. Shut off engine and engage brakes during installation of mounting kit.
2. If tractor is equipped with front weights, they should be removed.
3. Raise hood and remove hood side panels to prevent damage during loader mounting installation.
4. Remove dust plugs from tractor clutch housing casting and from three holes on each side of tractor to rear of front axle.
5. Tractor steering stops must be adjusted to provide a minimum clearance of 3/4" between front tire and any part of loader on full left and right lock with front axle fully oscillated. Adjustment must be made with lift cylinders fully retracted. Refer to tractor operator's manual for steering stop adjustment.

INSTALLING LOADER MOUNTING BRACKETS (Figure 1)

NOTE: Unless specified, leave all attaching hardware loose until mounting brackets are completely installed to facilitate assembly and proper alignment of mounting brackets.

1. Attach left midmounting (1) to tractor clutch housing area using four 14MM x 45MM cap screws (6) and 9/16 lock washers (7). Also to the three holes to rear of tractor front axle using three 14MM x 45MM cap screws (6), 9/16 lock washers (7), and 9/16 flat washers (8).

2. A) On right side of tractor, remove bolts from hose angle bracket to allow hoses to hang loose. Hoses may need to be re-routed to avoid pinching by right midmounting (3).

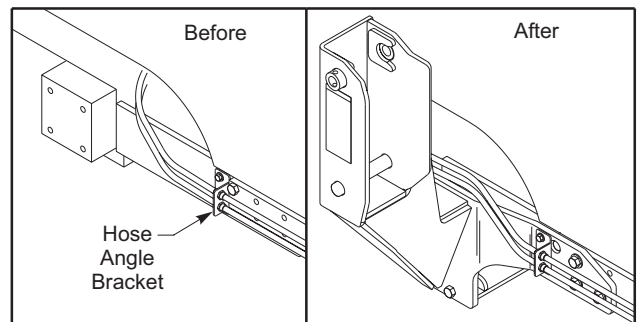

B) Attach right midmounting (3) to tractor clutch housing area using four 14MM x 45MM cap screws (6) and 9/16 lock washers (7). Also to the three holes to rear of tractor front axle using three 14MM x 45MM cap screws (6), 9/16 lock washers (7), and 9/16 flat washers (8).

C) Reattach hose angle bracket to right midmount using 3/8 x 1-1/4 cap screw (10), 3/8 flat washer (12) and 3/8 lock nut (11).

3. Attach crosstie assembly (5) to bottom side of tractor clutch housing using 14MM x 45MM cap screws (6) and 9/16 lock washers (7). Fasten crosstie assembly (5) to left and right midmounts (1 & 3) using 14MM x 45MM cap screws (6), 9/16 lock washers (7), and 14MM hex nuts (9).
4. Torque 14MM hardware to 109 ft.-lbs torque.
5. Reinstall hood side panels and lower hood to locked position.

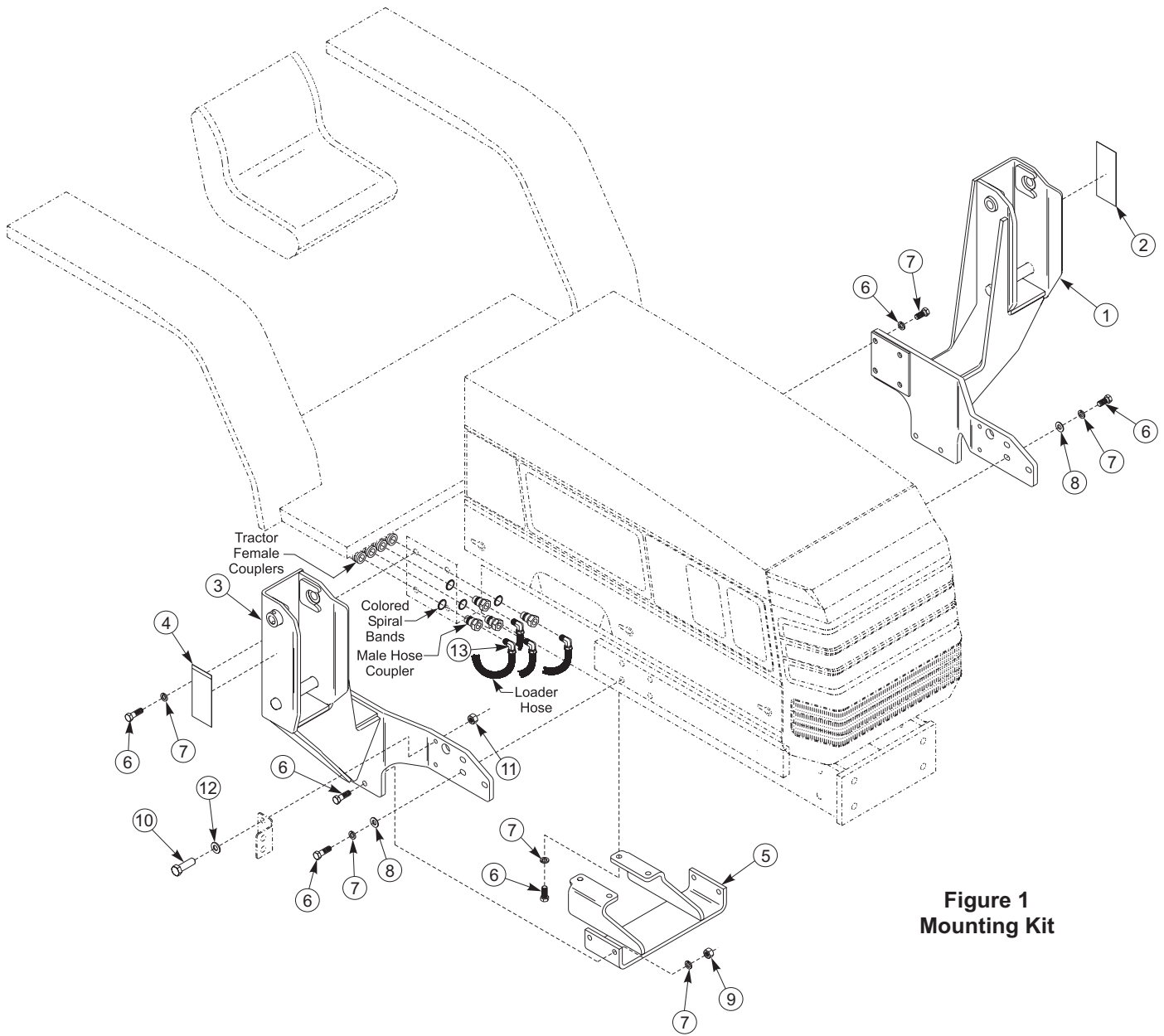

**Figure 1
Mounting Kit**

PARTS LIST - MOUNTING KIT

ITEM	Part No.	DESCRIPTION	QTY.
1	51991-1	MIDMOUNTING ASSEMBLY, Left, with Decals	1
2	46776	DECAL, Warning	1
3	51991-2	MIDMOUNTING ASSEMBLY, Right, with Decal	1
4	48436	DECAL, Warning	1
5	51999	CROSSTIE ASSEMBLY	1
6	42672-60	HHCS, 14MM-1.50 x 45MM	22
7	41837-6	WASHER, Lock, 9/16	22
8	42502-31	WASHER, Flat, 9/16	6
9	26457-1	NUT, Hex, 14MM-1.50	4
10	41838-9	HHCS, 3/8-16 x 1.25	2
11	41840-3	NUT, Lock, 3/8-16	2
12	42502-8	WASHER, Flat, 3/8	2
13	23487-2	FITTING, Elbow, 90° 1/2 NPT x 1/2 NPT	4



WARNING: Loader must be supported before removing hardware securing loader to the shipping pallet, or the loader will tip over.

MOUNTING 4211 LOADER (Figures 2, 3 & 4)



WARNING: To avoid injury during installation of quick attach loader, do not permit bystanders within ten feet of loader.



WARNING: To avoid injury during installation of quick attach loader, an overhead hoist must be used for initial mounting. Parking stands are not operational without attachment mounted.

1. Loop chain under each bucket cylinder and hook on loader boom arm (see figure 2A). Using overhead hoist to support loader, remove cotter pins (A), hitch pins (B) and lynch pins (C) (see figure 3). Discard only the cotter pins. Then remove hardware securing loader to pallet. Lift loader.

Figure 2

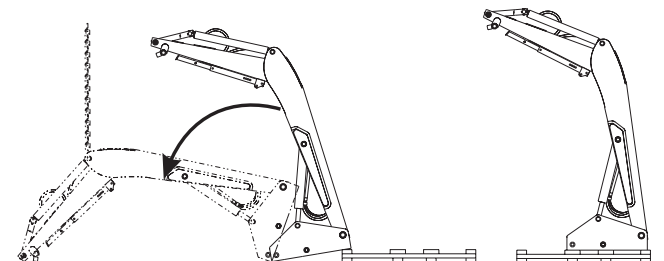
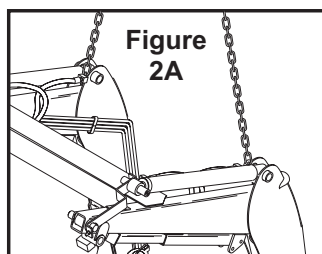

CAUTION: Loader uprights may rotate downward when loader is lifted from pallet.

2. Position pallet at rear of loader to facilitate lowering (see figure 2). Lower loader from vertical shipping position to horizontal position (scraps of cardboard may be used to protect paint). Remove 3/8 cap screws (D), lock nuts (E), pins (F), shipping brackets (G). Discard shipping brackets, retain hardware for further use. Remove bucket level indicator rod attached to oil lines for shipment.

3. Remove tie straps (H) from hydraulic hoses. Route hoses through hose loop (I) on inside of loader upright (refer to figure 3). Secure a hoist strap around the boom arm assembly or secure with a chain hook into hole (J), if so provided in underside of boom arm (see figure 3). If using a strap, the strap should be located around the boom arm in about the same location as the chain shown in figure 4. Be sure to keep strap under the oil lines on the right side of the boom.

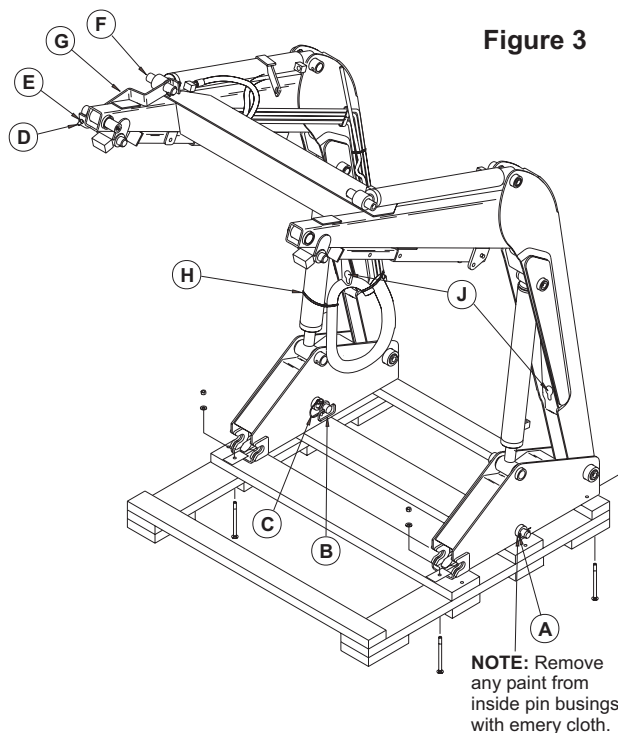
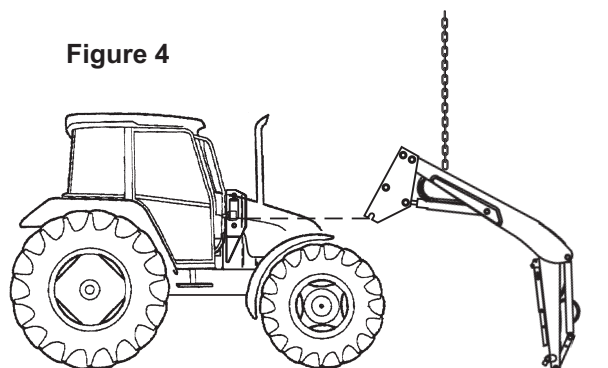

Figure 3

Raise loader with overhead hoist as shown in figure 4.

Figure 4





WARNING: Loader must be supported before removing hardware securing loader to the shipping pallet, or the loader will tip over.

MOUNTING 4211-MSL LOADER (Figures 5, 6 & 7)



WARNING: To avoid injury during installation of quick attach loader, do not permit bystanders within ten feet of loader.



WARNING: To avoid injury during installation of quick attach loader, an overhead hoist must be used for initial mounting. Parking stands are not operational without attachment mounted.

1. Loop hoist strap or chain around crossmember (see figure 5A). Using overhead hoist to support loader, remove shipping angle braces (C) (figure 6) by removing 1/2" lock nut (A), lift off brace (C), then replace 1/2" lock nut (A). **NOTE:** There is an additional 1/2" flat washer on outside of brace for

Figure 5

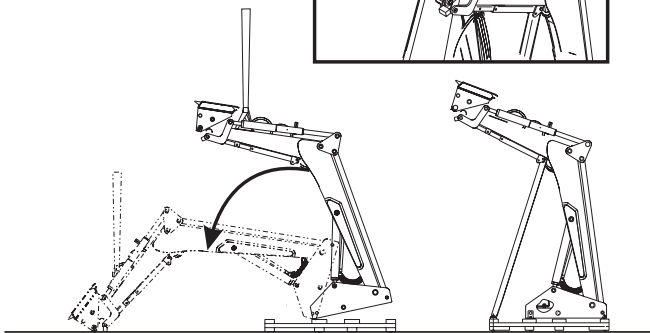
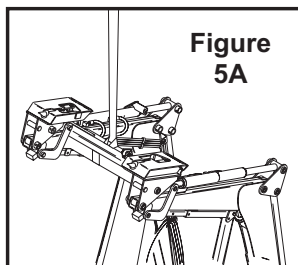

shipping only, remove and discarded with shipping angle brace.

NOTE: Do not over tighten lock nut (A). Parking stand tube must pivot freely.

Remove remaining hardware (D) from shipping braces (C) and discard braces and hardware.

Remove cotter pins (E), hitch pins (G) and lynch pins (F)(see figure 6). Discard only the cotter pins.

Then remove nuts and washers (D) from bolts securing loader to pallet.

2. Lower loader from vertical shipping position to horizontal position (figure 5) (Loader may require slight push to start lowering). Packaging hardware

Figure 6

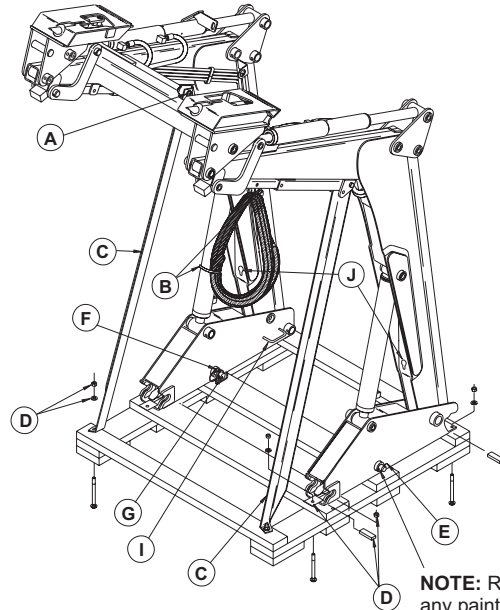

NOTE: Remove any paint from inside pin bushings with emery cloth.

may bend during lowering process, which is acceptable. Remove bucket level indicator rod attached to oil lines for shipment.

3. Remove tie straps (B) from hydraulic hoses. Route hoses through hose loop (I) on inside of loader upright (refer to figure 6). Secure a hoist chain hook into hole (J) provided in boom underside (refer to figures 6 & 7).

Raise loader with overhead hoist as shown in figure 7.

Figure 7

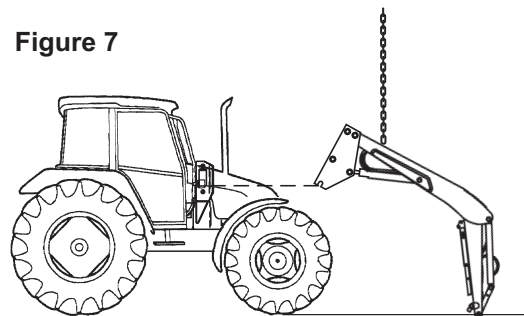

MOUNTING 4211-MSL & 4211 LOADERS (Cont.)

NOTE: Examine pin bushings and remove any paint with emery cloth before mounting loader (see figures 1, 3 & 6).

NOTE: Before continuing mounting procedure, lubricate loader as instructed in loader manual.

4. A) Remove male couplers from the ends of the hoses supplied with the loader. Install 90° fittings (10) onto hoses and male couplers onto 90° fittings using thread tape on pipe threads to seal. DO NOT overtighten.

B) Park tractor next to loader so right side of tractor cab window is parallel with rear of loader upright. Attach colored spiral bands to tractor female couplers to identify hoses (Refer to Figure 9). Attach lift cylinder function hoses (color coded green and yellow) to corresponding tractor couplers. Retract lift cylinders fully and continue to activate control lever for approximately 10 seconds.

NOTE: Important to attach lift cylinder hoses (yellow and green spiral band coded) for loader to function properly.

Extend lift cylinders about 2" from the fully closed position. Shut off tractor and disconnect hydraulic hoses.

Position tractor directly behind loader. Slowly raise loader with overhead hoist until loader upright will clear tractor front tires.

5. Move tractor forward until loader upright saddles are centered over mounting shaft. Lower loader with overhead hoist until upright saddle straddles mounting shaft.

Figure 8

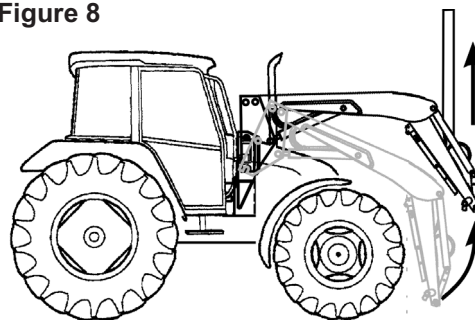

6. Remove hoist chain or strap from loader boom and secure around front crossmember (Refer to Figure 8). Using overhead hoist raise front of loader to rotate loader upright into mounting pocket. Continue to rotate loader upright until upright has fully rotated into back of mounting guide. Insert two 1x 7-3/4 pins and lynch pins which were removed from loader uprights in step 1, to secure loader to loader mountings.
7. Connect hoses to tractor hydraulics.
8. Start engine and slowly cycle cylinders several times to purge air from hydraulic system. Replenish hydraulic system.
9. Adjust front wheel tread settings or steering stops, if necessary to provide a minimum 3/4 inch clearance between front tires and any part of loader with lift cylinders fully retracted and front axle fully oscillated. Be sure lift cylinders are fully retracted. Refer to tractor operator's manual for tread setting and steering stop adjustment procedures.

INSTALLING BUCKET OR ATTACHMENT

Refer to loader operator's manual to install bucket or optional attachment.

ATTACH BUCKET LEVEL INDICATOR

Refer to instruction sheet and assembly manual with bucket or optional attachment.

GENERAL TORQUE SPECIFICATIONS

USE THE FOLLOWING TORQUES WHEN SPECIAL TORQUES ARE NOT GIVEN

Standard American and Metric Cap Screws

AMERICAN STANDARD CAP SCREWS									METRIC CAP SCREWS								
SAE Grade	5				8				Metric Class	8.8				10.9			
Typ. Head Markings									Typ. Head Markings								
Cap Screw	TORQUE				TORQUE				Cap Screw	TORQUE				TORQUE			
Size	FT-LBS		N-m		FT-LBS		N-m		Size	FT-LBS		N-m		FT-LBS		N-m	
Inches	MIN	MAX	MIN	MAX	MIN	MAX	MIN	MAX	Millimeters	MIN	MAX	MIN	MAX	MIN	MAX	MIN	MAX
1/4 - 20	6.25	7.25	8.5	10	8.25	9.5	11	13	M6 x 1.00	6	8	8	11	9	11	12	15
1/4 - 28	8	9	11	12	10.5	12	14	16	M8 x 1.25	16	20	21.5	27	23	27	31	36.5
5/16 - 18	14	15	19	20	18.5	20	25	27	M10 x 1.50	29	35	39	47	42	52	57	70
5/16 - 24	17.5	19	23	26	23	25	31	34	M12 x 1.75	52	62	70	84	75	91	102	123
3/8 - 16	26	28	35	38	35	37	47.5	50	M14 x 2.00	85	103	115	139	120	146	163	198
3/8 - 24	31	34	42	46	41	45	55.5	61	M16 x 2.50	130	158	176	214	176	216	238	293
7/16 - 14	41	45	55.5	61	55	60	74.5	81	M18 x 2.50	172	210	233	284	240	294	325	398
7/16 - 20	51	55	69	74.5	68	75	92	102	M20 x 2.50	247	301	335	408	343	426	465	577
1/2 - 13	65	72	88	97.5	86	96	116	130	M22 x 2.50	332	404	450	547	472	576	639	780
1/2 - 20	76	84	103	114	102	112	138	152	M24 x 3.00	423	517	573	700	599	732	812	992
9/16 - 12	95	105	129	142	127	140	172	190	M27 x 3.00	637	779	863	1055	898	1098	1217	1488
9/16 - 18	111	123	150	167	148	164	200	222	M30 x 3.00	872	1066	1181	1444	1224	1496	1658	2027
5/8 - 11	126	139	171	188	168	185	228	251	<p>NOTE: These values apply to fasteners as received from supplier, dry or when lubricated with normal engine oil. They do not apply if special graphite or moly sulphide greases or other extreme lubricants are used.</p>								
5/8 - 18	152	168	206	228	203	224	275	304									
3/4 - 10	238	262	322	355	318	350	431	474									
3/4 - 16	274	305	371	409	365	402	495	544									
7/8 - 9	350	386	474	523	466	515	631	698									
7/8 - 14	407	448	551	607	543	597	736	809									
1 - 8	537	592	728	802	716	790	970	1070									
1 - 14	670	740	908	1003	894	987	1211	1337									

INSTALLATION INSTRUCTIONS