

Keep With Operator's Manual

TWO FUNCTION HOSE KIT TO TRACTOR REAR REMOTE VALVES 5211 LOADER

MODEL	Model
Case IH	MX80C, MX90C, MX100C
McCormick	MC90, MC100, MC115

HOSE KIT GENERAL INFORMATION

Hose kit can be installed on tractor and loader using tools ordinarily available. Shut off engine, engage brakes, and remove key during installation.

IMPORTANT: Check for proper tractor valve operation before plumbing loader to tractor. See tractor operator's manual for instructions.

NOTE: Apply sealant only to all tapered threads unless coupled with swivel adapters. When using teflon tape, wrap tape clockwise (as viewed from end) and wrap only twice. Keep sealant away from first two threads of tapered end to prevent contamination of hydraulic fluid. Do not use sealant on o-ring or flare adapter fittings.



WARNING: Escaping hydraulic fluid under pressure can penetrate the skin causing serious injury.

- DO NOT use your hands to check for leaks. Use a piece of cardboard or paper to search for leaks.
- Stop engine and relieve pressure before connecting or disconnecting lines.
- Tighten all connections before starting engine or pressurizing lines.

If any fluid is injected into skin, obtain medical attention immediately or gangrene may result.

PLUMBING LOADER TO REAR REMOTE VALVE (Figure 1)

1. Starting at bottom and working upward, install female end of 1/2 x 170" hose (1) onto oil line tubes.
2. Install 5/8" diameter color coded bands (14, 15, 16 & 17) onto female ends of hoses (1), attached to boom oil line tubes, in sequence as shown in figure 1.

NOTE: Hose with blue band attaches to bucket cylinder base (BCB) oil line tube. Hose with red band attaches to bucket cylinder rod (BCR) oil line tube. Hose with yellow band attaches to lift cylinder rod (LCR) oil line tube. Hose with green band attaches to lift cylinder base (LCB) oil line tube.

3. Slide nylon sleeve (2) over 1/2 x 170" hoses (1). Position sleeve as close to boom oil lines as possible, covering hose crimps.
4. Install color coded dust caps (10, 11, 12 & 13) onto male ends of hoses, taking care to be sure color coding corresponds between dust cap and spiral band on each hose.
5. Install male couplers (5) onto male ends of 1/2 x 170" long hoses (1).

NOTE: Cap male couplers (5) with color coded dust caps (10, 11, 12 & 13) when not connected.

6. Attach loader hoses (1) with male couplers (5) and color coded dust caps to tractor rear remote couplers. Refer to tractor operator's manual for function of each rear port. Install 1" color code spiral bands (6, 7, 8 & 9) to tractor rear remote couplers.

**PLUMBING LOADER TO REAR REMOTE VALVE
(Figure 1) (Continued)**

WARNING: For proper loader function, operate loader only from approved valves. When plugging couplers into tractor remote coupler, be sure to connect the hoses (blue & red coded) from the upper two boom oil lines to the tractor remote couplers controlled by the valve which is to control rotation of bucket or attachment (tilt). Be sure to connect hoses from lower two boom oil lines (yellow & green coded) to tractor remote couplers controlled by the valve which is to raise and lower the boom (lift). This will ensure proper function of loader.

7. Use 1/2 x 20" adjustable plastic straps (4) and tarp strap (3) to bundle hoses together and secure hoses to tractor at approximately equal distances along length of hoses to avoid interference with moving parts.

8. After all plumbing has been completed, slowly cycle lift and tilt cylinders several times to purge air from hydraulic system. Retract cylinders and shut off engine. Add additional tractor hydraulic fluid as specified in tractor operator's manual to bring level of hydraulic fluid up o full.

NOTE: When cycling loader, operate control lever (s) according to functioning desired. If direction of a control lever is wrong, exchange quick coupler connections for rear remote ports controlled by that lever.



WARNING: Escaping hydraulic fluid under pressure can penetrate the skin causing serious injury.

- DO NOT use your hands to check for leaks. Use a piece of cardboard or paper to search for leaks.
- Stop engine and relieve pressure before connecting or disconnecting lines.
- Tighten all connections before starting engine or pressurizing lines.

If any fluid is injected into skin, obtain medical attention immediately or gangrene may result.

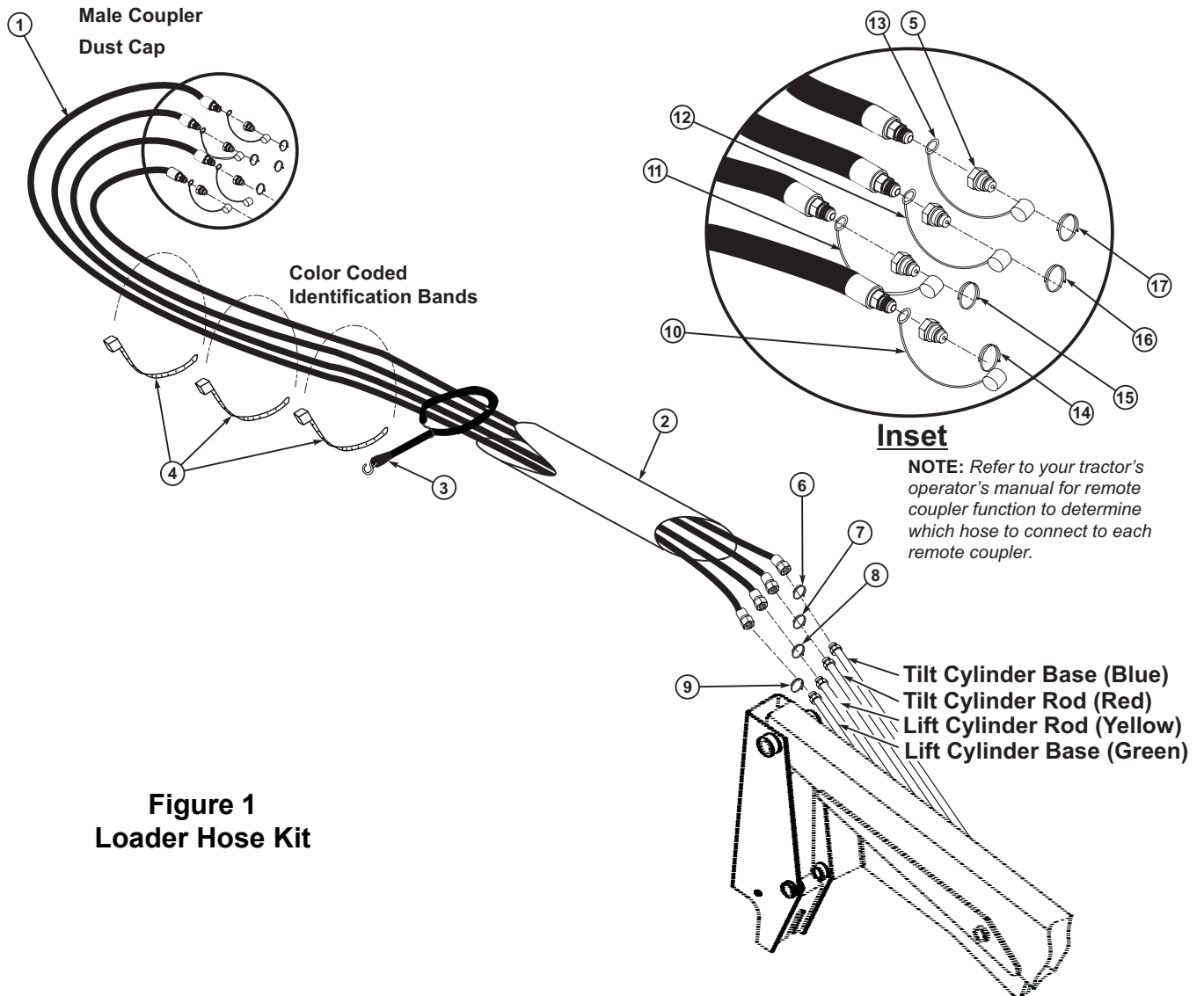

Figure 1
Loader Hose Kit

PARTS LIST – HOSE KIT

Item	Part No.	Description	Qty.
1	48794-3	HOSE, 1/2 I.D. x 170" Long	4
2	34853-3	SLEEVE, Nylon Hose, 60" Long	2
3	7438-1	STRAP, Rubber Tie	2
4	8137-3	STRAP, Plastic Tie, 1/2" x 20"	3
5	6137-13	COUPLER, Male Quick	4
6	36240-9	BAND, Plastic Identification, 1" I.D., Blue	1
7	36240-10	BAND, Plastic Identification, 1" I.D., Red	1
8	36240-11	BAND, Plastic Identification, 1" I.D., Yellow	1
9	36240-12	BAND, Plastic Identification, 1" I.D., Green	1
10	4838-8	CAP, Dust, Blue	1
11	4838-3	CAP, Dust, Red	1
12	4838-9	CAP, Dust, Yellow	1
13	4838-10	CAP, Dust, Green	1
14	36240-5	BAND, Plastic Identification, 5/8" I.D., Blue	1
15	36240-6	BAND, Plastic, Identification, 5/8" I.D., Red	1
16	36240-7	BAND, Plastic, Identification, 5/8" I.D., Yellow	1
17	36240-8	BAND, Plastic, Identification, 5/8" I.D., Green	1

INSTALLATION INSTRUCTIONS