

Keep with Operator's Manual

GRILLE GUARD KIT FOR CASE IH AND NEW HOLLAND CLASS II AND CLASS III TRACTORS

CASE IH MODELS	NEW HOLLAND MODELS
D25, DX25, D29, DX29	TC25, TC25D, TC29, TC29D, TC29DA
D33, DX33, D35, DX35	TC33, TC33D, TC33DA, TC35, TC35A, TC35D, TC35DA
D40, DX40, D45, DX45	TC40, TC40A, TC40D, TC40DA, TC45, TC45A, TC45D, TC45DA
	1530, 1630, 1725, 1925

TRACTOR & GRILLE GUARD GENERAL INFORMATION

Grille guard can be installed on tractor using tools ordinarily available, including standard wrenches and a torque wrench. Shut off engine and engage brakes during installation.

Grille guard is designed to be compatible with with 2407TL, 2407FL, 2408TL & 2408FL mid mounted loaders, New Holland 14LA, 15LA, 16LA & 17LA, and Case IH LX114 & L116 loaders on all Case IH and New Holland class II and class III tractors.

INSTALLING GRILLE GUARD (Figure 1)

NOTE: Install all attaching hardware loose until grille guard is completely assembled to facilitate assembly and proper alignment. Unless otherwise specified, tighten all hardware to torques specified in General Torques Specification table when assembly is complete.

- Place spacer plates (7) between grille guard mounting plates (6) and sides of tractor front frame and fasten grille guard mounting plates (6) and spacer plates (7) to sides of tractor front frame using 1/2 x 2-3/4" cap screws (11) and lock nuts (12).

NOTE: If grille guard is to be mounted on a tractor with 14LA, 15LA, or LX114 loader, use 1/2 x 3-1/2" cap screws (5), 1/2" hardened washers (provided with loader) and lock nuts (12). Refer to figure 1A.

- Position bottom of grille guard bumper (1) between mounting plates (6) and fasten grille guard bumper (1) to mounting plates (6) using 5/8 x 1-3/4" carriage bolts (8) and 5/8" lock nuts (9).

NOTE: Install 5/8 x 1-3/4" carriage bolts (8) with heads to center of grille guard, outward through square holes of bumper (1) as shown. Install 5/8" top lock lock nuts to outside of mounting plates, with locking nylon insert to the outside, as shown.

Tighten 5/8" lock nuts (9) onto carriage bolts (8) to no more than 139 ft.·lbs. torque, then loosen only enough to allow grille guard bumper (1) to pivot in mounting plates (6).

- To enhance grille guard latch operation, apply a light coating of grease to inside of slotted holes for latch bar (2) in upright plates of grille guard bumper (1) and apply a light coating of grease to top surface of mounting plates (6) where latch bar (2) will be in contact as bumper is swung into or out of latched position.
- Swing grille guard bumper (1) upward into latched position.
- Tighten 1/2 x 2-3/4" cap screws (6) and lock nuts (12) to 67 ft.·lbs. torque. If grille guard is mounted on tractor with 14LA, 15LA, or LX114 loader, refer to assembly instructions provided with loader to tighten 1/2 x 3-1/2" cap screws (5) and lock nuts (12).

NOTE: Lift latch bar against spring pressure to release latch. Lower grille guard before opening tractor hood.

IMPORTANT: Swing grille guard back up and latch into place before operating tractor or loader.

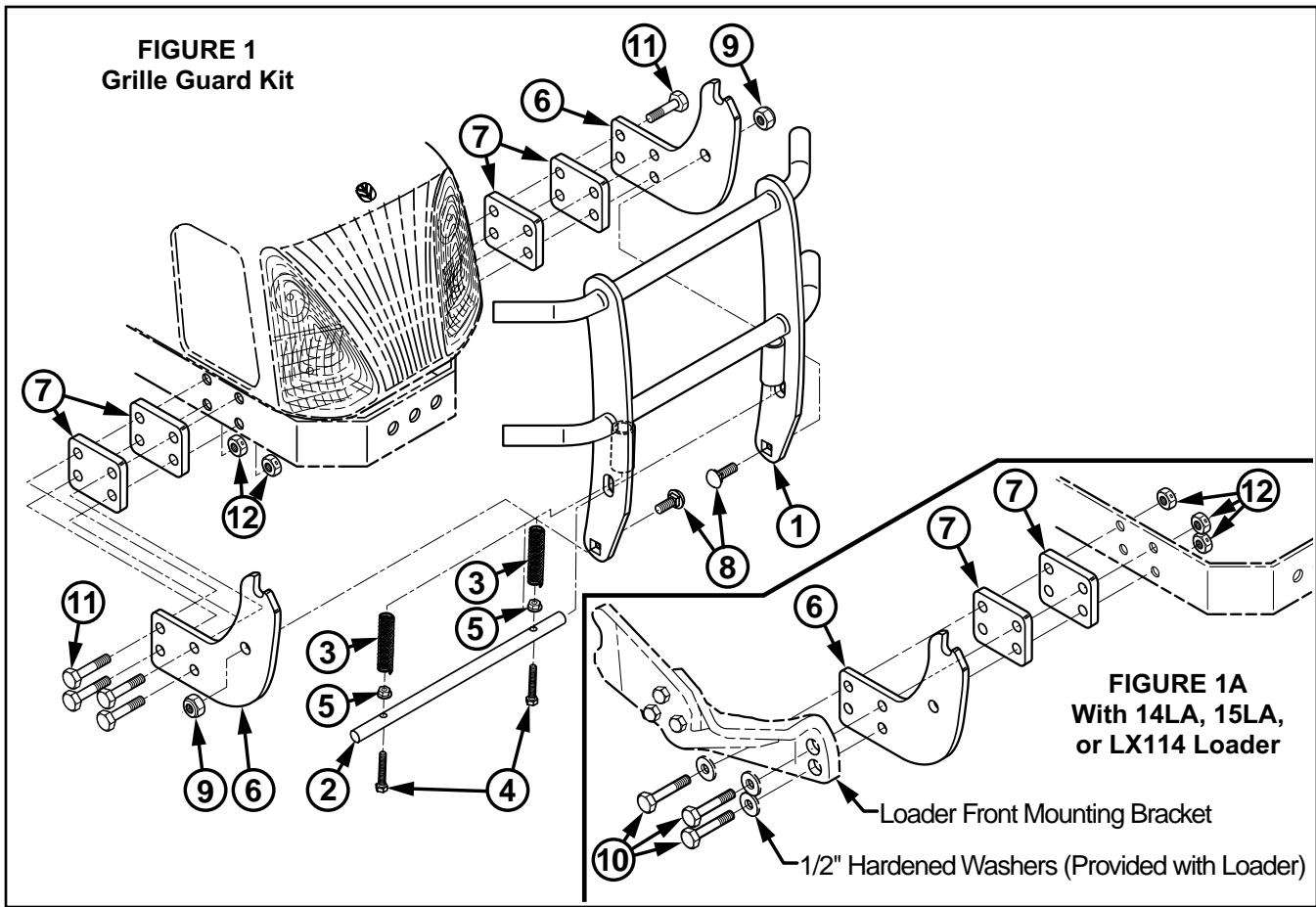

PARTS LIST – GRILLE GUARD KIT

Item	Part No.	Description	Qty.
1	52061	GRILLE GUARD, Bumper	1
*2	52065	BAR, Latch, Grille Guard	1
*3	6043-27	SPRING, Compression, .73 O.D. x 3.69" Long, Grille Guard Latch	2
*4	41838-89	SCREW, Cap, 5/16-18 x 2"	2
*5	42848-3	NUT, Flange Head, 5/16-18 Full Thread	2
6	52062	PLATE, Mounting, Grille Guard	2
7	51278	PLATE, Spacer, Grille Guard, 1/2"	4
8	41839-13	BOLT, Carriage, 5/8-11 x 1-3/4"	2
9	48338-1	NUT, Lock, 5/8-11, Nylon Insert (top lock)	2
10	41838-66	SCREW, Cap, 1/2-13 x 3-1/2" Grade 5	6
11	41838-73	SCREW, Cap, 1/2-13 x 2-3/4" Grade 5	8
12	42840-5	NUT, Lock, 1/2-13, Type N (center lock)	8

* Items preassembled with Grille Guard Bumper (1)

INSTALLATION INSTRUCTIONS