

Keep with Operator's Manual

LOADER MOUNTING KIT

2408 LOADER

CASE IH & NEW HOLLAND CLASS II TRACTORS

CASE IH MODEL	NEW HOLLAND MODEL	2WD	FWA	SUPERSTEER
D25, DX25	TC25	X	X	X
D29, DX29	TC29, TC29D, TC29DA	X	X	X
D33, DX33	TC33, TC33D, TC33DA	X	X	X
	1530, 1630, 1725, 1925	X	X	

Mounting brackets can be installed using tools ordinarily available.

NOTE: Leave all hardware loose until loader is completely assembled to facilitate alignment. Torque hardware to specifications listed in loader manual.

INSTALLING MOUNTING BRACKETS

1. Install front mounting brackets (3 & 4) to tractor frame using 1/2 x 1-3/4 cap screws (5) and 1/2 lock nuts (6).

NOTE: If tractor is equipped with mid remotes, remove and discard 1/2 spacer and sandwich right mid mounting bracket (2) between remote bracket and tractor casting. Use existing hardware to mount remote bracket (Figure 1A).

2. Install mid mounting brackets (1 & 2) to tractor transmission casting using 16mm x 45mm cap screws (8) and 5/8 lock washers (7). Use four or six cap screws per side, depending on number of threaded holes in tractor mounting pads.

3. **STD. FWA OR 2WD Only** - Support front of tractor and remove 14mm bolts holding rear of front axle casting to tractor frame. Fasten loader mid mounting brackets (1 & 2) in these holes using 14mm-1.50 x 55mm cap screws (10) and 9/16 lock washers (12)

SUPERSTEER Only - Remove forward 4 bolts fastening engine block to frame (NOTE: On right side remove steel pressure line on hydraulic pump). Using Loctite® (medium strength), install support flat (9) at these holes using 14mm-1.50 x 50mm class 10.9 (13) and 9/16 lock washers (12). Torque these bolts from 86 to 109 ft. lbs. Fasten loader mid mounting brackets (1 & 2) to these plates using 14mm-1.50 x 55mm cap screws (10), 14mm-1.50 hex nuts (11) and 9/16 lock washer (12). Reinstall hydraulic pressure line.

LOADER MOUNTED WITH 914A BELLY MOWER

Do not use 3/8" spacer between mower pivot-up stop plates and loader mountings. If necessary, for proper alignment shim between mower front lift brackets and pivot-up stop plate with 1/8 thick 3/4" flat washer.

INSTALLING LOADER

1. Attach nylon sling to bumper and use overhead hoist to support loader while removing pallet from loader

NOTE: Some loader hardware is used to attach loader to pallet. After removing loader from pallet reinstall hardware to same location on loader.

2. Loop nylon slings around loader boom. Remove hinge clamping hardware.
3. Using overhead hoist, raise loader over front mounting bracket. Slide loader to rear until side frames rest on mid mounting bracket tubes.

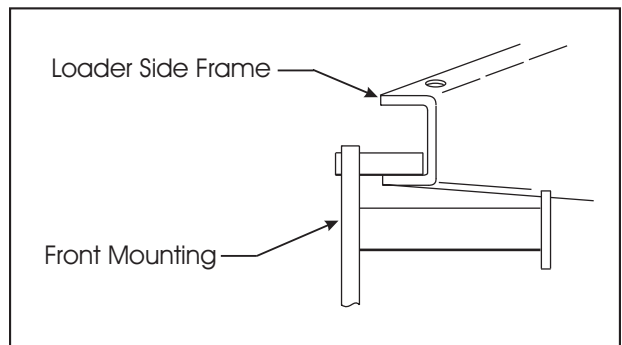

NOTE: Lower lip of loader side frame channel must be between front mounting tubes.

4. Clamp hinges around mid mounting bracket tubes using hardware provided.
5. Refer to plumbing kit instructions to complete loader installation.

2-7405

Figure 1
Installing Loader
Mounting Brackets

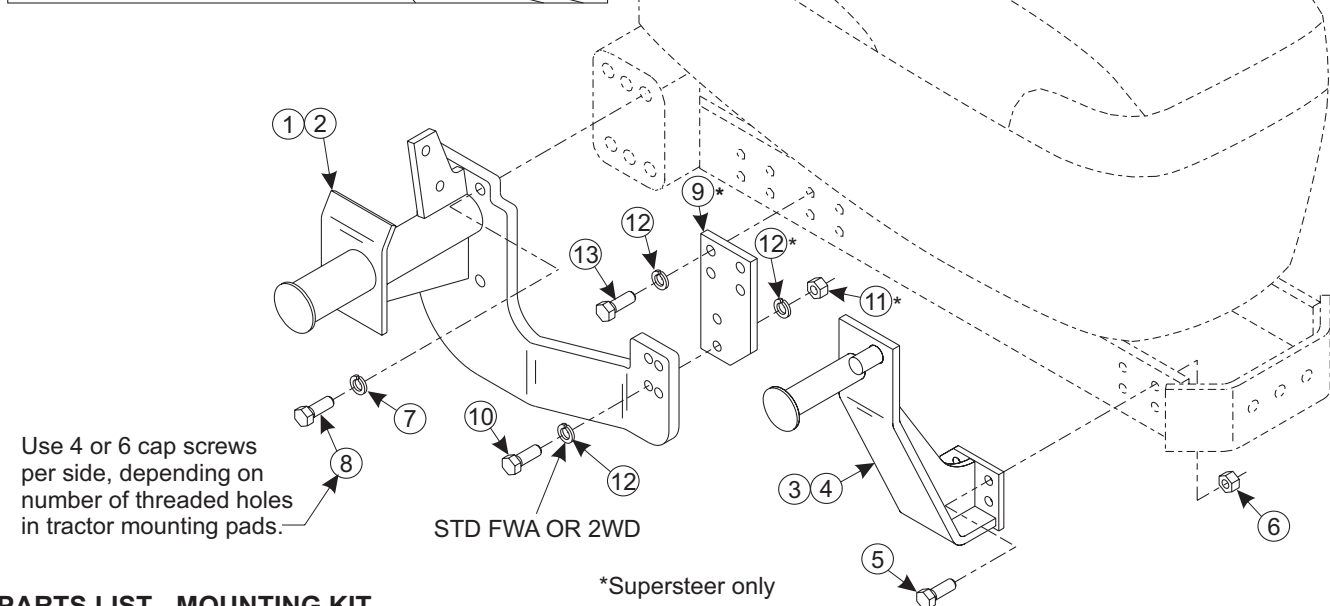
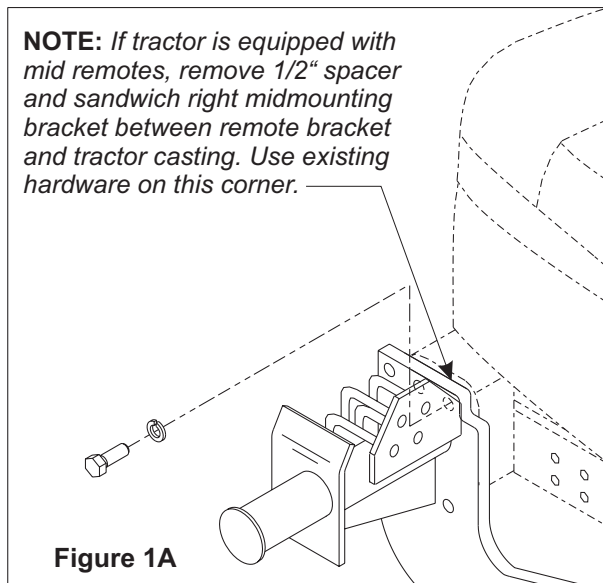

PARTS LIST - MOUNTING KIT

ITEM	PART No.	DESCRIPTION	QTY.
1	52144	BRACKET, Mounting, Mid, Left	1
2	52143	BRACKET, Mounting, Mid, Right	1
3	45520-1	BRACKET, Mounting, Front, Left	1
4	45520-2	BRACKET, Mounting, Front, Right	1
5	41838-12	SCREW, Cap, 1/2-13 x 1-3/4"	8
6	41840-5	NUT, Lock, 1/2-13	8
7	41837-7	WASHER, Lock, 5/8"	12
8	42672-21	SCREW, Cap, 16mm-2.0 x 45mm	12
9	49408	SPACER, Flat (SuperSteer only)	2
10	42672-22	SCREW, Cap, 14mm-1.50 x 55mm	4
11	26457-1	NUT, Hex, 14mm-1.50 (SuperSteer only)	4
12	41837-6	WASHER, Lock, 9/16"	12
13	49040-5	SCREW, Cap, 14mm-1.50 x 50mm, Class 10.9 (SuperSteer only)	8

INSTALLATION INSTRUCTIONS