

GRILLE GUARD KIT KUBOTA TRACTORS

TRACTOR MODEL	LESS LOADER	WITH COMPATIBLE LOADER		
		2408TL	2408FL	2409
L2800	X	X	X	X
L3400	X	X	X	X

TRACTOR & GRILLE GUARD GENERAL INFORMATION

Grille guard can be installed on tractor using tools ordinarily available, including standard wrenches and a torque wrench. Shut off engine and engage brakes during installation.

Grille guard can be installed on tractor without a loader. It is also designed to be compatible with 2408TL, 2408FL and 2409 loaders.

NOTE: Install all attaching hardware loose until grille guard is completely assembled to facilitate assembly and proper alignment. Unless otherwise specified, tighten all 14mm-1.50 hardware to 120N·m (88.5 ft.·lbs.); tighten all 1/2" hardware to 65-72 ft.·lbs.

INSTALLING GRILLE GUARD ONTO TRACTOR WITHOUT LOADER OR WITH 2408TL OR 2408FL LOADER (Figure 1)

1. Remove front cover from front of tractor frame.
2. Remove lower 14mm bolts from side frame which secure front steering linkage.
IMPORTANT: Do not remove top 14mm bolts.
3. Place spacer plate (3) between grille guard (1) and front frame of tractor. Loosely install using 14mm x 50mm cap screws (6), and 9/16" lock washers (9).

4. Place round spacers (4) between sides of tractor frame and side plates of grille guard (1). Fasten side plates of grille guard (1) and round spacers (4) to sides of tractor frame using 14mm x 75mm cap screws (5), 9/16" flat washers (10), and 9/16" lock washers (9).
5. Fasten cover plate (2) to front of tractor frame using 14mm x 30mm cap screws (7) and 9/16" lock washers (9) in lower pair of holes, and 1/2 x 1-1/4" cap screws (8) and lock nuts (11) in upper pair of holes.

INSTALLING GRILLE GUARD ONTO TRACTOR WITH 2409 LOADER (Figure 1)

1. Remove upper 14mm cap screws from loader front mounting plate.
2. Remove lower 14mm bolts from side frame that secures front steering linkage.
IMPORTANT: Do not remove upper 14mm bolts.
3. Install grille guard (1) by placing it over loader front mounting plate and fasten it to tractor frame loosely using 14mm x 50mm cap screws (6) and 9/16" lock washers (9).
4. Place round spacers (4) between sides of tractor frame and side plates of grille guard (1). Fasten side plates of grille guard (1) and round spacers (4) to sides of tractor frame using 14mm x 75mm cap screws (5), 9/16" flat washers (10), and 9/16" lock washers (9).

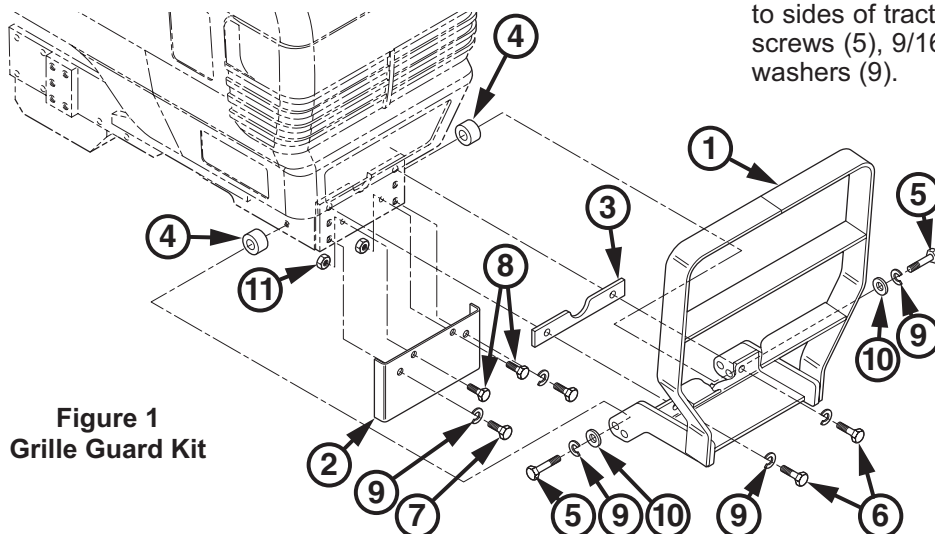
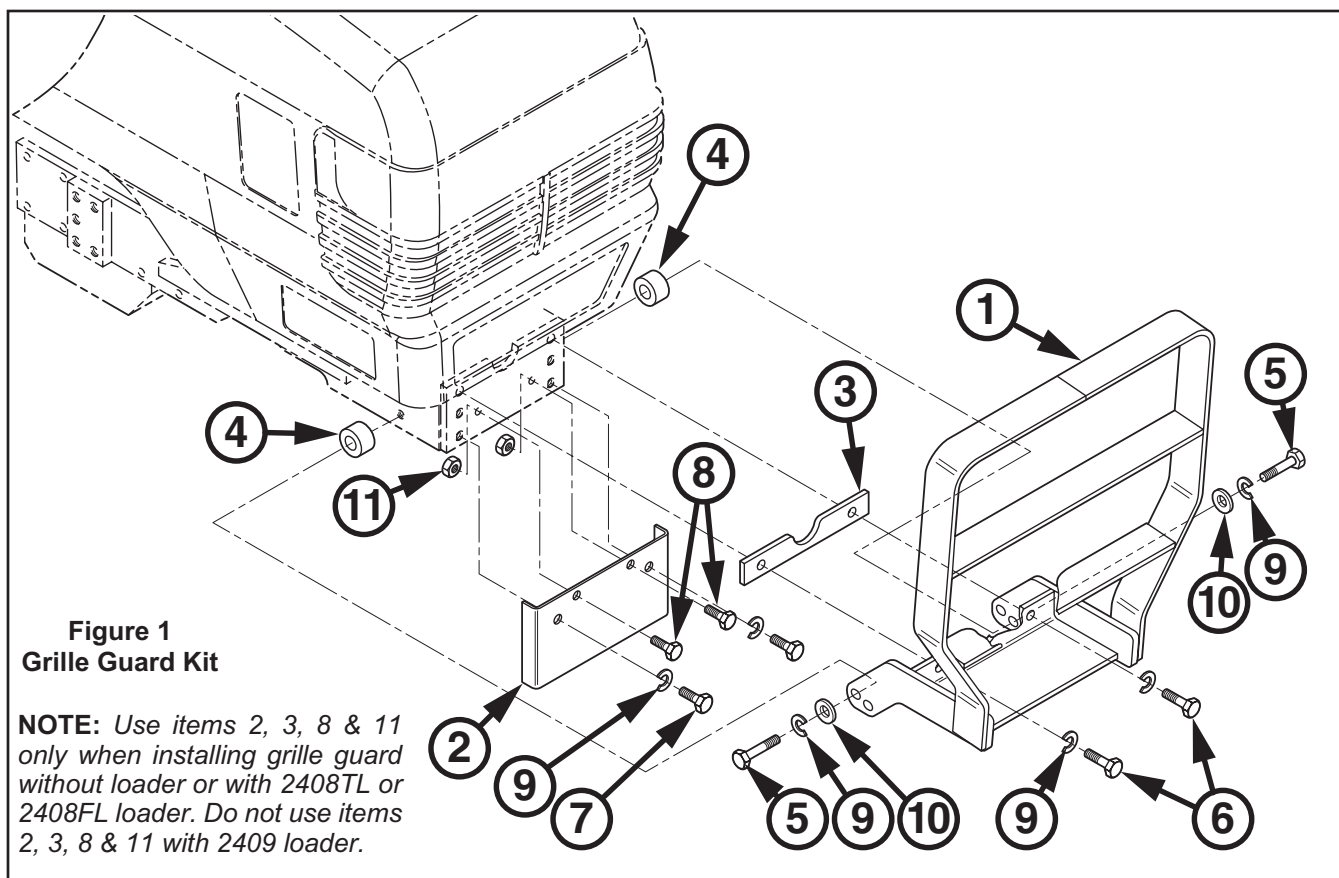

Figure 1
Grille Guard Kit

NOTE: Use items 2, 3, 8 & 11 only when installing grille guard without loader or with 2408TL or 2408FL loader. Do not use items 2, 3, 8 & 11 with 2409 loader.



PARTS LIST – GRILLE GUARD KIT

Item	Part No.	Description	Qty.
1	52326	GRILLE GUARD	1
2	52330	COVER, Plate	1
3	50928	SPACER, Plate	1
4	43395-7	SPACER, Round	2
5	42672-87	SCREW, Cap, 14mm-1.50 x 75mm, Class 8.8	2
6	42672-58	SCREW, Cap, 14mm-1.50 x 50mm, Class 8.8	2
7	42672-32	SCREW, Cap, 14mm-1.50 x 30mm, Class 8.8	2
8	41838-2	SCREW, Cap, 1/2-13 x 1-1/4", Grade 5	2
9	41837-6	WASHER, Lock, 9/16"	6
10	42502-11	WASHER, Flat, 9/16"	2
11	41840-5	NUT, Lock, 1/2-13, Type N	2

INSTALLATION INSTRUCTIONS