

Keep with Operator's Manual

**LOADER MOUNTING KIT  
2407TL LOADER  
KIOTI TRACTORS**

MODEL	FWA
CK25, CK25HST	X
CK30, CK30HST	X

**TRACTOR & MOUNTING KIT GENERAL INFORMATION**

Mounting brackets can be installed on tractor and loader using tools ordinarily available, including an overhead hoist with sling, standard and metric wrenches, a long socket extension, and a torque wrench.

Hose kit to tractor loader control valve is required to plumb loader to tractor. It must be installed as part of initial loader mounting, but after loader mounting brackets have been installed. Instructions are provided in "Installing Loader to Mounting Brackets" section and with hose kit.

This mounting kit is compatible with optional grille guard kit. If grille guard is to be installed, it may be installed before or after installing loader mounting brackets or mounting loader.

This mounting kit is compatible with Kioti mid mounted mower. Also compatible with Rhino, Schulte, or SMC model 65A backhoe.

Loader mid mounting brackets (1 & 2) can be installed more easily if tractor hood side panels are removed from tractor before installing mid mounting brackets.

Check tire clearances when loader installation is complete and adjust tractor tread width or steering stops, if necessary, to provide adequate tire clearance.

Shut off tractor engine and engage tractor brakes during installation.

**INSTALLING LOADER MOUNTING BRACKETS (Figure 1)**

**NOTE:** Leave all attaching hardware loose until mounting brackets are completely assembled to facilitate assembly and proper alignment. Tighten all hardware to torques specified in general torque specifications table.

1. Fasten rear of left mid mounting bracket (1) to tractor transmission casting using 14mm x 35mm cap screws (4) and 9/16" lock washers (7), and to tractor frame using 12mm x 35mm cap screws (5) and 1/2" lock washers (8).
2. Remove inspection cover from right side of tractor clutch housing. Fasten rear of right mid mounting bracket (1) to tractor transmission casting using 14mm x 35mm cap screws (4) and 9/16" lock washers (7), and to tractor frame using 12mm x 35mm cap screws (5) and 1/2" lock washers (8).
 

**NOTE:** One 14mm x 35mm cap screw (4) with lock washer (7), each side, must be installed into tractor transmission casting through access hole in mid mounting brackets (1 & 2). Use socket extension if necessary.
3. Tighten 14mm-1.50 cap screws (4) to 137ft.·lbs. torque, and tighten 12mm-1.25 cap screws (5) to 94ft.·lbs. torque.
4. Insert 2" diameter plastic plugs (10) into access holes in left and right mid mounting brackets (1 & 2).
5. Reinstall tractor hood side panels if removed for loader mounting bracket installation.

Figure 1  
Loader Mounting Kit

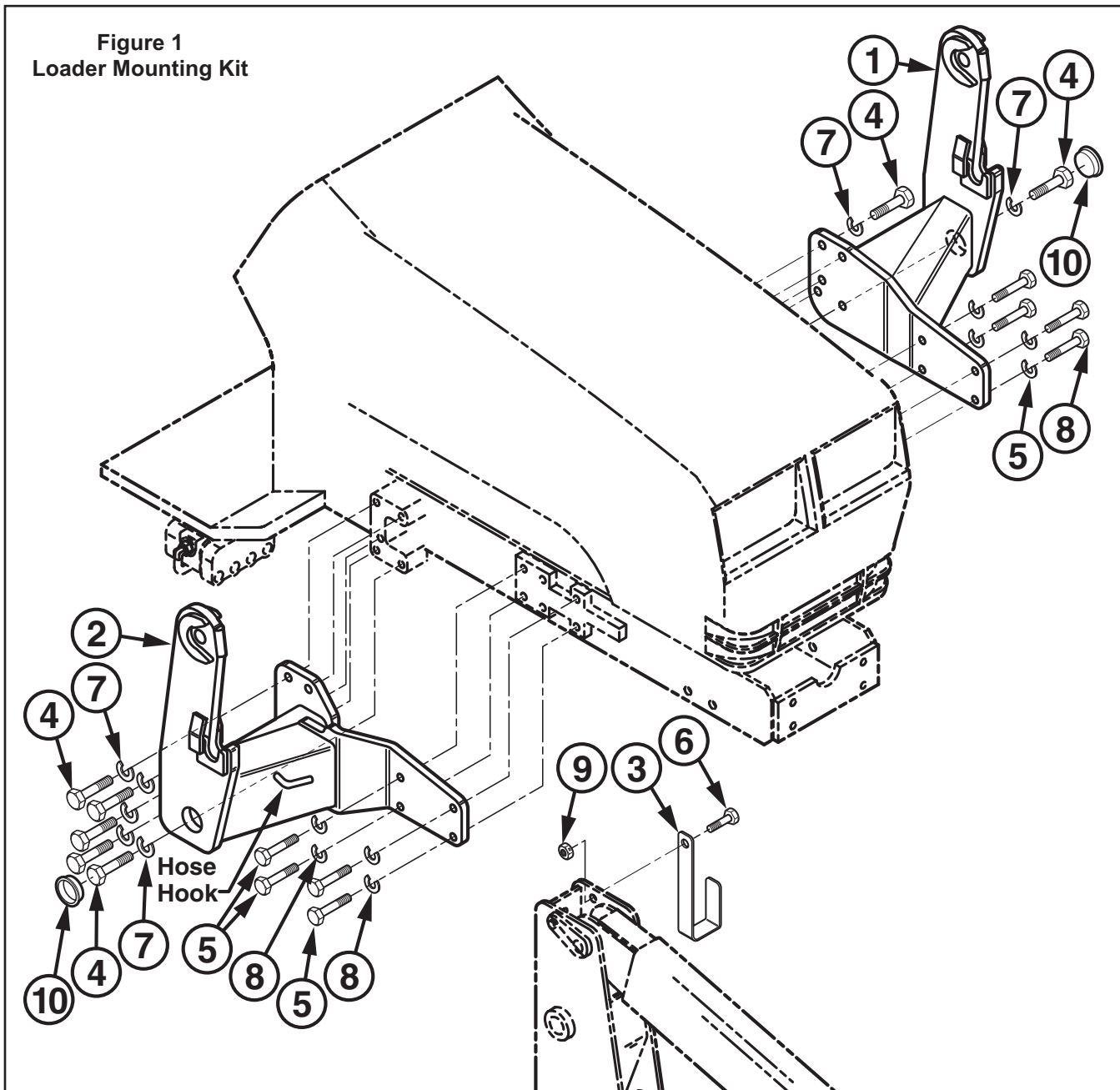

PARTS LIST – MOUNTING KIT

Item	Part No.	Description	Qty.
1	52681	BRACKET, Mounting, Mid, Left	1
2	52680	BRACKET, Mounting, Mid, Right	1
3	52685	HOOK, Hose Hanger	1
4	49040-18	SCREW, Cap, 14mm-1.50 x 35mm, Class 10.9	10
5	49040-17	SCREW, Cap, 12mm-1.25 x 35mm, Class 10.9	8
6	41838-21	SCREW, Cap, 3/8-16 x 3/4", Grade 5	1
7	41837-6	WASHER, Lock, 9/16"	10
8	41837-5	WASHER, Lock, 1/2"	8
9	41840-3	NUT, Lock, 3/8-16, Type N	1
10	27303-10	PLUG, Plastic, 2" Diameter x 1" Deep	2

**ATTACHING HOSE HANGER HOOK (Figure 2a)**

Fasten hose hanger hook (3) to left side of right loader upright, at hole provided near top of upright, using 3/8 x 3/4" cap screw (6) and lock nut (9).

**NOTE:** After loader is mounted, loop hoses over hose hanger (3) and over hook at front of right mid mounting bracket (2) to keep hoses from being damaged by lugs of tractor front tires. When dismantling loader from tractor, hoses must be unhooked from mid mounting hook and hose hanger (3) before dismantling.

**MOUNTING LOADER (Figures 2, 3, 4, 5, 6, 7 & 8)**

**WARNING:** Loader must be supported before removing hardware securing loader to shipping pallet or loader will tip over.



**WARNING:** To avoid injury during installation of loader, do not allow bystanders within ten feet of loader or attachment.



**WARNING:** To avoid injury during installation of loader, an overhead hoist must be used for initial mounting. Parking stands are not operational without bucket or heavy attachment mounted. (Bale spear or pallet fork alone do not provide enough weight.)

**MOUNTING LOADER (Continued)**

1. Loop chain or sling under each tilt cylinder, around loader outer knee plate and hook to each outer knee plate (see figure 3). Put slight tension on overhead hoist to prevent loader from tipping.
2. Temporarily remove linch pins (B) and hitch pins (A) (see figure 3) and keep with loader for securing loader uprights to mid mounting brackets later.
3. Remove 3/8" lock nuts (E) and flat washers (D) which fasten loader uprights to pallet and can be found inside uprights near top end. Remove 3/8" lock nuts (E) which fasten shipping angle brackets (G) to pallet. Remove 5/16" lock nuts (H) from u-bolts (J) to remove shipping angle brackets (G) from loader. Discard shipping brackets and hardware. Raise loader off pallet and remove pallet with bucket (see figure 3a).



**WARNING:** Loader uprights may rotate downward when loader is lifted from pallet.

4. Lower loader from vertical shipping position to horizontal, positioning scraps of cardboard on floor under loader to protect loader paint (see figure 3b).

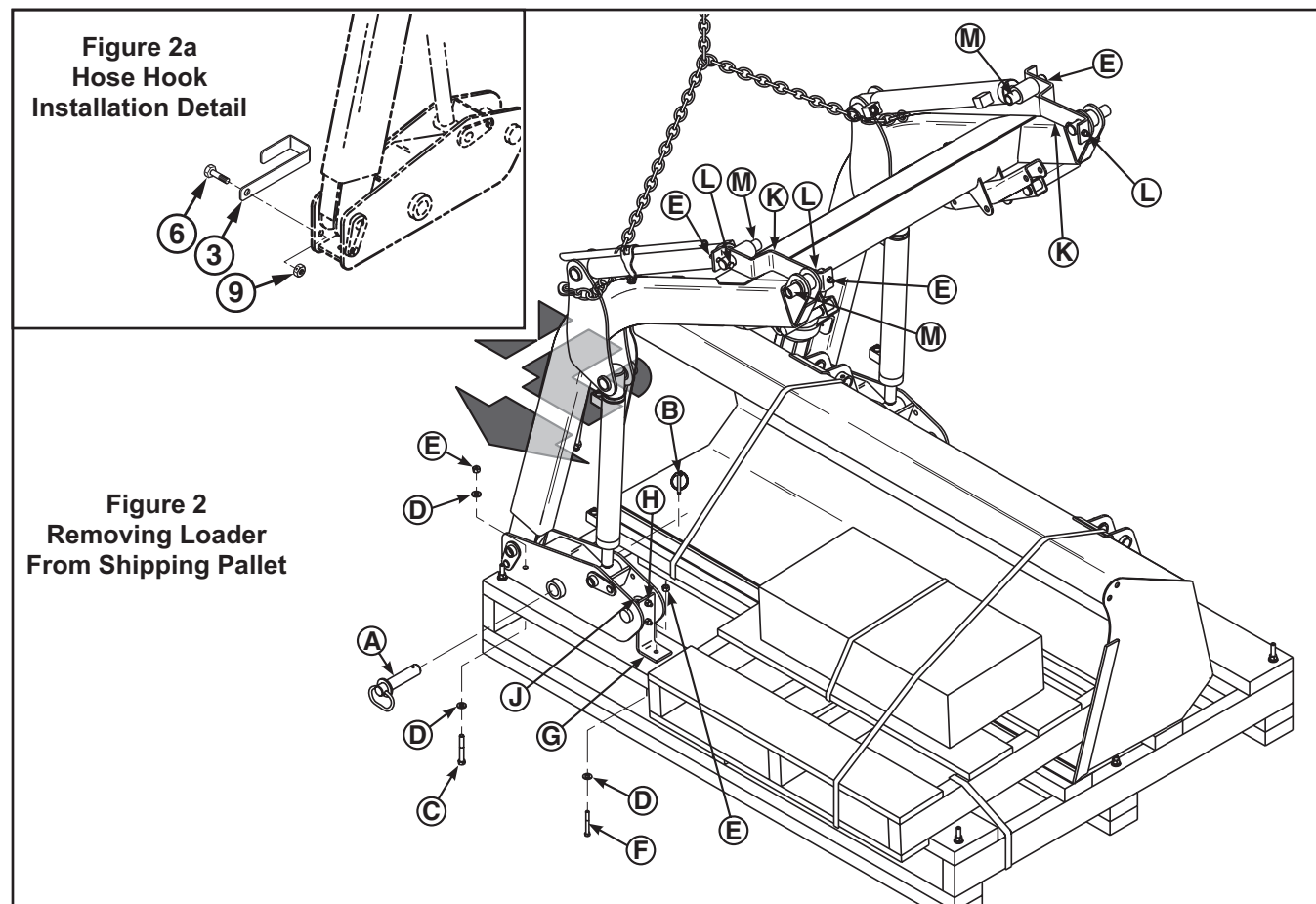

## MOUNTING LOADER (Continued)

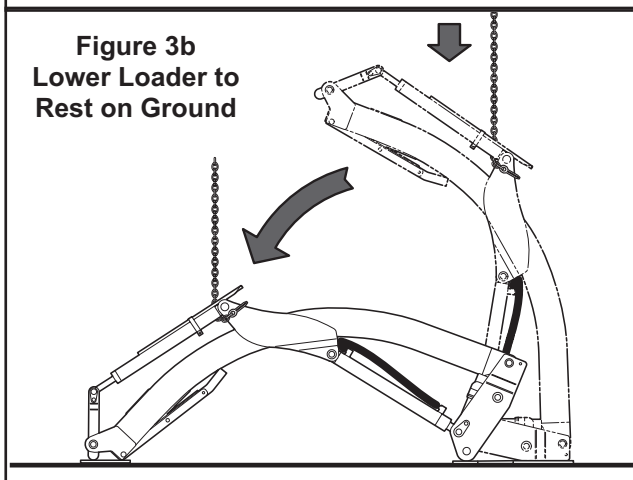
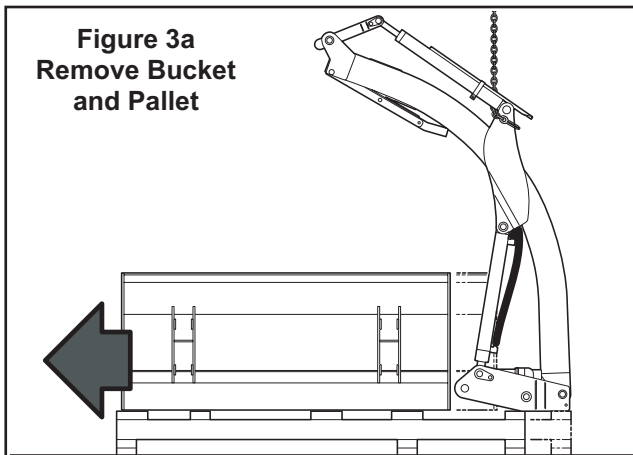

5. Install hydraulic plumbing for loader to tractor using hose kit for mid-mount valve, so all plumbing is completed except connecting quick couplers.
6. Secure a hoist strap around loader upper boom arms similar to figure 4. Slowly raise loader with overhead hoist until loader upright will clear tires (see figure 4).

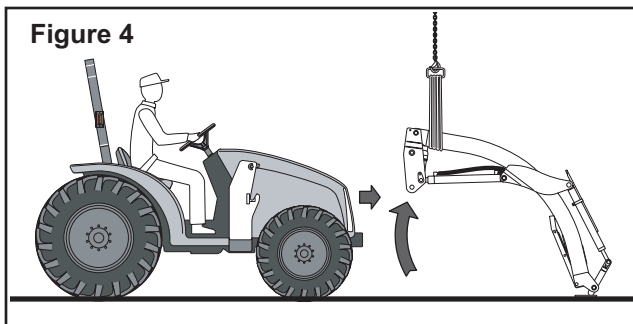

7. Drive tractor into loader until uprights of loader mounting brackets are within 12" or 18" of loader uprights. Shut off engine. Attach lift cylinder function hoses (color coded green and yellow) to corresponding tractor valve couplers. Route hoses under loader right mid mounting bracket.

**NOTE:** It is important to attach lift cylinder hoses (coded with yellow and green bands for loader to function properly. Do not connect boom oil line hoses for tilt cylinder control at this time. Connect these after shipping brackets are removed from attachment pin hubs in instruction 12).

8. Start tractor engine. Retract lift cylinders fully and continue to activate control lever for approximately 10 seconds. Cycle cylinders several times to remove air. Extend lift cylinders four or five inches from the fully closed position to ensure loader upright pin will be first part of loader upright to make contact with stop surface of loader mounting brackets. Shut off engine and set brakes.

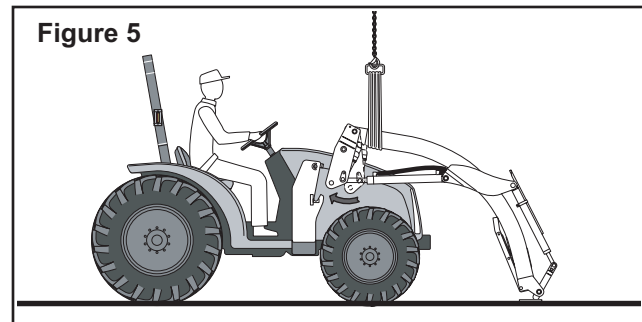

9. With overhead hoist, position loader upright pin to clear mount pin saddle by 1" (see figure 6). Start tractor engine and move tractor forward until both loader upright pins come to rest against flat vertical stop surface of both mounting brackets. Shut off engine and set brakes.

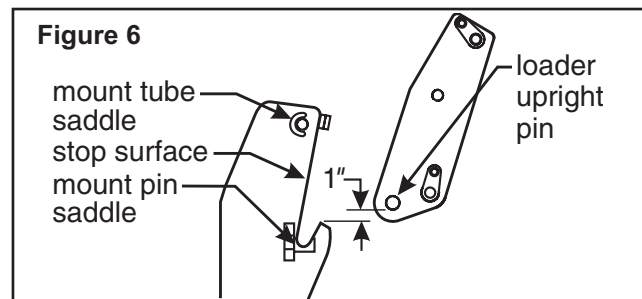

10. Lower loader with overhead hoist until both loader upright pins rest into mount pin saddles. Start tractor engine and retract lift cylinders, rotating loader uprights until uprights are fully seated into back of mount tube saddles (see figure 7).

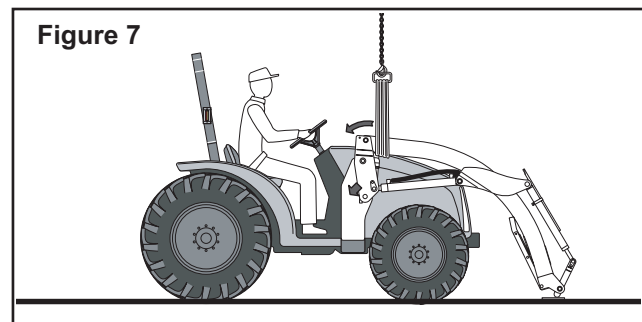

**MOUNTING LOADER (Continued)**

- Shut off tractor engine and set parking brakes. Insert two 1" x 4-7/8" pins (A) and linch pins (B), which were removed from loader uprights in instruction 2. Remove hoist chain or strap from loader boom arms.

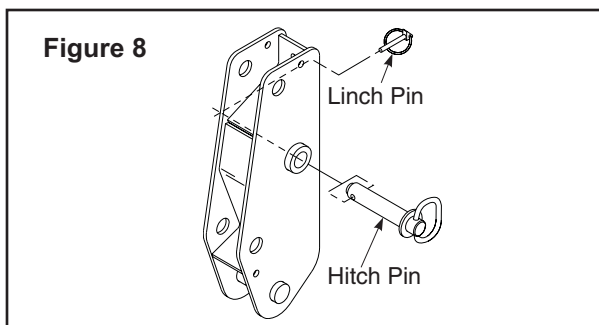

**NOTE:** In some cases a small amount of additional force may be required to insert pins. If necessary, use a drift and hammer made of non-sparking material (a shot-filled mallet is recommended) to seat loader uprights into mount tube saddles.

- Remove 3/8" cap screws (L) and lock nuts (E) to temporarily remove anti-rotation pins (M) to remove shipping brackets (K) (see figure 2). Discard shipping brackets (K), retaining anti-rotation pins and hardware for later reuse when installing bucket or attachment.
- Attach tilt cylinder function hoses (color coded blue and red) to corresponding tractor valve couplers, routing hoses under loader right mid mounting bracket. Loop all four loader control hoses over hose hanger (3, Figure 1) and over hook at front of right mid mounting bracket (2) to keep hoses from being damaged by lugs of tractor front tires.

**NOTE:** When dismantling loader from tractor, hoses must be unhooked from mid mounting hook and hose hanger (3) before dismantling.

- Start engine and fully extend and retract cylinders several times to purge air from hydraulic system. Add additional tractor hydraulic fluid as specified in tractor operator's manual to bring level of hydraulic fluid up to full.
- Adjust front wheel tread setting or steering stops, if necessary, to provide a minimum 3/4" clearance between front tires and any part of loader with lift cylinders fully retracted and front axle fully oscillated. Be sure lift cylinder are fully retracted. Refer to page 1, under preparing tractor. Refer to tractor operator's manual for tread setting and steering stop adjustment procedures.

**INSTALLING BUCKET OR ATTACHMENT**

Refer to loader operator's manual to install bucket or optional attachments. See instructions below for installing level rod with right tilt cylinder pin.



**WARNING:** Always have a bucket or heavy attachment attached to loader when it is removed from tractor. Pallet fork, bale spear, or similar attachments are too light to safely counterbalance loader boom arms when loader is dismantled from tractor.

**ADJUSTING LEVEL INDICATOR FOR BUCKET OR ATTACHMENT (Figure 9)**

Insert level rod into level indicator tube on right tilt cylinder. Pin level rod to rod end of right tilt cylinder by sandwiching level rod pivot angle between left side of cylinder cross tube and inside of attachment ear.

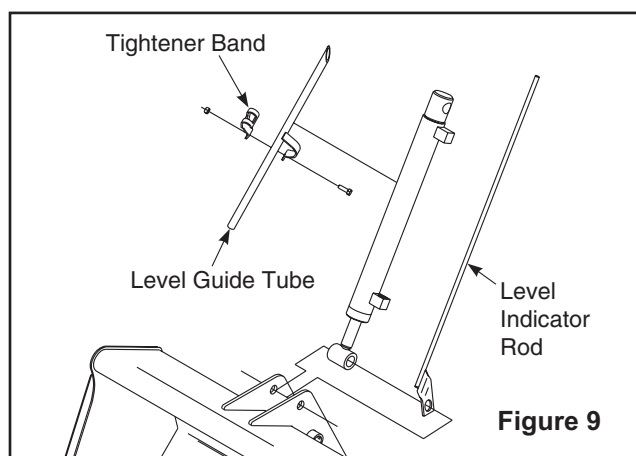

To adjust level indicator properly, locate tractor and loader attachment on a firm level surface with attachment resting on level surface in operating position. Loosen clamp bolt that fastens level indicator tube to right tilt cylinder and position it so end of level rod is at top end of tube.



**GENERAL TORQUE SPECIFICATIONS**

USE THE FOLLOWING TORQUES WHEN SPECIAL TORQUES ARE NOT GIVEN

**Standard American and Metric Cap Screws**

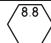
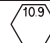
AMERICAN STANDARD CAP SCREWS										METRIC CAP SCREWS								
SAE Grade	5				8				Metric Class	8.8				10.9				
Typ. Head Markings									Typ. Head Markings									
Cap Screw	TORQUE				TORQUE				Cap Screw	TORQUE				TORQUE				
Size	FT·LBS		N·m		FT·LBS		N·m		Size	FT·LBS		N·m		FT·LBS		N·m		
Inches	MIN	MAX	MIN	MAX	MIN	MAX	MIN	MAX	Millimeters	MIN	MAX	MIN	MAX	MIN	MAX	MIN	MAX	
1/4 - 20	6.25	7.25	8.5	10	8.25	9.5	11	13	M6 x 1.00	6	8	8	11	9	11	12	15	
1/4 - 28	8	9	11	12	10.5	12	14	16	M8 x 1.25	16	20	21.5	27	23	27	31	36.5	
5/16 - 18	14	15	19	20	18.5	20	25	27	M10 x 1.50	29	35	39	47	42	52	57	70	
5/16 - 24	17.5	19	23	26	23	25	31	34	M12 x 1.75	52	62	70	84	75	91	102	123	
3/8 - 16	26	28	35	38	35	37	47.5	50	M14 x 2.00	85	103	115	139	120	146	163	198	
3/8 - 24	31	34	42	46	41	45	55.5	61	M16 x 2.50	130	158	176	214	176	216	238	293	
7/16 - 14	41	45	55.5	61	55	60	74.5	81	M18 x 2.50	172	210	233	284	240	294	325	398	
7/16 - 20	51	55	69	74.5	68	75	92	102	M20 x 2.50	247	301	335	408	343	426	465	577	
1/2 - 13	65	72	88	97.5	86	96	116	130	M22 x 2.50	332	404	450	547	472	576	639	780	
1/2 - 20	76	84	103	114	102	112	138	152	M24 x 3.00	423	517	573	700	599	732	812	992	
9/16 - 12	95	105	129	142	127	140	172	190	M27 x 3.00	637	779	863	1055	898	1098	1217	1488	
9/16 - 18	111	123	150	167	148	164	200	222	M30 x 3.00	872	1066	1181	1444	1224	1496	1658	2027	
5/8 - 11	126	139	171	188	168	185	228	251	<p><b>NOTE:</b> These values apply to fasteners as received from supplier, dry or when lubricated with normal engine oil. They do not apply if special graphite or molysulphide greases or other extreme lubricants are used.</p>									
5/8 - 18	152	168	206	228	203	224	275	304										
3/4 - 10	238	262	322	355	318	350	431	474										
3/4 - 16	274	305	371	409	365	402	495	544										
7/8 - 9	350	386	474	523	466	515	631	698										
7/8 - 14	407	448	551	607	543	597	736	809										
1 - 8	537	592	728	802	716	790	970	1070										
1 - 14	670	740	908	1003	894	987	1211	1337										

# INSTALLATION INSTRUCTIONS