

Keep With Operator's Manual

## LOADER MOUNTING KIT TEMPLATE FOR TRACTORS

MODEL	2WD	FWA	ROPS	CAB
GT65	X	X	X	X
GT75	X	X	X	X

### TRACTOR AND MOUNTING KIT GENERAL INFORMATION

Mounting kit can be installed on tractor using tools ordinarily available, including an overhead hoist and sling for initial loader installation, floor jack, standard and metric wrenches, and a torque wrench.

Mounting kit is not compatible with front weights. If front weights are present, remove them before installing loader mounting brackets.

Tractor-supplied hydraulic power is required for loader mounting and operation. Two hydraulic hose kit options are available, one includes hoses and fittings required to plumb loader hydraulics to tractor hydraulics and the other includes hoses and fittings required to plumb loader hydraulics to tractor rear remote valve couplers. Select the appropriate hose kit for your tractor remote control valve location.

Loader mounting kit is not compatible with front fenders. If tractor is equipped with front fenders, remove tractor front fenders and attaching hardware before installing loader mounting brackets.

Maximum size front agricultural tire option compatible with loader is 11.2-R24.

Tractor steering stops need to be adjusted to allow a minimum tire clearance of 3/4" between front tire and loader or mounting brackets on full left or right turn with front axle fully oscillated and loader lift cylinders fully retracted. Refer to tractor operator's manual for information about adjusting tractor steering stops.

Reference to left and right used in these instructions refer to position when seated in the operating position on tractor.

Shut off engine and engage brakes during installation.

**NOTE:** *Install all attaching hardware loosely (unless noted otherwise) until mounting kit is completely assembled to facilitate assembly and proper alignment. Unless otherwise specified, tighten all hardware to torques specified in general torque specifications table included in loader operator's manual.*

### PREPARING TRACTOR FOR LOADER MOUNTING BRACKET INSTALLATION

1. Remove hood side panels.
2. Temporarily remove exhaust pipe. Save hardware for reinstallation.
3. Loosen fuel tank housing and swing fuel tank away enough to gain clearance for loader mount installation.

### INSTALLING LOADER LEFT MID MOUNTING BRACKET (Figure 2)

1. Remove forward 16MM cap screw from supporting cab platform flange plate. On ROPS tractors, spacer (7) will substitute thickness of cab platform flange plate.
2. Place a clevis loop over top inside bushing of left mid mounting bracket (1) and secure. Using an overhead hoist, hook clevis loop and raise into position. To ease installation, slip 16MM x 65MM cap screws (10) and 5/8" lock washers (13) into rear holes of mid mount (1 & 2). For ROPS tractors, place spacer (7) over top rear cap screw (10).
3. Slide rear of left mid mounting bracket (1) over transmission casting and fasten using 16MM x 65MM cap screws (10), 5/8" lock washers (13) and ROPS spacer (7) previously placed. Finish fastening rear of left mid mounting using 16MM x 50MM cap screws (10) and 5/8" lock washers (13).



**WARNING:** Support mounting brackets when unbanding from pallet.

## INSTALLING LOADER LEFT MID MOUNTING BRACKET (Continued)

4. Place 3/4" long spacers (6) between slotted holes at front of left mid mounting bracket (1) and side of tractor front casting. Fasten using 14MM x 60MM cap screws (11), 9/16" flat washers (15) and 9/16" lock washers (14).
5. Loosen steering hydraulic hoses and reposition to avoid mid mounting bracket plate. Secure hoses to tractor frame using tie straps (16).
6. Reposition fuel tank and resecure fuel tank housing.
7. Replace exhaust pipe by maneuvering it between back of mid mounting bracket and fuel tank. Then between mid mount pocket and tractor frame and up to exhaust manifold. Finish securing exhaust using previously removed hardware. (See figure 1).

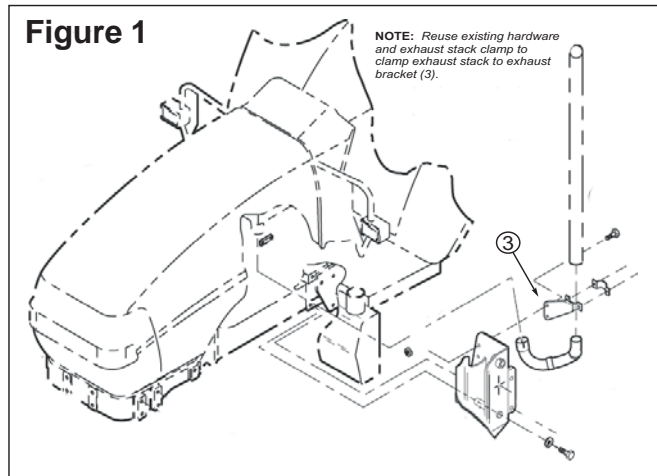

8. Remove inner 16MM cap screws from 3 point hitch bracket located on bottom of left rear axle.
9. Place left rail bracket (3) over 3 point hitch bracket and fasten using 16MM x 55MM cap screws (9) and 5/8" lock washers (13).

## INSTALLING LOADER RIGHT MID MOUNTING BRACKET (Figure 2)

1. Remove forward 16MM cap screw from supporting cab platform flange plate. On ROPS tractors, spacer (7) will substitute thickness of cab platform flange plate.
2. Place a clevis loop over top inside bushing of right mounting bracket (2) and secure. Using an overhead hoist, hook clevis loop and raise into position.
3. Slide rear of right mid mounting bracket (2) over transmission casting and fasten using 16MM x 65MM cap screws (10), 5/8" lock washers (13). On ROPS tractors, place spacer (7) on upper rear hole of right mid mounting bracket (2) before securing with 16MM x 65MM cap screws (10) and 5/8" lock washers (13). Finish fastening rear of right mid mounting bracket (2) using 16MM x 50MM cap screws (8) and 5/8" lock washers (13).
4. Place 3/4" long spacers (6) between slotted holes at front of right mid mounting bracket (2) and side of tractor casting. Fasten using 14MM x 60MM cap screws (11), 9/16" flat washers (15) and 9/16" lock washers (14).
5. Remove inner 16MM cap screws from 3 point hitch bracket located on bottom of right rear axle.
6. Place right rail bracket (4) over 3 point hitch bracket and fasten using 16MM x 55MM cap screws (9) and 5/8" lock washers (13).
7. Slip crosstie (5) between mid mounting brackets (1 & 2) and rail brackets (3 & 4). Fasten using 5/8 x 2" cap screws (12) and 5/8" lock nuts (17).
8. Replace hood side panels.

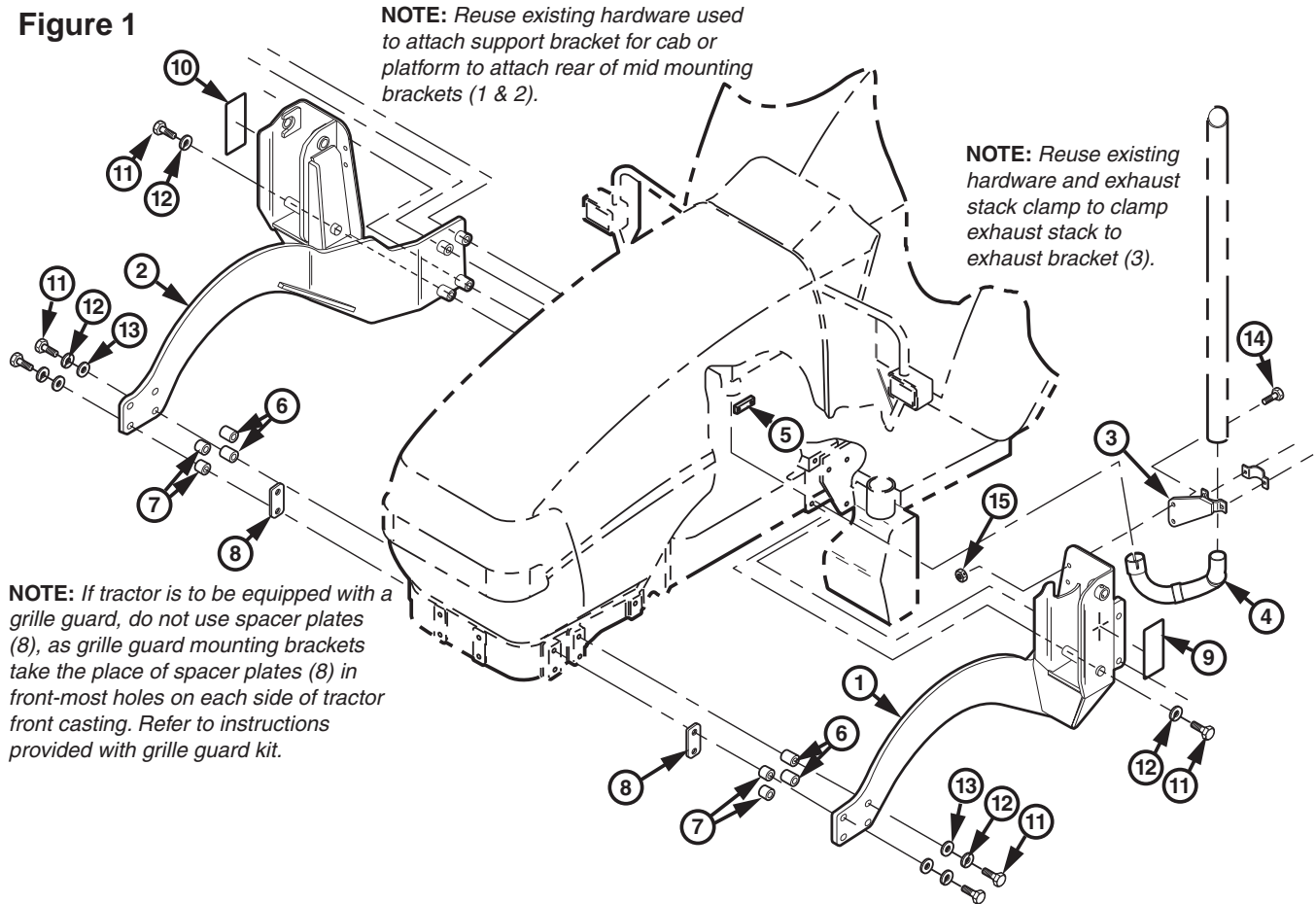
**Figure 1****PARTS LIST – MOUNTING KIT**

Item	Part No.	Description	Qty.
1	52861-1	BRACKET, Mid Mounting, Left, with Decal	1
2	52861-2	BRACKET, Mid Mounting, Right, with Decal	1
3	52802-1	BRACKET, Rail, Left	1
4	52802-2	BRACKET, Rail, Right	1
5	52807	CROSSTIE	1
6	49567-2	SPACER, Tube, 3/4" Long	4
7	43811-9	SPACER, Tube, 3/8" Long (ROPS Only)	2
8	42672-12	SCREW, Cap, 16MM-2.00 x 50MM, Grade 8.8	4
9	42672-79	SCREW, Cap, 16MM-2.00 x 55MM, Grade 8.8	4
10	42672-52	SCREW, Cap, 16MM-2.00 x 50MM, Grade 8.8	6
11	42672-43	SCREW, Cap, 14MM-2.00 x 60MM, Grade 8.8	4
12	41838-27	SCREW, Cap, 5/8-11 x 2.00, Grade 5	4
13	41837-7	WASHER, Lock, 5/8"	14
14	41837-6	WASHER, Lock, 9/16"	4
15	42502-11	WASHER, Flat, 9/16"	4
16	8137-3	STRAP, Tie, Adjustable Plastic	2
17	41840-7	NUT, Lock, 5/8-11	4
18	46776	DECAL, WARNING, (Left Side)	1
19	48436	DECAL, WARNING, (Right Side)	1

**MOUNTING LOADER TO TRACTOR (Figures 1, 3, 4, 5, 6, 7 & 8)**

**WARNING:** Loader must be supported before removing hardware securing loader to shipping pallet, or loader will tip over.



**WARNING:** To avoid injury during installation of quick attach loader, do not permit bystanders within ten feet of loader.



**WARNING:** To avoid injury during installation of quick attach loader, an overhead hoist must be used for initial mounting. Parking stands are not operational without bucket or heavy attachment mounted.

1. Loop chain under each bucket cylinder and hook on loader boom arm (see figure 2A). Using overhead hoist to support loader, remove cotter pins (A), hitch pins (B) and lynch pins (C) (see figure 3). Discard cotter pins only. Remove hardware securing loader to pallet. Lift loader.

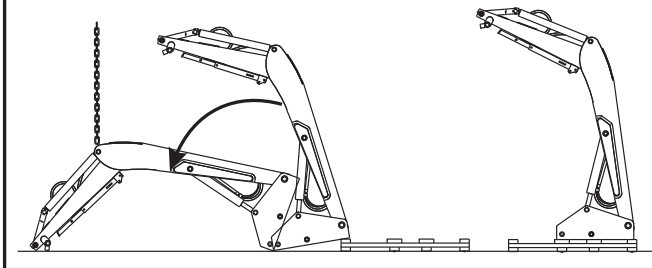
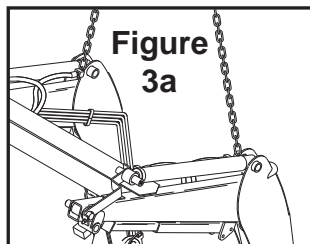
**Figure 3**

**WARNING:** Loader uprights may rotate downward when loader is lifted from pallet.

2. Position pallet at rear of loader to facilitate lowering (see figure 2). Lower loader from vertical shipping position to horizontal position (scraps of cardboard may be used to protect paint). Remove 3/8" cap screws (D figure 3), lock nuts (E), pins (F), shipping brackets (G). Discard shipping brackets, retain hardware for further use. Remove bucket level indicator rod, which is attached to oil lines for shipment.

3. Route hoses through hose loop (H) on inside of loader upright (shown in figure 3). Secure a hoist strap around boom arm assembly or secure with a chain hook into hole (I), if so provided in underside of boom arm (see figure 4). If using a strap, strap should be located around boom arm at approximately same location as chain shown in figure 4. Be sure to keep strap under oil lines on right side of boom.

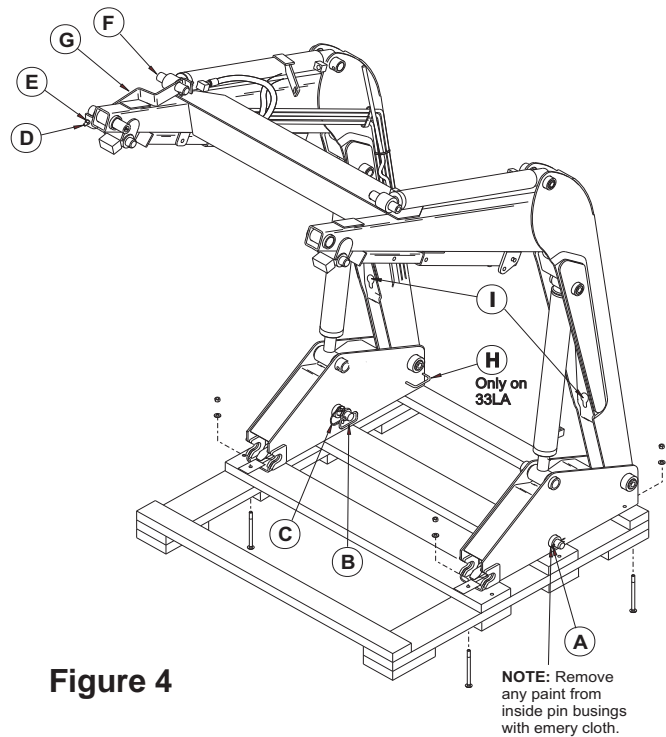
**Figure 4**

**NOTE:** Remove any paint from inside pin bushings with emery cloth.

4. Raise loader with overhead hoist as shown in figure 5.

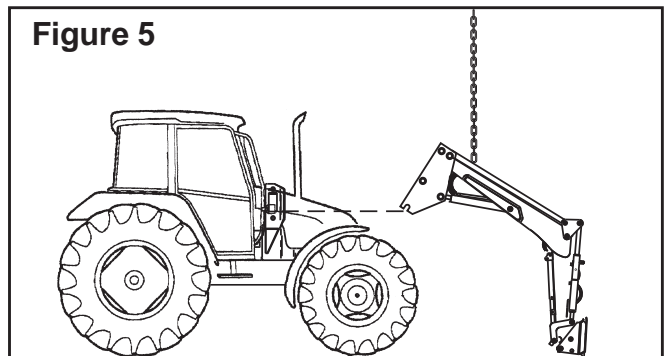
**Figure 5**

**NOTE:** Install valve kit or hose kit onto tractor before proceeding to instruction 5 on page 6.

(Continued on Page 6)

## MOUNTING 4211 LOADER (Figures 5, 6 & 7)



**WARNING:** Loader must be supported before removing hardware securing loader to shipping pallet, or loader will tip over.



**WARNING:** To avoid injury during installation of quick attach loader, do not permit bystanders within ten feet of loader.



**WARNING:** To avoid injury during installation of quick attach loader, an overhead hoist must be used for initial mounting. Parking stands are not operational without attachment mounted.

1. Loop hoist strap or chain around crossmember (see figure 5A). Using overhead hoist to support loader, remove shipping angle braces (B figure 6) by removing 1/2" lock nut (A), lift off brace (B), then reinstalling 1/2" lock nut that has been installed up to this point and (A).

**NOTE:** There is an additional 1/2" flat washer on outside of brace for shipping only, Remove and discard it with shipping angle brace.

**Figure 6**

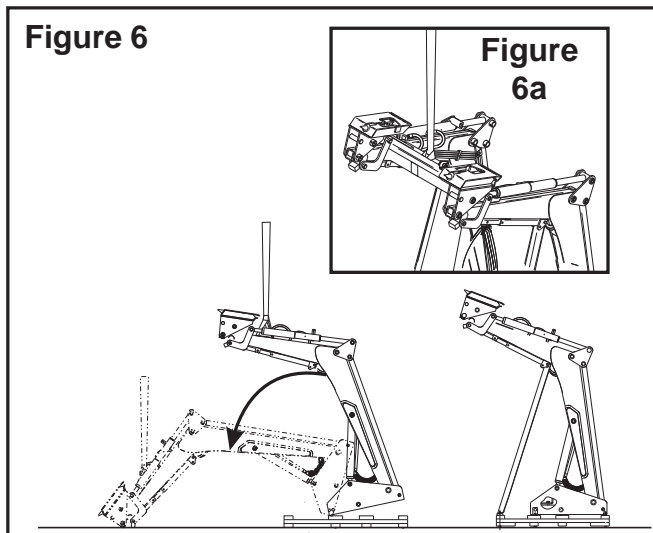

**NOTE:** Do not over tighten lock nut (A). Parking stand tube must pivot freely.

Remove remaining hardware (C figure 6) from shipping braces (B) and discard braces and hardware. Remove cotter pins (D), hitch pins (F) and lynch pins (E). Discard only cotter pins. Then remove nuts and washers (C) from bolts securing loader to pallet.

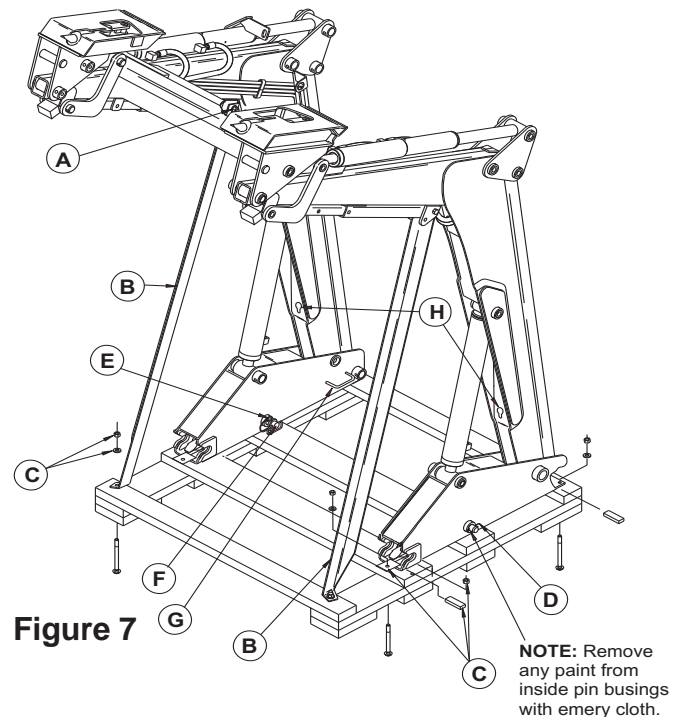

**Figure 7**

**NOTE:** Remove any paint from inside pin bushings with emery cloth.

2. Lower loader from vertical shipping position to horizontal position (figure 5) (Loader may require slight push to start lowering). Packaging hardware may bend during lowering process, which is acceptable. Remove bucket level indicator rod, which is attached to oil lines for shipment.
3. Route hoses through hose loop (G) on inside of loader upright (shown in figure 6). Secure a hoist chain hook into hole (H) provided in boom underside (refer to figures 6 & 7).
4. Raise loader with overhead hoist as shown in figure 7.



**MOUNTING 4211 LOADER (Continued)**

**NOTE:** *Examine pin bushings and remove any paint with emery cloth before mounting loader (see figures 1, 3 & 6).*

**NOTE:** *Before continuing mounting procedure, lubricate loader as instructed in loader manual.*

5. A) If tractor is equipped with a hose kit, back tractor up to rear of loader. Attach lift cylinder function hoses (color-coded green and yellow) to tractor rear remotes. Retract lift cylinders fully and continue to activate control lever for approximately 10 seconds.

B) If tractor is equipped with a valve kit, park tractor next to loader so right side of tractor cab window is parallel with rear of loader upright. Attach colored spiral bands to valve female couplers to identify hoses (Refer to valve kit instructions). Attach lift cylinder function hoses (color-coded green and yellow) to corresponding valve couplers. Retract lift cylinders fully and continue to activate control lever for approximately 10 seconds.

**NOTE:** *It is important to attach lift cylinder hoses (color-coded yellow and green with identification bands) for loader to function properly.*

Extend lift cylinders about 2" from fully closed position. Shut off tractor and disconnect hydraulic hoses.

Position tractor directly behind loader. Slowly raise loader with overhead hoist until loader upright will clear tractor front tires.

6. Move tractor forward until loader upright saddles are centered over mounting shaft. Lower loader with overhead hoist until upright saddle straddles mounting shaft.
7. Remove hoist chain or strap from loader boom and secure around front crossmember (see figure 9). Using overhead hoist raise front of loader to rotate loader upright into mounting pocket. Continue to rotate loader upright until upright has fully rotated into back of mounting guide. Insert two 1 x 7-3/4 pins and linch pins which were removed from loader uprights in step 1, to secure loader to loader mountings.

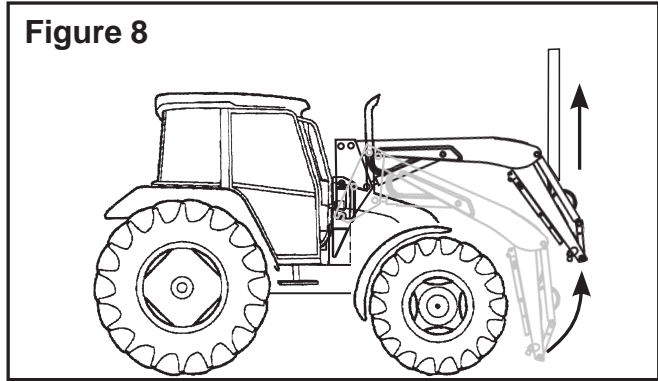
**Figure 8**

8. Connect hoses to tractor hydraulics. Refer to instructions provided with hose kit for tractors using rear remotes. Refer to valve kit instructions for tractors with auxiliary valve kit.
9. Start engine and slowly cycle cylinders several times to purge air from hydraulic system. Refer to hydraulic oil specifications in tractor operator's manual to replenish tractor hydraulic system.
10. Adjust front wheel tread settings or steering stops, if necessary to provide a minimum 3/4 inch clearance between front tires and any part of loader with lift cylinders fully retracted and front axle fully oscillated. Be sure lift cylinders are fully retracted. Refer to tractor operator's manual for tread setting and steering stop adjustment procedures.

**INSTALLING BUCKET OR ATTACHMENT**

Refer to loader operator's manual to install bucket or optional attachment.







**ATTACH BUCKET LEVEL INDICATOR**

Refer to instruction sheet and assembly manual with bucket or optional attachment for instructions to attach and adjust level indicator for bucket or attachment.

## GENERAL TORQUE SPECIFICATIONS

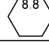
USE THE FOLLOWING TORQUES WHEN SPECIAL TORQUES ARE NOT GIVEN

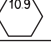
### Standard American and Metric Cap Screws

AMERICAN STANDARD CAP SCREWS									METRIC CAP SCREWS								
SAE Grade	5				8				Metric Class	8.8				10.9			
Typ. Head Markings									Typ. Head Markings	 				 			
Cap Screw	TORQUE				TORQUE				Cap Screw	TORQUE				TORQUE			
Size	FT·LBS		N·m		FT·LBS		N·m		Size	FT·LBS		N·m		FT·LBS		N·m	
Inches	MIN	MAX	MIN	MAX	MIN	MAX	MIN	MAX	Millimeters	MIN	MAX	MIN	MAX	MIN	MAX	MIN	MAX
1/4 - 20	6.25	7.25	8.5	10	8.25	9.5	11	13	M6 x 1.00	6	8	8	11	9	11	12	15
1/4 - 28	8	9	11	12	10.5	12	14	16	M8 x 1.25	16	20	21.5	27	23	27	31	36.5
5/16 - 18	14	15	19	20	18.5	20	25	27	M10 x 1.50	29	35	39	47	42	52	57	70
5/16 - 24	17.5	19	23	26	23	25	31	34	M12 x 1.75	52	62	70	84	75	91	102	123
3/8 - 16	26	28	35	38	35	37	47.5	50	M14 x 2.00	85	103	115	139	120	146	163	198
3/8 - 24	31	34	42	46	41	45	55.5	61	M16 x 2.50	130	158	176	214	176	216	238	293
7/16 - 14	41	45	55.5	61	55	60	74.5	81	M18 x 2.50	172	210	233	284	240	294	325	398
7/16 - 20	51	55	69	74.5	68	75	92	102	M20 x 2.50	247	301	335	408	343	426	465	577
1/2 - 13	65	72	88	97.5	86	96	116	130	M22 x 2.50	332	404	450	547	472	576	639	780
1/2 - 20	76	84	103	114	102	112	138	152	M24 x 3.00	423	517	573	700	599	732	812	992
9/16 - 12	95	105	129	142	127	140	172	190	M27 x 3.00	637	779	863	1055	898	1098	1217	1488
9/16 - 18	111	123	150	167	148	164	200	222	M30 x 3.00	872	1066	1181	1444	1224	1496	1658	2027
5/8 - 11	126	139	171	188	168	185	228	251	<b>NOTE:</b> These values apply to fasteners as received from supplier, dry or when lubricated with normal engine oil. They do not apply if special graphite or moly sulphide greases or other extreme lubricants are used.								
5/8 - 18	152	168	206	228	203	224	275	304									
3/4 - 10	238	262	322	355	318	350	431	474									
3/4 - 16	274	305	371	409	365	402	495	544									
7/8 - 9	350	386	474	523	466	515	631	698									
7/8 - 14	407	448	551	607	543	597	736	809									
1 - 8	537	592	728	802	716	790	970	1070									
1 - 14	670	740	908	1003	894	987	1211	1337									

# **INSTALLATION INSTRUCTIONS**