

Keep With Operator's Manual

HOSE KIT TO TRACTOR MID COUPLERS 2408TL LOADER

AGCO MODEL	MASSEY FERGUSON MODEL	FWA	ROPS
ST34A	1533	X	X
ST41A	1540	X	X

HOSE KIT GENERAL INFORMATION

Hose kit can be installed using tools ordinarily available. Shut off tractor engine and engage brakes during installation.

NOTE: Apply sealant only to all tapered threads unless coupled with swivel adapters. When using teflon tape, wrap tape clockwise (as viewed from end) and wrap only twice. Keep sealant away from first two threads of tapered end to prevent contamination of hydraulic fluid. Do not use sealant on o-ring or flare adapter threads.



WARNING: Escaping hydraulic fluid under pressure can penetrate skin causing serious injury.

- DO NOT use your hands to check for leaks. Use a piece of cardboard or paper to search for leaks.
- Stop engine and relieve pressure before connecting or disconnecting lines.
- Tighten all connections before starting engine or pressurizing lines.

If any fluid is injected into skin, obtain medical attention immediately or gangrene may result.

PLUMBING LOADER TO MID MOUNT COUPLERS (Figure 1)

1. Install color-coded spiral bands (2, 3, 4, 5) to male end of 3/8 x 60" hoses (1).
2. Install hoses to loader boom oil lines in sequence from the bottom up. (Loosening oil line clamp nearest to ends of oil lines may help ease assembly.) Attach hose identified by green band to lift cylinder base (LCB) oil line. Attach hose identified by yellow band to lift cylinder rod (LCR) oil line. Attach hose identified by red band to tilt cylinder rod (TCR) oil line. Attach hose identified by blue band to tilt cylinder base (TCB) oil line.

3. Bundle lift cylinder hoses together and tilt cylinder hoses together. Slide nylon sleeves (6) over 3/8 x 60" hoses (1). Make a small hole in sleeve near oil line tubes and fasten sleeve (6) over hose crimps using tie straps (7).
4. Install male couplers (9) with dust caps (10) onto male ends of 3/8 x 60" hoses (1). Bundle hoses (1) and sleeves (6) together using tie strap (13).
5. Attach loader hose male couplers to tractor female couplers, matching colors of spiral identification bands (2, 3, 4, 5) to colors used to identify female couplers.

IMPORTANT: Attach lift cylinder and tilt cylinder hoses to tractor couplers based on Figures 1A & 1B on next page.

6. If required, use tarp strap (11) to bundle hoses together and attach to front part of loader frame to prevent hoses from coming in contact with moving parts.
7. After all plumbing has been completed slowly cycle lift and bucket cylinders several times to purge air from hydraulic system. Retract cylinders and shut off engine. Replenish tractor hydraulic system.

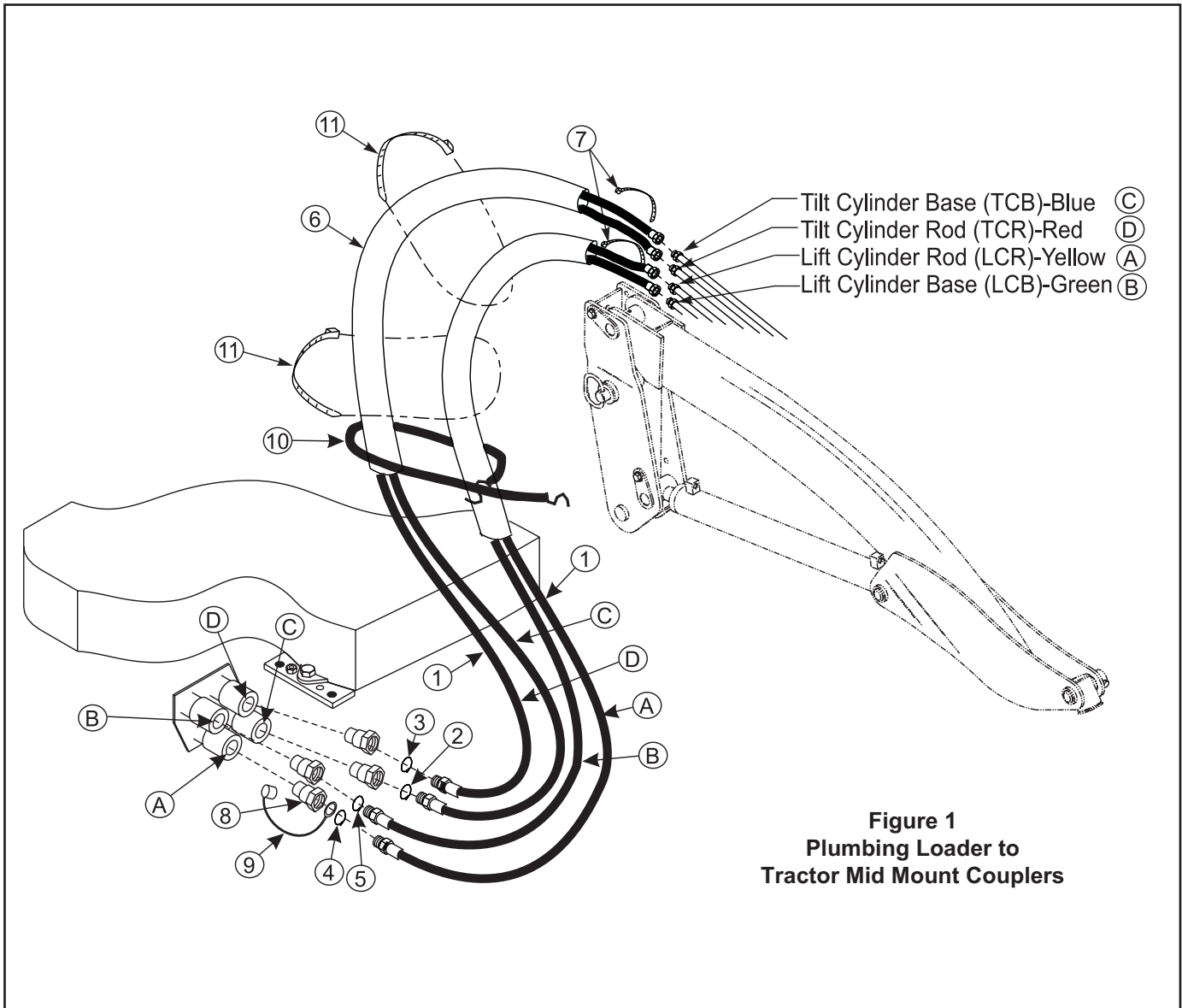

Figure 1
Plumbing Loader to
Tractor Mid Mount Couplers

PARTS LIST - HOSE KIT

Item	Part No.	Description	Qty.
1	38576-12	HOSE, 3/8 x 60"	4
2	36240-5	BAND, Colored, Blue	1
3	36240-6	BAND, Colored, Red	1
4	36240-7	BAND, Colored, Yellow	1
5	36240-8	BAND, Colored, Green	1
6	34853-3	SLEEVE, Nylon, 1.75 x 60"	2
7	8137-1	STRAP, Adjustable, .19 x 11.00	2
8	6137-11	COUPLER, Male, O-ring	4
9	4838-18	DUST CAP, Black	4
10	7438-1	TARP STRAP	1
11	8137-6	STRAP, Adjustable, .34 x 15.33	2

INSTALLATION INSTRUCTIONS