

Keep With Operator's Manual

**SMC 102 QX**  
**Loader Mounting Kit Instructions**  
**International Harvester & Farmall - 66 & 86 Series**

**INSTALLING MOUNTING BRACKETS (Figure 1)**

Support tractor front casting using a jack or blocks.

1. Remove front two bolts on each side of tractor front casting.
2. Install left (1) and right (2) front mountings to tractor front casting using 3/4 - 10 x 1-1/2" HHCS (8) and 3/4" lock washers (9) at front of tractor casting and 5/8 - 11 x 1-3/4 HHCS (10) and 5/8" lock washers (11) at sides of tractor front casting.  
  
**Note:** On 1981 production "86" Series tractors M20 - 2.5 x 40 mm HHCS (13) and 20 mm lock washers (14) are used in place of the 3/4 - 10 x 1-1/2" HHCS (8) and 3/4" lock washers, and M16 - 2.00 HHCS (15) are used in place of the 5/8 - 11 x 1-3/4" HHCS at the tractor front casting.
3. Fasten left (3) and right (4) mounting channels to tractor clutch housing area using 3/4 - 10 x 2-3/4" HHCS (16), 3/4" lock washers (9) and spacer bushings (7) at rear hole of channels (3 & 4) and 5/8 - 11 x 1-3/4" HHCS (10), 5/8" flat washers (17), and 5/8" lock nuts in other five holes in channels.

**Note:** On some cab equipped models, spacer bushings (7) are not used.

4. Center mid mounting assembly (5) with round tubs up and forward and fasten to mounting plates (3 & 4) using 3/4 - 10 x 5-1/2" HHCS (18), clamp flat (6), and 3/4 - 10 lock nuts (19).

**Installing Loader to mounting Brackets**

1. Attach nylon sling around loader front bumper and use an overhead hoist to raise the loader off the pallet and lower into horizontal position. Attach the nylon slings around the loader lift boom arms and use the overhead hoist to raise the loader and position the side frame channels over the front mounting brackets. Slide loader rearward until side frame uprights are over mid mounting tubes.
2. Clamp hinge around tubes on loader mid mounting assembly. Fasten with 3/4 x 3" HHCS, flat washers, and lock nuts. (supplied with loader).
3. Refer to the loader owners manual and hydraulic plumbing instructions to complete the loader installation.

**PARTS LIST - Loader Mount Kit**

Item	Part No.	Description	Qty.
1	53355-1	Front Mounting Assembly Left	1
2	53355-2	Front Mounting Assembly Right	1
3	53347-1	Mounting Plate, Left	1
4	53347-2	Mounting Plate, Right	1
5	53350	Mid Mounting Assembly	1
6	36478	Flat - Clamp	2
7	23006	Spacer Bushing	2
8	41838-44	HHCS, 3/4-10x1.50 Gr5	4
9	41837-8	Lock Washer 3/4	6
10	42969-18	HHCS 5/8-11 X 1.75 Gr8	18
11	41837-7	Washer, lock 5/8	8
12	41840-7	Lock Nut, 5/8-11	10
13	42672-42	Met, HHCS 20mm - 2.5mm x 40mm	4
14	48093-2	Lock Washer, Metric 20mm	4
15	42672-12	Met, HHCS16mm-2mm x 50mm gr 8.8	8
16	41838-42	HHCS, 3/4-10x2.75 Gr5	2
17	42502-32	Washer, Flat 5/8 W-std	10
18	41838-65	HHCS, 3/4-10 X 5.50	4
19	41840-8	Lock Nut, 3/4-10	4

Figure 1

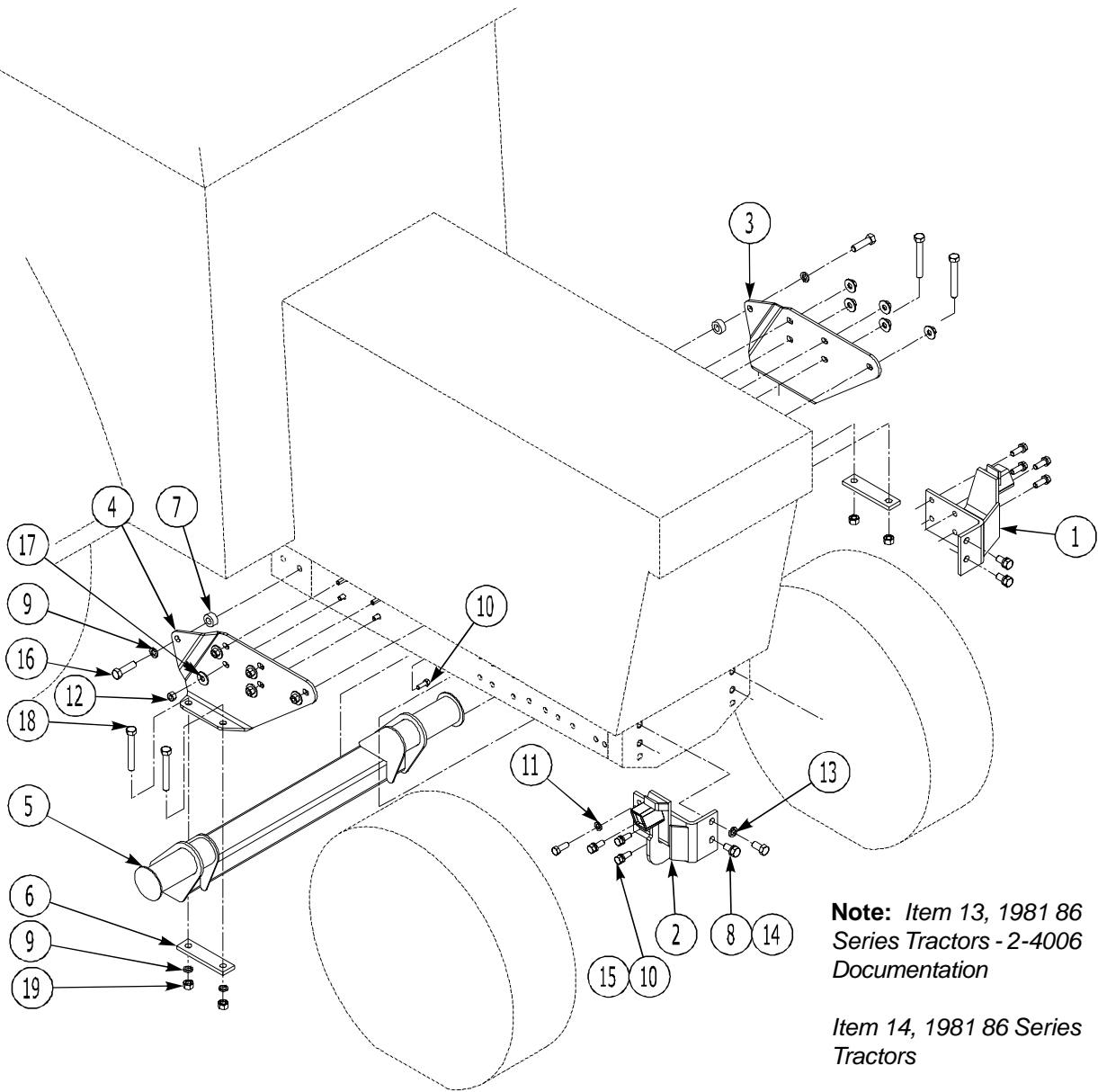

**Note:** Item 13, 1981 86 Series Tractors - 2-4006 Documentation

Item 14, 1981 86 Series Tractors

Item 15, 1981 86 Series Tractors - 2-3936 Documentation

# INSTALLATION INSTRUCTIONS